

TEMPORARY 4in YELLOW LINE (PAINT)
DURABLE 4in YELLOW LINE (THERMOPLASTIC)

STA 22+00 TO 52+25 SOLID LT&RT
STA 49+59 DOUBLE SOLID RT
(WITH CENTERLINE BREAKS FOR TOWN HIGHWAYS)

TEMPORARY 4in WHITE LINE (PAINT)
DURABLE 4in WHITE LINE (THERMOPLASTIC)

STA 22+00 TO 52+25 SOLID LT&RT
(WITH EDGELINE BREAKS FOR TOWN HIGHWAYS)

TEMPORARY LETTER OR SYMBOL (PAINT)
DURABLE LETTER OR SYMBOL (THERMOPLASTIC)

STA 49+59 RT "STOP"

TEMPORARY 24in STOP BAR (PAINT)
DURABLE 24in STOP BAR (THERMOPLASTIC)

STA 49+59 RT SINCLAIR RD

PAVEMENT CORES -

#	TOTAL DEPTH (in)	DRAINABLE BASE	SOLID CORE	COMMENTS
3	6.5	NO	YES	--
18	7.75	NO	YES	CABIN COVE RD
17	9.0	NO	YES	CABIN COVE RD

NOTE:
- NO PCC UNDER ANY CORES
- NO CORES OVER ASPHALTED
- NO SHOULDER CORES
- NO STRIPPED CORES

STA 22+40 LT
INSTALL ANCHOR FOR STEEL BEAM RAIL

STA 22+40 TO 26+75 LT

REMOVAL AND DISPOSAL OF GUARD RAIL

STA 22+40 TO 26+75 LT

INSTALL STEEL BEAM GUARD RAIL, GALVANIZED

STA 26+75 LT

INSTALL ANCHOR FOR STEEL BEAM RAIL

REMOVE SIGNS
6

BITUMINOUS CONCRETE GUTTER
STA 38+40 TO 40+00 LT

CHANGE ELEVATION OF SEWER MANHOLE
STA 49+70 RT
STA 22+50 LT
DONE BY TOWN OF JOHNSON

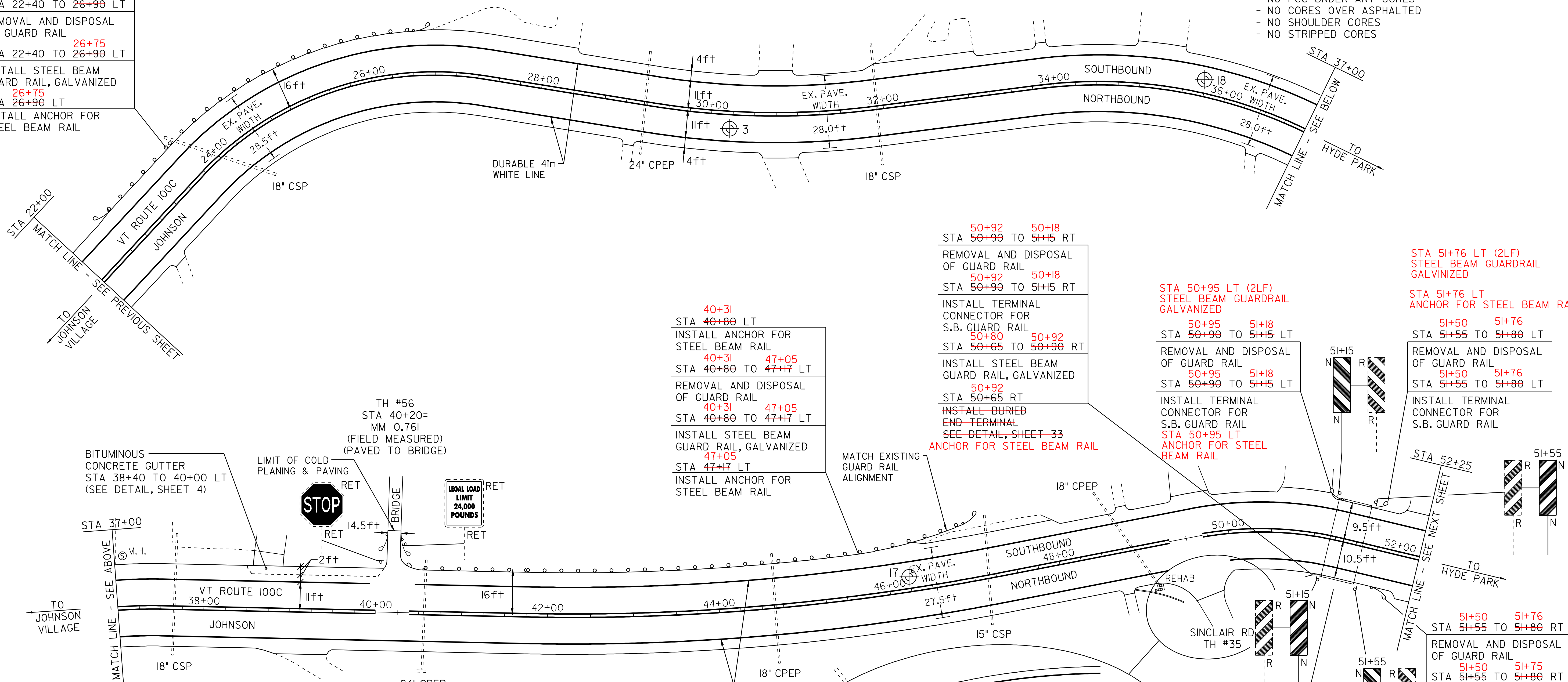

40+31
STA 40+80 LT
INSTALL ANCHOR FOR STEEL BEAM RAIL

40+31 47+05
STA 40+80 TO 47+17 LT

REMOVAL AND DISPOSAL OF GUARD RAIL

40+31 47+05
STA 40+80 TO 47+17 LT

INSTALL STEEL BEAM GUARD RAIL, GALVANIZED

47+05
STA 47+17 LT

INSTALL ANCHOR FOR STEEL BEAM RAIL

50+92 50+18
STA 50+90 TO 51+15 RT

REMOVAL AND DISPOSAL OF GUARD RAIL

50+92 50+18
STA 50+90 TO 51+15 RT

INSTALL TERMINAL CONNECTOR FOR S.B. GUARD RAIL

50+80 50+92
STA 50+65 TO 50+90 RT

INSTALL STEEL BEAM GUARD RAIL, GALVANIZED

50+92
STA 50+65 RT

INSTALL BURIED END TERMINAL
SEE DETAIL, SHEET 33
ANCHOR FOR STEEL BEAM RAIL

50+95 51+18
STA 50+90 TO 51+15 LT

REMOVAL AND DISPOSAL OF GUARD RAIL

50+95 51+18
STA 50+90 TO 51+15 LT

INSTALL TERMINAL CONNECTOR FOR S.B. GUARD RAIL

50+95 LT
ANCHOR FOR STEEL BEAM RAIL

51+76 LT (2LF)
STEEL BEAM GUARDRAIL GALVANIZED

51+76 LT
ANCHOR FOR STEEL BEAM RAIL

51+50 51+76
STA 51+55 TO 51+80 LT

REMOVAL AND DISPOSAL OF GUARD RAIL

51+50 51+76
STA 51+55 TO 51+80 LT

INSTALL TERMINAL CONNECTOR FOR S.B. GUARD RAIL

51+50 51+76
STA 51+55 TO 51+80 RT

REMOVAL AND DISPOSAL OF GUARD RAIL

51+50 51+75
STA 51+55 TO 51+80 RT

INSTALL TERMINAL CONNECTOR FOR S.B. GUARD RAIL

51+76 RT
ANCHOR FOR STEEL BEAM GUARD RAIL

51+76 RT (2LF)
STEEL BEAM GUARD RAIL, GALVANIZED

REMOVAL AND DISPOSAL OF GUARD RAIL

STA 22+40 TO 26+90 LT 22+40 TO 26+75
STA 40+80 TO 47+17 LT 40+31 TO 47+04
STA 50+90 TO 51+15 LT 50+92 TO 51+18
STA 50+90 TO 51+15 RT 50+92 TO 51+18
STA 51+55 TO 51+80 LT 51+50 TO 51+76
STA 51+55 TO 51+80 RT 51+50 TO 51+75

ANCHOR FOR STEEL BEAM RAIL

STA 22+40 LT
STA 26+90 LT 26+75
STA 40+80 LT 40+31
STA 47+17 LT 47+05
STA 50+65 RT - 250+92
STA 50+95 LT
STA 51+76 LT
STA 51+76 RT

TERMINAL CONNECTOR FOR S. B. GUARD RAIL

STA 50+90 TO 51+15 LT 50+92 TO 51+18
STA 50+90 TO 51+15 RT 50+92 TO 51+18
STA 51+55 TO 51+80 LT 51+50 TO 51+76
STA 51+55 TO 51+80 RT 51+50 TO 51+75

REHABILITATION OF D.I.'S, C.B.'S, OR M.H.'S
STA 49+10 RT

STEEL BEAM GUARD RAIL, GALVANIZED

STA 22+40 TO 26+90 LT 22+40 TO 26+75
STA 40+80 TO 47+17 LT 40+31 TO 47+05
STA 50+65 TO 50+90 RT 50+80 TO 50+92
STA 50+95 LT (WING)
STA 51+76 LT (WING)
STA 51+76 RT (WING)

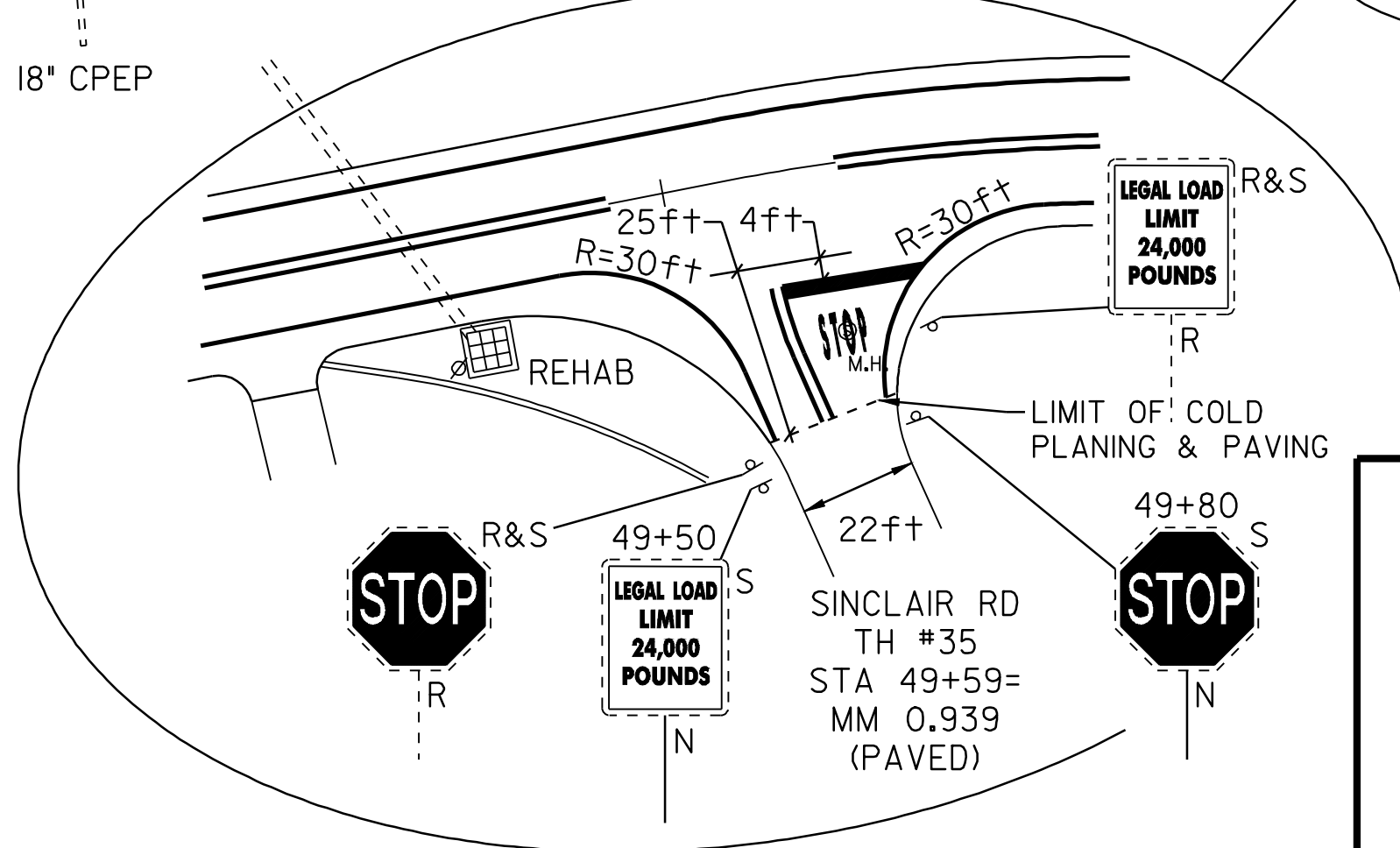

PAVING PROJECT LAYOUT SHEET #3

DESIGNED BY	BCE/PJM	DATE	7-07
DRAWN BY	C.E.A., INC.	DATE	7-07
DESIGN FILE NO.	p99c182.dgn		
PRF FILE	p99c182p103.i	DATE PLOTTED	08-JAN-2009
PROJ. NAME	JOHNSON - HYDE PARK		
PROJ. NO.	STP 2215(1)S		
SHEET	12	OF	33 SHEETS