

TEMPORARY 4" WHITE LINE, PAINT
 DURABLE 4" WHITE LINE, THERMOPLASTIC
 STA 307+79 TO 310+69 SOLID RT
 STA 307+79 TO 312+50 SOLID LT
 STA 310+69 TO 310+84 SOLID RT (TH 83)
 STA 311+04 TO 311+19 SOLID RT (TH 83)
 STA 311+19 TO 312+50 SOLID RT

TEMPORARY 4" YELLOW LINE, PAINT
 DURABLE 4" YELLOW LINE, THERMOPLASTIC
 STA 307+00 TO 307+19 SOLID LT & RT
 STA 307+59 TO 310+74 SOLID LT & RT
 STA 310+94 DOUBLE SOLID RT (TH 83)
 STA 311+14 TO 312+50 SOLID LT & RT

TEMPORARY CROSSWALK MARKING, PAINT
 DURABLE CROSSWALK MARKING, THERMOPLASTIC
 STA 307+29 TO 307+49 LT (TH 86)
 TEMPORARY LETTER OR SYMBOL, PAINT
 DURABLE LETTER OR SYMBOL, THERMOPLASTIC
 STA 310+99 RT - "STOP" (TH 83)

TEMPORARY 24" STOP BAR, PAINT
 DURABLE 24" STOP BAR, THERMOPLASTIC
 STA 310+95 TO 311+07 RT (TH 83)

CHANGING ELEVATION OF DROP INLETS,
 CATCH BASINS, OR MANHOLES
 STA 308+86 LT (CB)
 STA 311+10 RT (CB)
 STA 312+00 RT (CB)
 REHAB. DROP INLETS, CATCH BASINS,
 OR MANHOLES, CLASS I, CLASS II OR CLASS III
 STA 308+86 RT (DI)

REMOVING SIGNS
 AS SHOWN - 5

ERECTING SALVAGED SIGNS
 AS SHOWN - 5

STA 307+00 TO 312+50
 MAY HAVE SEWER MANHOLES
 HIDDEN BY PAVEMENT.

CHANGING ELEVATION
 OF SEWER MANHOLES (NON PART.)
 STA 308+99 RT
~~STA 311+65 CL~~

ADJUST ELEVATION
 OF VALVE BOX (NON PART.)
 STA 307+39 LT
 STA 309+54 LT

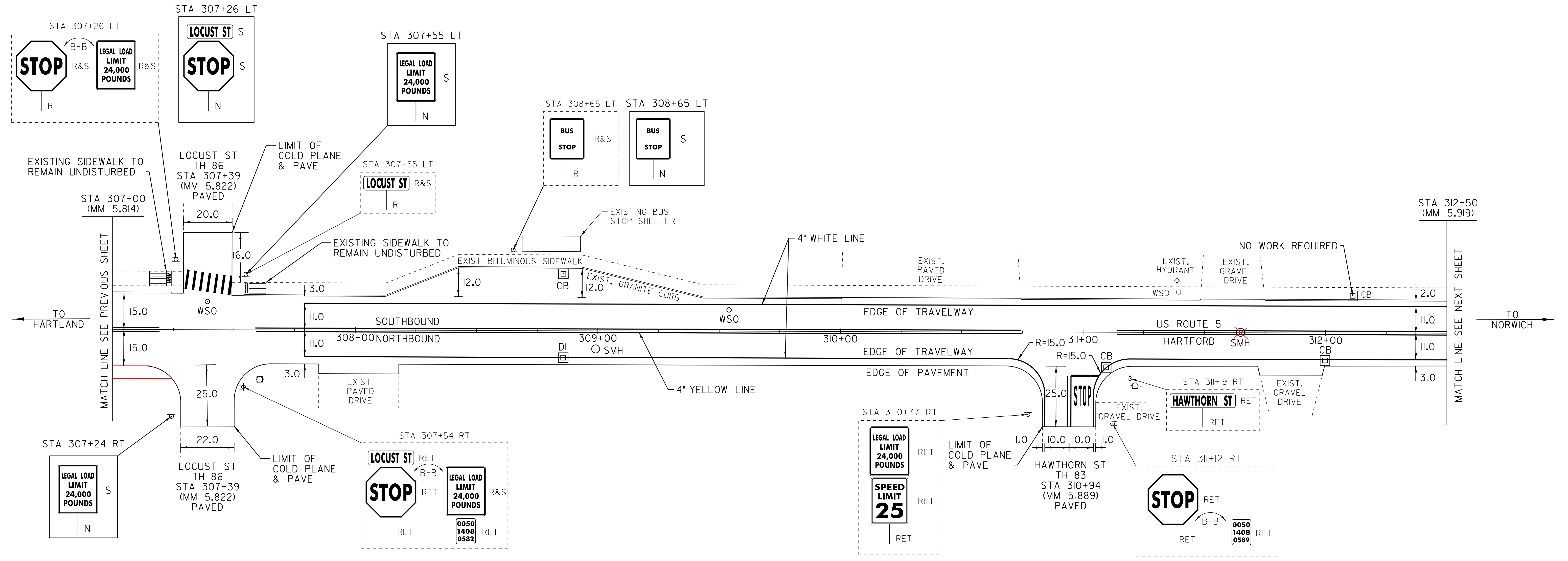

NOTE:
 EXISTING SIDEWALK RAMPS AT
 LOCUST ST. MEET ADA REQUIREMENTS.
 DO NOT DISTURB

LEGEND

- R = REMOVE EXISTING
- S = SALVAGE
- R&S = REMOVE AND SALVAGE
- N = NEW
- RET = RETAIN
- B-B = BACK TO BACK
- = EXISTING GUARDRAIL
- = PROPOSED GUARDRAIL
- ↑ = TYPE I DELINEATOR, WHITE

PAVING LAYOUT SHEET 20	PROJECT NAME: HARTFORD-NORWICH	PLOT DATE: 14-FEB-2012 15:50
	PROJECT NUMBER: STP 2206(1)S	DRAWN BY: MRS
	FILE NAME: /pave/99c164/pci64	CHECKED BY: NLL
	DESIGNED BY: NLL	SHEET 44 OF 137

NOT TO SCALE