

TEMPORARY 4" WHITE LINE, PAINT  
 DURABLE 4" WHITE LINE, THERMOPLASTIC  
 STA 291+50 TO 293+43 SOLID RT  
 STA 291+50 TO 297+00 SOLID LT  
 STA 294+23 TO 295+50 SOLID RT  
 STA 296+30 TO 297+00 SOLID RT

TEMPORARY 4" YELLOW LINE, PAINT  
 DURABLE 4" YELLOW LINE, THERMOPLASTIC  
 STA 291+50 TO 293+63 SOLID LT & RT  
 STA 294+03 TO 295+70 SOLID LT & RT  
 STA 296+10 TO 297+00 SOLID LT & RT

TEMPORARY CROSSWALK MARKING, PAINT  
 DURABLE CROSSWALK MARKING, THERMOPLASTIC  
 STA 293+73 TO 293+95 RT (TH 90)  
 STA 295+80 TO 295+99 RT (TH 90)

CHANGING ELEVATION OF DROP INLETS,  
 CATCH BASINS, OR MANHOLES  
 STA 295+97 RT (CB)

REMOVING SIGNS  
 AS SHOWN - 2

ERECTING SALVAGED SIGNS  
 AS SHOWN - 2

STA 291+50 TO 297+00  
 MAY HAVE SEWER MANHOLES  
 HIDDEN BY PAVEMENT.

BITUMINOUS GUTTER  
 295+48 - 297+00 LT

PORTLAND CEMENT CONCRETE SIDEWALK, 5 INCH  
 59 STA 293+42 TO 293+71 RT (RAMP TYPE I)  
 STA 293+96 TO 294+09 RT (RAMP TYPE I)  
 STA 295+65 TO 295+80 RT (RAMP TYPE I)  
 STA 295+99 TO 296+14 RT (RAMP TYPE I)

ADJUST ELEVATION  
 OF VALVE BOX (NON PART.)  
 STA 295+78 LT

~~VERTICAL GRANITE CURB~~  
~~STA 293+42 TO 293+71 RT~~  
~~STA 293+42 TO 293+71 RT (BACK CURB)~~  
~~STA 293+96 TO 294+09 RT~~  
~~STA 295+65 TO 295+80 RT~~  
~~STA 295+99 TO 296+14 RT~~ **INSTALLED BY TOWN**

DETECTABLE WARNING SURFACE  
 STA 293+64 RT  
 STA 294+01 RT  
 STA 295+78 RT  
 STA 296+02 RT

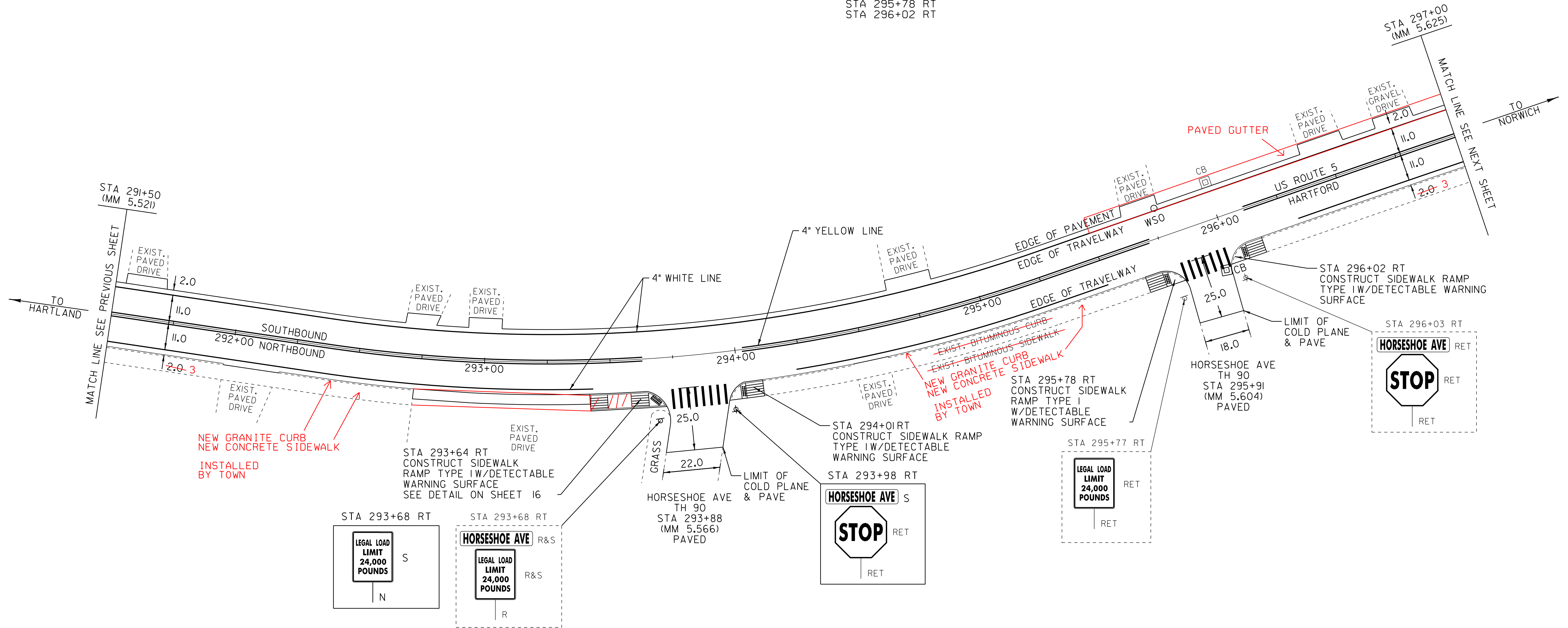

LEGEND

- R = REMOVE EXISTING
- S = SALVAGE
- R&S = REMOVE AND SALVAGE
- N = NEW
- RET = RETAIN
- B-B = BACK TO BACK
- EXISTING GUARDRAIL
- PROPOSED GUARDRAIL
- ↑ = TYPE I DELINEATOR, WHITE

<b>PAVING LAYOUT SHEET 17</b>	PROJECT NAME: HARTFORD-NORWICH	PLOT DATE: 14-FEB-2012 15:50
	PROJECT NUMBER: STP 2206(1)S	DRAWN BY: MRS
	FILE NAME: /pave/99cl64/pci64	DESIGNED BY: NULL
	IPARM FILE NAME: pci64l7.i	CHECKED BY: NULL
		SHEET 41 OF 137

NOT TO SCALE