

TEMPORARY 4" WHITE LINE, PAINT
 DURABLE 4" WHITE LINE, THERMOPLASTIC
 STA H 37+50 TO H 38+75 SOLID RT
 STA H 37+50 TO H 38+22 SOLID LT
 STA 259+50 TO 260+69 SOLID LT
 STA 259+50 TO 265+00 SOLID RT
 STA 259+50 TO 260+71 DASHED LT
 STA 259+50 TO 260+73 DASHED RT
 STA 259+50 TO 260+91 SOLID RT LANE LINE
 STA 261+22 TO 264+76 DASHED RT
 STA 261+75 TO 264+64 DASHED LT
 STA 261+83 TO 265+00 SOLID LT

DURABLE 8" YELLOW LINE, THERMOPLASTIC
 STA H 37+50 TO H 37+73 SOLID LT & RT (GORE)
 STA 264+77 TO 265+00 SOLID LT & RT (GORE)
 TEMPORARY LETTER OR SYMBOL, PAINT
 STA H 38+43 RT - "STOP"
 STA 260+69 LT - LEFT TURN ARROW
 STA 261+82 LT - THRU/RIGHT TURN ARROW
 STA 264+58 LT - THRU/RIGHT TURN ARROW

DURABLE LETTER OR SYMBOL, THERMOPLASTIC
 STA H 38+43 RT - "STOP"
 STA 260+24 LT - "ONLY"
 STA 260+69 LT - LEFT TURN ARROW
 STA 261+82 LT - THRU/RIGHT TURN ARROW
 STA 262+74 LT - THRU/RIGHT TURN ARROW
 STA 263+66 LT - THRU/RIGHT TURN ARROW
 STA 264+58 LT - THRU/RIGHT TURN ARROW

TEMPORARY 24" STOP BAR, PAINT
 DURABLE 24" STOP BAR, THERMOPLASTIC
 STA H 38+50 TO H 38+54 RT

PAINTED CURB
 STA H 37+73 TO H 38+51 LT (ISLAND)
 STA H 37+73 TO H 38+51 RT (ISLAND)
 STA 260+45 TO 260+75 LT (ISLAND)
 STA 260+45 TO 260+75 LT (ISLAND)
 STA 261+48 TO 261+78 RT (ISLAND)
 STA 261+48 TO 261+78 LT (ISLAND)
 STA 264+46 TO 264+76 LT (ISLAND)
 STA 264+46 TO 264+76 RT (ISLAND)

REMOVAL AND DISPOSAL OF GUARDRAIL
 STA H 37+50.0 TO H 38+89.0 RT
 STA 259+50.0 TO 260+47.0 LT
 STA ~~262+00.0~~ TO 263+38.0 LT
 261+25 37+90 - 38+50 LT
 STEEL BEAM GUARDRAIL, GALVANIZED
 STA H 37+50.0 TO H 38+89.0 RT
 STA 259+50.0 TO 260+47.0 LT
 STA 262+00.0 TO 263+37.5 LT
 37+90 - 38+50 LT
 ANCHOR FOR STEEL BEAM RAIL
 STA 263+37.5 LT

REMOVING SIGNS
 AS SHOWN - 13
 ERECTING SALVAGED SIGNS
 AS SHOWN - 5

TEMPORARY 4" YELLOW LINE, PAINT
 DURABLE 4" YELLOW LINE, THERMOPLASTIC
 STA H 37+50 TO H 37+73 DOUBLE SOLID LT & RT
 STA H 37+73 TO H 38+52 SOLID LT & RT (ISLAND)
 STA 259+50 TO 260+76 SOLID LT (ISLAND)
 STA 259+50 TO 260+76 SOLID LT (ISLAND)
 STA 261+47 TO 264+77 SOLID LT (ISLAND)
 STA 261+47 TO 264+77 SOLID RT (ISLAND)
 STA 264+77 TO 265+00 DOUBLE SOLID RT
 STA 264+77 TO 265+00 DOUBLE SOLID LT

REHAB. DROP INLETS, CATCH BASINS,
 OR MANHOLES, CLASS I, CLASS II OR CLASS III
 STA 261+57 RT (CB)

BITUMINOUS CONCRETE CURB, TYPE A
 STA H 37+50 TO H 38+66 RT
 STA 260+38 TO 260+71 LT

SHOULDER BERM REMOVAL
 STA 261+93 TO 262+00 LT

~~STONE FILL, TYPE I~~
~~STA H 38+67 RT~~

COMMON EXCAVATION
 STA 261+22.0 TO 261+54.5 LT & RT

REMOVING AND RESETTING CURB
 STA 261+48.0 TO 261+54.0 LT & RT

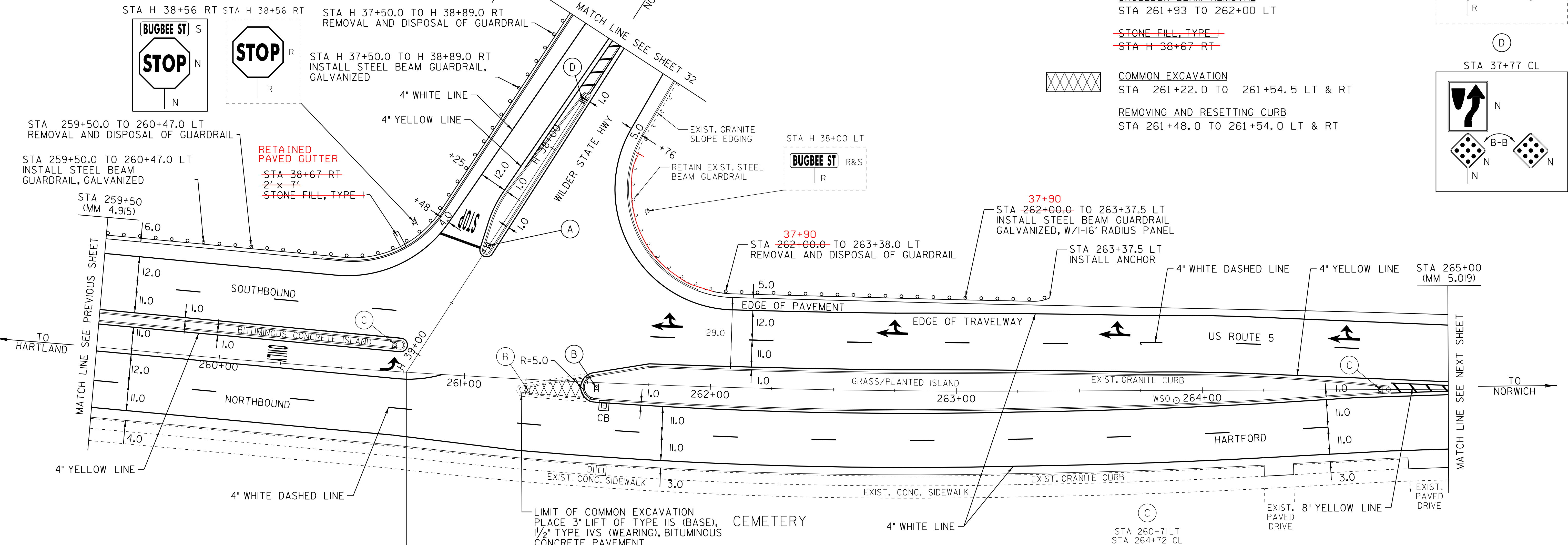
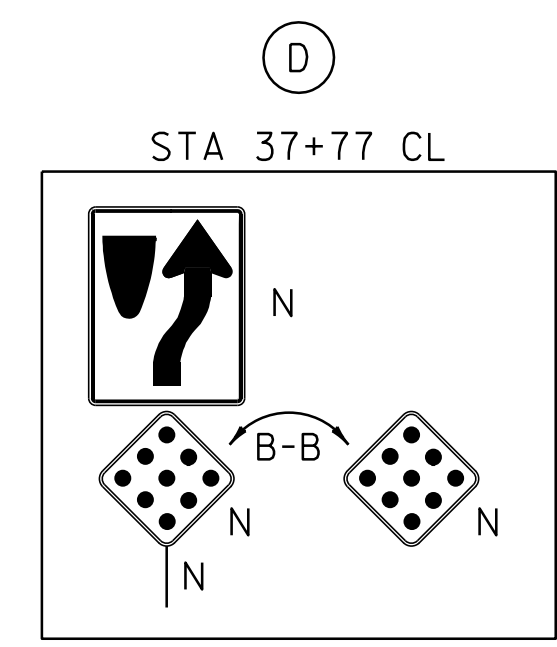
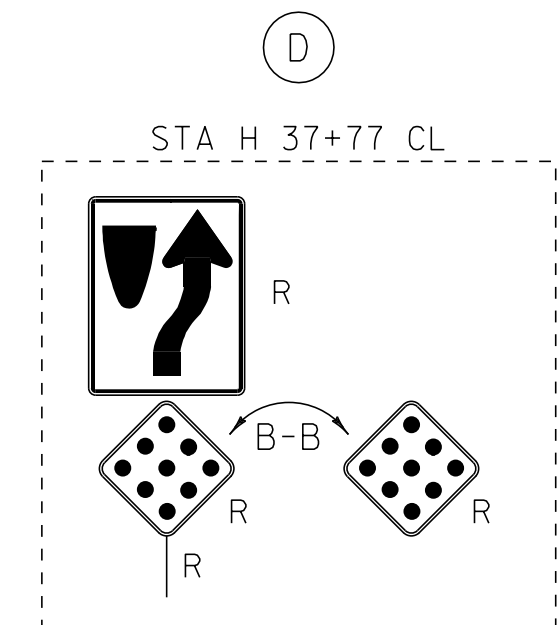

**END STP 2206(1)S
 WILDER STATE HIGHWAY
 STA H 39+08.67
 (MM 0.740)**

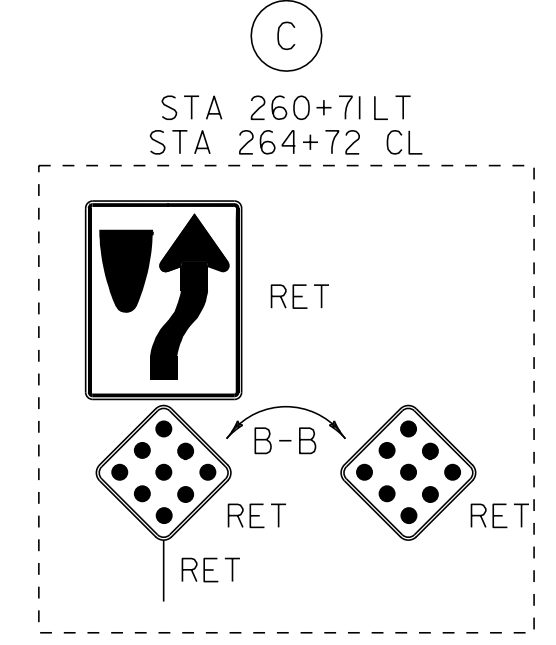
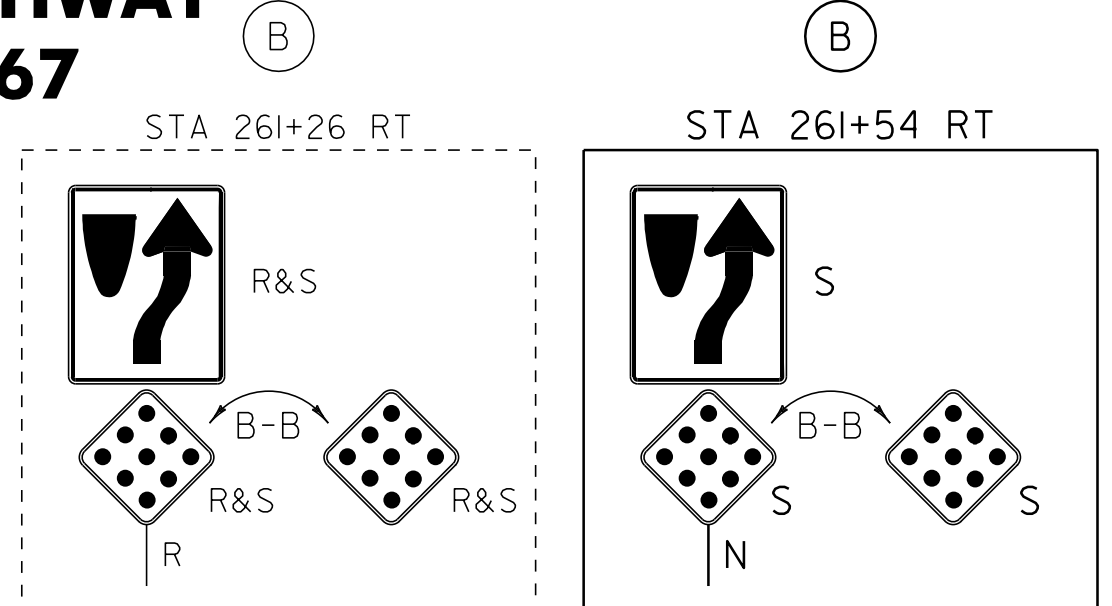
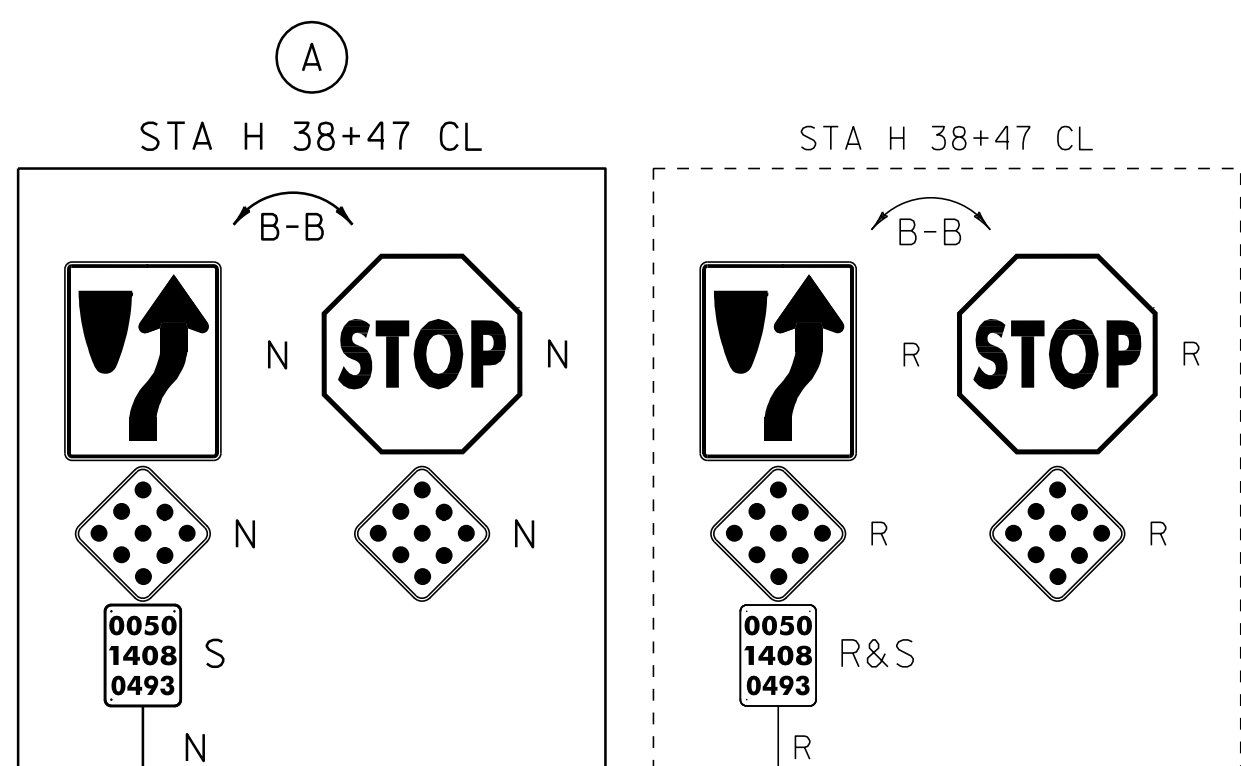

NOTE:
 STA 264+25 TO 265+00 RT
 PAVE TO FACE OF CURB
 OR EXIST. CONCRETE SIDEWALK.

- LEGEND
- R = REMOVE EXISTING
 - S = SALVAGE
 - R&S = REMOVE AND SALVAGE
 - N = NEW
 - RET = RETAIN
 - B-B = BACK TO BACK
 - — — = EXISTING GUARDRAIL
 - - - - = PROPOSED GUARDRAIL
 - ⚡ = TYPE I DELINEATOR, WHITE

PAVING LAYOUT SHEET 11

PROJECT NAME: HARTFORD-NORWICH
 PROJECT NUMBER: STP 2206(1)S

FILE NAME: /pave/99cl64/pci64
 PROJECT LEADER: PTS
 DESIGNED BY: NLL
 IPARM FILE NAME: pci64lall.i

PLOT DATE: 14-FEB-2012 15:50
 DRAWN BY: MRS
 CHECKED BY: NLL
 SHEET 35 OF 137

NOT TO SCALE