

**BEGIN STP 2206(1)S
LOCATION TIES
US ROUTE 5**

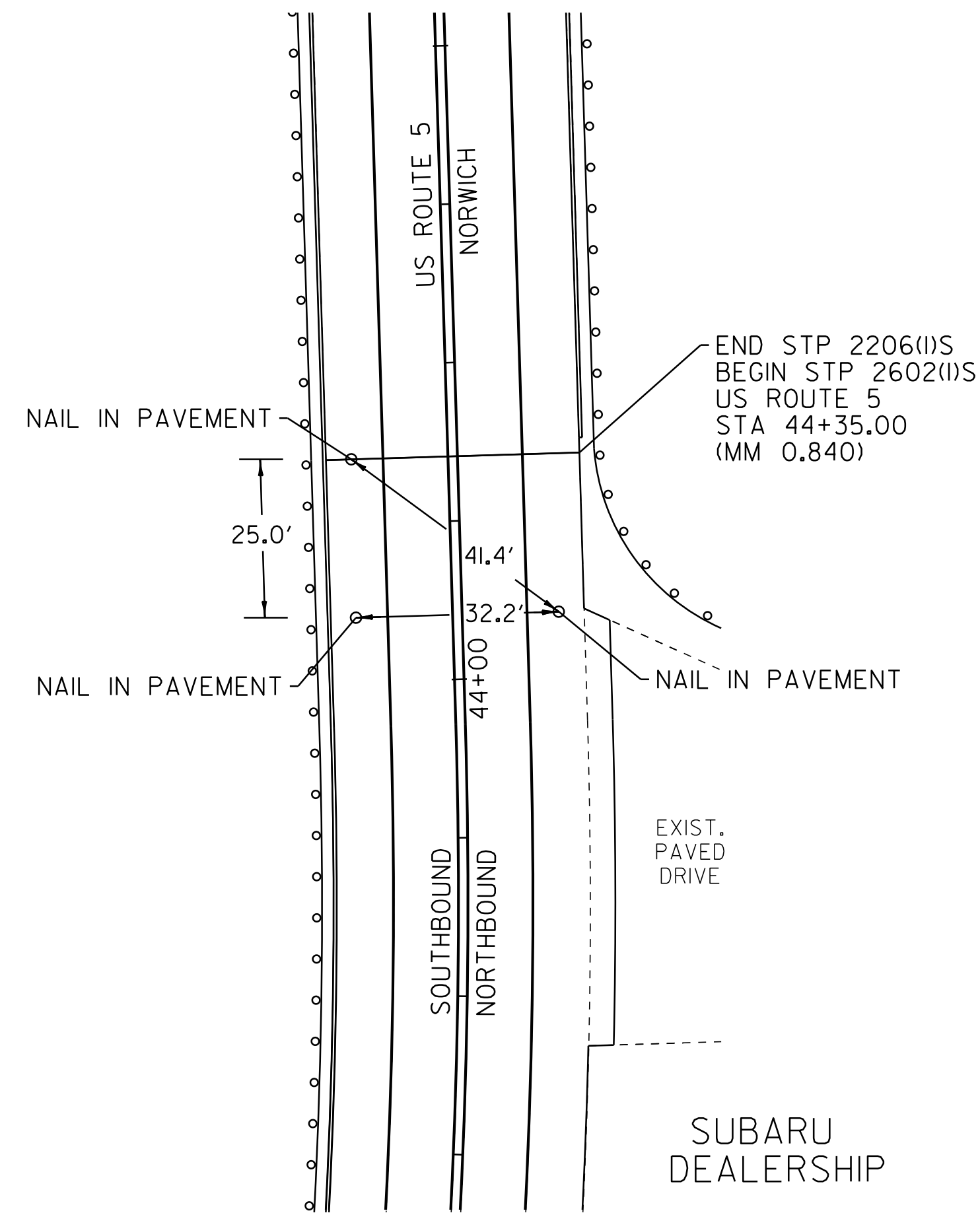

**END STP 2206(1)S
BEGIN STP 2602(1)S
LOCATION TIES
US ROUTE 5**

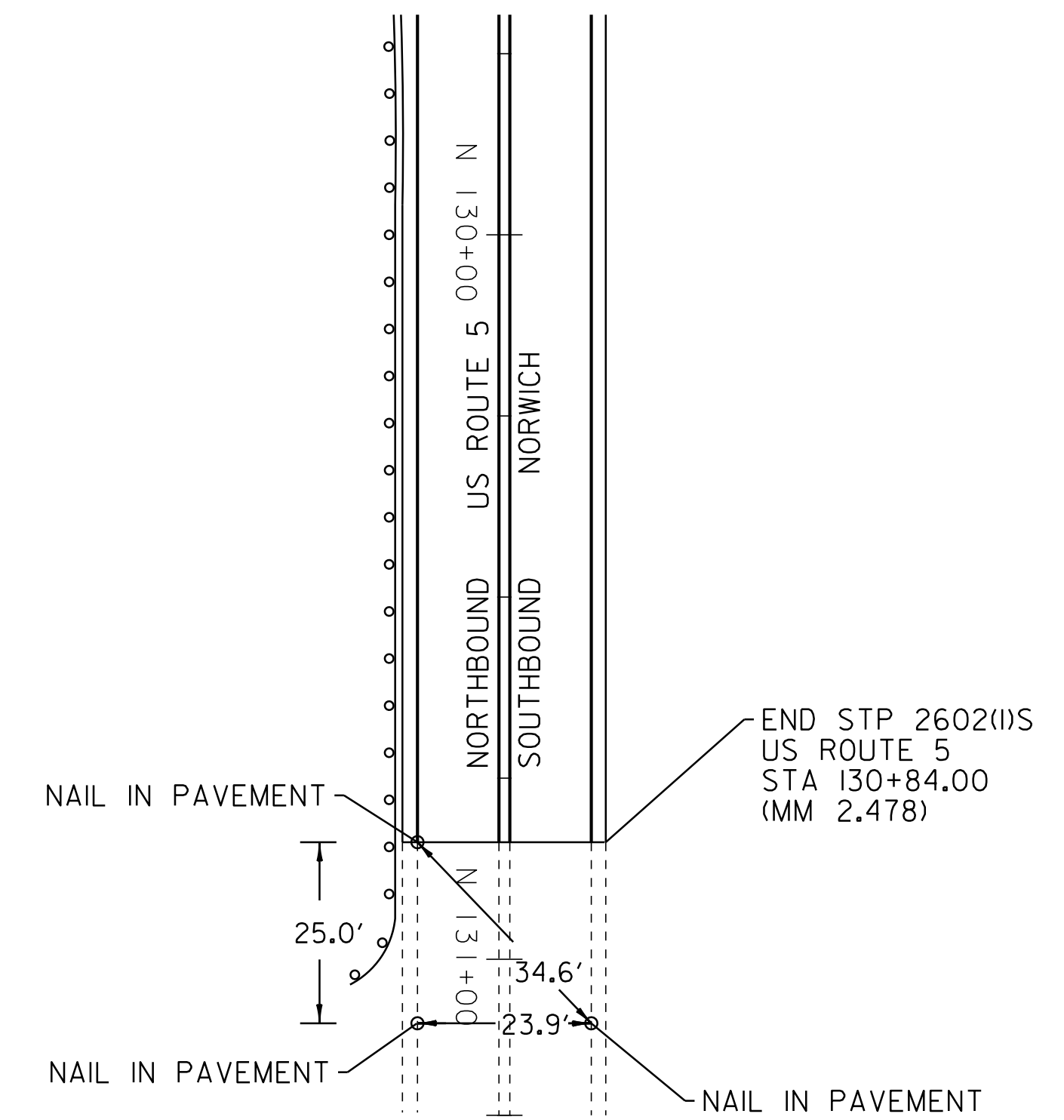

**END STP 2602(1)S
LOCATION TIES
US ROUTE 5**

NOT TO SCALE

**COMPOSITE
PROJECT
TIE
SHEET**

PROJECT NAME: HARTFORD-NORWICH / NORWICH	PLOT DATE: 14-FEB-2012 15:48
PROJECT NUMBER: STP 2206(1)S / STP 2602(1)S	DRAWN BY: MRS
FILE NAME: /pave/99cl64/pcl64	CHECKED BY: NLL
PROJECT LEADER: PTS	SHEET 3 OF 137
DESIGNED BY: NLL	
IPARM FILE NAME: pcl64cptso1.i	