

646.402 DURABLE 4 INCH WHITE LINE, THERMOPLASTIC
 VT. ROUTE 30:
 STA. 14+00.00 - STA. 16+52.64 EDGE LINE, LT/RT

646.412 DURABLE 4 INCH YELLOW LINE, THERMOPLASTIC
 (ALL LINES WILL INCLUDE C/L BREAKS FOR
 TOWN HIGHWAYS)
 VT. ROUTE 30:
 STA. 14+00.00 - STA. 16+52.64 DOUBLE SOLID C/L

646.602 TEMPORARY 4 INCH WHITE LINE, PAINT
 VT. ROUTE 30:
 STA. 14+00.00 - STA. 16+52.64 EDGE LINE, LT/RT

646.612 TEMPORARY 4 INCH YELLOW LINE, PAINT
 (ALL LINES WILL INCLUDE C/L BREAKS FOR
 TOWN HIGHWAYS)
 VT. ROUTE 30:
 STA. 14+00.00 - STA. 16+52.64 DOUBLE SOLID C/L

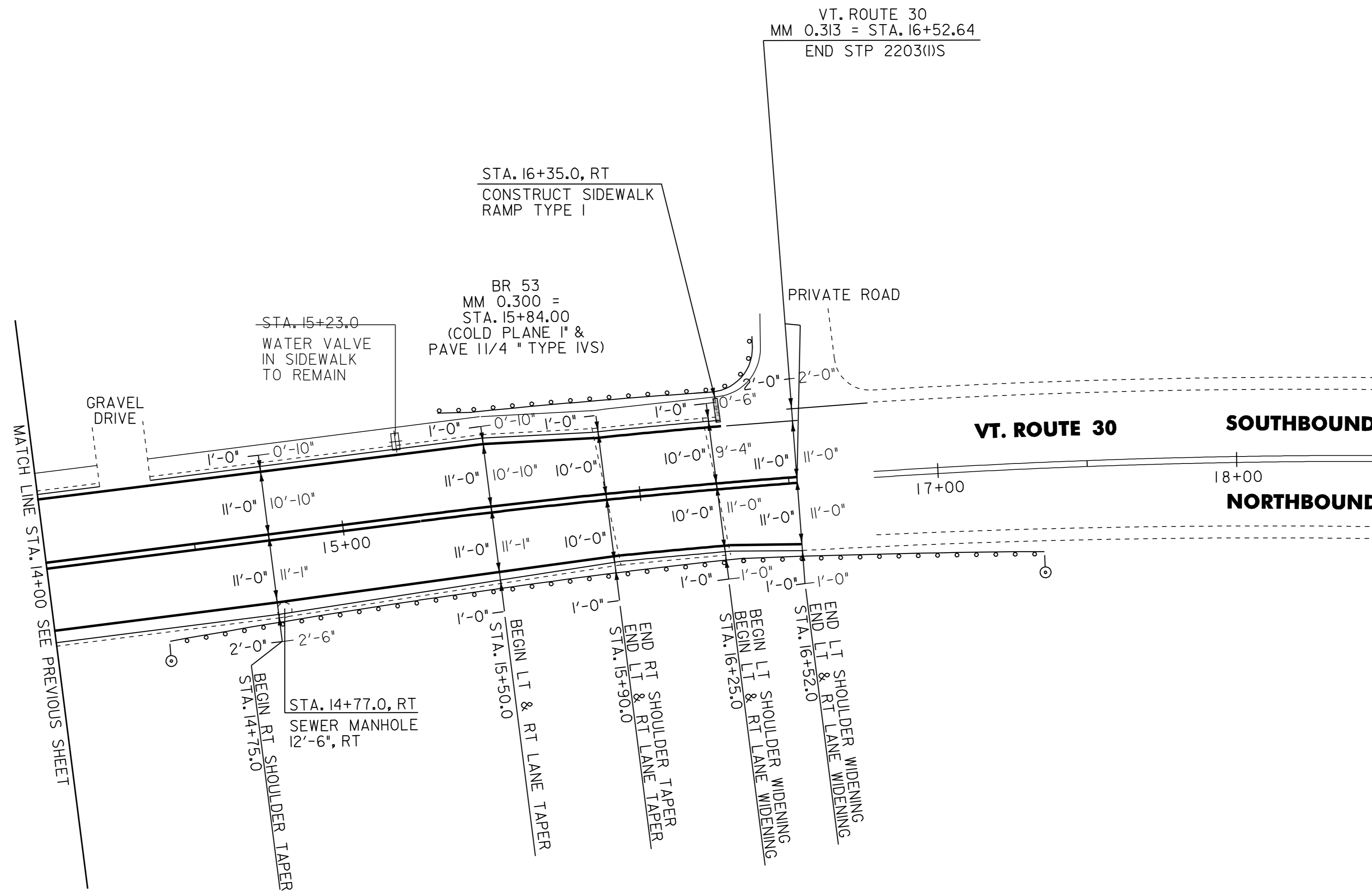

604.42 CHANGING ELEVATION OF SEWER MANHOLES

VT. ROUTE 30:
~~STA. 14+77.0 RT~~

621.20 STEEL BEAM GUARDRAIL, GALVANIZED

VT. ROUTE 30:
 STA. 14+78.0 - STA. 15+65.5 RT (87.5 LF)
 STA. 15+34.0 - STA. 15+48.5 LT (14.5 LF) 16.5
 STA. 16+23.5 - STA. 16+38.0 LT (14.5 LF)
 STA. 16+65.5 - STA. 16+90.5 RT (25.0 LF)
 43.0

621.21 HD STEEL BEAM GUARDRAIL, GALVANIZED

VT. ROUTE 30:
 STA. 15+48.5 - STA. 15+79.5 LT (41.2 LF) 32.5
 STA. 15+65.5 - STA. 15+90.5 RT (32.5 LF)
 STA. 16+34.3 - STA. 16+65.5 RT (41.2 LF) 47.5
 28.0

621.50 MANUFACTURED TERMINAL SECTION, FLARED

VT. ROUTE 30:
 STA. 14+40.5 - STA. 14+78.0 RT
 STA. 16+90.5 - STA. 17+28.0 RT

621.80 REMOVAL AND DISPOSAL OF GUARDRAIL

VT. ROUTE 30:
 STA. 15+34.0 - STA. 15+79.7 LT (45.7 LF)
 STA. 14+42.0 - STA. 15+90.5 RT (148.5 LF)
 STA. 16+23.5 - STA. 16+38.0 LT (14.5 LF)
 STA. 16+34.3 - STA. 17+30.0 RT (95.5 LF)

676.10 DELINEATOR WITH STEEL POST

♀ TYPE I WHITE
 VT. ROUTE 30:
 STA. 14+40.5 RT
 STA. 17+28.0 RT

621.60 ANCHOR FOR STEEL BEAM RAIL

VT. ROUTE 30:
 STA. 15+47 RT
 STA. 15+43 LT

900.540 SUPPLEMENTAL AGREEMENT (525.40 BRIDGE RAIL, GAL. HDSB, CURB MOUNTED (MOD.))

VT. ROUTE 30:
 STA. 15+84 - STA. 16+21 LT (37.5 FT)
 STA. 15+90 - STA. 16+28 RT (37.5 FT)

NOTE:

I. SEE SHEETS 63 AND 64 FOR BR 53 DETAILS.
 SEE SHEET 65 FOR BRIDGE CURB REPAIR
 DETAILS.

NOT TO SCALE

**PROJECT
 LAYOUT
 SHEET #30**

PROJECT NAME: MANCHESTER
 PROJECT NUMBER: STP 2203(I)S

FILE NAME: p99c158.dgn
 PROJECT LEADER: D.E.G.
 DESIGNED BY: M.J.M.
 IPARM FILE: p99c158130.i

PLOT DATE: 09-MAY-2008
 DRAWN BY: C.A.K.
 CHECKED BY: D.W.E.
 SHEET 44 OF 68