

646.402 DURABLE 4 INCH WHITE LINE, THERMOPLASTIC
 HISTORIC VT. ROUTE 7A:
 STA. 252+85.92 LANE LINE RT, TH-44

646.412 DURABLE 4 INCH YELLOW LINE, THERMOPLASTIC
 (ALL LINES WILL INCLUDE C/L BREAKS FOR TOWN HIGHWAYS)
 HISTORIC VT. ROUTE 7A:
 STA. 248+00.00 - STA. 253+40.00 DOUBLE SOLID C/L
 STA. 253+40.00 - STA. 254+00.00 DOUBLE SOLID LT/RT

646.481 DURABLE 24 INCH STOP BAR, TYPE 1 TAPE
 HISTORIC VT. ROUTE 7A:
 STA. 252+85.92 RT, TH-44

646.602 TEMPORARY 4 INCH WHITE LINE, PAINT
 HISTORIC VT. ROUTE 7A:
 STA. 252+85.92 LANE LINE RT, TH-44

646.612 TEMPORARY 4 INCH YELLOW LINE, PAINT
 (ALL LINES WILL INCLUDE C/L BREAKS FOR TOWN HIGHWAYS)
 HISTORIC VT. ROUTE 7A:
 STA. 248+00.00 - STA. 253+40.00 DOUBLE SOLID C/L
 STA. 253+40.00 - STA. 254+00.00 DOUBLE SOLID LT/RT

646.682 TEMPORARY 24 INCH STOP BAR, PAINT
 HISTORIC VT. ROUTE 7A:
 STA. 252+85.92 RT, TH-44

646.491 DURABLE LETTER OR SYMBOL, TYPE 1 TAPE
 HISTORIC VT. ROUTE 7A:
 STA. 252+85.92 RT, TH-44, "S,T,O,P" (8 EA)
 STA. 252+85.92 RT, TH-44, ARROW (2 EA)
 646.501 DURABLE CROSSWALK MARKING, TYPE 1 TAPE
 HISTORIC VT. ROUTE 7A:
 STA. 250+30.00 LT/RT
 STA. 251+99.00 LT/RT
 STA. 252+85.92 RT, TH-44

646.692 TEMPORARY LETTER OR SYMBOL, PAINT
 HISTORIC VT. ROUTE 7A:
 STA. 252+85.92 RT, TH-44, "S,T,O,P" (16 EA)
 STA. 252+85.92 RT, TH-44, ARROW (4 EA)
 646.702 TEMPORARY CROSSWALK MARKING, PAINT
 HISTORIC VT. ROUTE 7A:
 STA. 250+30.00 LT/RT
 STA. 251+99.00 LT/RT
 STA. 252+85.92 RT, TH-44

675.50 REMOVING SIGNS
 AS SHOWN - 8
 675.60 ERECTING SALVAGED SIGNS
 AS SHOWN - 2

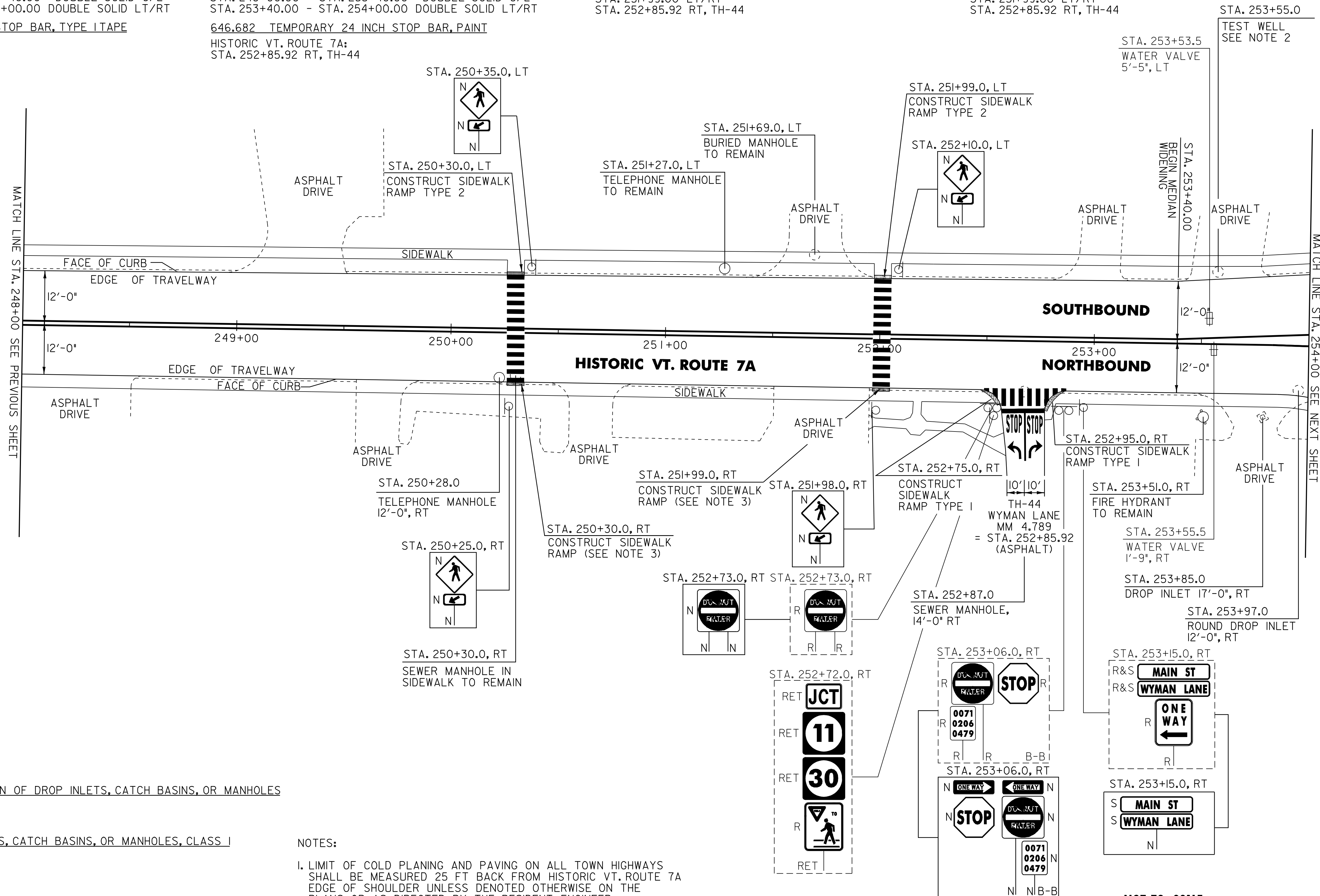

604.40 CHANGING ELEVATION OF DROP INLETS, CATCH BASINS, OR MANHOLES
 HISTORIC VT. ROUTE 7A:
~~STA. 250+28.0 RT~~

604.412 REHAB. DROP INLETS, CATCH BASINS, OR MANHOLES, CLASS I
 HISTORIC VT. ROUTE 7A:
~~STA. 253+85.0 RT~~
 STA. 253+97.0 RT

604.42 CHANGING ELEVATION OF SEWER MANHOLES
 HISTORIC VT. ROUTE 7A:
~~STA. 252+87.0 RT~~

629.20 ADJUST ELEVATION OF VALVE BOX
 HISTORIC VT. ROUTE 7A:
 STA. 253+53.5 LT
 STA. 253+55.5 RT

NOTES:

- LIMIT OF COLD PLANING AND PAVING ON ALL TOWN HIGHWAYS SHALL BE MEASURED 25 FT BACK FROM HISTORIC VT. ROUTE 7A EDGE OF SHOULDER UNLESS DENOTED OTHERWISE ON THE PLANS OR AS DIRECTED BY THE RESIDENT ENGINEER.
- THE CONTRACTOR MUST USE CARE WHEN COLD PLANING AROUND THE EXISTING TEST WELL TO AVOID DAMAGING IT. IF DAMAGE SHOULD OCCUR DURING COLD PLANING, THE CONTRACTOR SHALL REPAIR THE WELL AS DIRECTED BY THE RESIDENT ENGINEER AT NO COST TO THE STATE OF VERMONT.
- SEE SHEET 67 FOR SIDEWALK RAMP DETAIL 2.

SIGN LEGEND
 R = REMOVE
 S = SALVAGE
 N = NEW
 RET = RETAIN
 B-B = BACK TO BACK
 EXISTING = - - - - -
 NEW = _____

NOT TO SCALE

PROJECT LAYOUT SHEET #18	PROJECT NAME: MANCHESTER	PLOT DATE: 09-MAY-2008
	PROJECT NUMBER: STP 2203(1)S	DRAWN BY: C.A.K.
	FILE NAME: p99c158.dgn	CHECKED BY: D.W.E.
	DESIGNED BY: M.J.M.	SHEET 32 OF 68
	IPARM FILE: p99c158i18.i	