

646.41 DURABLE 100 mm YELLOW LINE
 STA. SR0+000.000 - STA. SR0+251.723 DOUBLE SOLID (CENTER LINE)
 STA. 16+695.000 - STA. 16+960.000 DOUBLE SOLID (CENTER LINE)

646.40 DURABLE 100 mm WHITE LINE
 STA. SR0+000.000 - STA. SR0+251.723 SOLID LT & RT (EDGE LINE)
 STA. 16+695.000 - STA. 16+960.000 DASHED 3.6 m LT (LANE LINE)
 STA. 16+695.000 - STA. 16+960.000 SOLID LT & RT (EDGE LINE)
 STA. 16+695.000 - STA. 16+866.000 DOTTED 3.6 m RT (LANE LINE)
 STA. 16+866.000 - STA. 16+960.000 DASHED 3.6 m RT (LANE LINE)

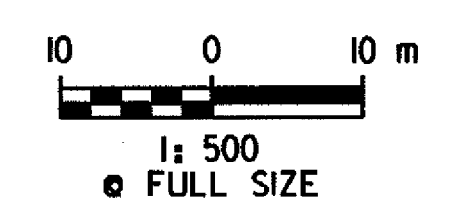
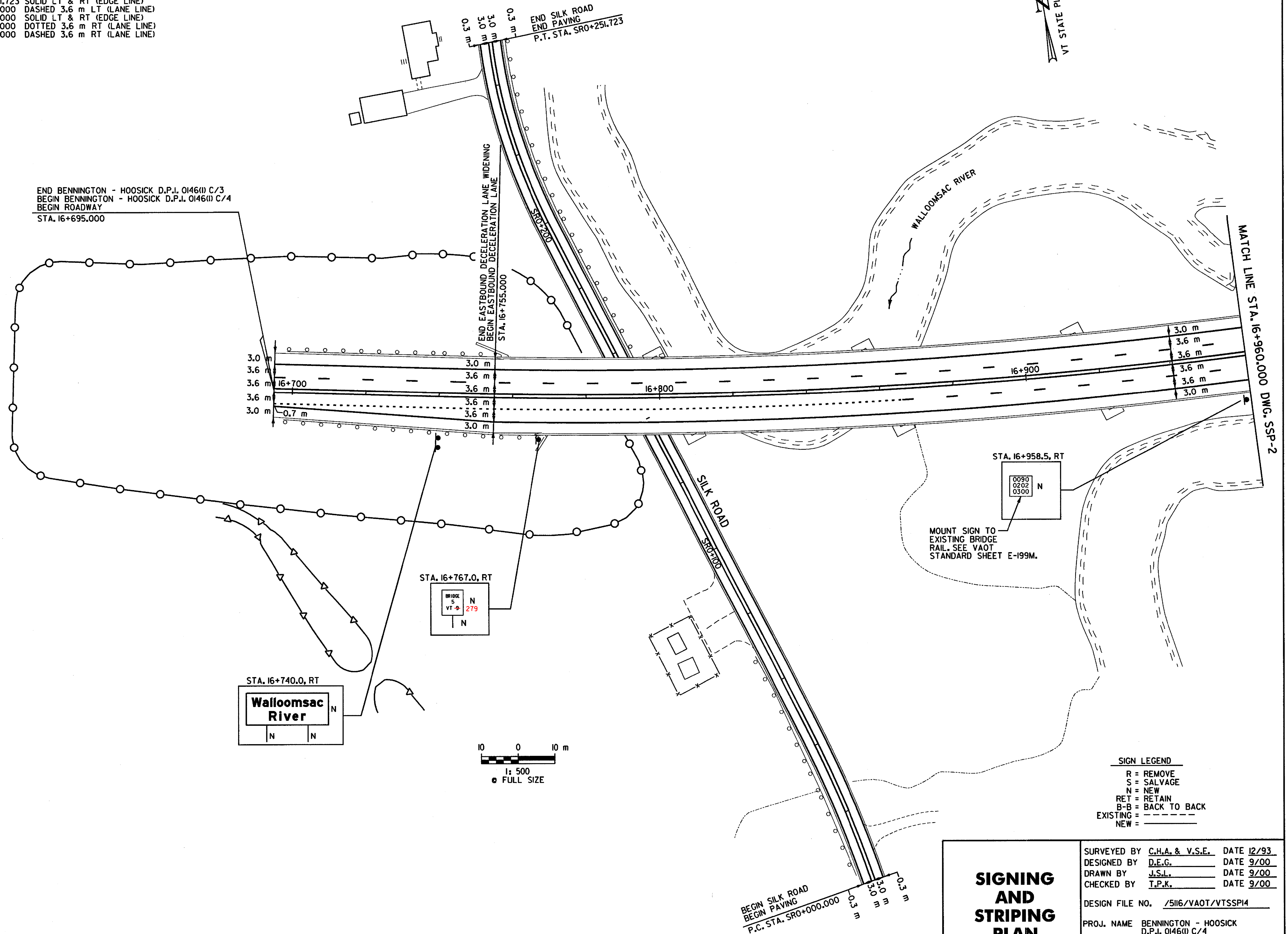
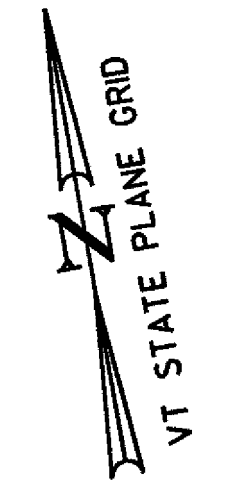

SIGN LEGEND

R = REMOVE
 S = SALVAGE
 N = NEW
 RET = RETAIN
 B-B = BACK TO BACK
 EXISTING = - - - - -
 NEW = _____

SIGNING AND STRIPING PLAN	SURVEYED BY	C.H.A. & V.S.E.	DATE	12/93
	DESIGNED BY	D.E.G.	DATE	9/00
	DRAWN BY	J.S.L.	DATE	9/00
	CHECKED BY	T.P.K.	DATE	9/00
DESIGN FILE NO.		/5116/VAOT/VTSSP14		
PROJ. NAME		BENNINGTON - HOOSICK D.P.I. 0146(I) C/4		
PROJ. NO.		P.I.N. 1306.60		
DWG NO. SSP-1		SHEET 131 OF 385		

FILE NAME = u:\5116\vaot\contract4\vtssp14.dgn
 DATE/TIME = 08 SEP 2000
 USER = 1459

DATUM	
VERTICAL	NAVD 88
HORIZONTAL	NAD 83 (1992)