

DETOUR 2 LAYOUT

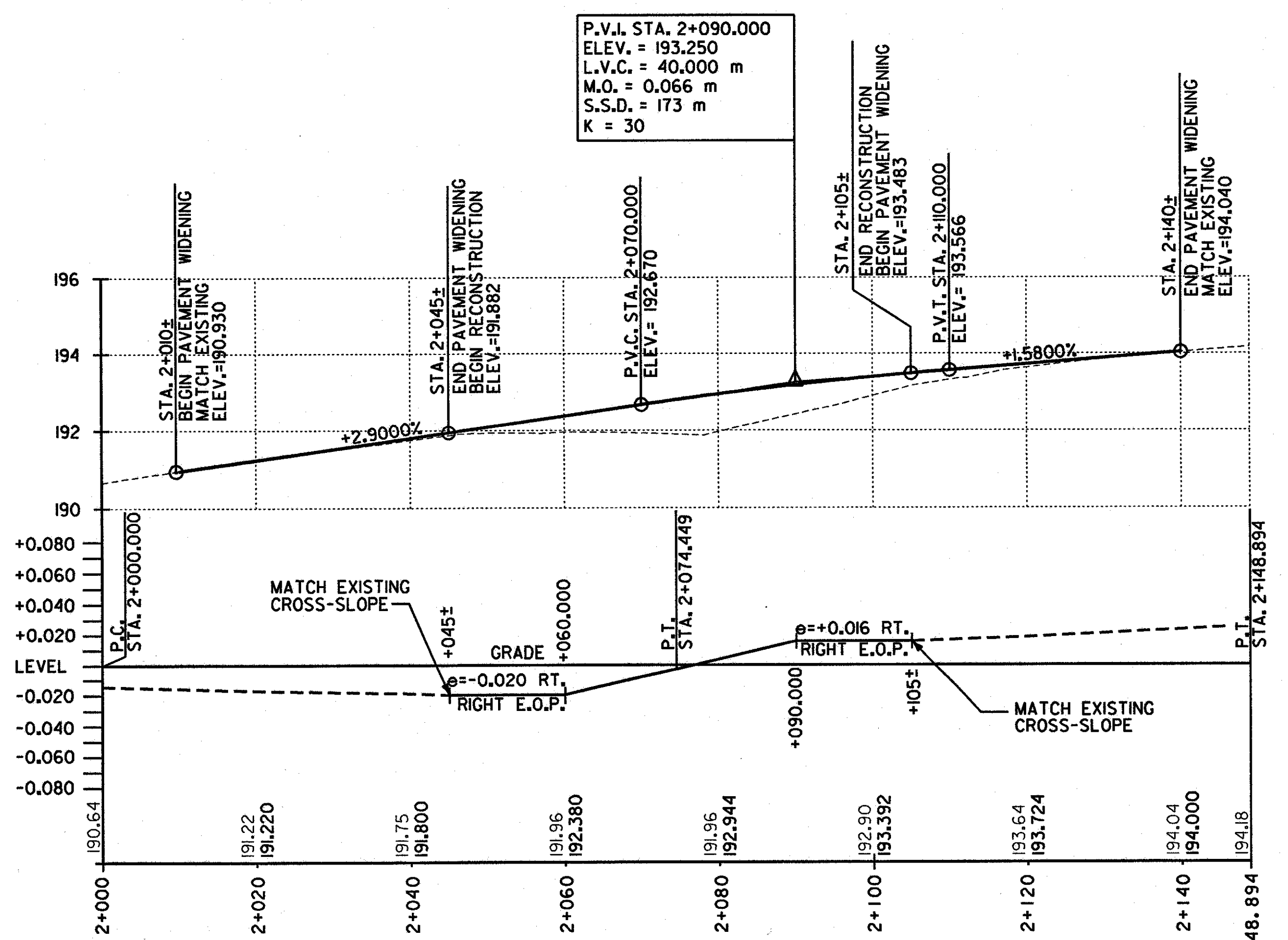
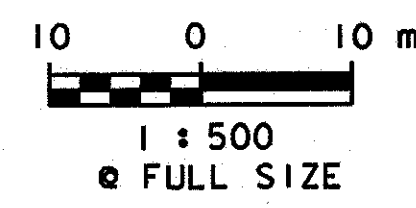

DETOUR 2 PROFILE / BANKING DIAGRAM

DATUM	
VERTICAL	NAVD 88
HORIZONTAL	NAD 83 (1992)

FILE NAME = u:\5116\vaot\contr\act4\csp\csp-3.dgn
 DATE/TIME = 07 SEP 2000
 USER = 11459

TYPICAL SECTIONS - DETOUR 1 AND DETOUR 2

- 50 SUPERPAVE BITUMINOUS CONCRETE PAVEMENT (PG 58-28) TYPE III S
- 100 BASE COURSE, SUPERPAVE BITUMINOUS CONCRETE PAVEMENT (PG 58-28) TYPE IS
- 300 SUBBASE OF CRUSHED GRAVEL (COARSE GRADED)

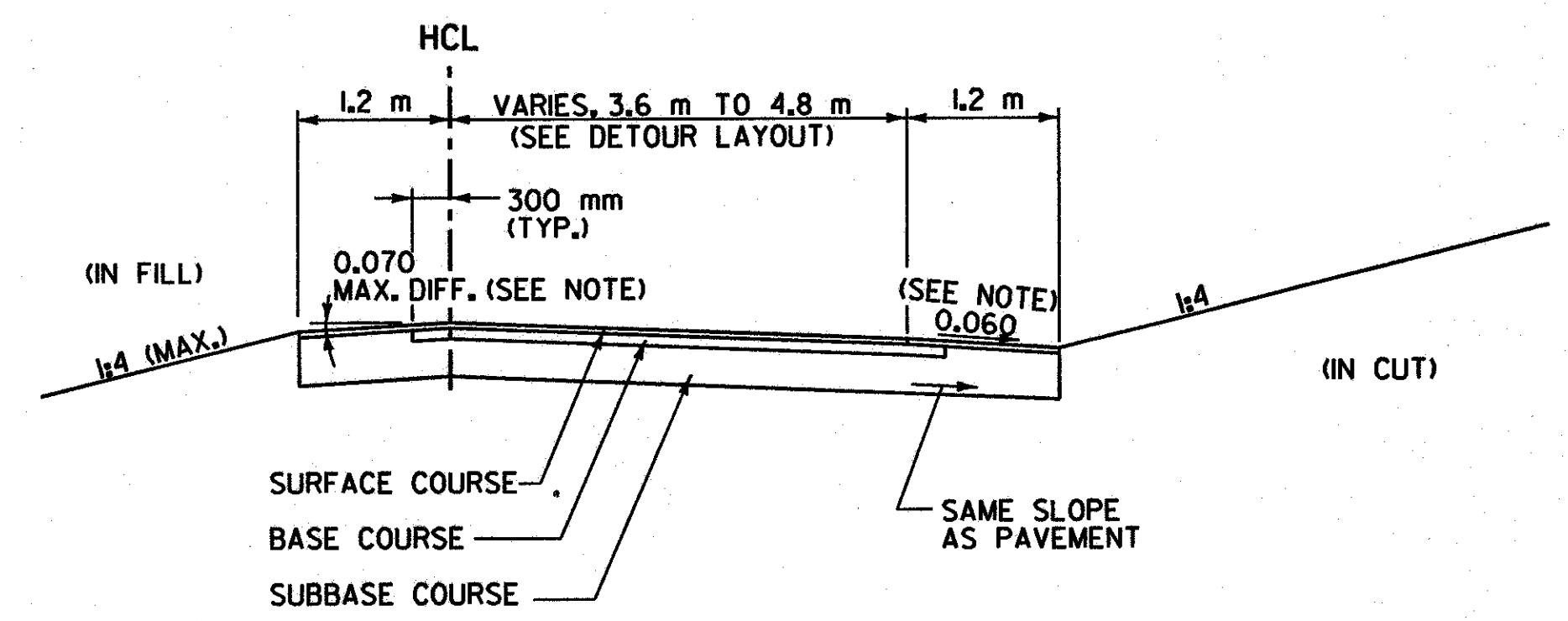

DETOUR 1 / DETOUR 2 TYPICAL RECONSTRUCTION SECTION - BANKED RIGHT (SEE NOTE)

N.T.S.

NOTE: FOR A 'BANKED LEFT' ROADWAY, THE LEFT SHOULDER SLOPE WILL BE 0.060 (DOWN LEFT) AND THE RIGHT SHOULDER WILL BE BANKED RIGHT WITH A 0.070 MAXIMUM DIFFERENCE.

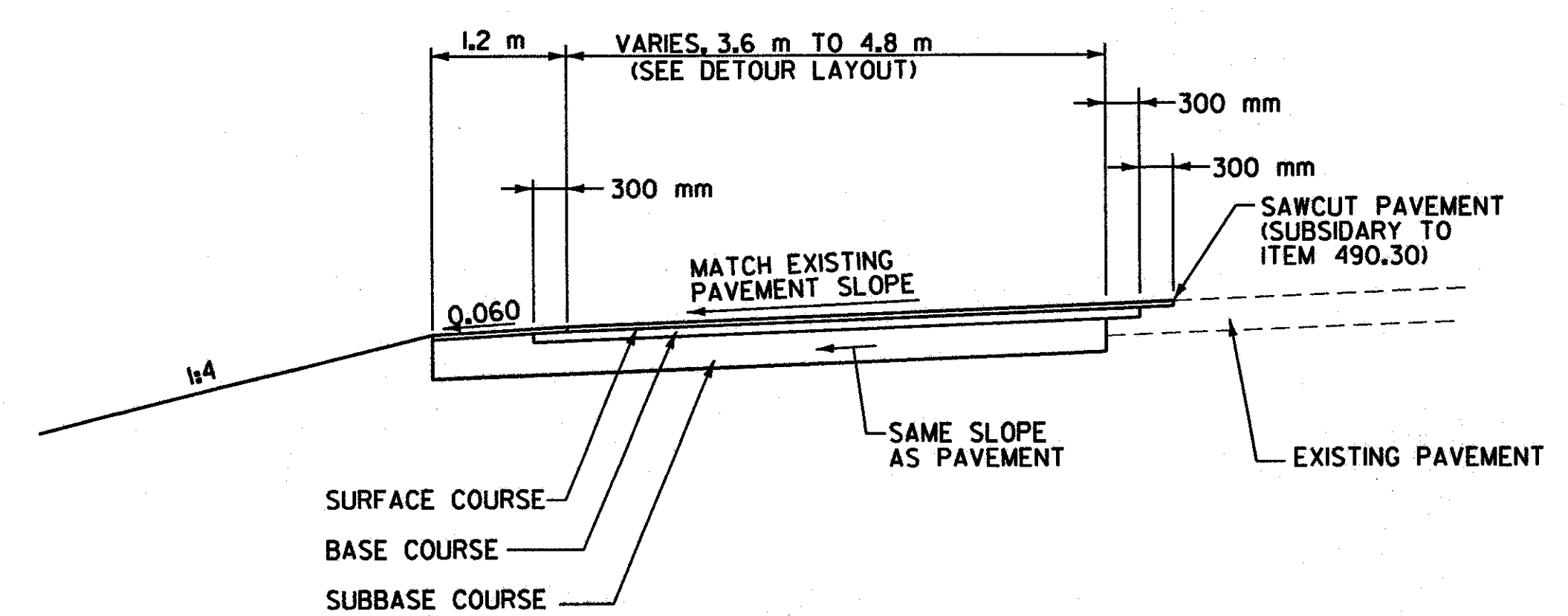

DETOUR 1 / DETOUR 2 TYPICAL WIDENING SECTION

N.T.S.

CONSTRUCTION SEQUENCING PHASE 2	SURVEYED BY	C.H.A. & V.S.E.	DATE	12/93
	DESIGNED BY	T.Y.B.	DATE	9/00
	DRAWN BY	K.H.D.	DATE	9/00
	CHECKED BY	T.P.K.	DATE	9/00
	DESIGN FILE NO.	5116/VAOT/CSP/CSP-3.DGN		
PROJ. NAME	BENNINGTON - HOOSICK D.P.L. 0146(II) C/4			
PROJ. NO.	P.L.N 1306.60			
DWG NO. CSP-5				SHEET 102 OF 385