

**PHASE 2 CONSTRUCTION NOTES:**

1. INSTALL PORTABLE CHANGEABLE MESSAGE SIGNS ON VT. ROUTE 67A NORTHBOUND, VT. ROUTE 67A SOUTHBOUND, AND VT. ROUTE 9 WESTBOUND. THESE SIGNS ARE INTENDED TO INFORM MOTORISTS OF LANE CLOSURES, NEW TRAFFIC PATTERNS AND OTHER TRAFFIC INFORMATION DEEMED NECESSARY BY THE RESIDENT ENGINEER.
2. USING SHORT DURATION SHOULDER CLOSURES (SEE VAOT STANDARD SHEET E-1111), CONSTRUCT TEMPORARY DETOUR 1 AND DETOUR 2.

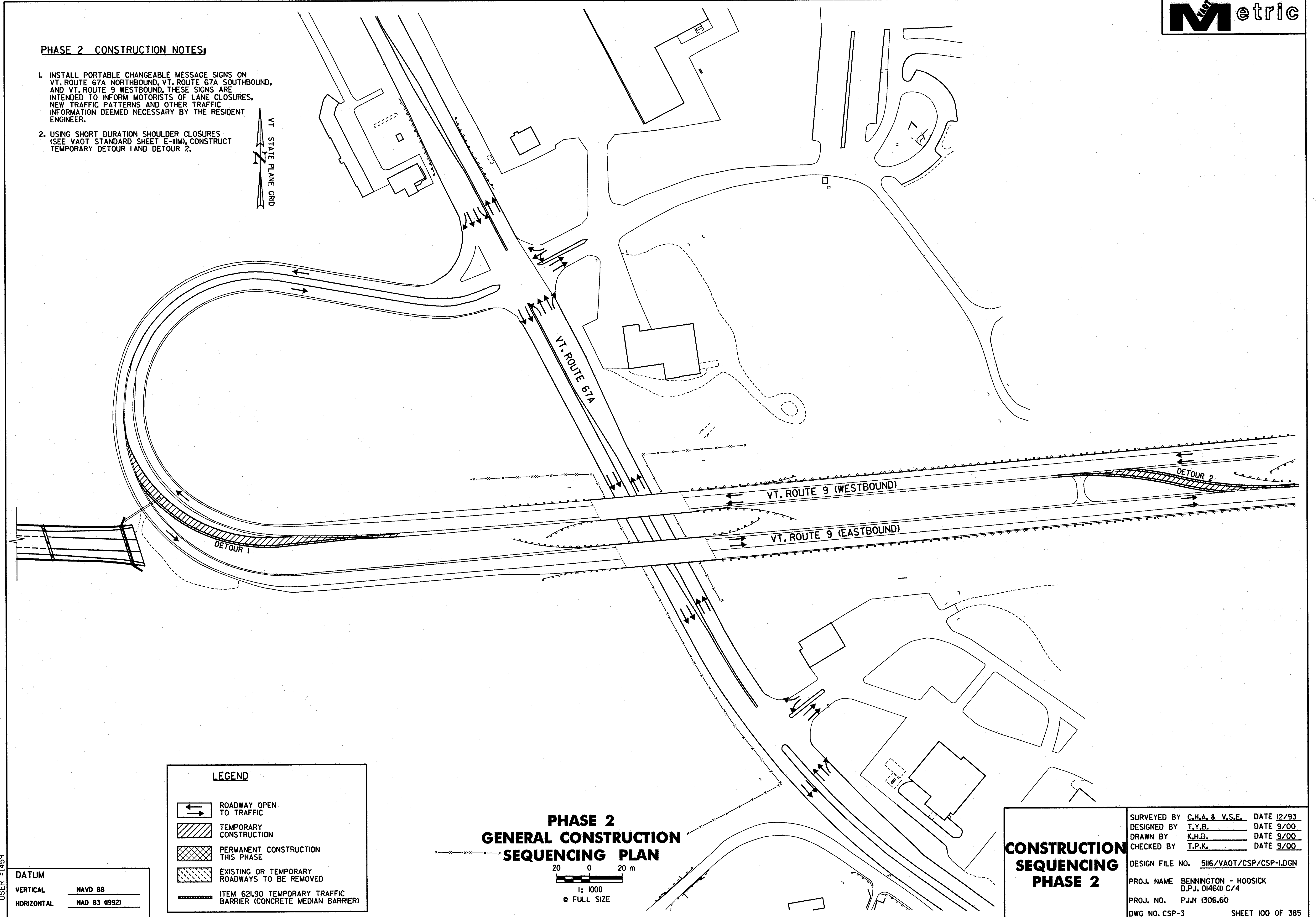

**LEGEND**

	ROADWAY OPEN TO TRAFFIC
	TEMPORARY CONSTRUCTION
	PERMANENT CONSTRUCTION THIS PHASE
	EXISTING OR TEMPORARY ROADWAYS TO BE REMOVED
	ITEM 621.90 TEMPORARY TRAFFIC BARRIER (CONCRETE MEDIAN BARRIER)

**PHASE 2  
GENERAL CONSTRUCTION  
SEQUENCING PLAN**

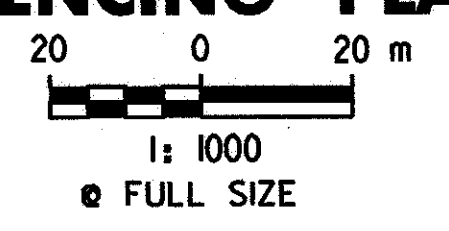

**DATUM**

VERTICAL	NAVD 88
HORIZONTAL	NAD 83 (992)

**CONSTRUCTION SEQUENCING PHASE 2**

SURVEYED BY	C.H.A. & V.S.E.	DATE	12/93
DESIGNED BY	T.Y.B.	DATE	9/00
DRAWN BY	K.H.D.	DATE	9/00
CHECKED BY	T.P.K.	DATE	9/00
DESIGN FILE NO.	5116/VAOT/CSP/CSP-LDGN		
PROJ. NAME	BENNINGTON - HOOSICK D.P.I. 0146(I) C/4		
PROJ. NO.	P.I.N 1306.60		
DWG NO. CSP-3	SHEET 100 OF 385		

FILE NAME =u:\5116\vaot\contract4\csp\csp-1.dgn  
 DATE/TIME =07 SEP 2000  
 USER =1459