

$C = 155 \text{ } 86.40 \text{ m}^2$   
 $F = 36 \text{ } 43.66 \text{ m}^2$   
 $R = 29 \text{ } 74.96 \text{ m}^2$   
 AESTHETIC FILL =  $69 \text{ } 68.39 \text{ m}^2$

O.G.	DH	1/1/03
Rock	DH	1/16/03
TEMP.		
FG	BL	3/10/05

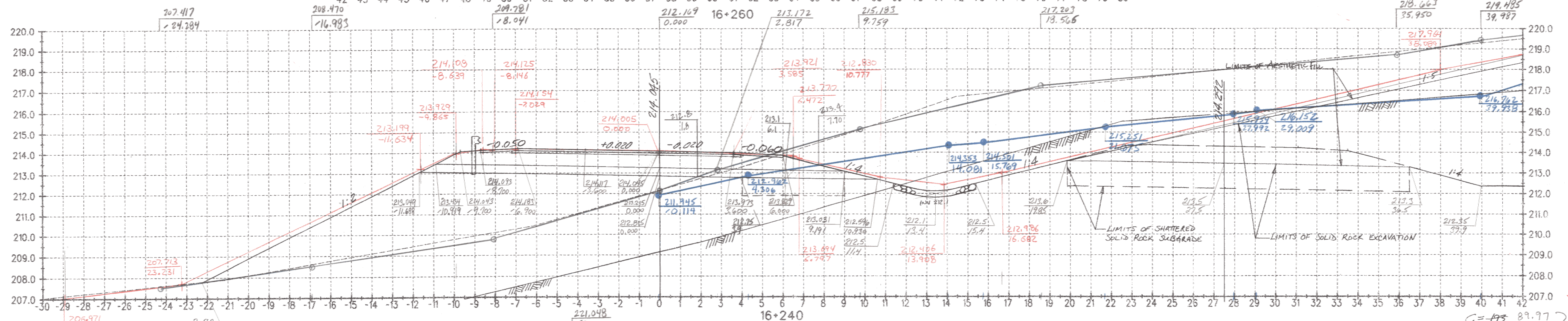
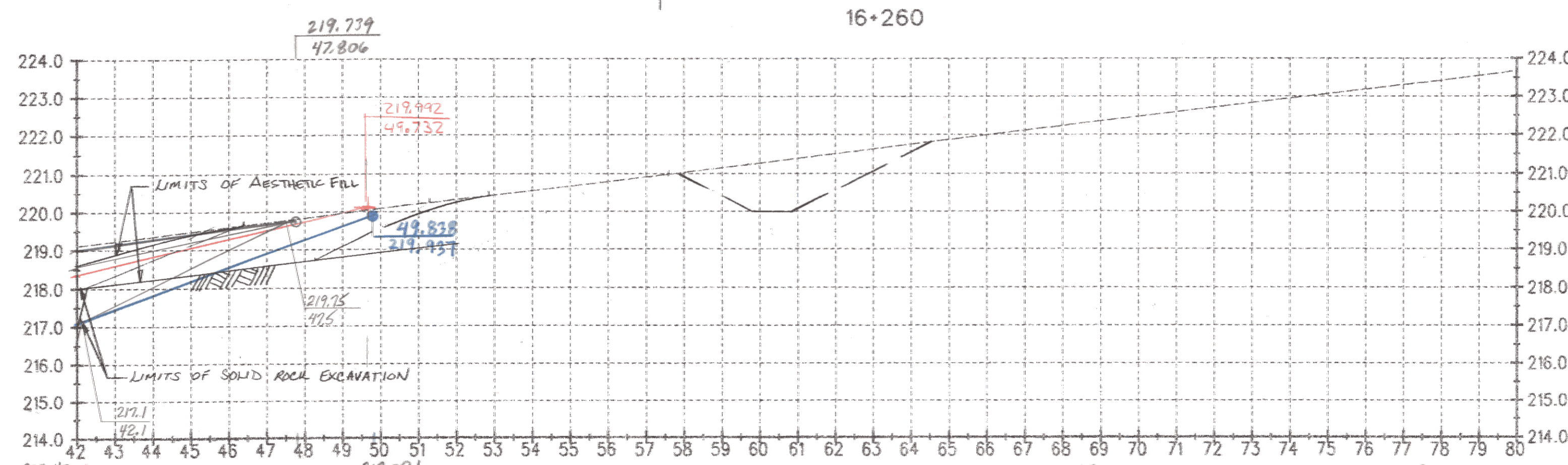

$C = 195 \text{ } 89.97 \text{ m}^2$   
 $F = 47 \text{ } 49.25 \text{ m}^2$   
 $R = 25 \text{ } 99.79 \text{ m}^2$   
 AESTHETIC FILL =  $88 \text{ } 89.67 \text{ m}^2$

O.G. Drawn By: DH 1/14/03



SURVEYED BY	C.H.A. & V.S.E.	DATE	6/95
DESIGNED BY	D.E.G.	DATE	6/95
DRAWN BY	J.S.L.	DATE	6/95
CHECKED BY	T.P.K.	DATE	6/95
DESIGN FILE NO.	N/A		
PROJ. NAME	BENNINGTON - HOOSICK		
	D.P. 1. 0146(1) C/3		
PROJ. NO.	P.I.N. 1306.60.201		
SHEET 444	OF 473	SHEETS	DWG No.

ALL DIMENSIONS IN MILLIMETERS EXCEPT AS INDICATED  
  
 H 1:100  
 V 1:100

DATUM	
VERTICAL	NAVD 88
HORIZONTAL	NAD 83 (1992)