

DECK POUR SEQUENCE
N.T.S.

DECK POUR SEQUENCE NOTES:

1. CONCRETE DECK SHALL BE POURED FOLLOWING THE DECK POUR SEQUENCE DIAGRAM.
2. DIRECTION OF POUR IS INDICATED BY THE ARROWS.
3. ONCE PLACEMENT OF A SECTION HAS STARTED, IT SHALL BE COMPLETED WITHOUT INTERRUPTION.
4. POURS 2a AND 2b SHALL NOT BE STARTED UNTIL 72 HOURS AFTER COMPLETION OF POUR 1.
5. POURS 2a AND 2b MAY BE PLACED SIMULTANEOUSLY OR CONSECUTIVELY WITH THE CONCRETE REMAINING PLASTIC THROUGHOUT THE PLACEMENT.

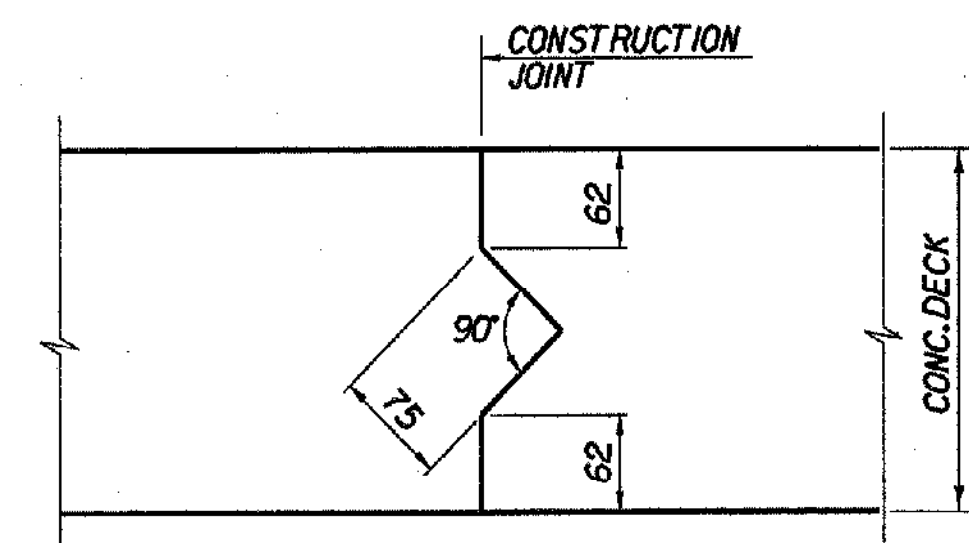

DECK CONSTRUCTION JOINT
N.T.S.

NOTES:

1. FOR ADDITIONAL DECK REINFORCEMENT PLACEMENT AT RAIL POST ANCHORAGE, SEE STD. BRI-97M.
2. ALL DECK REINFORCEMENT BARS SHALL BE EPOXY COATED.

CURB AND RAILING NOTES:

1. THE 600 mm CURB SHALL BE PLACED IN 450 m MAX. SECTIONS AS PER SHEET BR522. CURB JOINT DETAILS. PLACEMENT DETAILS FOR THE CURB SHALL BE SUBMITTED TO THE BRIDGE RAILING FABRICATOR BY THE CONTRACTOR.
2. BRIDGE RAIL POSTS SHALL BE 500 mm MINIMUM FROM CURB CONSTRUCTION JOINTS (UNLESS OTHERWISE NOTED).
3. FOR CURB JOINT DETAILS AND CURB DETAILS, SEE SHT. BR522 AND STD. BRI-97M.
4. FOR BRIDGE RAILING DETAILS, SEE STD. BRI-97M.
5. FOR APPROACH RAIL DETAILS, SEE DWG. NO. MD-3 & MD-4.

BRIDGE DECK CONC. PLACED AS ONE POUR
JFW 2/2/06
BRIDGE DECK REINF. LENGTH CHANGES
JFW 2/2/06

BRIDGE DECK REINFORCEMENT PLAN

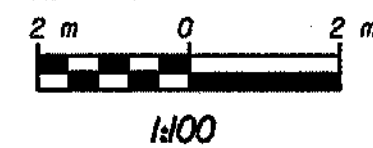

** BRIDGE DECK REINF. LENGTHS WERE CHANGED AS PER CHA LETTER DATED 6/17/03 JFW 2/2/06

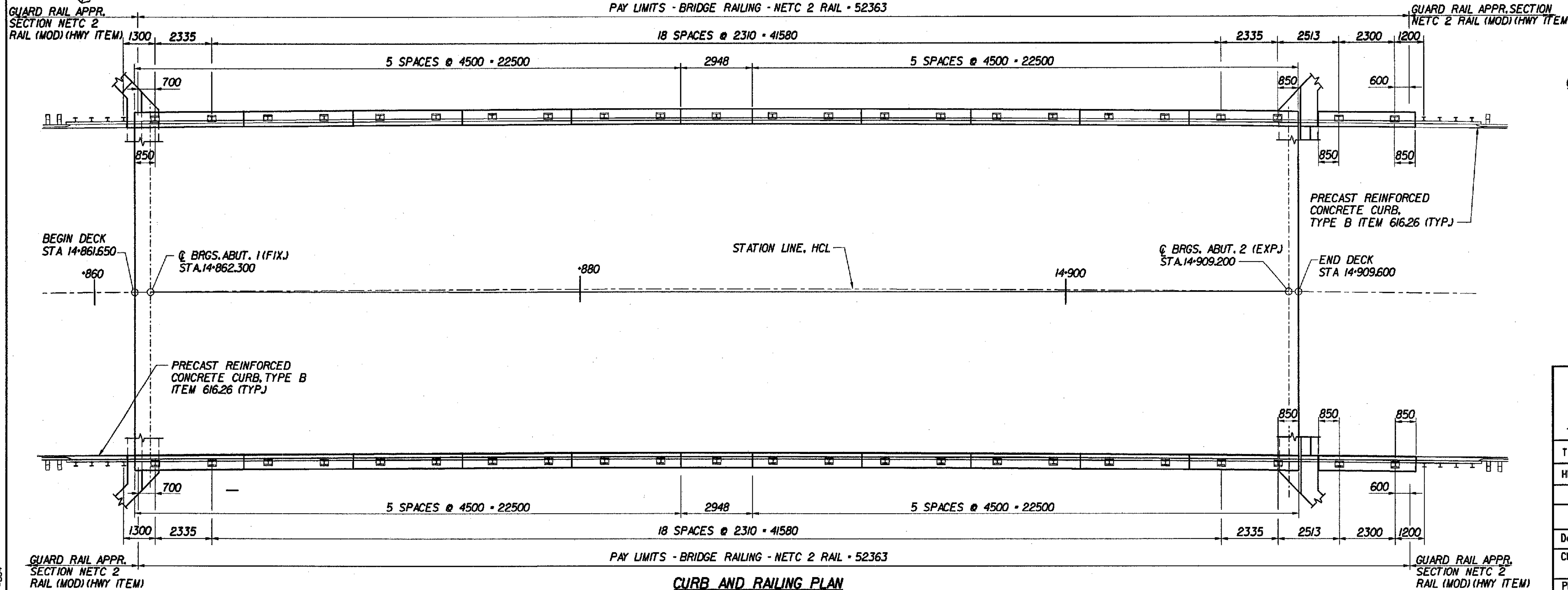
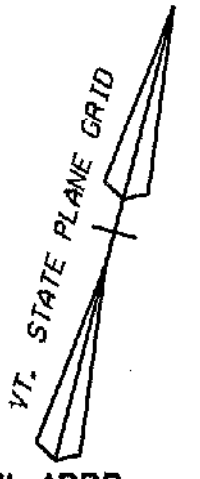

CURB AND RAILING PLAN

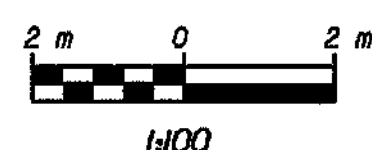

**STATE OF VERMONT
AGENCY OF TRANSPORTATION**

Town Of	BENNINGTON	Bridge No.	BR500
Highway No.	VT. RTE. 9	Log Sta.	
		Surv. Sta.	14+900
VT. RTE. 9 OVER AIRPORT BROOK EAST			
DECK REINFORCEMENT AND RAILING PLAN			
Designed By	M. GOGUEN	Drawn by	B. WEATHERBY
Checked By	P. PERKINS	Date	11/01
		Bridge Design Supervisor	M. OLSTAD
		Date	11/01
PROJECT	BENNINGTON-HOOSICK	PROJECT NO.	D.P.J. 0146(II)
I.G.C. Info.			
Bridge Sheet No.	BR510	Sheet	240 OF 473



FILE NAME: S:\A\3727A\14-5100\decks\plan.rvt
DATE/TIME: 10/11/2001
USER: BSB