

676.10 DELINEATORS W/ STEEL POSTS

- 8 TYPE II, DOUBLE WHITE
- STA. 12+470.0 RT STA. 12+620.0 RT
- STA. 12+500.0 RT STA. 12+650.0 RT
- STA. 12+530.0 RT STA. 12+680.0 RT
- STA. 12+560.0 RT STA. 12+710.0 RT
- STA. 12+590.0 RT STA. 12+740.0 RT
- TYPE I, AMBER
- STA. 12+767.0 RT

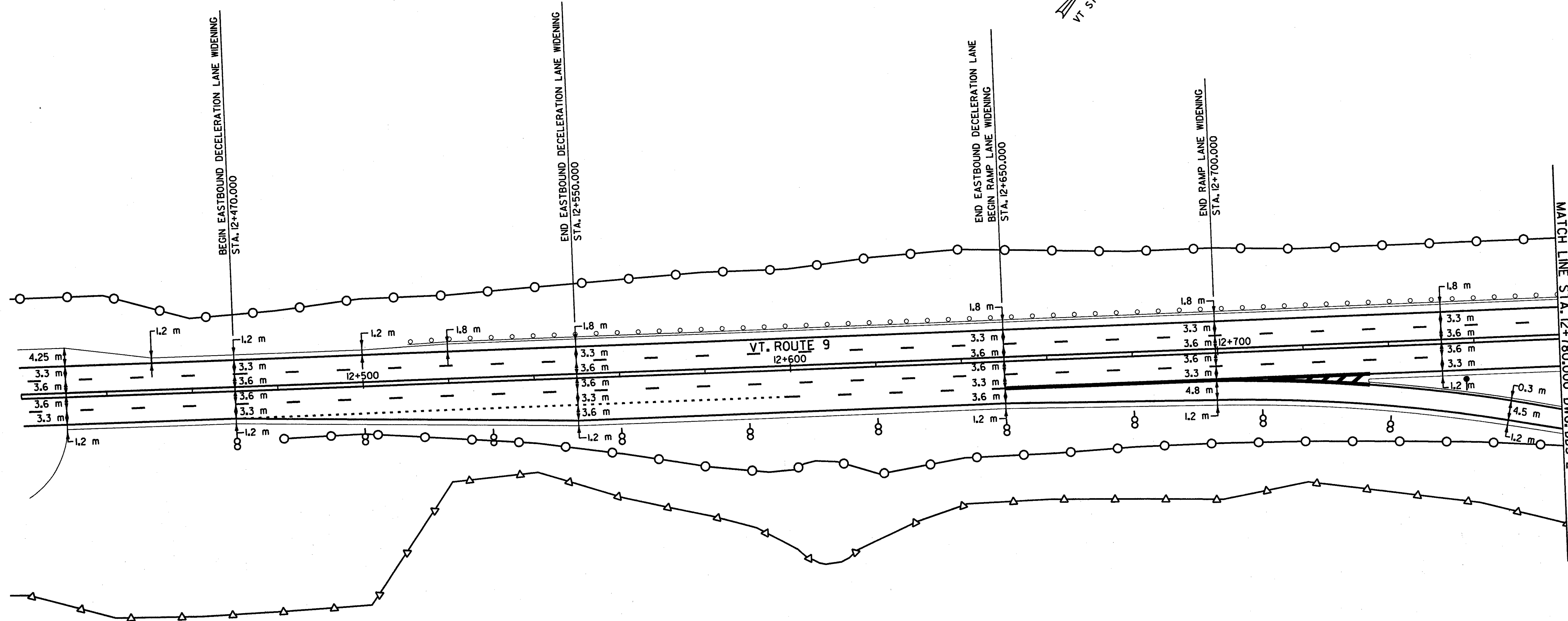
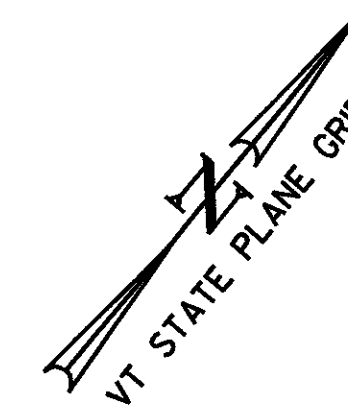

FILE NAME = \\5116\VAOT\CONTRACT3\VTDDSI.dgn
 DATE/TIME = 10/11/2001
 USER = 664

DATUM	
VERTICAL	NAVD 88
HORIZONTAL	NAD 83 (1992)

- DELINEATOR LEGEND**
- TYPE I, WHITE
 - TYPE I, AMBER
 - ⊗ TYPE II, DOUBLE WHITE
 - △ TYPE III, WHITE W/ RED ON BACK
 - ◑ TYPE III, AMBER W/ RED ON BACK

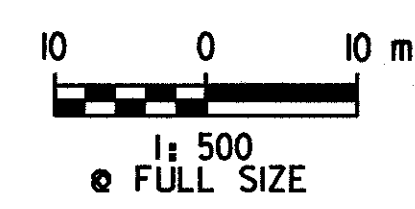

DELINEATOR SHEET 1	SURVEYED BY C.H.A. & V.S.E. DATE 12/93
	DESIGNED BY D.E.G. DATE 11/01
	DRAWN BY J.S.L. DATE 11/01
	CHECKED BY T.P.K. DATE 11/01
DESIGN FILE NO. /5116/VAOT/C3/VTDDSI	PROJ. NAME BENNINGTON - HOOSICK D.P.I. 014611 C/3
	PROJ. NO. P.I.N. 1306.60
DWG NO. DDS-1	SHEET 169 OF 473