

150
646.40 DURABLE 100 mm WHITE LINE

STA. 16+580.000 - STA. 16+695.000 SOLID LT & RT (EDGE LINE)
STA. 16+580.000 - STA. 16+695.000 SOLID 3.6 m LT (LANE LINE)
STA. 16+680.000 - STA. 16+695.000 DOTTED 3.6 m RT (LANE LINE)

150
646.41 DURABLE 100 mm YELLOW LINE

STA. 16+580.000 - STA. 16+695.000 DOUBLE SOLID (CENTER LINE)



MATCH STRIPING PLACED UNDER BENNINGTON - HOOSICK D.P.I. 0146(1) C/4
END ROADWAY
END BENNINGTON - HOOSICK D.P.I. 0146(1) C/3
BEGIN BENNINGTON - HOOSICK D.P.I. 0146(1) C/4
STA. 16+695.000

STA. 16+636.6, LT

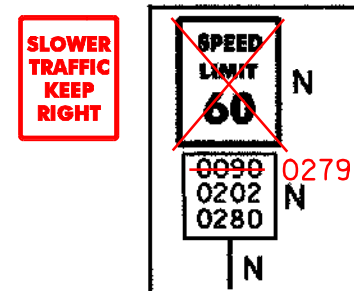

MATCH LINE STA. 16+580.000 DWG. SSP-13

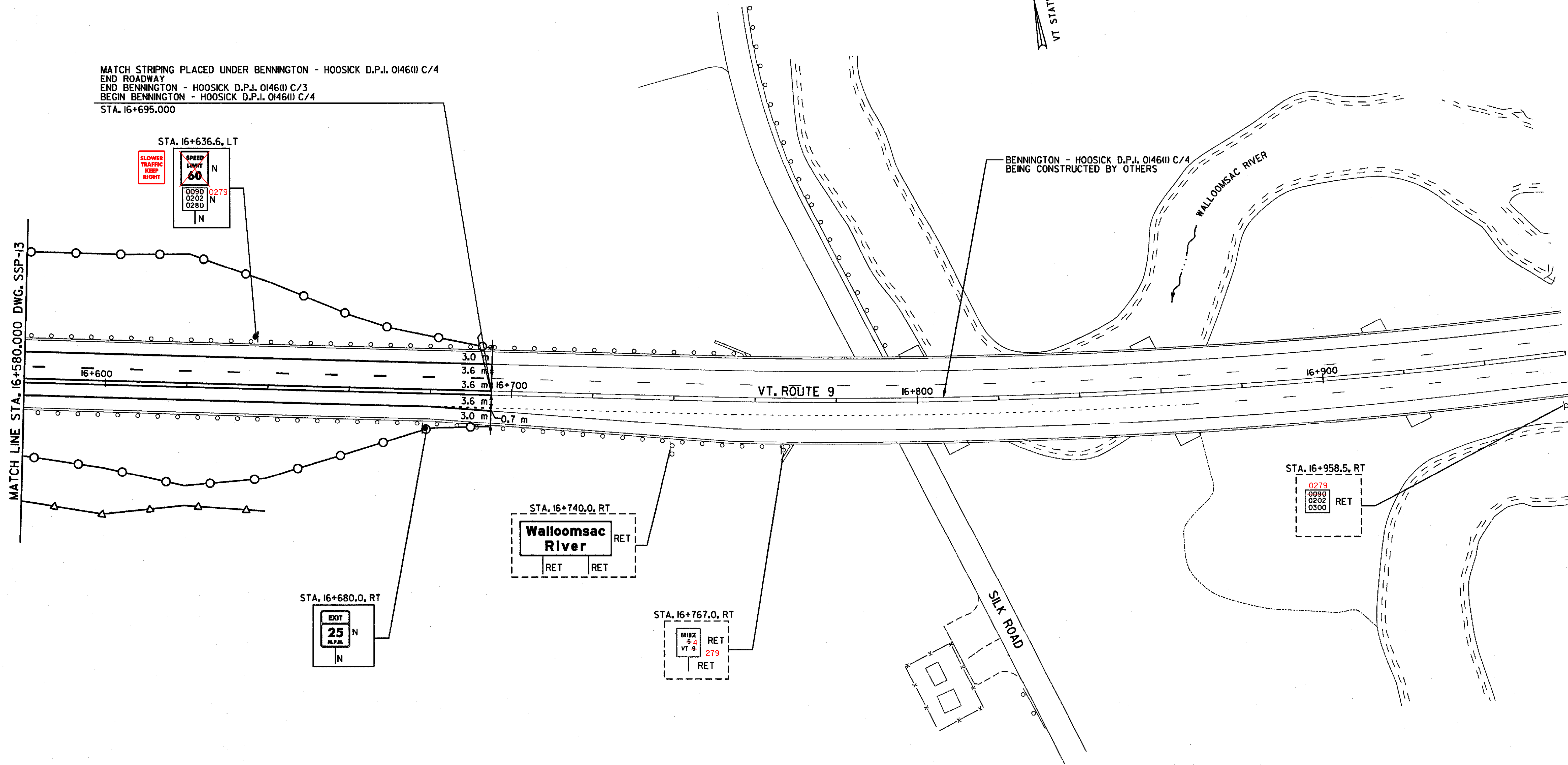

STA. 16+680.0, RT

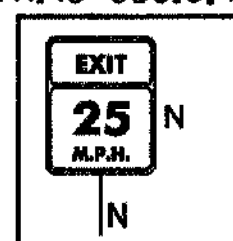

STA. 16+740.0, RT

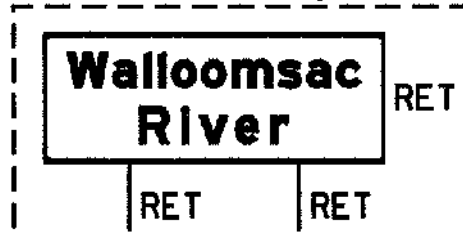

STA. 16+767.0, RT

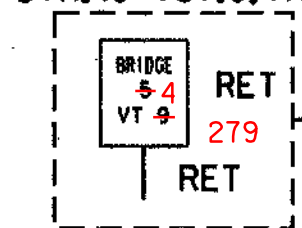

STA. 16+958.5, RT

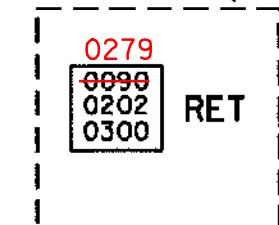

FILE NAME = \\s116\VAOT\CONTRACT3\VTSSP14.DGN
DATE / TIME = 10/11/2001
USER = 664

DATUM	
VERTICAL	NAVD 88
HORIZONTAL	NAD 83 (1992)

SIGN LEGEND
R = REMOVE
S = SALVAGE
N = NEW
RET = RETAIN
B-B = BACK TO BACK
EXISTING = - - - - -
NEW = _____

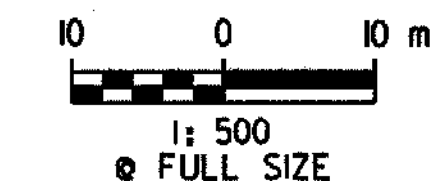

SIGNING AND STRIPING PLAN

AS-BUILT NOTE: SEE NOTE ON SHEET 144
RMT 2/3/06

SURVEYED BY	C.H.A. & V.S.E.	DATE	12/93
DESIGNED BY	D.E.G.	DATE	11/01
DRAWN BY	J.S.L.	DATE	11/01
CHECKED BY	T.P.K.	DATE	11/01
DESIGN FILE NO.	/5116/VAOT/VTSSP14		
PROJ. NAME	BENNINGTON - HOOSICK D.P.I. 0146(1) C/3		
PROJ. NO.	P.L.N. 1306.60		
DWG NO.	SSP-14	SHEET	157 OF 473