

150  
646.40 DURABLE 100 mm WHITE LINE  
STA. 16+260.000 - STA. 16+580.000 DASHED 3.6 m LT (LANE LINE)  
STA. 16+260.000 - STA. 16+580.000 SOLID LT & RT (EDGE LINE)

150  
646.40 DURABLE 100 mm YELLOW LINE  
STA. 16+260.000 - STA. 16+580.000 DOUBLE SOLID (CENTER LINE)

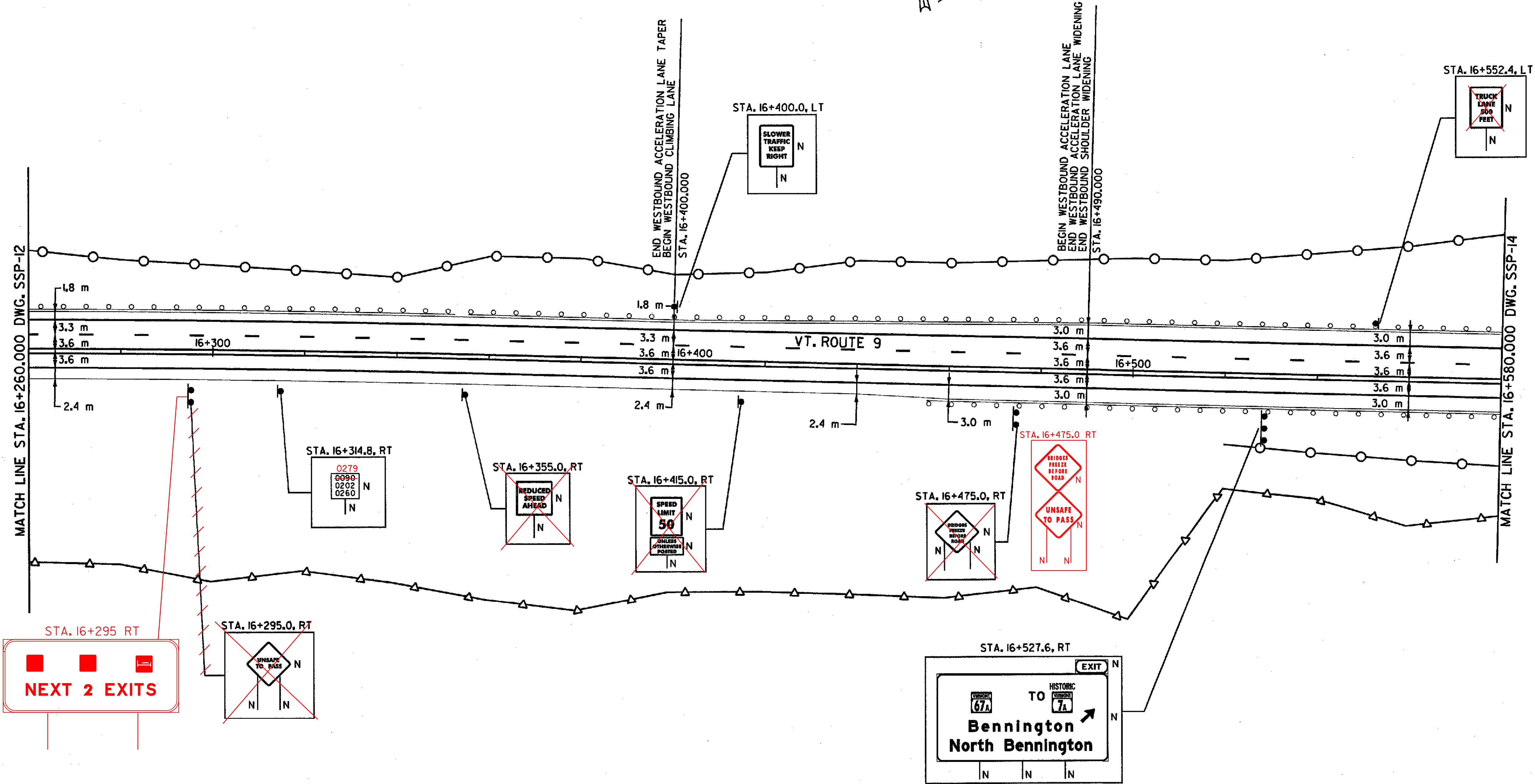

**SPEED LIMIT 55**

FILE NAME = c:\5116\VAOT\CONTRACTS\VTSSP14A.DGN  
DATE/TIME = 10/11/2001  
USER = 664

DATUM	
VERTICAL	NAVD 88
HORIZONTAL	NAD 83 (1992)

**SIGN LEGEND**  
R = REMOVE  
S = SALVAGE  
N = NEW  
RET = RETAIN  
B-B = BACK TO BACK  
EXISTING = -----  
NEW = \_\_\_\_\_

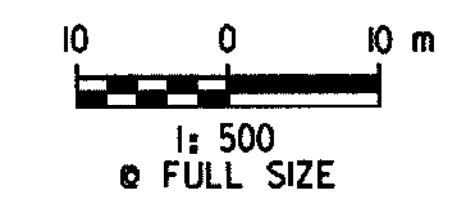

AS-BUILT NOTE: SEE NOTE ON SHEET 144  
RMT 2/3/06

<b>SIGNING AND STRIPING PLAN</b>	SURVEYED BY	C.H.A. & V.S.E.	DATE	12/93
	DESIGNED BY	D.E.G.	DATE	11/01
	DRAWN BY	J.S.L.	DATE	11/01
	CHECKED BY	T.P.K.	DATE	11/01
DESIGN FILE NO.		/5116/VAOT/VTSSP14A		
PROJ. NAME		BENNINGTON - HOOSICK D.P.L. 0146(1) C/3		
PROJ. NO.		P.L.N. 1306.60		
DWG NO. SSP-13		SHEET 156 OF 473		