

646.40 DURABLE 150 mm WHITE LINE
 STA. 15+560.000 - STA. 15+900.000 SOLID LT & RT (EDGE LINE)
 STA. 15+647.640 - STA. 15+900.000 DASHED 3.6 m LT (LANE LINE)

646.41 DURABLE 150 mm YELLOW LINE
 STA. 15+560.000 - STA. 15+900.000 DOUBLE SOLID (CENTER LINE)

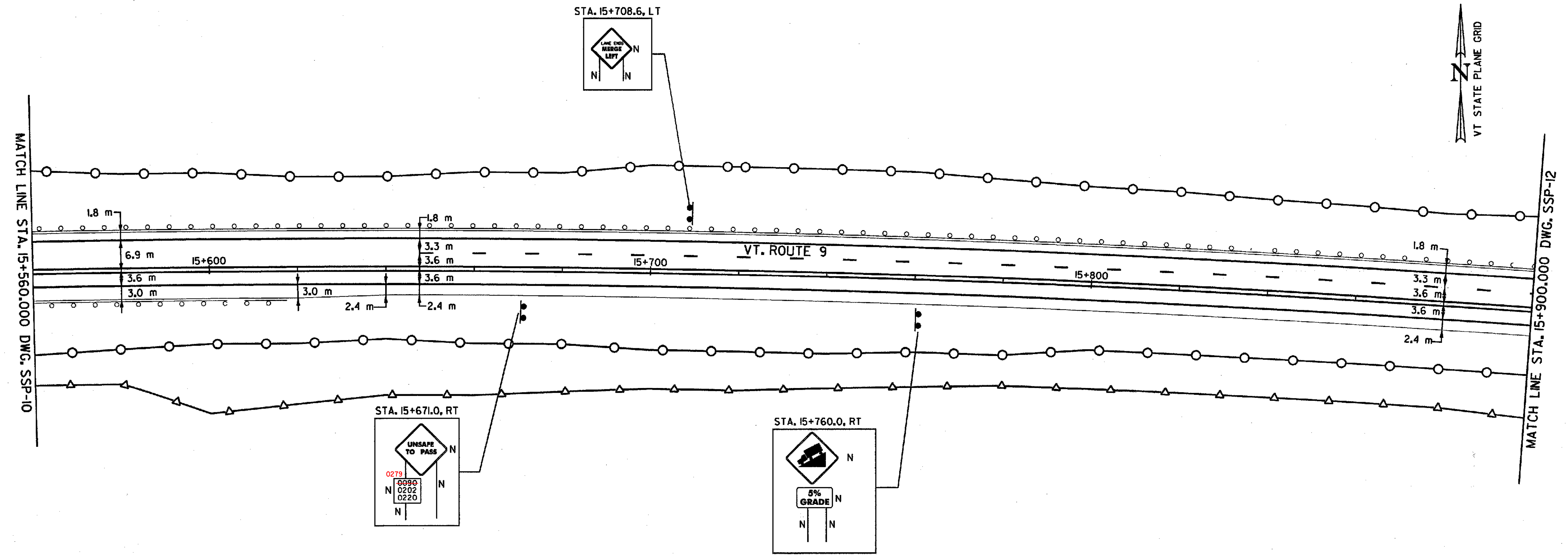

FILE NAME = s:\116\VAOT\CONTRACT3\VTSSP13.DGN
 DATE/TIME = 10/11/2001
 USER = 664

DATUM	
VERTICAL	NAVD 88
HORIZONTAL	NAD 83 (1992)

SIGN LEGEND
 R = REMOVE
 S = SALVAGE
 N = NEW
 RET = RETAIN
 B-B = BACK TO BACK
 EXISTING = -----
 NEW = _____

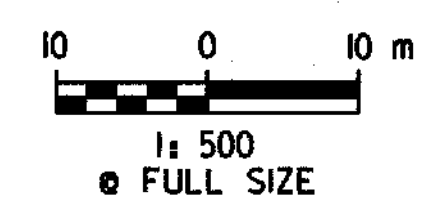

SIGNING AND STRIPING PLAN

AS-BUILT NOTE: SEE NOTE ON SHEET 144 RMT 2/3/06

SURVEYED BY	C.H.A. & V.S.E.	DATE	12/93
DESIGNED BY	D.E.G.	DATE	11/01
DRAWN BY	J.S.L.	DATE	11/01
CHECKED BY	T.P.K.	DATE	11/01
DESIGN FILE NO.	/5116/VAOT/VTSSP13		
PROJ. NAME	BENNINGTON - HOOSICK D.P.J. 0146(1) C/3		
PROJ. NO.	P.I.N. 1306.60		
DWG NO. SSP-II	SHEET 154 OF 473		