

646.40 DURABLE 100 mm WHITE LINE  
 STA. 13+480.000 - STA. 13+675.000 DASHED 3.6 m LT (LANE LINE)  
 STA. 13+480.000 - STA. 13+540.000 SOLID LT & RT (EDGE LINE)  
 STA. 13+480.000 - STA. 13+630.000 SOLID RT (RAMP EDGE LINE)  
 STA. 13+540.000 - STA. 13+630.000 SOLID LT (EDGE LINE)  
 STA. 13+630.000 - STA. 13+677.500 DASHED RT (LANE LINE)  
 STA. 13+630.000 - STA. 13+830.000 SOLID LT & RT (EDGE LINE)

646.41 DURABLE 100 mm YELLOW LINE  
 STA. 13+480.000 - STA. 13+820.000 DOUBLE SOLID (CENTER LINE)  
 STA. 13+820.000 - STA. 13+830.000 SOLID LT/DASHED RT (CENTER LINE)  
 STA. 13+480.000 - STA. 13+520.000 SOLID RT (RAMP EDGE LINE)

646.44 DURABLE 300 mm WHITE LINE  
 STA. 13+540.000 - STA. 13+630.000 SOLID RT (GORE LINE)

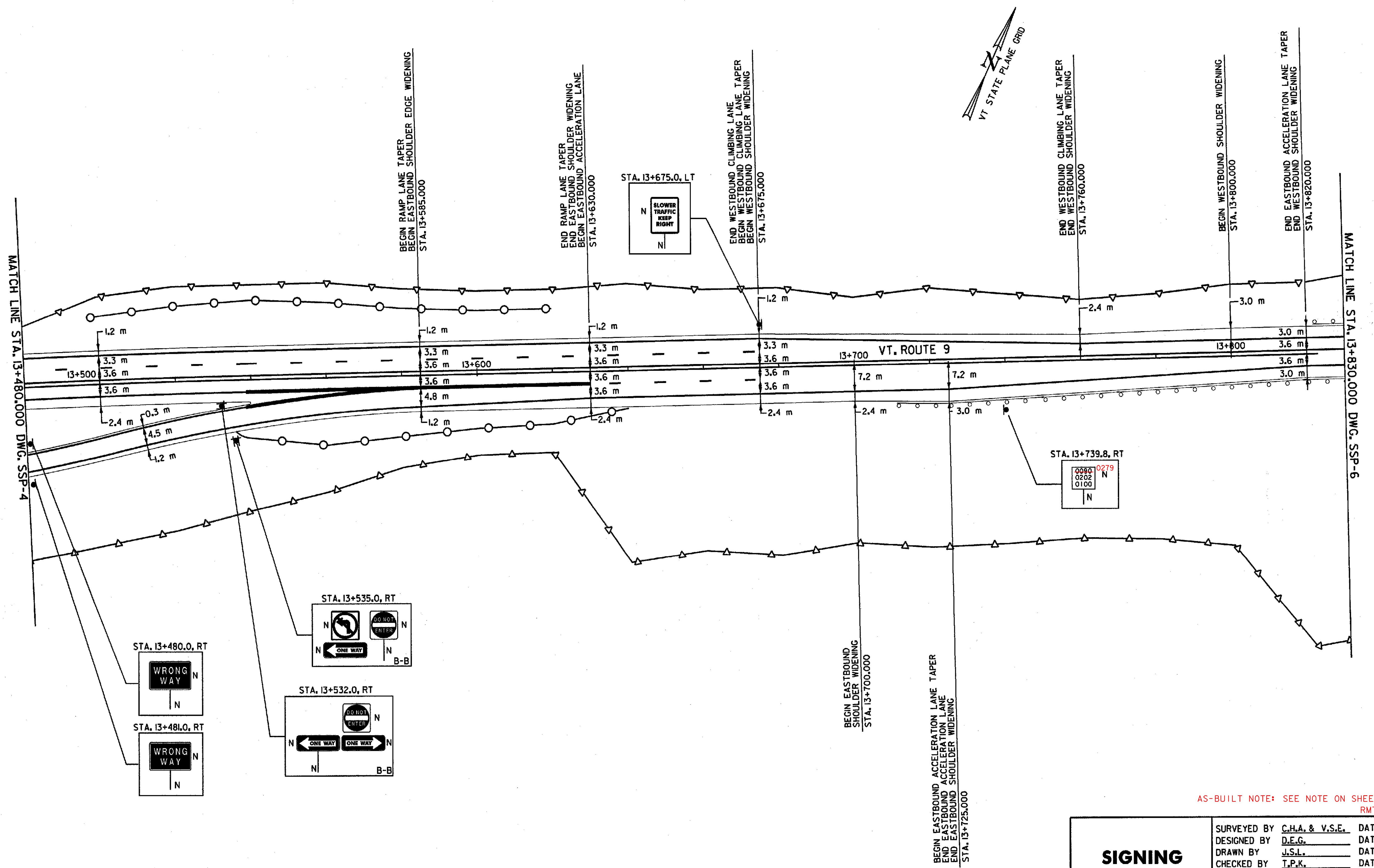

FILE NAME = F:\5116\VAOT\CONTRACT3\VTSSP10.DGN  
 DATE/TIME = 10/11/2001  
 USER = 664

DATUM	
VERTICAL	NAVD 88
HORIZONTAL	NAD 83 (1992)

**SIGN LEGEND**  
 R = REMOVE  
 S = SALVAGE  
 N = NEW  
 RET = RETAIN  
 B-B = BACK TO BACK  
 EXISTING = -----  
 NEW = \_\_\_\_\_

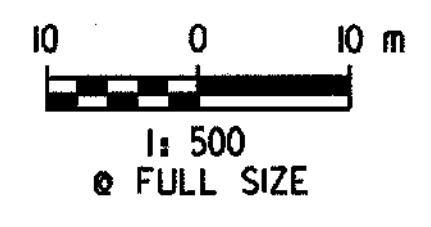

### SIGNING AND STRIPING PLAN

AS-BUILT NOTE: SEE NOTE ON SHEET 144  
 RMT 2/3/06

SURVEYED BY	C.H.A. & V.S.E.	DATE	12/93
DESIGNED BY	D.E.G.	DATE	11/01
DRAWN BY	J.S.L.	DATE	11/01
CHECKED BY	T.P.K.	DATE	11/01
DESIGN FILE NO.	/5116/VAOT/VTSSP10		
PROJ. NAME	BENNINGTON - HOOSICK D.P.I. 0146(1) C/3		
PROJ. NO.	P.L.N. 1306.60		
DWG NO.	SSP-5	SHEET	148 OF 473