

613.10 STONE FILL, TYPE I
 STA. 15+430.0 - STA. 15+490.0 RT 18.2 m³ (643 CF)
 STA. 15+525.0 - STA. 15+550.0 RT 5.2 m³ (184 CF)

613.11 STONE FILL, TYPE II
 STA. 15+508.4 - STA. 15+525.6 RT 132 m³ (4,662 CF)

649.31 GEOTEXTILE UNDER STONE FILL
 STA. 15+485.0 - STA. 15+497.0 RT 106 m² (1,141 SF)
 STA. 15+508.4 - STA. 15+525.6 RT 365 m² (3,933 SF)

649.51 GEOTEXTILE FOR SILT FENCE
 STA. 15+200.0 - STA. 15+470.0 RT 324 m² (3,488 SF)
 STA. 15+200.0 - STA. 15+560.0 LT 432 m² (4,650 SF)
 STA. 15+500.0 RT 14 m² (151 SF)

651.26 HAYBALES FOR EROSION CONTROL
 STA. 15+200.0 - STA. 15+310.0 LT 110 EA
 STA. 15+200.0 - STA. 15+420.0 RT 220 EA
 STA. 15+200.0 - STA. 15+560.0 LT 360 EA
 STA. 15+225.0 - STA. 15+400.0 RT 24 EA
 STA. 15+380.0 - STA. 15+520.0 LT 140 EA

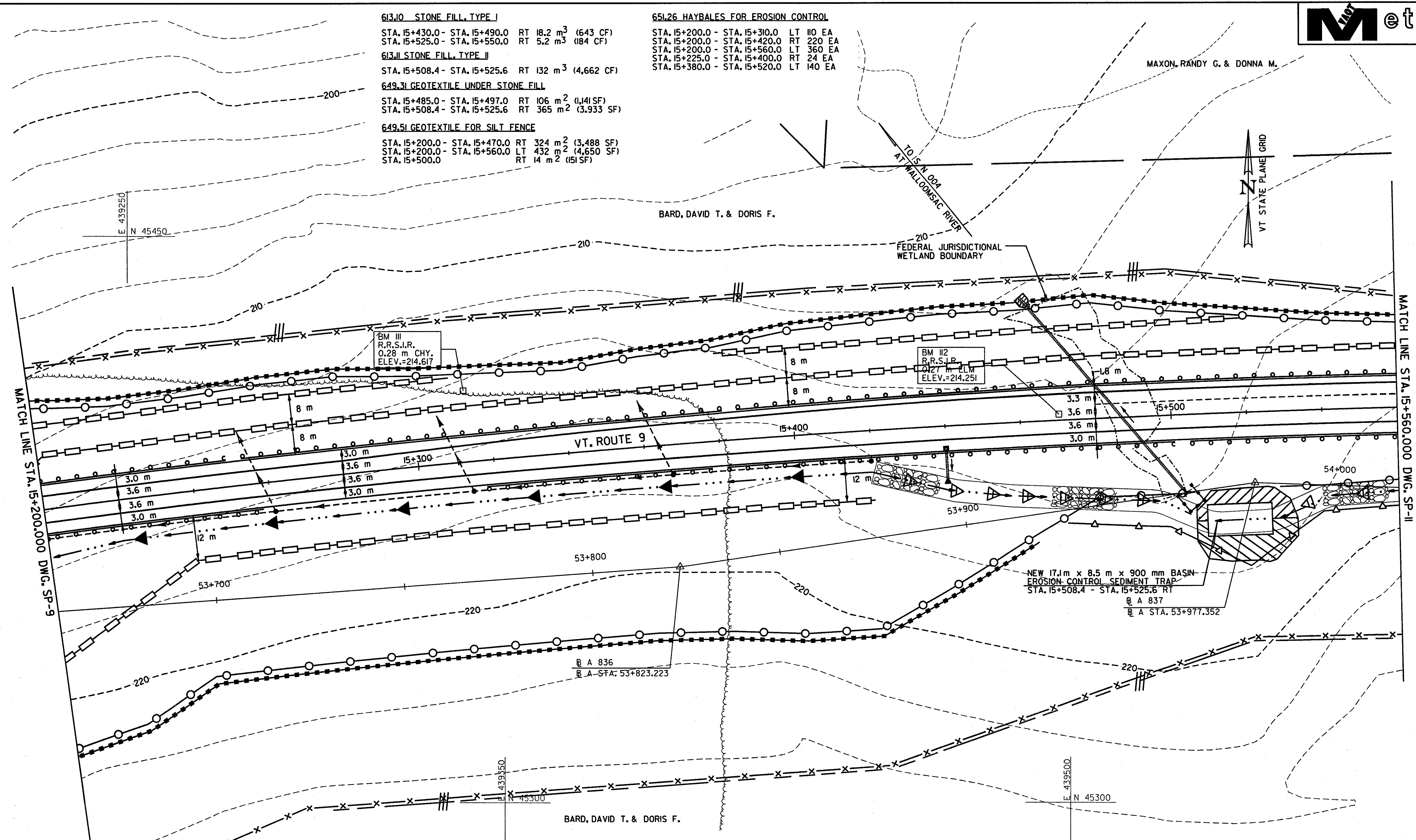

- GENERAL NOTES:**
- SLOPES WILL BE SEEDED AND MULCHED AS SOON AS PRACTICABLE.
 - WHERE STONE FILL IS SHOWN AT STREAM LOCATIONS IT SHALL BE PLACED CONCURRENT WITH EXCAVATION / FILLING OPERATIONS.
 - SILT FENCE SHALL BE INSTALLED IN FILL AREAS PRIOR TO COMMENCING FILL OPERATIONS. WHERE SILT FENCE IS SHOWN AT THE TOP OF STONE FILL, NO FILL SHALL BE PLACED ABOVE THE STONE FILL ELEVATION UNTIL THE SILT FENCE IS INSTALLED.
 - SILT FENCE MAY BE USED IN LIEU OF HAY BALE CHECK DAMS IN DITCHES AND AT DROP INLET LOCATIONS AS DIRECTED BY THE RESIDENT ENGINEER.
 - DIMENSIONS ARE WRITTEN IN THE FORMAT: (LxWxH).

NOTE:
 ADDITIONAL CONTROLS AND PROTECTION OF THE ENVIRONMENT NOT SHOWN ON THE PLANS MAY BE WARRANTED DURING CONSTRUCTION AND SHALL BE INCORPORATED INTO THE PROJECT AS REQUIRED AS DIRECTED BY THE RESIDENT ENGINEER.

LEGEND	
DESCRIPTION	SYMBOL
HAY/STRAWBALE CHECK DAM	
STONE CHECK DAM	
HAY/STRAWBALE (HAYBALE DIKE)	
SILT FENCE	
SILT FENCE FOR CULVERT INLET PROTECTION	
SNOW FENCE (MOD.)	
COFFERDAM/STREAM DIVERSION DAM	
TEMPORARY CONSTRUCTION ACCESS / WORK AREAS	
EROSION CONTROL SEDIMENT TRAP	

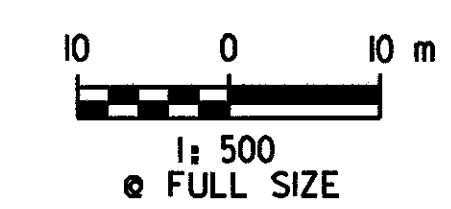

STORMWATER MANAGEMENT PLAN

SURVEYED BY C.H.A. & V.S.E. DATE 12/93
 DESIGNED BY D.E.G. DATE 11/01
 DRAWN BY C.A.K. DATE 11/01
 CHECKED BY T.P.K. DATE 11/01

DESIGN FILE NO. /5116/vaot/vtsp10.dgn
 PROJ. NAME BENNINGTON - HOOSICK D.P.I. 014611 C/3
 PROJ. NO. P.L.H. 1306.60
 DWG. NO. SP-10 SHEET 131 OF 473

FILE NAME = \\s116\vaot\CONTRACT3\vtsp10.dgn
 DATE/TIME = 10/11/2001
 USER = 664

DATUM	
VERTICAL	NAVD 88
HORIZONTAL	NAD 83 (1992)