

649.51 GEOTEXTILE FOR SILT FENCE

STA. 14+160.0 - STA. 14+170.0 RT 18 m² (194 SF)
 STA. 14+160.0 - STA. 14+198.0 LT 59 m² (635 SF)
 STA. 14+169.0 - STA. 14+300.0 RT 173 m² (1,863 SF)
 STA. 14+169.0 - STA. 14+320.0 LT 204 m² (2,196 SF)

613.II STONE FILL, TYPE II (MOD.)

STA. 14+160.0 - STA. 14+200.0 LT/RT 299 m³ (10,559 CF)

649.3I GEOTEXTILE UNDER STONE FILL (MOD.)

STA. 14+160.0 - STA. 14+200.0 LT/RT 499 m² (5371 SF)

651.26 HAYBALES FOR EROSION CONTROL

STA. 14+200.0 - STA. 14+225.0 LT 25 EA
 STA. 14+200.0 - STA. 14+280.0 LT 80 EA
 STA. 14+220.0 - STA. 14+280.0 RT 60 EA
 STA. 14+350.0 - STA. 14+490.0 LT 20 EA
 STA. 14+350.0 - STA. 14+490.0 RT 20 EA

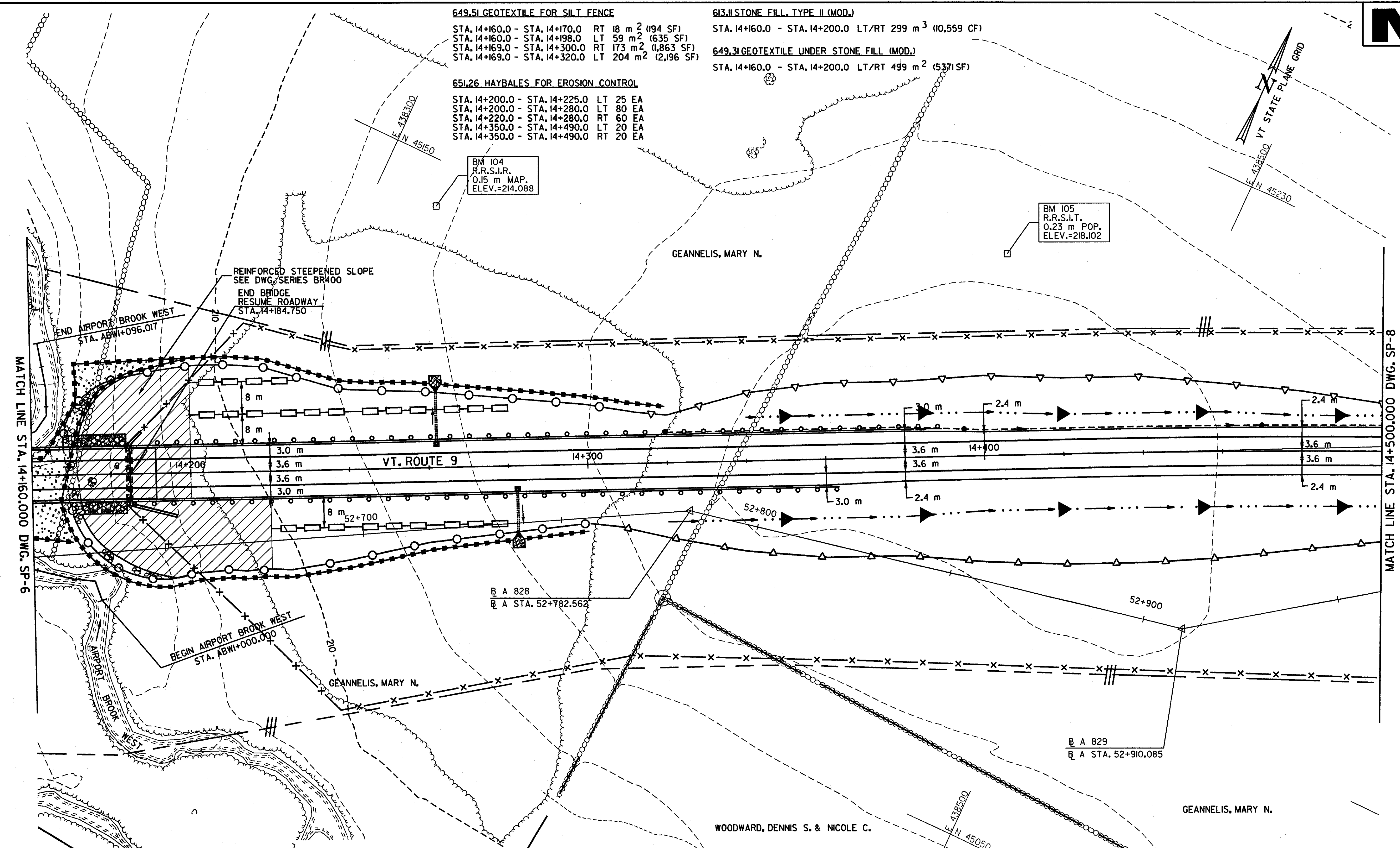

BM 104
 R.R.S.I.T.
 0.15 m MAP.
 ELEV.=214.088

BM 105
 R.R.S.I.T.
 0.23 m POP.
 ELEV.=218.102

B A 828
 B A STA. 52+782.562

B A 829
 B A STA. 52+910.085

GENERAL NOTES:

- SLOPES WILL BE SEEDED AND MULCHED AS SOON AS PRACTICABLE.
- WHERE STONE FILL IS SHOWN AT STREAM LOCATIONS IT SHALL BE PLACED CONCURRENT WITH EXCAVATION / FILLING OPERATIONS.
- SILT FENCE SHALL BE INSTALLED IN FILL AREAS PRIOR TO COMMENCING FILL OPERATIONS. WHERE SILT FENCE IS SHOWN AT THE TOP OF STONE FILL, NO FILL SHALL BE PLACED ABOVE THE STONE FILL ELEVATION UNTIL THE SILT FENCE IS INSTALLED.
- SILT FENCE MAY BE USED IN LIEU OF HAY BALE CHECK DAMS IN DITCHES AND AT DROP INLET LOCATIONS AS DIRECTED BY THE RESIDENT ENGINEER.
- TEMPORARY CONSTRUCTION ACCESS/WORK AREAS SHALL BE CONSTRUCTED WITH 600 mm OF 613.II STONE FILL, TYPE II (MOD.) OVER 649.3I GEOTEXTILE UNDER STONE FILL (MOD.), UPON THE COMPLETION OF CONSTRUCTION OR AS DIRECTED BY THE RESIDENT ENGINEER, THE CONTRACTOR SHALL REMOVE THE STONE FILL AND GEOTEXTILE FABRIC USED TO CONSTRUCT THE TEMPORARY CONSTRUCTION ACCESS/WORK AREAS.

NOTE:

ADDITIONAL CONTROLS AND PROTECTION OF THE ENVIRONMENT NOT SHOWN ON THE PLANS MAY BE WARRANTED DURING CONSTRUCTION AND SHALL BE INCORPORATED INTO THE PROJECT AS REQUIRED AS DIRECTED BY THE RESIDENT ENGINEER.

LEGEND	
DESCRIPTION	SYMBOL
HAY/STRAWBALE CHECK DAM	
STONE CHECK DAM	
HAY/STRAWBALE (HAYBALE DIKE)	
SILT FENCE	
SILT FENCE FOR CULVERT INLET PROTECTION	
SNOW FENCE (MOD.)	
COFFERDAM/STREAM DIVERSION DAM	
TEMPORARY CONSTRUCTION ACCESS / WORK AREAS	
EROSION CONTROL SEDIMENT TRAP	

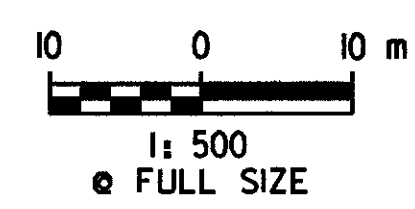

STORMWATER MANAGEMENT PLAN

SURVEYED BY C.H.A. & V.S.E. DATE 12/93
 DESIGNED BY D.E.G. DATE 11/01
 DRAWN BY C.A.K. DATE 11/01
 CHECKED BY T.P.K. DATE 11/01
 DESIGN FILE NO. /5116/vaot/vtsp7.dgn
 PROJ. NAME BENNINGTON - HOOSICK D.P.J. 0146(i) C/3
 PROJ. NO. P.I.N. 1306.60
 DWG NO. SP-7 SHEET 128 OF 473

FILE NAME =u:\5116\VAOT\CONTRACT3\vtsp7.dgn
 DATE/TIME =10/11/2001
 USER =664

DATUM	
VERTICAL	NAVD 88
HORIZONTAL	NAD 83 (1992)