

**616.35 TREATED TIMBER CURB**  
 STA. 16+384.4 - STA. 16+580.0 LT (195.6 m)  
 STA. 16+515.4 - STA. 16+580.0 RT (64.6 m)

**621.20 STEEL BEAM GUARDRAIL**  
 STA. 16+260.0 - STA. 16+580.0 LT (320.0 m)  
 STA. 16+465.9 - STA. 16+580.0 RT (114.1 m)

**621.505 MANUFACTURED TERMINAL SECTION (FLARED)**  
 STA. 16+465.9 RT

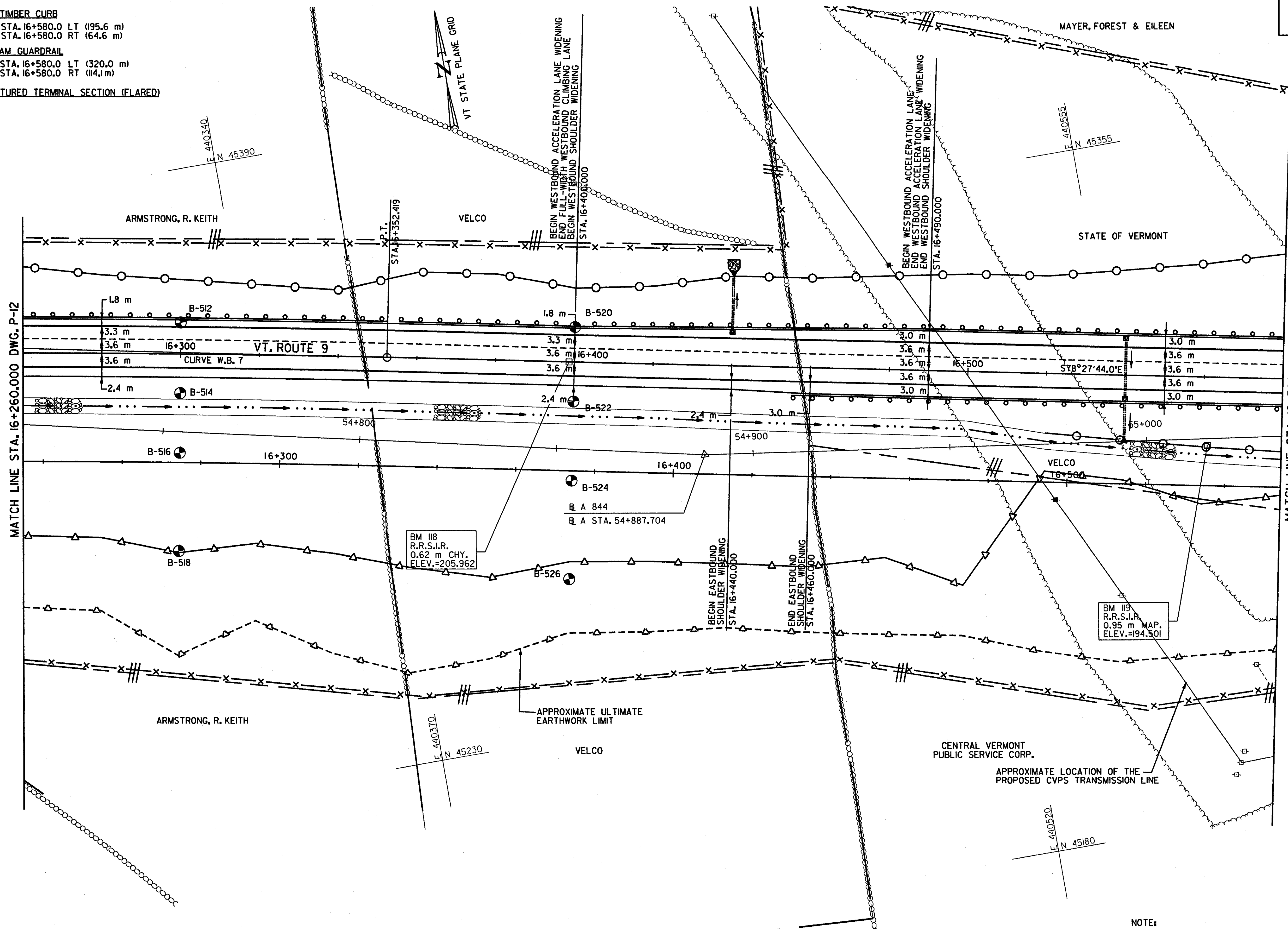

MATCH LINE STA. 16+260.000 DWG. P-12

MATCH LINE STA. 16+580.000

**620.25 WOVEN WIRE FENCE WITH STEEL POSTS**  
 STA. 16+260.000 - STA. 16+340.900 LT (81.4 m)  
 STA. 16+260.000 - STA. 16+360.077 RT (105.6 m)  
 STA. 16+340.900 - STA. 16+452.100 LT (111.3 m)  
 STA. 16+360.077 - STA. 16+468.221 RT (108.8 m)  
 STA. 16+441.800 - STA. 16+580.000 LT (138.4 m)  
 STA. 16+452.100 - STA. 16+441.800 LT (65.4 m)  
 STA. 16+468.221 - STA. 16+547.949 RT (80.4 m)  
 STA. 16+547.949 - STA. 16+580.000 RT (32.8 m)

**620.40 STEEL BRACE FOR WOVEN WIRE FENCE**  
 STA. 16+340.900 LT (2 EA)  
 STA. 16+360.077 RT (2 EA)  
 STA. 16+441.800 LT (1 EA)  
 STA. 16+452.100 LT (2 EA)  
 STA. 16+468.221 RT (2 EA)  
 STA. 16+547.949 RT (2 EA)  
 STA. 16+560.000 LT (2 EA)

**649.11 GEOTEXTILE FOR ROADBED SUBGRADE SEPARATOR**  
 STA. 16+520.000 - STA. 16+580.000 (2,717 m<sup>2</sup>)

**CURVE W.B. 7**  
 P.C.C. = STA. 15+308.571  
 P.T. = STA. 16+352.419  
 $\Delta = 16^\circ 50' 50.4''$  RT  
 R = 3550.000 m  
 T = 525.717 m  
 L = 1043.848 m  
 E = 38.715 m  
 $e_{max} = 0.020$  DN. RT

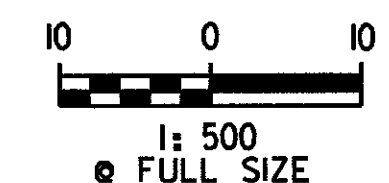

NOTE:  
 1. ITEM 649.11 GEOTEXTILE FOR ROADBED SUBGRADE SEPARATOR SHALL BE PLACED BY THE CONTRACTOR AS DIRECTED BY THE RESIDENT ENGINEER.

**PLAN**

SURVEYED BY C.H.A. & V.S.E. DATE 12/93  
 DESIGNED BY D.E.G. DATE 11/01  
 DRAWN BY J.S.L. DATE 11/01  
 CHECKED BY T.P.K. DATE 11/01

DESIGN FILE NO. 5116/vaot/vtp20.dgn

PROJ. NAME BENNINGTON - HOOSICK  
 D.P.I. 014611 C/3

PROJ. NO. P.I.N. 1306.60  
 DWG NO. P-13 SHEET 86 OF 473

FILE NAME = I:\5116\VAOT\CONTRACT3\VTP20.DGN  
 DATE/TIME = 02/11/2001  
 USER = 684

**DATUM**  
 VERTICAL NAVD 88  
 HORIZONTAL NAD 83 (1992)