

SEE REVISED PLAN SHEET 77,
 DATED 01/03, FOR REVISED
 EARTHWORK LIMITS.
 RMT 1/31/06

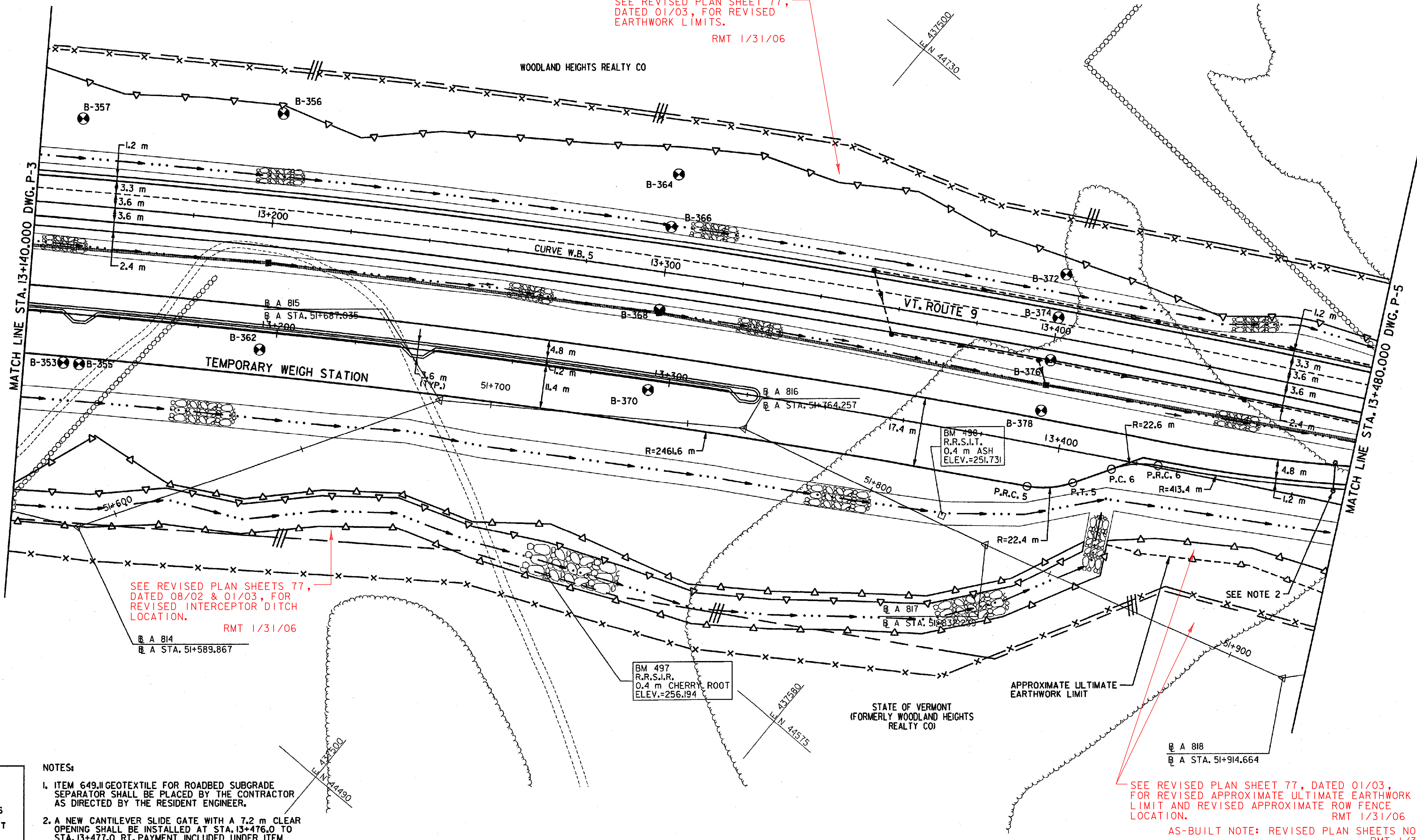

SEE REVISED PLAN SHEETS 77,
 DATED 08/02 & 01/03, FOR
 REVISED INTERCEPTOR DITCH
 LOCATION.
 RMT 1/31/06

SEE REVISED PLAN SHEET 77, DATED 01/03,
 FOR REVISED APPROXIMATE ULTIMATE EARTHWORK
 LIMIT AND REVISED APPROXIMATE ROW FENCE
 LOCATION.
 RMT 1/31/06
 AS-BUILT NOTE: REVISED PLAN SHEETS NOTED.
 RMT 1/31/06

NOTES:

- ITEM 649.1 GEOTEXTILE FOR ROADBED SUBGRADE SEPARATOR SHALL BE PLACED BY THE CONTRACTOR AS DIRECTED BY THE RESIDENT ENGINEER.
- A NEW CANTILEVER SLIDE GATE WITH A 7.2 m CLEAR OPENING SHALL BE INSTALLED AT STA. 13+476.0 TO STA. 13+477.0 RT. PAYMENT INCLUDED UNDER ITEM 620.30 DRIVE GATE FOR WOVEN WIRE FENCE (MOD.). SEE SPECIAL PROVISIONS FOR ADDITIONAL INFORMATION.

CURVE W.B. 5
 P.C.= STA. 13+841.329
 P.T.= STA. 13+538.666
 $\Delta=15^{\circ}58'54.5''$ RT
 R=2500.000 m
 T=350.947 m
 L=697.337 m
 E=24.513 m
 $e_{max}=0.021$ DN. RT

HORIZONTAL CONTROL FOR TEMPORARY WEIGH STATION		
CONTROL POINT	STATION	OFFSET
P.R.C. 5	13+399.947	38.400 RT
P.T. 5	13+411.302	35.377 RT
P.C. 6	13+420.373	30.135 RT
P.R.C. 6	13+431.887	26.991 RT

620.25 WOVEN WIRE FENCE WITH STEEL POSTS

STA. 13+140.000 - STA. 13+340.000	LT (203.3 m)
STA. 13+140.000 - STA. 13+160.000	RT (21.4 m)
STA. 13+160.000 - STA. 13+260.000	RT (94.7 m)
STA. 13+260.000 - STA. 13+320.000	RT (60.0 m)
STA. 13+320.000 - STA. 13+387.000	RT (62.6 m)
STA. 13+340.000 - STA. 13+380.000	LT (41.6 m)
STA. 13+380.000 - STA. 13+480.000	LT (101.5 m)
STA. 13+387.000 - STA. 13+440.000	RT (61.1 m)
STA. 13+440.000 - STA. 13+480.000	RT (38.9 m)

620.40 STEEL BRACE FOR WOVEN WIRE FENCE

STA. 13+160.000	RT (2 EA)
STA. 13+190.000	LT (2 EA)
STA. 13+260.000	RT (2 EA)
STA. 13+320.000	RT (2 EA)
STA. 13+340.000	LT (2 EA)
STA. 13+380.000	LT (2 EA)
STA. 13+387.000	RT (2 EA)
STA. 13+440.000	RT (2 EA)

620.30 DRIVE GATE FOR WOVEN WIRE FENCE (MOD.)

STA. 13+476.0 - STA. 13+477.0	RT
-------------------------------	----

649.1 GEOTEXTILE FOR ROADBED SUBGRADE SEPARATOR

STA. 13+280.000 - STA. 13+480.000	(987 m ²)
-----------------------------------	-----------------------

DATUM

VERTICAL	NAVD 88
HORIZONTAL	NAD 83 (992)

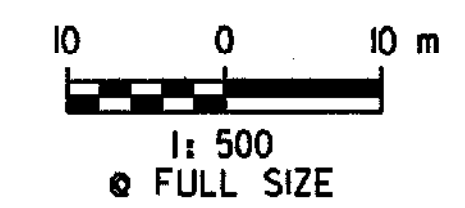

PLAN		
SURVEYED BY	C.H.A. & V.S.E.	DATE 12/93
DESIGNED BY	D.E.G.	DATE 11/01
DRAWN BY	J.S.L.	DATE 11/01
CHECKED BY	T.P.K.	DATE 11/01
DESIGN FILE NO.	/5116/vaot/vtpl1.dgn	
PROJ. NAME	BENNINGTON - HOOSICK D.P.I. 014601 C/3	
PROJ. NO.	P.I.N. 1306.60	
DWG NO. P-4	SHEET 77 OF 473	

FILE NAME = \\5116\VAOT\CONTRACT3\VTPL1.DGN
 DATE/TIME = 10/11/2001
 USER = 664