

616.20 GRANITE SLOPE EDGING
 STA. 12+977.8 - STA. 13+140.0 RT (326.0 m)
 616.35 TREATED TIMBER CURB
 STA. 12+780.0 - STA. 12+805.4 LT (25.4 m)
 621.20 STEEL BEAM GUARDRAIL
 STA. 12+780.0 - STA. 13+081.0 LT (301.0 m)
 621.505 MANUFACTURED TERMINAL SECTION (FLARED)
 STA. 13+081.0 LT

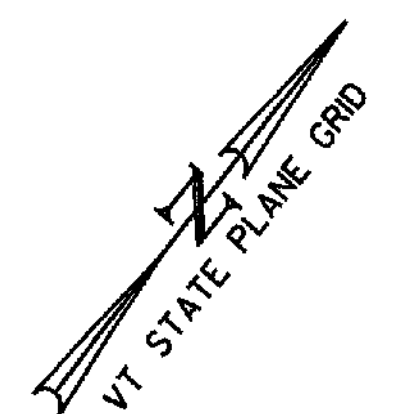

SEE REVISED PLAN SHEET 76,
 DATED 01/03, FOR REVISED
 EARTHWORK LIMIT.
 RMT 1/31/06

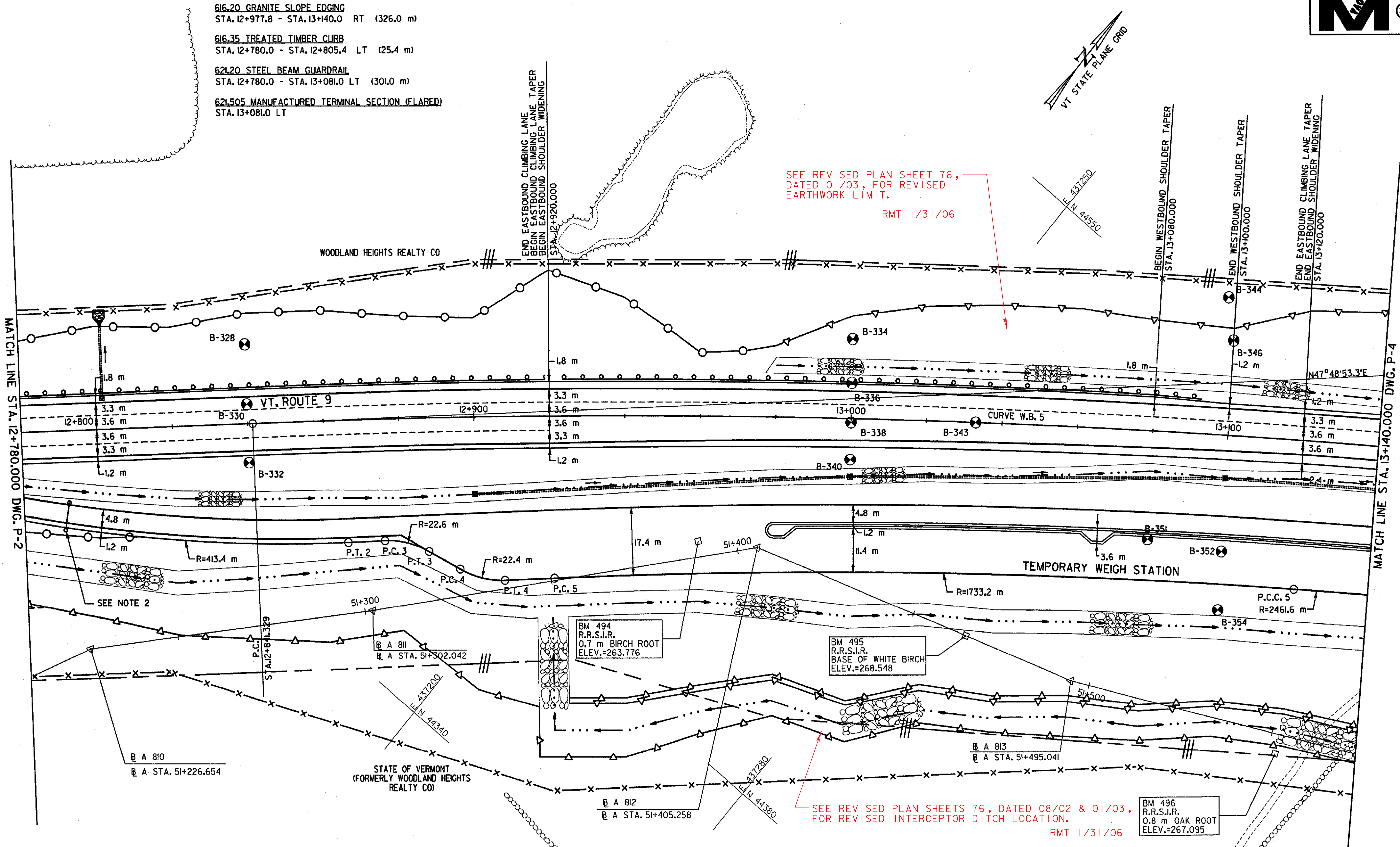

MATCH LINE STA. 12+780.000 DWG. P-2

MATCH LINE STA. 13+140.000 DWG. P-4

SEE NOTE 2

SEE REVISED PLAN SHEETS 76, DATED 08/02 & 01/03,
 FOR REVISED INTERCEPTOR DITCH LOCATION.
 RMT 1/31/06

- NOTES:
- ITEM 649.11 GEOTEXTILE FOR ROADBED SUBGRADE SEPARATOR SHALL BE PLACED BY THE CONTRACTOR AS DIRECTED BY THE RESIDENT ENGINEER.
 - A NEW CANTILEVER SLIDE GATE WITH A 7.2 m CLEAR OPENING SHALL BE INSTALLED AT STA. 12+790.7 TO 12+792.0 RT. PAYMENT INCLUDED UNDER ITEM 620.30 DRIVE GATE FOR WOVEN WIRE FENCE (MOD.). SEE SPECIAL PROVISIONS FOR ADDITIONAL INFORMATION.

620.25 WOVEN WIRE FENCE WITH STEEL POSTS
 STA. 12+780.000 - STA. 12+820.000 LT (40.0 m)
 STA. 12+780.000 - STA. 12+820.000 RT (40.3 m)
 STA. 12+820.000 - STA. 12+900.000 LT (81.4 m)
 STA. 12+820.000 - STA. 12+920.000 RT (105.5 m)
 STA. 12+900.000 - STA. 13+140.000 LT (243.2 m)
 STA. 12+920.000 - STA. 13+080.000 RT (155.8 m)
 STA. 13+080.000 - STA. 13+140.000 RT (56.8 m)

620.30 DRIVE GATE FOR WOVEN WIRE FENCE (MOD.)
 STA. 12+790.7 - STA. 12+792.0 RT

620.40 STEEL BRACE FOR WOVEN WIRE FENCE
 STA. 12+820.000 LT (2 EA)
 STA. 12+820.000 RT (2 EA)
 STA. 12+900.000 LT (2 EA)
 STA. 12+920.000 RT (2 EA)
 STA. 13+080.000 RT (2 EA)
 STA. 13+045.000 LT (2 EA)

CURVE W.B. 5

P.C. = STA. 12+841.329
 P.T. = STA. 13+538.666
 $\Delta = 15^\circ 58' 54.5''$ RT
 R = 2500.000 m
 T = 350.947 m
 L = 697.337 m
 E = 24.513 m
 $e_{max} = 0.021$ DN, RT

HORIZONTAL CONTROL FOR TEMPORARY WEIGH STATION

CONTROL POINT	STATION	OFFSET
P.T. 2	12+865.198	31.502 RT
P.C. 3	12+875.514	31.367 RT
P.T. 3	12+887.461	34.443 RT
P.C. 4	12+895.580	39.088 RT
P.T. 4	12+907.556	42.084 RT
P.C. 5	12+920.911	41.680 RT
P.C.C. 5	13+120.074	38.400 RT

AS-BUILT NOTE: REVISED PLAN SHEETS NOTED.
 RMT 1/31/06

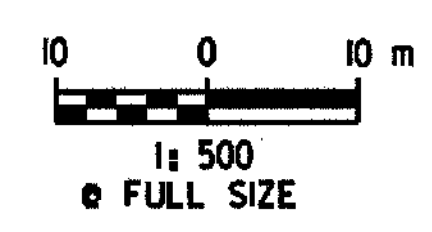

PLAN

SURVEYED BY C.H.A. & V.S.E. DATE 12/93
 DESIGNED BY D.E.G. DATE 11/01
 DRAWN BY J.S.L. DATE 11/01
 CHECKED BY T.P.K. DATE 11/01
 DESIGN FILE NO. /5116/vaot/vtpl0.dgn
 PROJ. NAME BENNINGTON - HOOSICK
D.P.J. 0146(1) C/3
 PROJ. NO. P.L.N. 1306.60
 DWG NO. P-3 SHEET 76 OF 473

FILE NAME = \\5116\vaot\CONTRACT3\VTPL0.DGN
 DATE/TIME = 10/11/2001
 USER = 664

DATUM

VERTICAL	NAVD 88
HORIZONTAL	NAD 83 (1992)