

616.35 TREATED TIMBER CURB  
STA. 12+520.4 - STA. 12+780.0 LT (259.6 m)

621.20 STEEL BEAM GUARDRAIL  
STA. 12+522.4 - STA. 12+780.0 LT (257.6 m)

616.47 BITUMINOUS CONCRETE GUTTERS & TRAFFIC ISLANDS  
STA. 12+740.0 - STA. 12+780.0 RT (8.0 ft)

621.505 MANUFACTURED TERMINAL SECTION (FLARED)  
STA. 12+522.4 LT

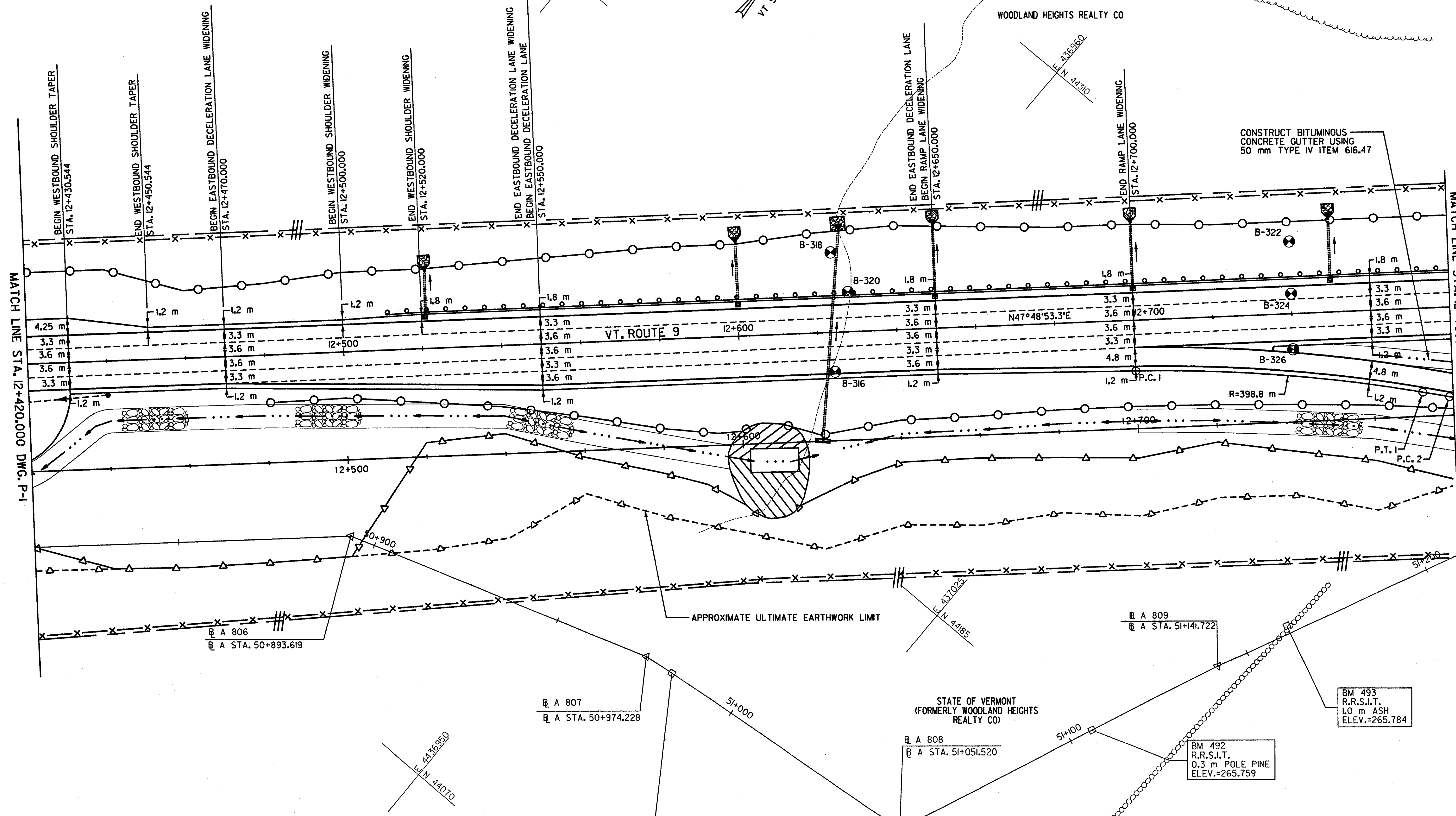

**HORIZONTAL CONTROL FOR TEMPORARY WEIGH STATION**

CONTROL POINT	STATION	OFFSET
P.C. 1	12+700.000	12.900 RT
P.T. 1	12+772.325	21.328 RT
P.C. 2	12+779.012	22.737 RT

620.25 WOVEN WIRE FENCE WITH STEEL POSTS  
STA. 12+420.000 - STA. 12+780.000 LT (360.0 m)  
STA. 12+420.000 - STA. 12+600.000 RT (197.3 m)  
STA. 12+600.000 - STA. 12+780.000 RT (179.7 m)

620.40 STEEL BRACE FOR WOVEN WIRE FENCE  
STA. 12+450.000 RT (2 EA)  
STA. 12+460.000 LT (2 EA)  
STA. 12+600.000 RT (2 EA)  
STA. 12+640.000 LT (2 EA)  
STA. 12+710.000 RT (2 EA)

649.11 GEOTEXTILE FOR ROADBED SUBGRADE SEPARATOR  
STA. 12+420.000 - STA. 12+580.000 (920 m<sup>2</sup>)  
STA. 12+580.000 - STA. 12+660.000 (3423 m<sup>2</sup>)

NOTE:  
1. ITEM 649.11 GEOTEXTILE FOR ROADBED SUBGRADE SEPARATOR SHALL BE PLACED BY THE CONTRACTOR AS DIRECTED BY THE RESIDENT ENGINEER.

**PLAN**

SURVEYED BY	C.H.A. & V.S.E.	DATE	12/93
DESIGNED BY	D.E.G.	DATE	11/01
DRAWN BY	J.S.L.	DATE	11/01
CHECKED BY	T.P.K.	DATE	11/01
DESIGN FILE NO.	/5116/vaot/vtp9.dgn		
PROJ. NAME	BENNINGTON - HOOSICK D.P.I. 0146(II) C/3		
PROJ. NO.	P.I.N. 1306.60		
DWG NO. P-2	SHEET 75 OF 473		

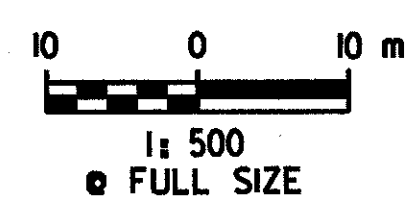

FILE NAME = \\V:\5116\VAOT\CONTRACTS\VT\TP9.DGN  
DATE/TIME = 10/11/2001  
USER = 664

**DATUM**  
VERTICAL NAVD 88  
HORIZONTAL NAD 83 (1992)