

FED. ROAD REG. NO.	STATE	FEDERAL AID PROJECT NO.	SHEET NO.	TOTAL SHEETS
1	N.Y.	0146001	66	92

BENNINGTON CONNECTOR S.H. 98-2
 P.I.N. 1306.60
 WHITEHOUSE BRIDGE - VERMONT STATE LINE S.H. 1426
 RENSSELAER COUNTY

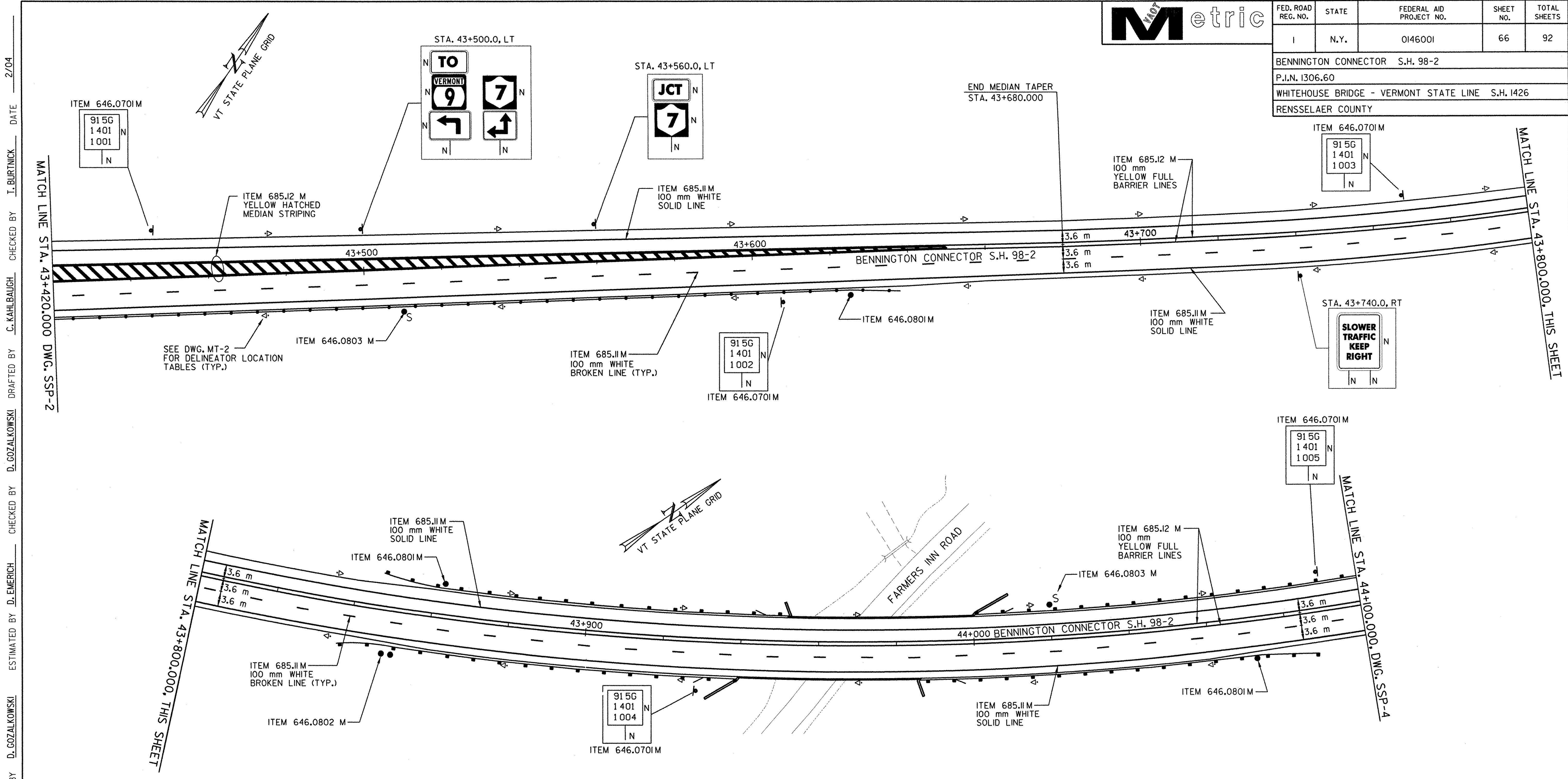

FILE NAME: \\s315\project\contract\1\signs\3.dgn
 DATE: 2/25/04
 IN CHARGE OF: T. KARIS
 DESIGNED BY: D. EMERICH
 CHECKED BY: D. EMERICH
 ESTIMATED BY: D. EMERICH
 DRAFTED BY: D. GOZALKOWSKI
 CHECKED BY: C. KAHLBAUGH
 DRAFTED BY: C. KAHLBAUGH
 CHECKED BY: I. BURTNICK
 DATE: 2/04

DELINEATOR LEGEND	
▷	WHITE DELINEATOR
▷	ITEM 646.0601M, DELINEATOR, SINGLE UNIT, ONE WAY ON POST
◁▷	ITEM 646.0602 M, DELINEATOR, SINGLE UNIT, BACK TO BACK ON POST
▷◁	ITEM 646.0603 M, DELINEATOR, SINGLE UNIT, TWO WAY ON POST
▷◁▷	ITEM 646.0604 M DELINEATOR, SINGLE UNIT, THREE WAY ON POST
•	ITEM 646.0801M SNOWPLOWING MARKER, SINGLE UNIT
••	ITEM 646.0802 M SNOWPLOWING MARKER, DOUBLE UNIT
•S	ITEM 646.0803 M SUPPLEMENTARY SNOWPLOWING MARKERS

DATUM	
VERTICAL	NAVD 88
HORIZONTAL	NAD 83 (1992)

SIGN LEGEND	
R	REMOVE
S	SALVAGE
N	NEW
RET	RETAIN
B-B	BACK TO BACK
EXISTING	-----
NEW	_____

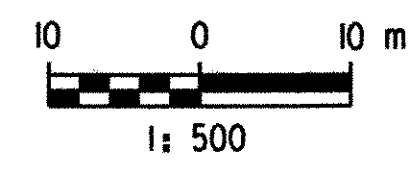

NOTE:
 I. SEE DWG'S. STD-1 & STD-2 FOR SIGN TEXT DATA.

SIGNING AND STRIPING PLAN STA. 43+420 TO STA. 44+100	SURVEYED BY	C.H.A. & V.S.E.	DATE	12/93
	DESIGNED BY	D.W.E.	DATE	2/04
	DRAWN BY	C.A.K.	DATE	2/04
	CHECKED BY	T.P.K.	DATE	2/04
DESIGN FILE NO.		NYSSP3.DGN		
PROJ. NAME	BENNINGTON - HOOSICK D.P.I. 0146(II) C/1			
PROJ. NO.	P.I.N. 1306.60			
SHEET	66 OF 92	DWG NO.		SSP-3