

FED. ROAD REG. NO.	STATE	FEDERAL AID PROJECT NO.	SHEET NO.	TOTAL SHEETS
1	N.Y.	0146001	65	92

BENNINGTON CONNECTOR S.H. 98-2  
 P.I.N. 1306.60  
 WHITEHOUSE BRIDGE - VERMONT STATE LINE S.H. 1426  
 RENSSELAER COUNTY

DELINEATOR LEGEND	
▷	WHITE DELINEATOR
▷	ITEM 646.0601M, DELINEATOR, SINGLE UNIT, ONE WAY ON POST
▷	ITEM 646.0602 M, DELINEATOR, SINGLE UNIT, BACK TO BACK ON POST
▷	ITEM 646.0603 M, DELINEATOR, SINGLE UNIT, TWO WAY ON POST
▷	ITEM 646.0604 M DELINEATOR, SINGLE UNIT, THREE WAY ON POST
•	ITEM 646.0801M SNOWPLOWING MARKER, SINGLE UNIT
••	ITEM 646.0802 M SNOWPLOWING MARKER, DOUBLE UNIT
•S	ITEM 646.0803 M SUPPLEMENTARY SNOWPLOWING MARKERS

NOTE:  
 I. SEE DWG'S. STD-1 & STD-2 FOR SIGN TEXT DATA.

2/04 DATE I. BURTNICK CHECKED BY C. KAHLBAUGH DRAFTED BY D. GOZALKOWSKI CHECKED BY D. EMERICH ESTIMATED BY D. GOZALKOWSKI CHECKED BY D. EMERICH DESIGNED BY I. KARRIS IN CHARGE OF  
 FILE NAME = u:\SR15\m\stds\contract\ngssp2.dgn  
 DATE/TIME = 2/23/2004  
 USER = 225

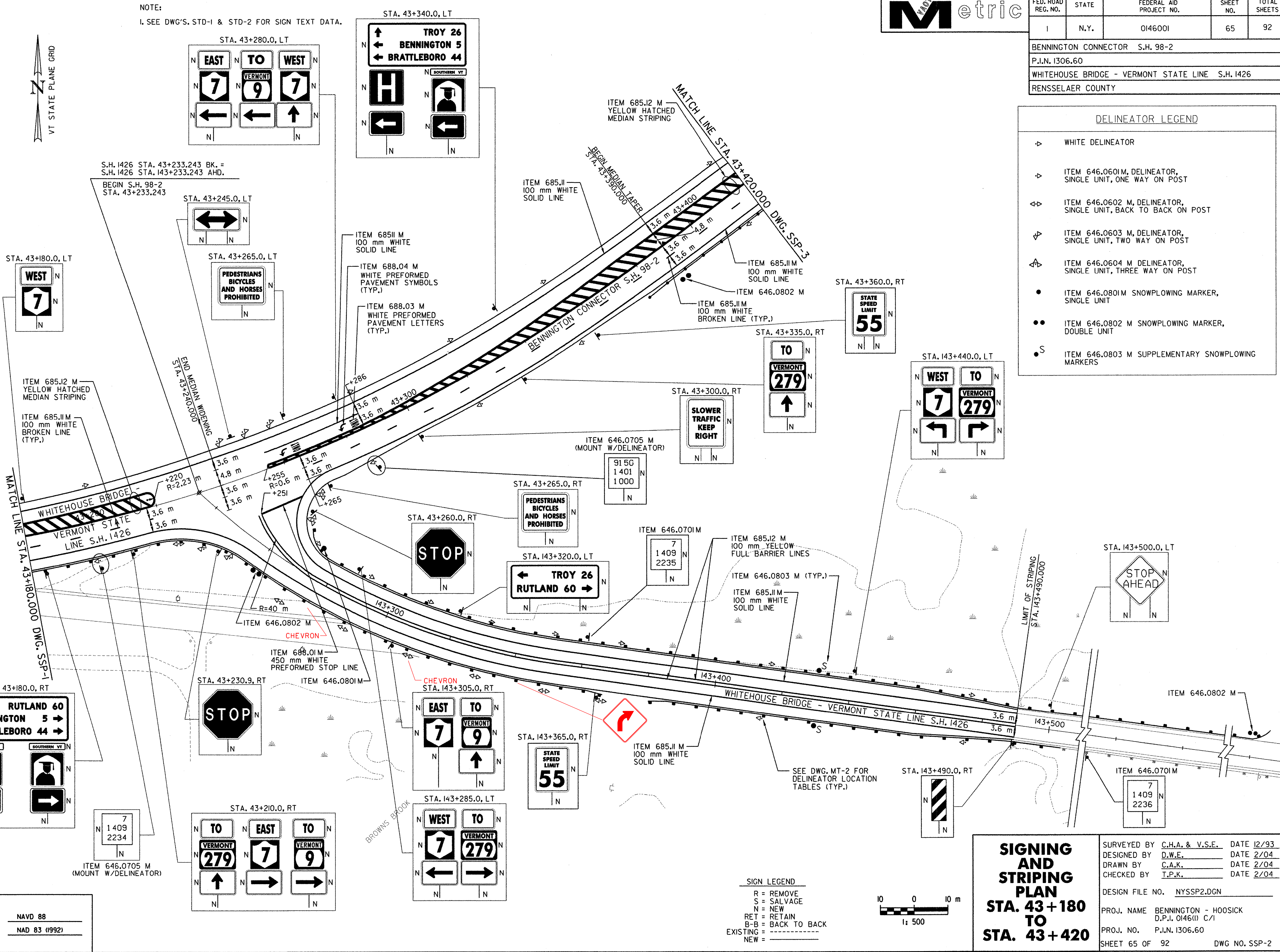

DATUM

VERTICAL	NAVD 88
HORIZONTAL	NAD 83 (1992)

SIGN LEGEND

R	= REMOVE
S	= SALVAGE
N	= NEW
RET	= RETAIN
B-B	= BACK TO BACK
EXISTING	= -----
NEW	= _____

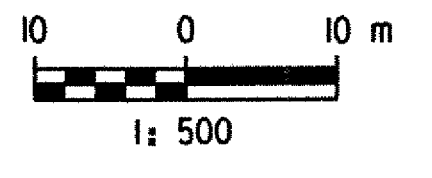

**SIGNING AND STRIPING PLAN**  
**STA. 43 + 180 TO STA. 43 + 420**

SURVEYED BY	C.H.A. & V.S.E.	DATE	12/93
DESIGNED BY	D.W.E.	DATE	2/04
DRAWN BY	C.A.K.	DATE	2/04
CHECKED BY	I.P.K.	DATE	2/04
DESIGN FILE NO.	NYSSP2.DGN		
PROJ. NAME	BENNINGTON - HOOSICK		
	D.P.I. 0146(I) C/1		
PROJ. NO.	P.I.N. 1306.60		
SHEET	65 OF 92	DWG NO.	SSP-2