

FILE NAME = \\S:\GIS\roads\contract\rowpln3.dgn
 DATE/TIME = 2/23/2004 2:22:55
 IN CHARGE OF I. KARI
 DESIGNED BY D. EMERICH
 CHECKED BY D. EMERICH
 ESTIMATED BY D. EMERICH
 CHECKED BY D. GOZALKOWSKI
 DRAFTED BY C. KAHLBAUGH
 CHECKED BY C. KAHLBAUGH
 DATE 2/04

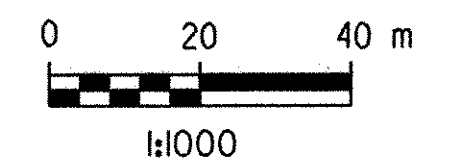

FED. ROAD REG. NO.	STATE	FEDERAL AID PROJECT NO.	SHEET NO.	TOTAL SHEETS
I	N.Y.	0146001	60	92

BENNINGTON CONNECTOR S.H. 98-2
 P.I.N. 1306.60
 WHITEHOUSE BRIDGE - VERMONT STATE LINE S.H. 1426
 RENSSELAER COUNTY

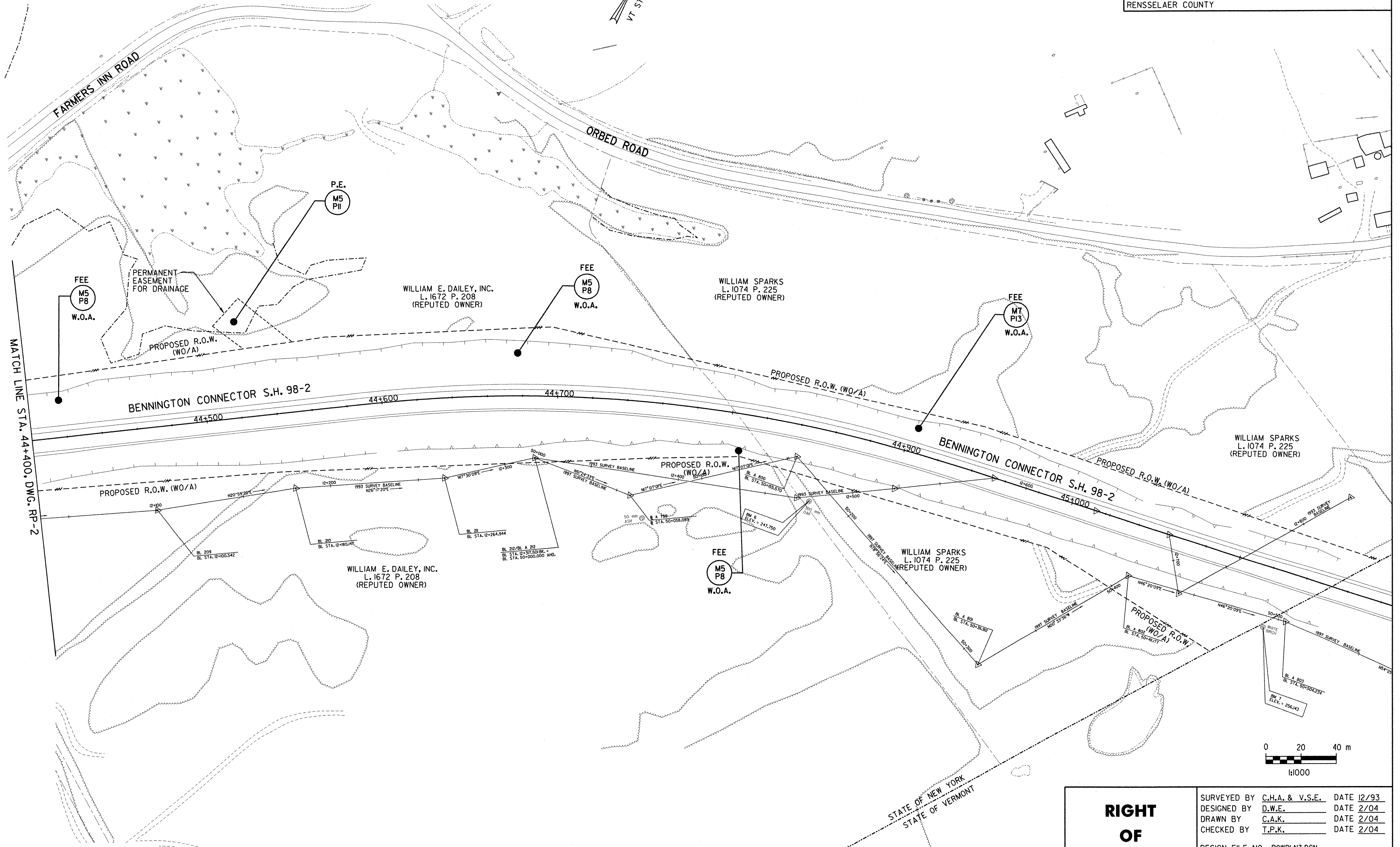
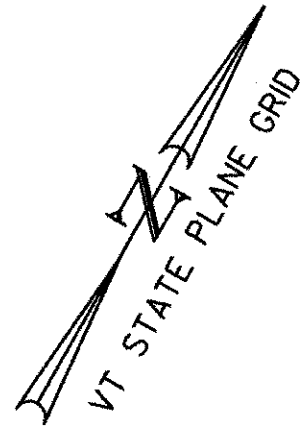

DATUM

VERTICAL	NAVD 88
HORIZONTAL	NAD 83 (1992)

NOTE: THIS RIGHT-OF-WAY PLAN WAS GENERATED FOR CONSTRUCTION PURPOSES ONLY. IT IS BEING PROVIDED TO INDICATE PROPOSED TAKING LINES, MAP AND PARCEL NUMBERS, AND TABLES OF PROPOSED MONUMENTATION. THE OFFICIAL RIGHT-OF-WAY PLAN IS ON FILE AT THE N.Y.S.D.O.T. REGION 1 OFFICE.

RIGHT OF WAY PLAN		
SURVEYED BY	C.H.A. & V.S.E.	DATE 12/93
DESIGNED BY	D.W.E.	DATE 2/04
DRAWN BY	C.A.K.	DATE 2/04
CHECKED BY	T.P.K.	DATE 2/04
DESIGN FILE NO. ROWPLN3.DGN		
PROJ. NAME	BENNINGTON - HOOSICK D.P.I. 0146(1) C/1	
PROJ. NO.	P.I.N. 1306.60	
SHEET 60 OF 92	DWG NO. RP-3	