

FILE NAME = A:\150\mch\contract\1\vgdw-2.dgn
 DATE/TIME = 2/23/2004
 USER = 225
 IN CHARGE OF T. KARISS
 DESIGNED BY D. EMERICH
 CHECKED BY D. EMERICH
 ESTIMATED BY D. EMERICH
 CHECKED BY D. GOZALKOWSKI
 DRAFTED BY D. GOZALKOWSKI
 CHECKED BY C. KAHLBAUGH
 DATED BY I. BURTMICK
 DATE 2/04

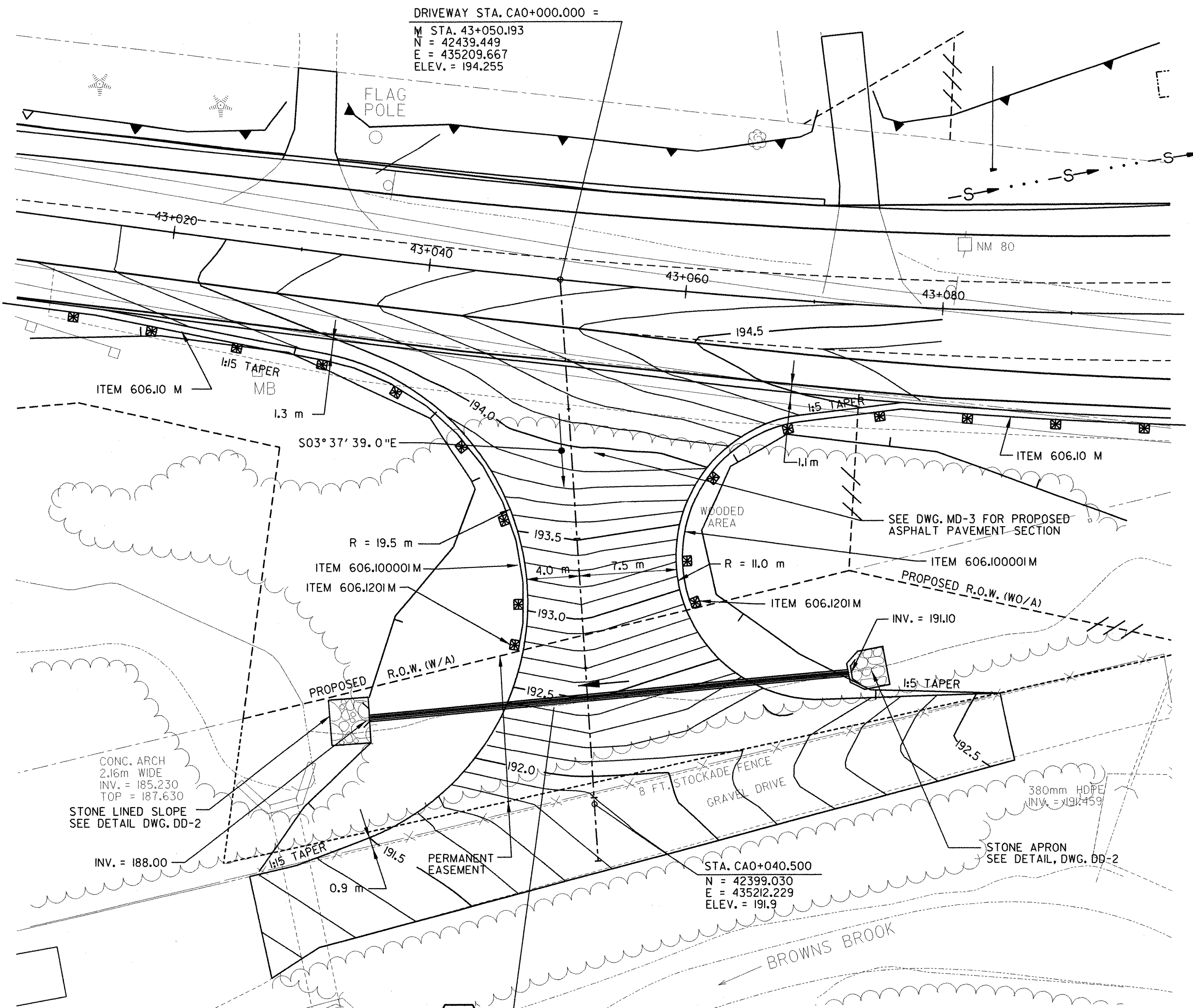

FED. ROAD REG. NO.	STATE	FEDERAL AID PROJECT NO.	SHEET NO.	TOTAL SHEETS
1	N.Y.	0146001	37	92

BENNINGTON CONNECTOR S.H. 98-2
 P.I.N. 1306.60
 WHITEHOUSE BRIDGE - VERMONT STATE LINE S.H. 1426
 RENSSELAER COUNTY



DRIVEWAY 5
 1:200
 PLAN

NOTE: SEE DWG.'S P-1, AND MD-3 FOR ADDITIONAL SITE INFORMATION

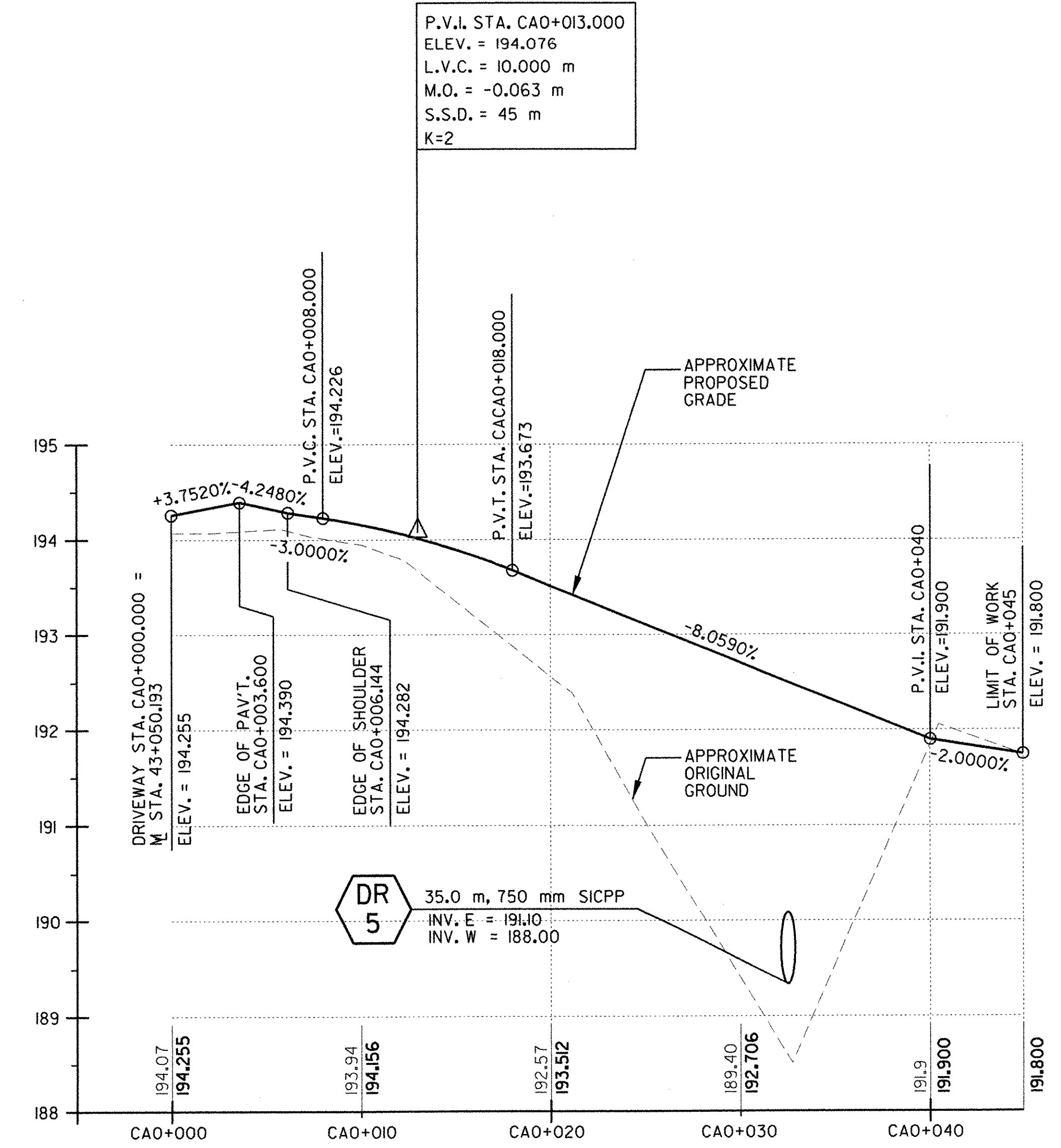

DRIVEWAY 5
 1:200
 1:40
 PROFILE

DRIVEWAY PLANS	
SURVEYED BY	C.H.A. & V.S.E. DATE 12/93
DESIGNED BY	D.W.E. DATE 2/04
DRAWN BY	C.A.K. DATE 2/04
CHECKED BY	T.P.K. DATE 2/04
DESIGN FILE NO.	NYDW-2.DGN
PROJ. NAME	BENNINGTON - HOOSICK D.P.I. 0146(I) C/1
PROJ. NO.	P.I.N. 1306.60
SHEET 37 OF 92	DWG NO. DW-2