

646.40 DURABLE 100 mm WHITE LINE
 (ALL LINES WILL INCLUDE EDGE LINE BREAKS AND RADIUS FOR TOWN HIGHWAYS)
 SUNDERLAND:
 STA. 0+620.0 - STA. 1+149.072 LT & RT
 STA. 0+775.0 - STA. 0+842.0 3.6 m RT, DOTTED LINE
 STA. 0+827.0 - STA. 0+838.0 3.6 m LT, DASHED LINE
 STA. 0+842.0 - STA. 0+866.0 3.6 m RT, DASHED LINE

646.41 DURABLE 100 mm YELLOW LINE
 (ALL LINES WILL INCLUDE C/L BREAKS FOR TOWN HIGHWAYS) S=SOLID, D=DASHED
 SUNDERLAND:
 STA. 0+620.0 STA. 0+692.0 LT
 STA. 0+692.0 STA. 1+149.072 RT
 STA. 0+740.298 DOUBLE SOLID LT, T-16
 STA. 0+762.829 DOUBLE SOLID RT, T-16

646.42 DURABLE 200 mm WHITE LINE
 SUNDERLAND:
 STA. 0+745.2 - STA. 0+816.0 LT, SHOULDER HATCHING
 STA. 0+838.0 - STA. 0+881.0 3.6 m LT
 STA. 0+853.0 - STA. 0+881.0 LT
 STA. 0+866.0 - STA. 0+917.0 3.6 m RT
 STA. 0+881.0 - STA. 0+917.0 RT, SHOULDER HATCHING
 STA. 0+881.0 - STA. 0+917.0 RT

646.46 DURABLE 600 mm STOP BAR
 SUNDERLAND:
 STA. 0+740.298 LT, T-16
 STA. 0+762.829 RT, T-16
 STA. 0+946.294 LT, U.S. ROUTE 7 RAMP C
 STA. 1+139.416 RT, U.S. ROUTE 7 RAMP A
 STA. 1+146.300 LT, ORVIS COMMERCIAL DRIVE

646.50 DURABLE LETTER OR SYMBOL
 SUNDERLAND:
 STA. 0+740.298 LT, T-16 "S,T,O,P" (4 EA)
 STA. 0+762.829 RT, T-16 "S,T,O,P" (4 EA)
 STA. 0+875.0 RT, U.S. ROUTE 7 RAMP D, "O,N,L,Y" (4 EA)
 STA. 0+877.5 LT, U.S. ROUTE 7 RAMP C, "Y,I,E,L,D" (5 EA)
 STA. 0+879.0 RT, U.S. ROUTE 7 RAMP D, ARROW (1EA)
 STA. 0+946.294 LT, U.S. ROUTE 7 RAMP C, "S,T,O,P" (4 EA)
 STA. 1+139.416 RT, U.S. ROUTE 7 RAMP A, "S,T,O,P" (4 EA)
 STA. 1+149.0 LT, ORVIS COMMERCIAL DRIVE, "S,T,O,P" (4 EA)

646.414 DURABLE 150 mm WHITE LINE
 SUNDERLAND:
 STA. 0+946.294 LT, U.S. ROUTE 7 RAMP C
 STA. 0+946.294 RT, U.S. ROUTE 7 RAMP D
 STA. 1+139.416 LT, U.S. ROUTE 7 RAMP B
 STA. 1+139.416 RT, U.S. ROUTE 7 RAMP A

646.61 TEMPORARY 100 mm YELLOW LINE
 (ALL LINES WILL INCLUDE C/L BREAKS FOR TOWN HIGHWAYS) S=SOLID, D=DASHED
 SUNDERLAND:
 STA. 0+740.298 DOUBLE SOLID LT, T-16
 STA. 0+762.829 DOUBLE SOLID RT, T-16

646.42 TEMPORARY 200 mm WHITE LINE
 SUNDERLAND:
 STA. 0+745.2 - STA. 0+816.0 LT, SHOULDER HATCHING
 STA. 0+838.0 - STA. 0+881.0 3.6 m LT
 STA. 0+853.0 - STA. 0+881.0 LT
 STA. 0+866.0 - STA. 0+917.0 3.6 m RT
 STA. 0+881.0 - STA. 0+917.0 RT, SHOULDER HATCHING
 STA. 0+881.0 - STA. 0+917.0 RT

646.66 TEMPORARY 600 mm STOP BAR
 SUNDERLAND:
 STA. 0+740.298 LT, T-16
 STA. 0+762.829 RT, T-16
 STA. 0+946.294 LT, U.S. ROUTE 7 RAMP C
 STA. 1+139.416 RT, U.S. ROUTE 7 RAMP A
 STA. 1+146.300 LT, ORVIS COMMERCIAL DRIVE

646.50 TEMPORARY LETTER OR SYMBOL
 SUNDERLAND:
 STA. 0+740.298 LT, T-16 "S,T,O,P" (4 EA)
 STA. 0+762.829 RT, T-16 "S,T,O,P" (4 EA)
 STA. 0+946.294 LT, U.S. ROUTE 7 RAMP C, "S,T,O,P" (4 EA)
 STA. 1+139.416 RT, U.S. ROUTE 7 RAMP A, "S,T,O,P" (4 EA)
 STA. 1+149.0 LT, ORVIS COMMERCIAL DRIVE, "S,T,O,P" (4 EA)

675.50 REMOVING SIGNS
 AS SHOWN - II

675.60 ERECTING SALVAGED SIGNS
 AS SHOWN - 7

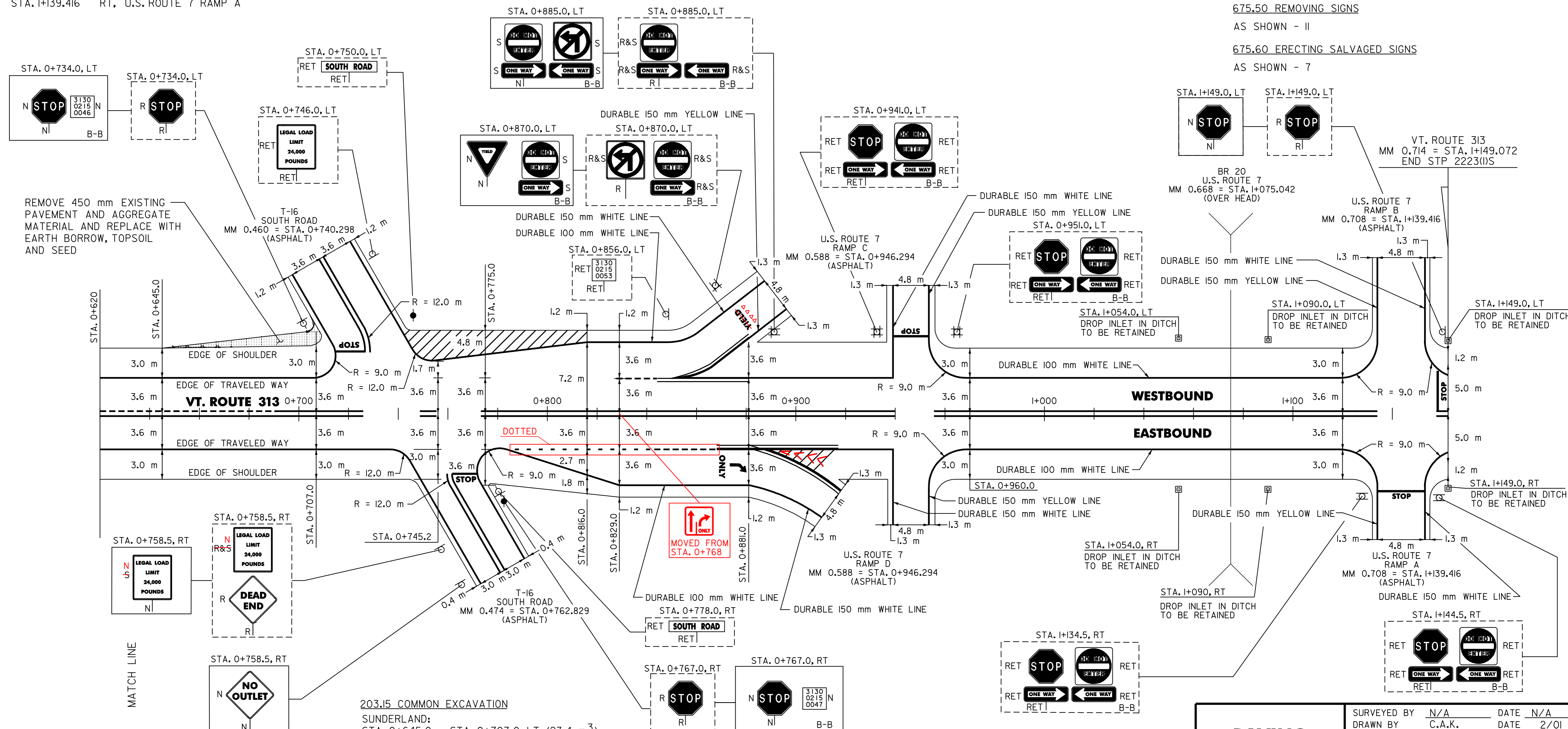

DATUM

| | |
|------------|-----|
| VERTICAL | N/A |
| HORIZONTAL | N/A |

- 203.15 COMMON EXCAVATION**
 SUNDERLAND:
 STA. 0+645.0 - STA. 0+707.0 LT (23.4 m³)
- 203.28 EXCAVATION OF SURFACES AND PAVEMENTS**
 SUNDERLAND:
 STA. 0+645.0 - STA. 0+707.0 LT (9 m³)
- 203.30 EARTH BARROW**
 SUNDERLAND:
 STA. 0+645.0 - STA. 0+707.0 LT (32.4 m³)

NOTE:
 1. PAVING LIMIT ON ALL TOWN HIGHWAYS & INTERCHANGE RAMP SHALL BE MEASURED 8 m BACK FROM VT. ROUTE 313 EDGE OF SHOULDER UNLESS DENOTED OTHERWISE ON THE PLANS OR AS DIRECTED BY THE RESIDENT ENGINEER

- SIGN LEGEND
- R= REMOVE
 - S= SALVAGE
 - N= NEW
 - RET= RETAIN
 - B-B= BACK TO BACK
 - EXISTING=
 - NEW=

PAVING PROJECT LAYOUT # 6

| | | | |
|-----------------|------------------------|--------------|---------------|
| SURVEYED BY | N/A | DATE | N/A |
| DRAWN BY | C.A.K. | DATE | 2/01 |
| SQUAD LEADER | T.P.K. | | |
| DESIGN FILE NO. | /pave/99b198/pb198.dgn | | |
| IPARM FILE | pb198106.i | DATE PLOTTED | APR-2007 10:4 |
| PROJ. NAME | ARLINGTON - SUNDERLAND | | |
| PROJ. NO. | STP 2223(IIS) | | |
| SHEET 13 OF 16 | SHEETS | | |