

**TEMPORARY AND DURABLE 100 mm YELLOW LINE**

STA 8+000	TO	8+433	DASHED	462
STA 8+433	TO	8+514	DASHED LT, SOLID RT	560
STA 8+514	TO	8+529	SOLID LT & RT	
STA 8+535	TO	8+600	DOUBLE SOLID RT (TH #8)	
STA 8+541	TO	8+600	SOLID LT & RT	

**TEMPORARY AND DURABLE 100 mm WHITE LINE**

STA 8+000	TO	8+600	LT
STA 8+000	TO	8+532	RT
STA 8+538	TO	8+600	RT

**TEMPORARY AND DURABLE 600 mm STOP BAR**

STA 8+535	RT (TH #8)
-----------	------------

**TEMPORARY AND DURABLE LETTER OR SYMBOL**

STA 8+535	RT - "STOP" (TH 8)
-----------	--------------------

**STEEL BEAM GUARDRAIL**

STA 8+044	TO	8+188	RT
STA 8+387	TO	8+520	RT 531
STA 8+390	TO	8+436	LT
STA 8+500	TO	8+515	LT

**DELINEATORS WITH STEEL POSTS**

STA. 8+033	RT
STA. 8+199	RT
STA. 8+376	RT
STA. 8+379	LT
STA. 8+436	LT
STA. 8+495	LT
STA. 8+526	LT
STA. 8+531	RT

**REMOVAL & DISPOSAL OF GUARDRAIL**

STA 8+033	TO	8+201	LT
STA 8+377	TO	8+531	RT
STA 8+381	TO	8+419	LT
STA 8+489	TO	8+527	LT

**REMOVING SIGNS**  
AS SHOWN - 3

**ERECTING SALVAGED SIGNS**  
AS SHOWN - 2-1

**ANCHOR FOR STEEL BEAM RAIL**  
STA. 8+495 LT  
STA. 8+525 RT

**YIELDING MARKER POSTS**  
STA. 8+025 RT  
STA. 8+027 LT  
STA. 8+117 LT  
STA. 8+117 RT  
STA. 8+222 RT  
STA. 8+241 LT

**MANUFACTURED TERMINAL SECTION (FLARED)**

STA 8+044	RT
STA 8+188	RT
STA 8+387	RT
STA 8+390	LT
STA 8+436	LT
STA 8+500	LT
STA 8+515	LT - TANGENTIAL, CHANGED BY S.A./C.O. #3 DATED 1/12/05
STA 8+520	RT

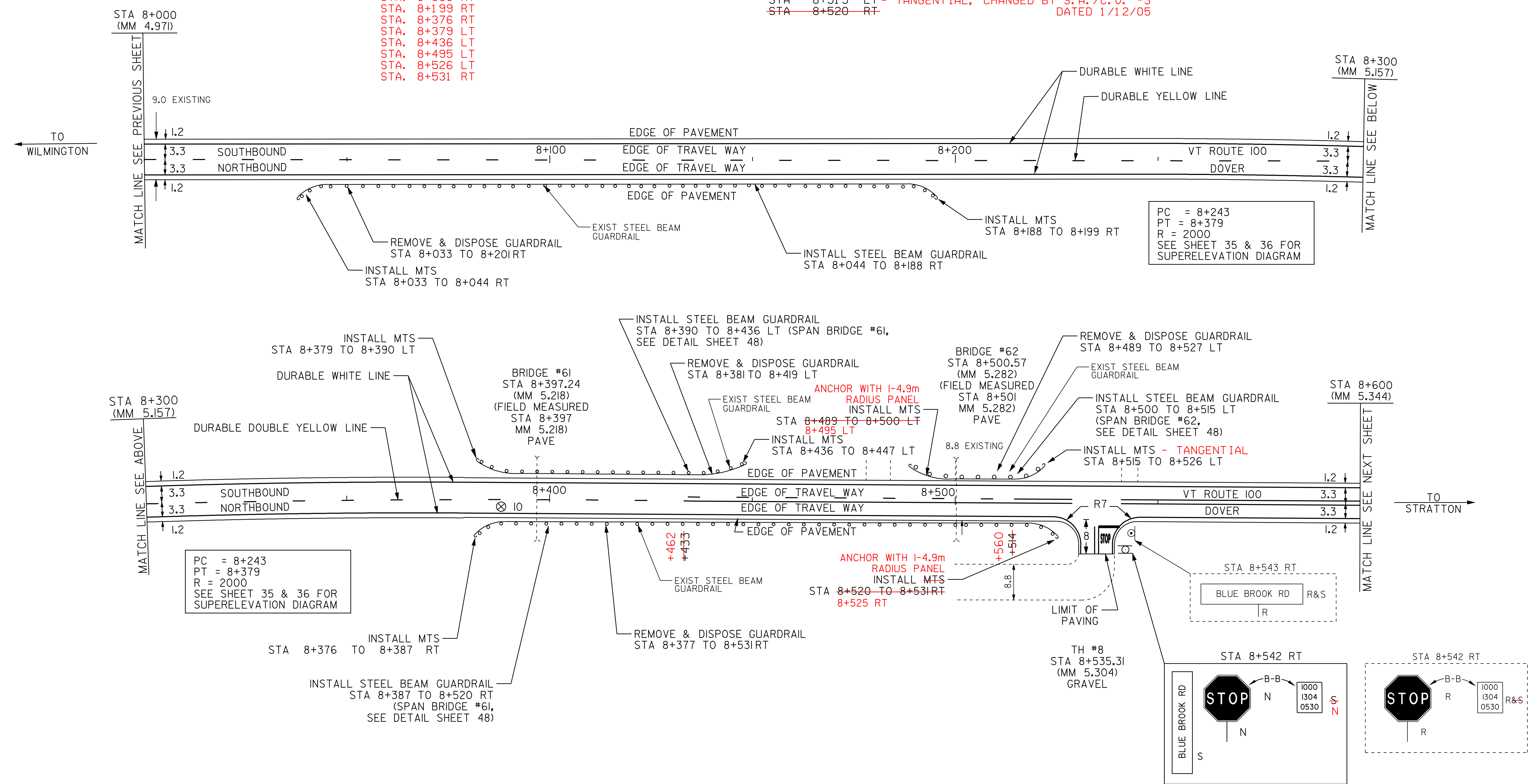

PC = 8+243  
PT = 8+379  
R = 2000  
SEE SHEET 35 & 36 FOR SUPERELEVATION DIAGRAM

PC = 8+243  
PT = 8+379  
R = 2000  
SEE SHEET 35 & 36 FOR SUPERELEVATION DIAGRAM

ANCHOR WITH 1-4.9m RADIUS PANEL  
INSTALL MTS  
STA 8+520 TO 8+531 RT  
8+525 RT

**LEGEND**

R	=	REMOVE EXISTING
S	=	SALVAGE
R&S	=	REMOVE AND SALVAGE
N	=	NEW
RET	=	RETAIN
B-B	=	BACK TO BACK
○	=	NEW RAIL
○	=	EXISTING RAIL
⊗	=	BORING LOCATION

NOTE: ALL DIMENSIONS IN METERS EXCEPT AS INDICATED

**DATUM**

VERTICAL	N/A
HORIZONTAL	N/A

**PAVEMENT CORES**

STA	TOTAL DEPTH (MM)	PCC
10 STA 8+388 RT	178	NO

NOT TO SCALE

**PAVING PROJECT LAYOUT #16**

<b>PROJECT:</b> DOVER-STRATTON	<b>PROJECT NO.:</b> STP 2214(I)S
DESIGN FILE NAME: /pave/99bl80/pbl80.dgn	PLOT DATE: 24-MAY-2007
IPARM FILE NAME: pbl80i16.1	SURVEY DATE: 5/00
SURVEYED BY: CLD ENGINEERS, INC	DRAWN BY: MPS
SQUAD LEADER: WRH	SHEET: 25 OF 49