

TEMPORARY AND DURABLE 100 mm YELLOW LINE
 STA 6+200 TO 6+341 DASHED 357
 STA 6+341 57 TO 6+620 DASHED LT, SOLID RT 654
 STA 6+620 54 TO 6+636 SOLID LT & RT
 STA 6+642 DOUBLE SOLID LT (SKI AREA ROAD)
 STA 6+648 TO 6+727 SOLID LT & RT 751
 STA 6+727 51 TO 6+800 SOLID LT, DASHED RT

TEMPORARY AND DURABLE 100 mm WHITE LINE
 STA 6+200 TO 6+800 SOLID RT
 STA 6+200 TO 6+636 SOLID LT
 STA 6+648 TO 6+800 SOLID LT

TEMPORARY AND DURABLE LETTER OR SYMBOL
 STA 6+638 LT - "STOP"

REMOVAL & DISPOSAL OF GUARDRAIL
 STA 6+200 TO 6+247 RT
 STA 6+200 TO 6+247 LT

MANUFACTURED TERMINAL SECTION (FLARED)
 STA 6+235 RT
 STA 6+235 LT

REMOVING SIGNS
 AS SHOWN - 2-3

ERECTING SALVAGED SIGNS
 AS SHOWN - 1

YIELDING MARKER POSTS
 STA. 6+394 LT
 STA. 6+405 RT
 STA. 6+487 LT
 STA. 6+517 RT
 STA. 6+641 RT

TEMPORARY AND DURABLE 600 mm STOP BAR
 STA 6+638 LT

EROSION MATTING
 STA. 6+652 TO 6+672 RT

STEEL BEAM GUARDRAIL
 STA 6+200 TO 6+235 RT
~~STA 6+200 TO 6+235 LT~~

STEEL BEAM GUARDRAIL - 2.4 POSTS (MOD.)
 STA 6+200 TO 6+235 LT

THINNING AND TRIMMING FOR SIGNS
 STA 6+636 LT

DELINEATORS WITH STEEL POSTS
 STA. 6+235 LT
 STA. 6+235 RT

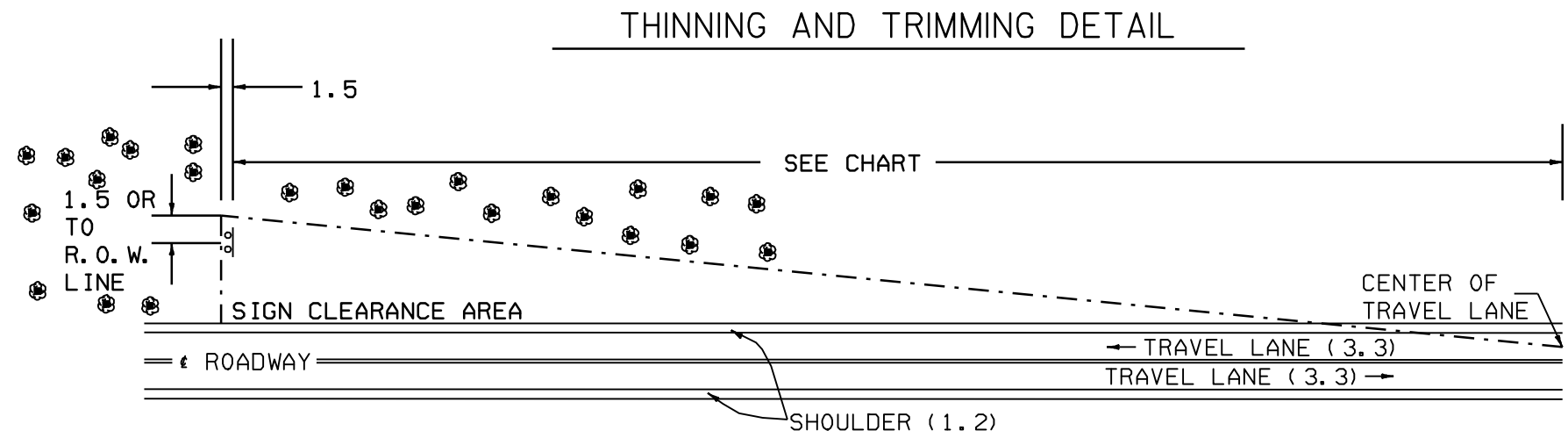
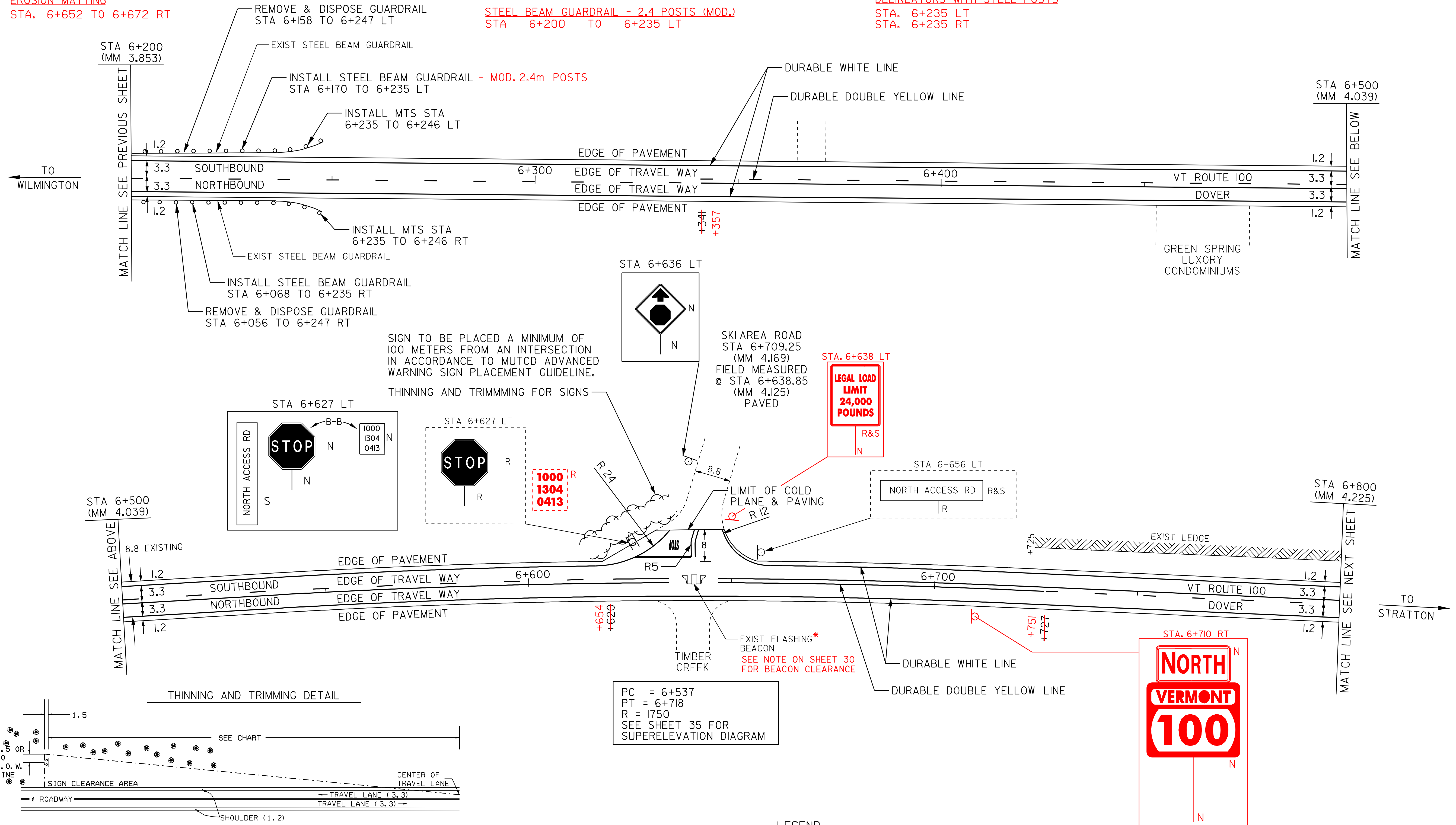

MINIMUM SIGN SIGHT DISTANCE CHART

APPROACH SPEED (km/hr)	SIGHT DISTANCE (meters)
50 OR LESS	91
55	107
65	122
70	137
80	152
90	168

- LEGEND**
- R = REMOVE EXISTING
 - S = SALVAGE
 - R&S = REMOVE AND SALVAGE
 - N = NEW
 - RET = RETAIN
 - B-B = BACK TO BACK
 - = NEW RAIL
 - - - = EXISTING RAIL
 - ⊗ = BORING LOCATION

NOTE: ALL DIMENSIONS IN METERS EXCEPT AS INDICATED

DATUM
 VERTICAL N/A
 HORIZONTAL N/A

NOT TO SCALE

PAVING PROJECT LAYOUT #13

PROJECT: DOVER-STRATTON	PROJECT NO.: STP 2214(I)S
DESIGN FILE NAME: /pave/99bl80/pbl80.dgn	PLOT DATE: 24-MAY-2007
IPARM FILE NAME: pbl80i13.1	SURVEY DATE: 5/00
SURVEYED BY: CLD ENGINEERS, INC	DRAWN BY: MPS
SQUAD LEADER: WRH	SHEET: 22 OF 49