

TEMPORARY & DURABLE 100 mm WHITE LINE
 STA. 1+820.0 TO 2+200.0, SOLID LT. & RT.
 (WITH EDGELINE BREAK FOR BLANCHARD ROAD)

TEMPORARY & DURABLE 100 mm YELLOW LINE
 STA. 1+820.0 TO 2+200.0, SOLID LT. & RT.
 (WITH CENTERLINE BREAK FOR BLANCHARD ROAD)

REMOVING SIGNS
 AS SHOWN - 5

ERECTING SALVAGED SIGNS
 AS SHOWN - 2

DITCH CLEANING
 STA. 1+820.0 TO 2+132.4, RT. (SITE 7)
 (FOR DETAILS, SEE SHEET 6)

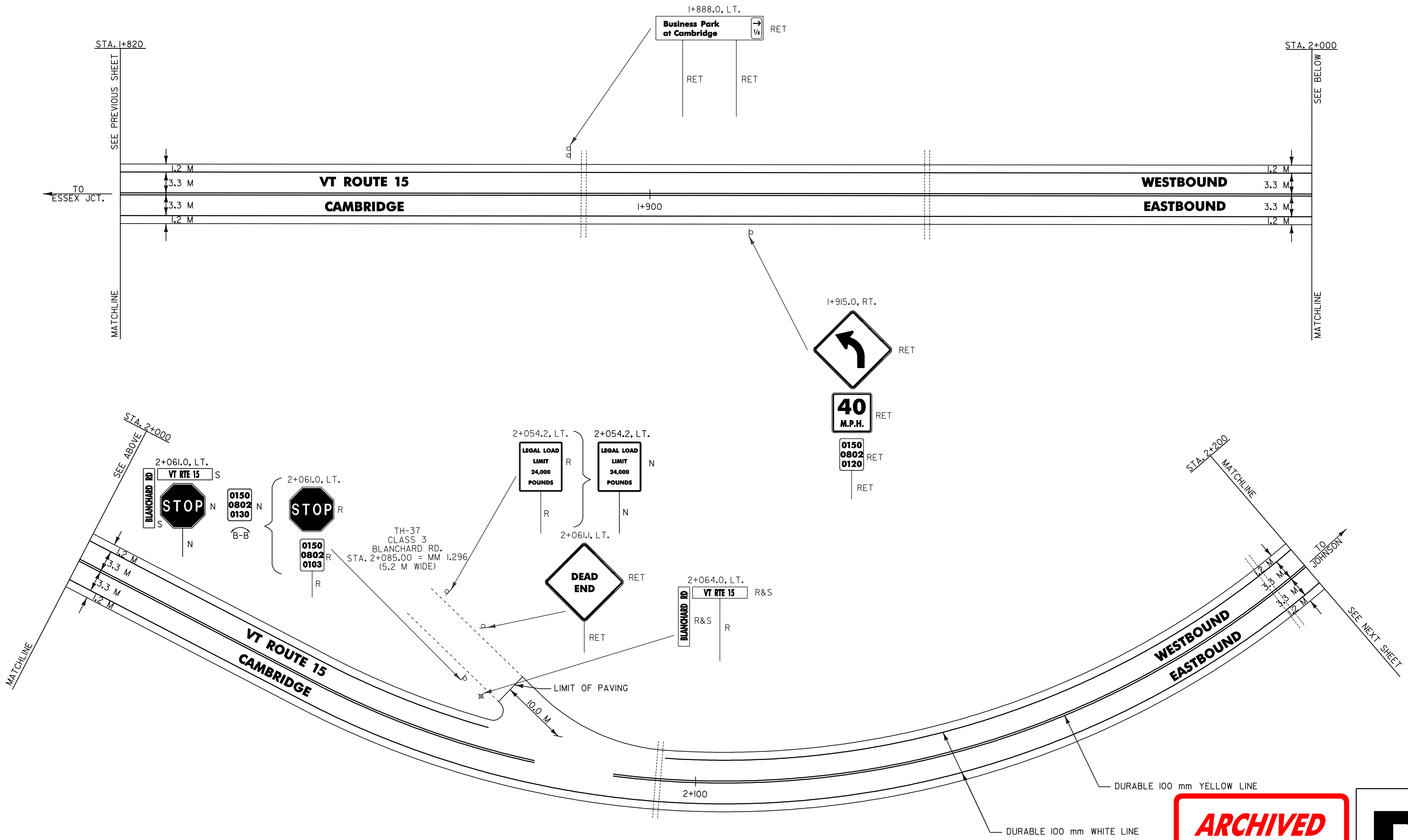

**ARCHIVED
IN DPR**



- NOTES: 1) ALL DIMENSIONS IN MILLIMETERS EXCEPT WHERE OTHERWISE INDICATED.
 2) FOR ANY TOWN HIGHWAY OR STREET DETAILS, SEE VTTRANS STANDARD E-193M.
 3) EW = EXISTING ROADWAY WIDTH

LAYOUT SHEET #19

PROJECT NAME: UNDERHILL - CAMBRIDGE	PLOT DATE: 26-JAN-2006 11:0
PROJECT NUMBER: STP 2212(1)S	DRAWN BY: D-H
FILE NAME: Z:\pave\99bl76\pb176.dgn	CHECKED BY:
DESIGNED BY: D-H	SHEET 28 OF 36
IPARM FILE NAME: pb17619.i	