

TEMPORARY & DURABLE 100 mm WHITE LINE
 UNDERHILL STA. 7+800.0 TO 7+956.6, SOLID LT. & RT.
 WESTFORD STA. 0+000.0 TO 0+260.0, SOLID LT. & RT.

TEMPORARY & DURABLE 100 mm YELLOW LINE
 UNDERHILL STA. 7+800.0 TO 7+956.6, SOLID LT. & RT.
 WESTFORD STA. 0+000.0 TO 0+260.0, SOLID LT. & RT.

MANUFACTURED TERMINAL SECTION (FLARED)
 STA. 0+002.1 TO 0+013.5, RT.
 STA. 0+081.9 TO 0+093.3, RT.
 STA. 0+198.7 TO 0+210.1, RT.

STEEL BEAM GUARD RAIL W/2.4 METER POSTS (MOD.)
 STA. 0+013.5 TO 0+060.0, RT.
 STA. 0+060.0 TO 0+081.9, RT.
 STA. 0+210.1 TO 0+260.0, RT.

REMOVAL AND DISPOSAL OF GUARD RAIL
 STA. 0+002.0 TO 0+060.0, RT.
 STA. 0+060.0 TO 0+090.0, RT.
 STA. 0+199.0 TO 0+260.0, RT.



UNDERHILL STA. 7+956.60 = MM 4.944
WESTFORD STA. 0+000.00 = MM 0.000
UNDERHILL - WESTFORD TOWN LINE

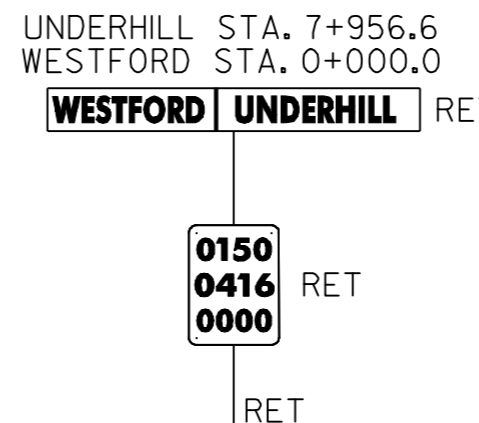
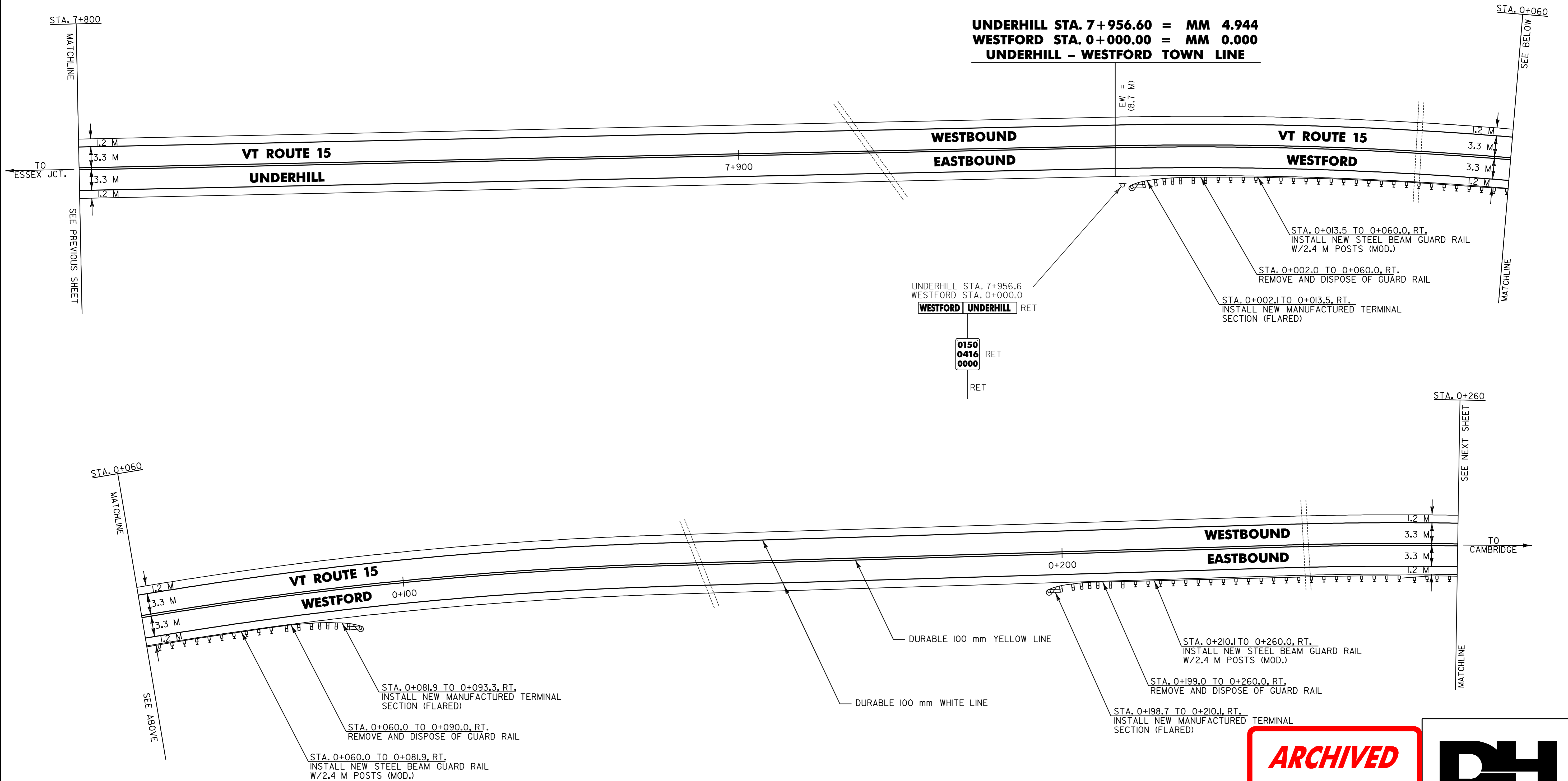

**ARCHIVED
 IN DPR**



- NOTES: 1) ALL DIMENSIONS IN MILLIMETERS EXCEPT WHERE OTHERWISE INDICATED.
 2) FOR ANY TOWN HIGHWAY OR STREET DETAILS, SEE VTTRANS STANDARD E-193M.
 3) EW = EXISTING ROADWAY WIDTH

LAYOUT SHEET #3

PROJECT NAME: UNDERHILL - CAMBRIDGE	FILE NAME: Zpqve299bl76Zpb176.dgn	PLOT DATE: 26-JAN-2006 11:0
PROJECT NUMBER: STP_2212(1)S	PROJECT LEADER: JLL	DRAWN BY: D-H
	DESIGNED BY: D-H	CHECKED BY:
	IPARM FILE NAME: pb17613.1	SHEET 12 OF 36