

**CONSTRUCTION APPROACH SIGNING**

NOT TO SCALE  
SEE STD E-100, E-100A AND E-103  
FOR SIGN PLACEMENT

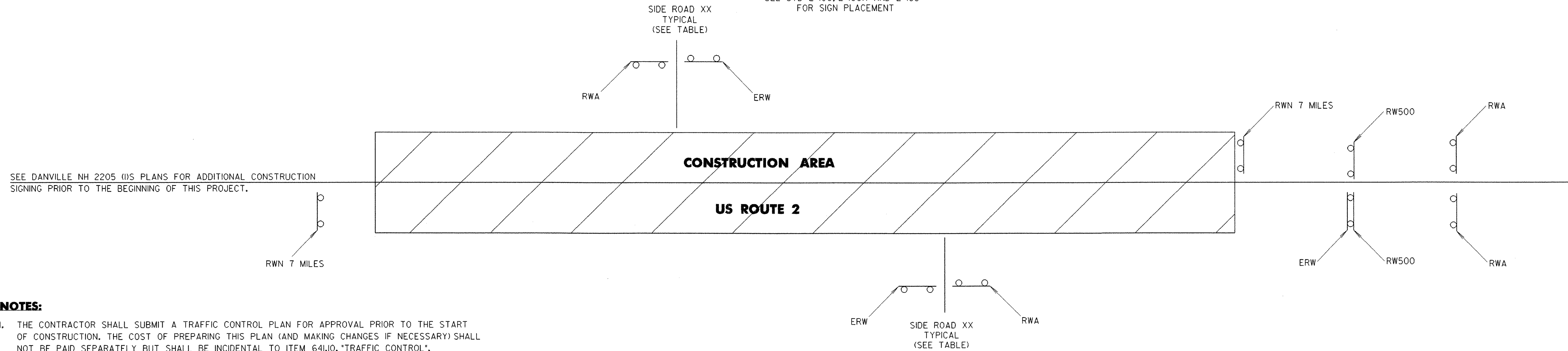

SEE DANVILLE NH 2205 (I)S PLANS FOR ADDITIONAL CONSTRUCTION SIGNING PRIOR TO THE BEGINNING OF THIS PROJECT.

**NOTES:**

- THE CONTRACTOR SHALL SUBMIT A TRAFFIC CONTROL PLAN FOR APPROVAL PRIOR TO THE START OF CONSTRUCTION. THE COST OF PREPARING THIS PLAN (AND MAKING CHANGES IF NECESSARY) SHALL NOT BE PAID SEPARATELY BUT SHALL BE INCIDENTAL TO ITEM 641J0, "TRAFFIC CONTROL".
- THE CONTRACTOR SHALL INCLUDE A CONSTRUCTION SIGN APPROACH PACKAGE FOR EXPECTED LANE CLOSURES AND WORK ZONE SPEED REDUCTIONS IN COMPLIANCE WITH VTRANS STANDARD E-103. PAYMENT FOR PROVIDING THIS PACKAGE SHALL BE INCIDENTAL TO ITEM 641J0, "TRAFFIC CONTROL".
- ADDITIONAL SIGNING ON THE INTERSTATE 91(I-91) MAINLINE AND RAMPS ASSOCIATED WITH I-91 MAY BE REQUIRED AS DIRECTED BY THE RESIDENT ENGINEER.
- THE BID PRICE FOR "TRAFFIC CONTROL", ITEM 641J0, SHALL INCLUDE ALL OF THE FOLLOWING, AS NEEDED: APPROACH AND ON-PROJECT CONSTRUCTION SIGNING, PORTABLE ARROW BOARDS, BARRIERS, BARRELS, CONES, BARRICADES, TEMPORARY REGULATORY AND WARNING SIGNS, AND POSTS AS DETAILED IN VTRANS STANDARDS. ALL ADJUSTING, RELOCATING, AND REMOVING OF THESE DEVICES AS DIRECTED BY THE RESIDENT ENGINEER SHALL ALSO BE INCLUDED. THE FOLLOWING ITEMS WILL BE PAID FOR SEPARATELY: 646.602, 646.612, 646.622, 646.632, 646.662, 646.672, 646.682, AND 646.692 - TEMPORARY PAVEMENT MARKINGS 630J0 AND 630J5 - UNIFORMED TRAFFIC OFFICERS AND FLAGGERS
- PORTABLE CHANGEABLE MESSAGE SIGNS (PCMS) WILL BE PROVIDED FOR USE ALONG THIS PROJECT. THE PLACEMENT OF THESE UNITS AS WELL AS THE MESSAGE WILL BE APPROVED BY THE RESIDENT ENGINEER. THESE SIGNS WILL BE PAID FOR UNDER ITEM 641J5, "PORTABLE CHANGEABLE MESSAGE SIGN".  
  
PCMS SHOULD NOT REPLACE ANY OF THE SIGNING DETAILED IN THE MUTCD AND SHOULD NOT BE USED IF STANDARD TRAFFIC CONTROL DEVICES ADEQUATELY PROVIDE THE INFORMATION THE MOTORISTS NEED TO TRAVEL SAFELY.  
  
THE PCMS SHALL CONSIST OF EITHER ONE OR TWO PHASES. TYPICALLY, A PHASE SHALL CONSIST OF UP TO THREE LINES OF EIGHT CHARACTERS PER LINE. THE PCMS SHOULD BE USED AS A SUPPLEMENT AND NOT AS A SUBSTITUTE FOR CONVENTIONAL SIGNS AND PAVEMENT MARKINGS.  
  
THE PCMS SHOULD COMMUNICATE WHAT INFORMATION MOTORISTS NEED TO KNOW. UNNECESSARY INFORMATION SHOULD BE AVOIDED. MESSAGES SHOULD BE UPDATED PERIODICALLY TO DESCRIBE THE WORK ACTIVITY OCCURRING SO THAT THE PCMS CONTINUES TO COMMAND THE ATTENTION OF MOTORISTS.
- THE MUTCD 2003 SHALL BE THE STANDARD FOR ALL TRAFFIC CONTROL DEVICES. EXISTING SIGNS, SIGNALS AND MARKINGS SHALL BE VALID UNTIL SUCH TIME AS THEY ARE REPLACED OR RECONSTRUCTED. WHEN NEW TRAFFIC CONTROL DEVICES ARE ERECTED OR PLACED OR EXISTING TRAFFIC CONTROL DEVICES ARE REPLACED OR REPAIRED THE EQUIPMENT, DESIGN, METHOD OF INSTALLATION, PLACEMENT OR REPAIR SHALL CONFORM WITH SUCH STANDARDS.
- NO CONSTRUCTION SIGNS SHALL BE INSTALLED AS TO INTERFERE OR OBSTRUCT THE VIEW OF EXISTING TRAFFIC CONTROL DEVICES, STOPPING SIGHT DISTANCE, AND CORNER SIGHT DISTANCE FROM DRIVES AND TOWN HIGHWAYS. TRAFFIC CONTROL DEVICES SHALL BE SPACED ACCORDING TO THE 2003 MUTCD AND/OR VTRANS STANDARDS.
- ON VTRANS STANDARD E-103, SIGN W4-2 MAY BE REPLACED WITH W9-2:

SIDE ROAD NAME	ROAD WORK AHEAD	SIDE ROAD WORK AHEAD	SIDE ROAD WORK 500 FT	END ROAD WORK	ROAD WORK 500 FT	ROAD WORK NEXT 7 MILES
<b>DANVILLE</b>						
BEGIN PROJECT (US 2)						1
TH #61 (PENNY LANE)	1			1		
TH 38 (DOLE HILL ROAD)	1			1		
TH #90 (OLD STAGECOACH ROAD)	1			1		
TH #39 (RED BARN ROAD)	1			1		
TH #12 (PARKER ROAD)	1			1		
TH #40 (JAMESON ROAD)	1			1		
VT 2B (CROSS ROAD)	1			1		
<b>ST. JOHNSBURY</b>						
TH #7 (NORTH DANVILLE ROAD)	1			1		
VT 2B	1			1		
END PROJECT (U.S. ROUTE 2)	2			1	2	1
TOTALS	11			10	2	2

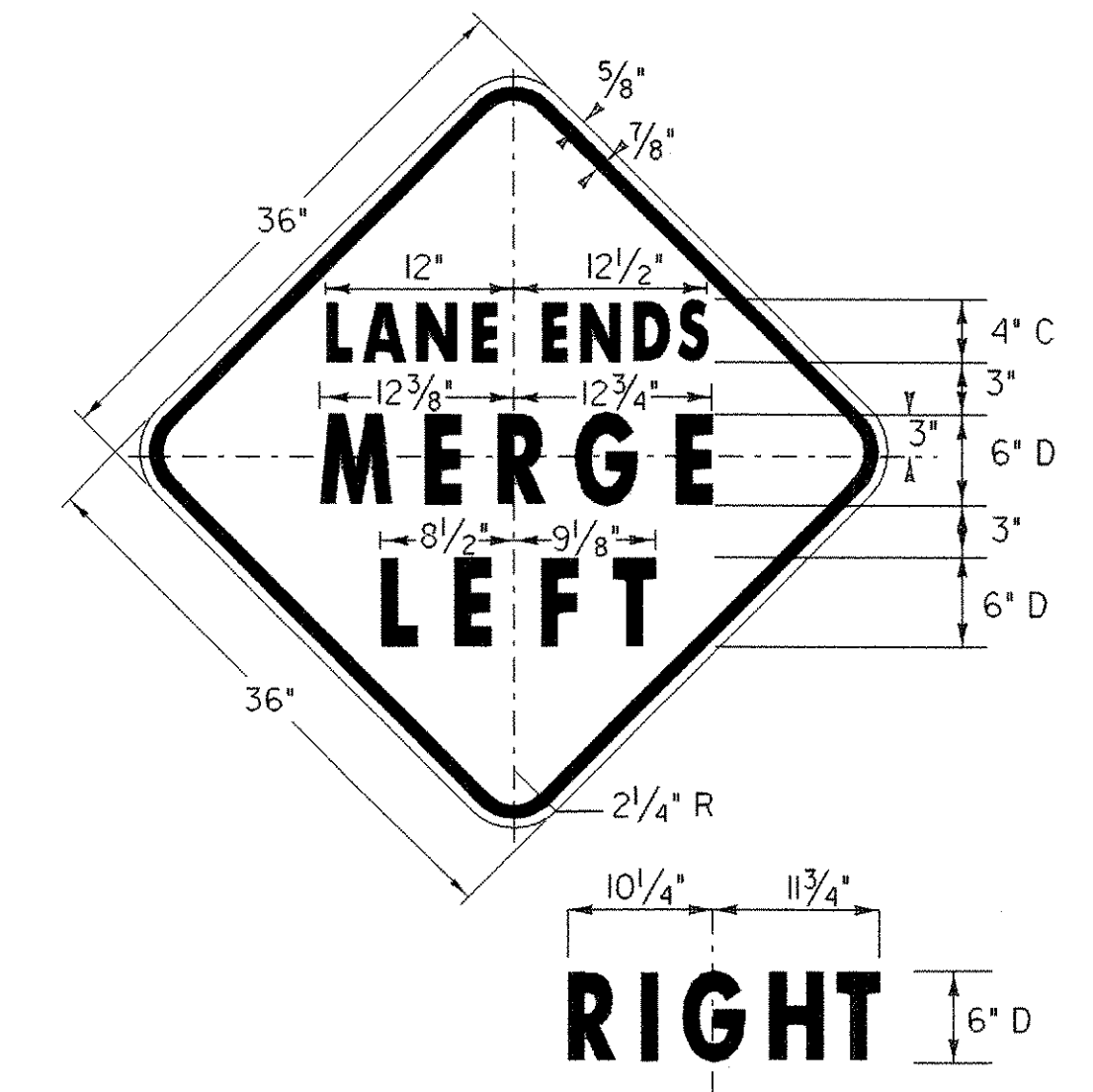

**NOTE:**  
1. "MERGE" - D (10% SPACING)

- LEGEND**
- RWA = ROAD WORK AHEAD
  - RW500 = ROAD WORK 500 FT
  - SRWA = SIDE ROAD WORK AHEAD
  - SRW500 = SIDE ROAD WORK 500 FT
  - ERW = END ROAD WORK
  - RWN = ROAD WORK NEXT 7 MILES

**ALL DETAILS NOT TO SCALE**



<b>CONSTRUCTION APPROACH SIGNING SHEET</b>	PROJECT NAME: DANVILLE - ST. JOHNSBURY
	PROJECT NUMBER: NH 2501(I)S
	FILE NAME: pave/05b034/05b034 PROJECT LEADER: EPD DESIGNED BY: JDA PLOT FILE: 05b034cas.i
	PLOT DATE: 12-JAN-2007 DRAWN BY: JAR CHECKED BY: EPD SHEET 63 OF 63