

646.426 DURABLE 6" WHITE LINE, RECESSED  
 STA. 60+50 - STA. 74+50 (SOLID LT & RT)  
 STA. 60+50 - STA. 74+50 (DASHED LT)  
 STA. 60+50 - STA. 74+50 (DASHED RT)  
 STA. 61+80 - STA. 64+45 (SOLID LT)  
 STA. 64+45 - STA. 66+84 (DOTTED LT)  
 (WITH BREAKS FOR SIDE ROAD)

646.436 DURABLE 6" YELLOW LINE, RECESSED  
 STA. 60+50 - STA. 61+49 (SOLID LT & RT)  
 STA. 61+73 - STA. 74+50 (SOLID LR & RT)  
 STA. 61+61 (DOUBLE SOLID CENTERLINE)

646.622 TEMPORARY 6" WHITE LINE, PAINT  
 STA. 60+50 - STA. 74+50 (SOLID LT & RT)  
 STA. 60+50 - STA. 74+50 (DASHED LT)  
 STA. 60+50 - STA. 74+50 (DASHED RT)  
 STA. 61+80 - STA. 64+45 (SOLID LT)  
 STA. 64+45 - STA. 66+84 (DOTTED LT)  
 (WITH BREAKS FOR SIDE ROAD)

646.692 TEMPORARY LETTER OR SYMBOLS, PAINT  
 STA. 61+38 LT "STOP"  
 STA. 61+54 RT "STOP"  
 STA. 61+67 LT "STOP"  
 STA. 61+98 LT ARROW

646.632 TEMPORARY 6" YELLOW LINE, PAINT  
 STA. 60+50 - STA. 61+49 (SOLID LT & RT)  
 STA. 61+73 - STA. 74+50 (SOLID LR & RT)  
 STA. 61+61 (DOUBLE SOLID CENTERLINE)

646.682 TEMPORARY 24" STOP BAR, PAINT  
 STA. 61+33 - STA. 61+45 LT  
 STA. 61+42 - STA. 61+61 RT  
 STA. 61+61 - STA. 61+79 LT

**SIGN LEGEND**  
 R = REMOVE  
 S = SALVAGE  
 N = NEW  
 RET = RETAIN  
 B-B = BACK TO BACK

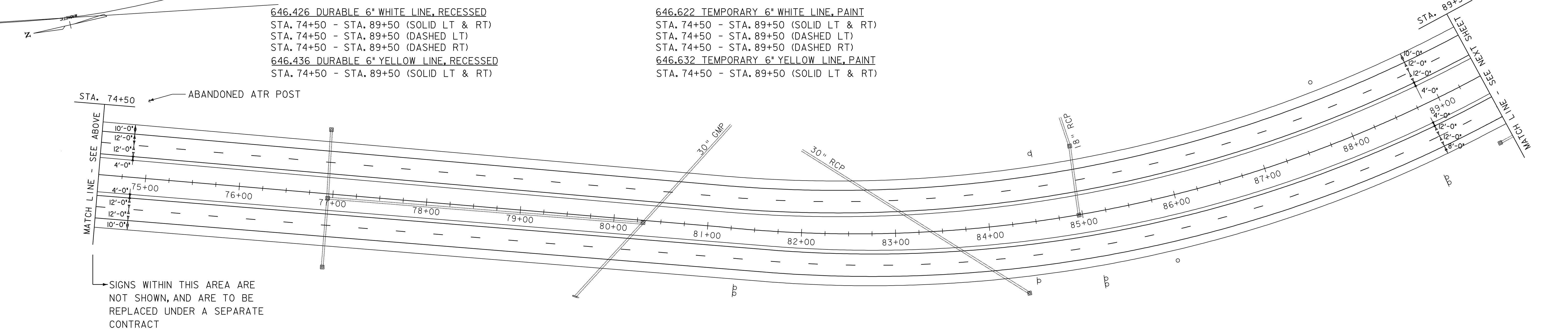

646.426 DURABLE 6" WHITE LINE, RECESSED  
 STA. 74+50 - STA. 89+50 (SOLID LT & RT)  
 STA. 74+50 - STA. 89+50 (DASHED LT)  
 STA. 74+50 - STA. 89+50 (DASHED RT)

646.622 TEMPORARY 6" WHITE LINE, PAINT  
 STA. 74+50 - STA. 89+50 (SOLID LT & RT)  
 STA. 74+50 - STA. 89+50 (DASHED LT)  
 STA. 74+50 - STA. 89+50 (DASHED RT)

SIGNS WITHIN THIS AREA ARE NOT SHOWN, AND ARE TO BE REPLACED UNDER A SEPARATE CONTRACT

**SIGN LEGEND**  
 R = REMOVE  
 S = SALVAGE  
 N = NEW  
 RET = RETAIN  
 B-B = BACK TO BACK

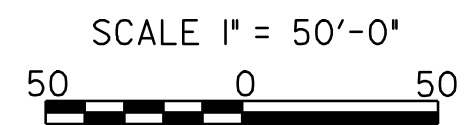

**PROJECT LAYOUT SHEET 11**

PROJECT NAME:	PROJECT NUMBER: NH 2501(I)S
FILE NAME: pave/05b034/05b034	PLOT DATE: 19-JUN-2009 16:17
PROJECT LEADER: EPD	DRAWN BY: JAR
DESIGNED BY: JDA	CHECKED BY: EPD
PLOT FILE: 05b034pl1.i	SHEET 43 OF 63

<b>DATUM</b>	
VERTICAL	N/A
HORIZONTAL	N/A