

INDEX OF SHEETS

1	TITLE SHEET
2-3	PROJECT TYPICAL SHEET
4-5	QUANTITY SHEETS
6	ITEM DETAIL SUMMARY SHEET
7-14	LAYOUT SHEETS
15-17	TRAFFIC SIGN SUMMARY SHEETS
18	MISCELLANEOUS DETAILS
19	CONSTRUCTION APPROACH SIGNING

**STATE OF VERMONT
AGENCY OF TRANSPORTATION**



**TOWNS OF DORSET, MT. TABOR, AND DANBY
COUNTIES OF BENNINGTON AND RUTLAND
U.S. ROUTE 7**

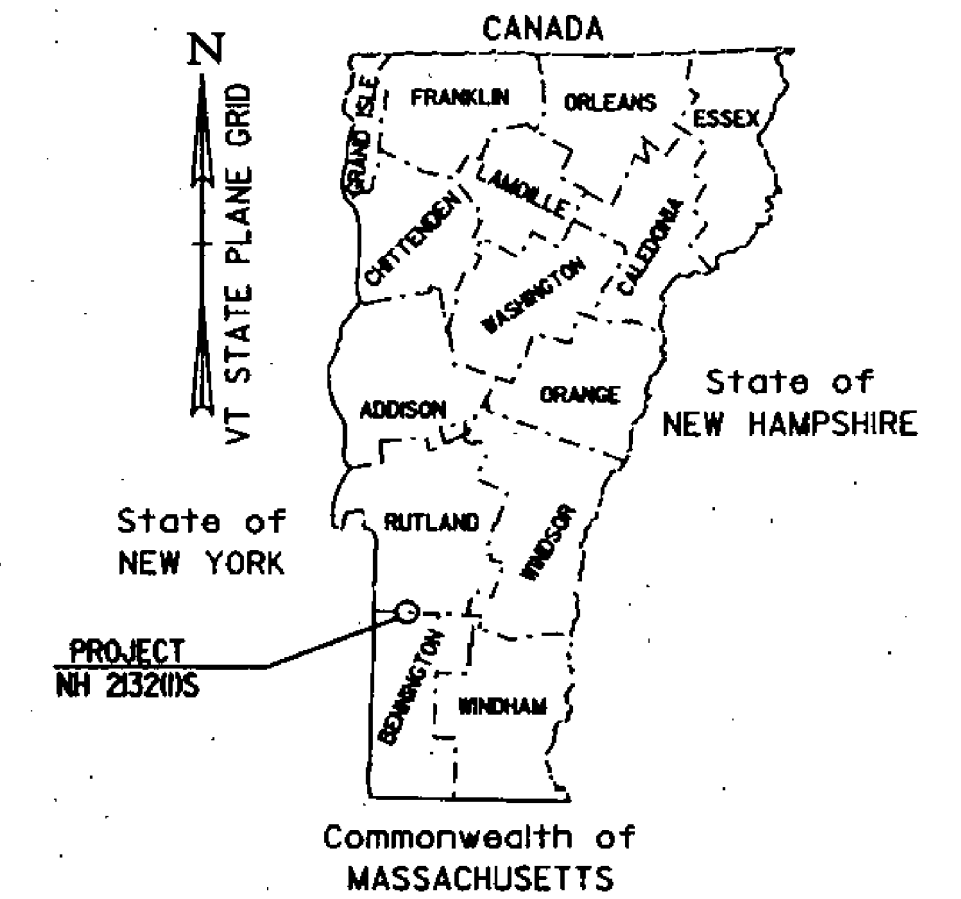

VAOT STANDARDS

E-100	CONSTRUCTION APPROACH SIGNS	01-06-97
E-101	CONSTRUCTION SIGN DETAILS	03-10-97
E-102	CONSTRUCTION SIGN DETAILS	08-08-95
E-102A	CONSTRUCTION SIGN DETAILS	08-08-95
E-103	MAINLINE TRAFFIC CONTROL, DIVIDED HIGHWAY, ONE LANE CLOSED	09-23-98
E-106	TRAFFIC CONTROL MISCELLANEOUS DETAILS	08-08-95
E-107	DELINEATION, BARRICADES AND DETOURS FOR CONSTRUCTION AREAS	08-08-95
E-107A	BREAKAWAY BARRICADE DETAILS	08-08-95
E-108	CONSTRUCTION ZONE LONGITUDINAL DROP OFFS	08-18-95
E-110	MAJOR MAINTENANCE OPERATION LANE CLOSURE	08-08-95
E-120	STANDARD SIGN PLACEMENT EXPRESSWAY AND FREEWAY	08-08-95
E-121	STANDARD SIGN PLACEMENT CONVENTIONAL ROAD	08-08-95
E-141	REGULATORY SIGN DETAILS	09-20-95
E-151	WARNING SIGN DETAILS	08-08-95
E-152	WARNING SIGN DETAILS	08-08-95
E-160	FLANGED CHANNEL STEEL SIGN POST	08-18-95
E-164	SQUARE STEEL SIGN POST	08-18-95
E-191	PAVEMENT MARKING DETAILS	08-18-95
E-192	PAVEMENT MARKING DETAILS	10-14-98
G-1d	STEEL BEAM GUARD RAIL HEAVY DUTY STEEL BEAM GUARD RAIL STEEL BEAM MEDIAN BARRIER ANCHOR FOR STEEL BEAM RAIL	06-01-94

BEGINNING IN DORSET AT A POINT APPROXIMATELY 2.159 MILES NORTH OF THE DORSET/MANCHESTER TOWN LINE, EXTENDING NORTHERLY ALONG U.S. ROUTE 7 FOR A ROADWAY LENGTH OF 9.130 MILES TO DANBY MILE MARKER 0.388.

MILE MARKER TO MILE MARKER DATA	LENGTH (FEET)	LENGTH (MILES)
TOWN OF DORSET U.S. ROUTE 7 STA. 114+00.00 (MM 2.159) TO STA. 189+02.00 (MM 3.580)	7502.00	1.421
TOWN OF MOUNT TABOR U.S. ROUTE 7 STA. 101+00.00 (MM 1.913) TO STA. 147+25.00 (MM 2.789)	4625.00	0.876
TOWN OF DANBY U.S. ROUTE 7 STA. 206+00.00 (MM 3.902) TO STA. 220+86.24 (MM 4.183)	1486.24	0.281
TOWN OF DANBY U.S. ROUTE 7 STA. 0+00.00 (MM 0.000) TO STA. 20+50.00 (MM 0.388)	2050.00	0.388
	<u>15663.24</u>	<u>2.966</u>

LENGTH OF ROADWAY 48,206.00 FEET = 9.130 MILES
LENGTH OF PROJECT 15,663.24 FEET = 2.966 MILES

WORK TO BE PERFORMED UNDER THIS PROJECT INCLUDES: SHOULDER REHABILITATION, RESURFACING OF THE EXISTING HIGHWAY, GUARD RAIL IMPROVEMENTS, ASSOCIATED PAVEMENT MARKINGS AND INCIDENTAL ITEMS.

TRAFFIC DATA

	2000 ADT (DHV)	2010 ADT (DHV)	95-05 ESAL'S
VT 7A (DORSET TO TH 22/TH 116)	6680 (850)	7820 (960)	1,968,000
TH 22/TH 16 TO TH 1 (MT. TABOR)	5020 (675)	5880 (775)	1,479,000
TH 1 (MT. TABOR) TO TH 59 (WALLINGFORD)	4920 (665)	5760 (760)	1,450,000

SEP 16 1999

Date _____
Pike Industries, Inc.
Contractor
Jim Smalley
Signature
Contracts Administrator
Title
Ellen Kemana
Director of Administration And Duly Authorized Agent

CONTRACT PLANS

THESE PLANS DO NOT REFLECT CHANGES MADE ON THE PROJECT.

CONVENTIONAL SIGNS

COUNTY LINE	---
TOWN LINE	- - - -
LIMITS OF ACCESS	○-○-○-○
POINT OF ACCESS	X
FENCE LINE	-x-x-
STONE WALL	- - - -
TRAVELED WAY	— — — —
GUARD RAIL	— — — —
RAILROAD	— — — —
SURVEY LINE	— — — —
CULVERT	— — — —
POWER POLE	⊕
TELEPHONE POLE	⊕
TREES	⊗
CONTROL OF ACCESS	///
PROPERTY LINE	— — — —
R.O.W. TAKING LINE	— — — —
SLOPE RIGHTS	SR
TOP OF CUT	△
TOE OF SLOPE	○

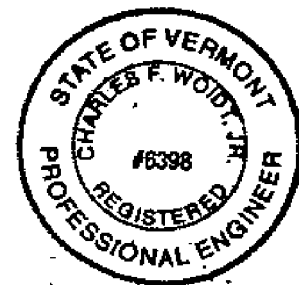

PLANS PREPARED BY



McFARLAND-JOHNSON, INC.
BINGHAMTON N.Y.

BY *Charles F. Wozniak* 7-19-99

DATUM
VERTICAL _____
HORIZONTAL _____

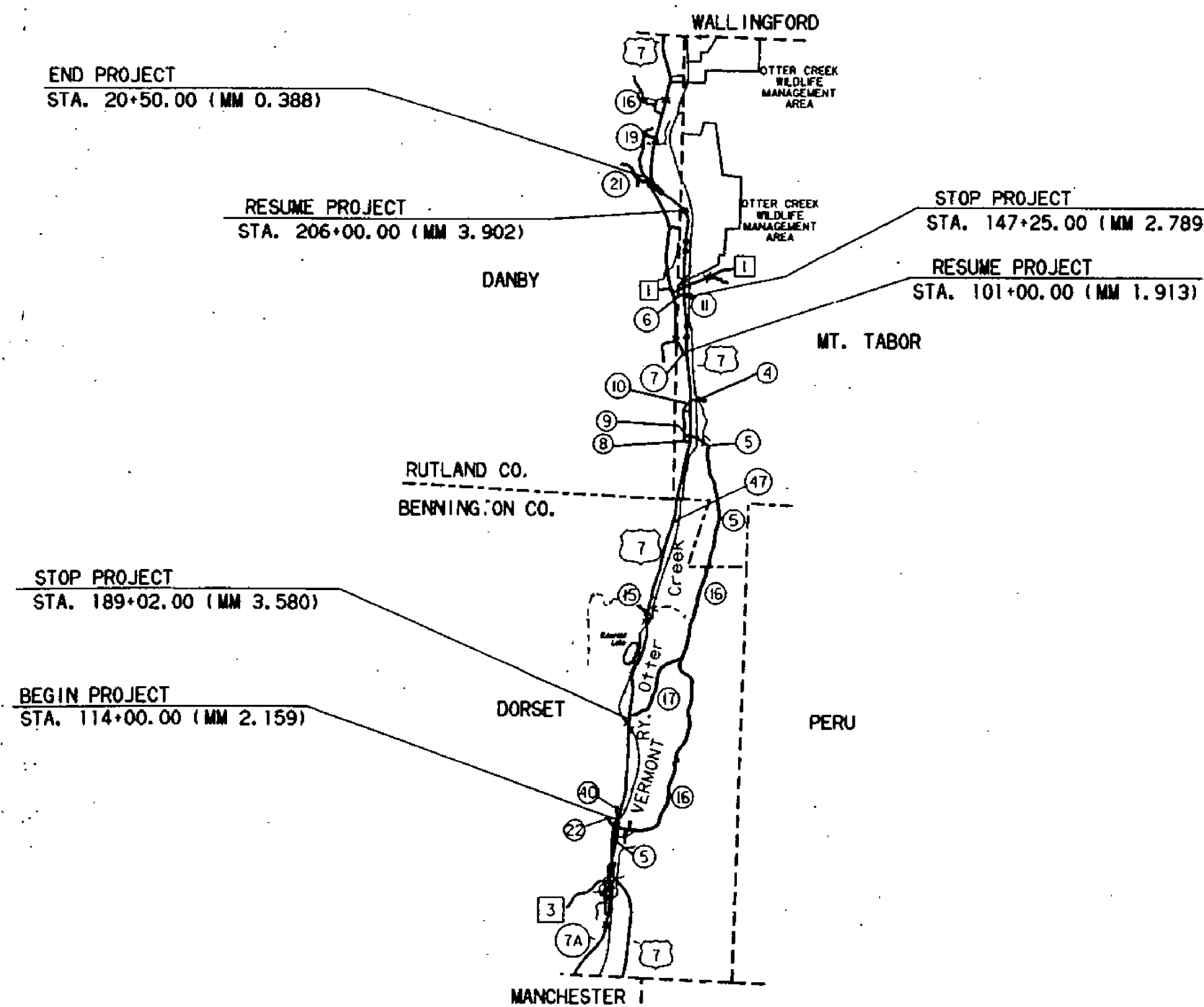

THESE PLANS ARE SUBJECT TO SUCH ENGINEERING CHANGES AS MAY BE REQUIRED BY THE FEDERAL HIGHWAY ADMINISTRATION OR THE CHIEF ENGINEER. CONSTRUCTION IS TO BE CARRIED ON IN ACCORDANCE WITH THESE PLANS AND THE STANDARD SPECIFICATIONS FOR CONSTRUCTION DATED 1990, AS APPROVED BY THE FEDERAL HIGHWAY ADMINISTRATION ON MARCH 15, 1990 FOR USE ON THIS PROJECT, INCLUDING ALL SUBSEQUENT REVISIONS AND SUCH REVISED SPECIFICATIONS AND SPECIAL PROVISIONS AS ARE INCORPORATED IN THESE PLANS.

SUBMITTED BY ORDER OF THE STATE TRANSPORTATION BOARD	
APPROVED _____	DATE 7/21/99
DIRECTOR OF PROJECT DEVELOPMENT	
DEPARTMENT OF TRANSPORTATION FEDERAL HIGHWAY ADMINISTRATION	
APPROVED _____	DATE _____
DIVISION ADMINISTRATOR	
PROJECT	DORSET-MT TABOR-DANBY NH 2132(1)S
SHEET 10 19 SHEETS	

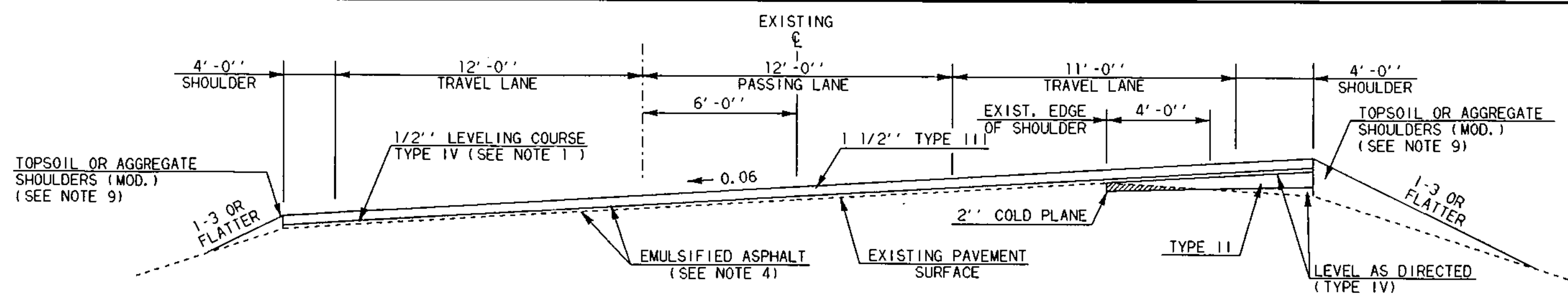

- OVERLAY SUPERELEVATED SECTION -
U.S. ROUTE 7 (MT. TABOR) STA. 206+00 TO (DANBY) STA. 3+40 (NORTHBOUND PASSING LANE)

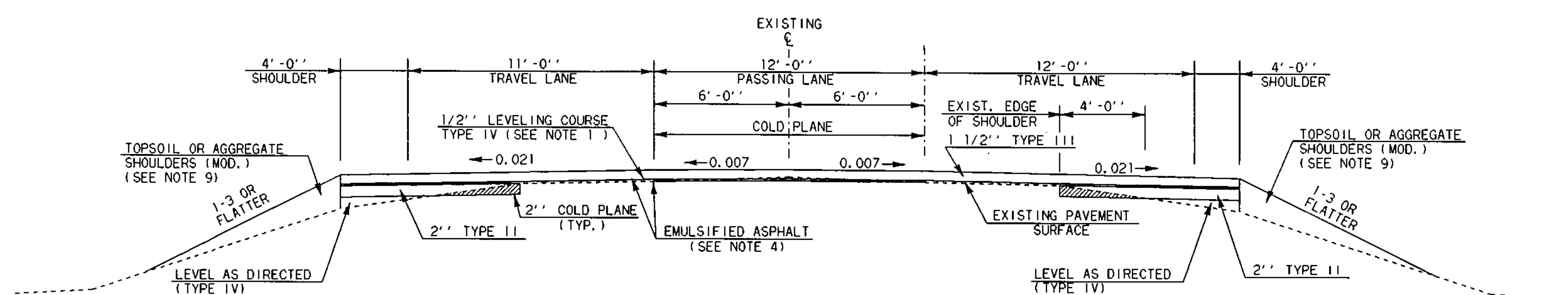

- OVERLAY TYPICAL SECTION (SOUTHBOUND) -
U.S. ROUTE 7 (DORSET) STA. 151+76 TO (DORSET) STA. 179+52 (SOUTHBOUND PASSING LANE)
(MT. TABOR) STA. 101+00 TO (MT. TABOR) STA. 144+00 (SOUTHBOUND PASSING LANE)

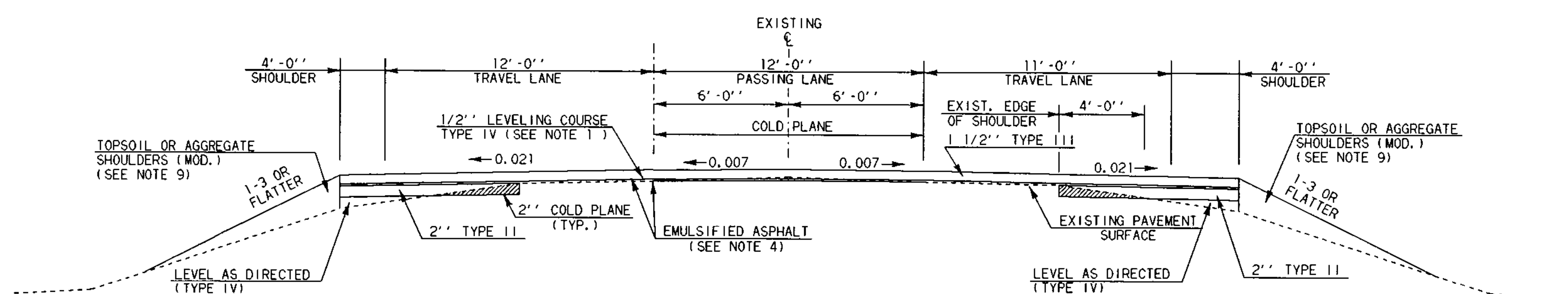

- OVERLAY TYPICAL SECTION (NORTHBOUND) -
U.S. ROUTE 7 (DORSET) STA. 114+00 TO (DORSET) STA. 141+76 (NORTHBOUND PASSING LANE)
(DANBY) STA. 5+79 TO (DANBY) STA. 20+50 (NORTHBOUND PASSING LANE)

PROJECT PAVING LIMITS

TOWN & ROUTE	BEGIN STATION	END STATION	LANE TYPICAL	WEARING DEPTH	LEVELING t	NOTES
DORSET U.S. ROUTE 7	114+00	127+77	8 - 12 - 12 - 11 - 8	1 1/2"	205	SEE LAYOUTS
	127+77	146+76	4 - 12 - 12 - 11 - 4	1 1/2"	284	NORTHBOUND PASSING LANE
	146+76	151+76	4 - (12 TO 11) - 12 - 12 - 4	1 1/2"	75	
	151+76	169+52	4 - 11 - 12 - 12 - 4	1 1/2"	265	SOUTHBOUND PASSING LANE
MT. TABOR U.S. ROUTE 7	169+52	179+52	(4 TO 8) - (11 TO 12) - (12 TO 0) - 12 - (4 TO 8)	1 1/2"	149	SEE LAYOUTS
	101+00	111+00	(8 TO 4) - (12 TO 11) - (0 TO 12) - 12 - (8 TO 4)	1 1/2"	149	SEE LAYOUTS
	111+00	134+00	4 - 11 - 12 - 12 - 4	1 1/2"	343	SOUTHBOUND PASSING LANE - SEE LAYOUTS
MT. TABOR U.S. ROUTE 7	134+00	144+00	(4 TO 8) - (11 TO 12) - (12 TO 0) - 12 - (4 TO 8)	1 1/2"	149	SEE LAYOUTS
	206+00	216+00	(8 TO 4) - 12 - (0 TO 12) - (12 TO 11) - (8 TO 4)	1 1/2"	233	SEE LAYOUTS
	216+00	220+86.24	4 - 12 - 12 - 11 - 4	1 1/2"	113	NORTHBOUND PASSING LANE
DANBY U.S. ROUTE 7	0+00	10+50	4 - 12 - 12 - 11 - 4	1 1/2"	245	NORTHBOUND PASSING LANE
	10+50	20+50	(4 TO 8) - 12 - (12 TO 0) - (11 TO 12) - (4 TO 8)	1 1/2"	149	SEE LAYOUTS

NOTES

- THE WEARING COURSE SHALL BE TYPE III, THE LEVELING COURSE SHALL BE TYPE IV. ASPHALT CEMENT USED IN THE BITUMINOUS CONCRETE PAVEMENT SHALL BE PG 58-34.
- COLD PLANING TO BE COMPLETED ACCORDING TO TYPICAL OR AS DENOTED OTHERWISE ON THE PLANS. ALL COLD PLANED AREAS SHALL BE TACKED WITH EMULSIFIED ASPHALT.
- THREE FEET OF BACKING IS REQUIRED BEHIND THE FACE OF GUARD RAIL WITH 6' POSTS. IF THIS CAN NOT BE OBTAINED THEN 8' POSTS SHALL BE USED.
- EMULSIFIED ASPHALT SHALL BE APPLIED ON ALL EXISTING PAVEMENT SURFACES, ON ALL COLD PLANED SURFACES AND BETWEEN ALL LIFTS OF PAVEMENT AT THE RATE OF 0.015 GAL./SY. OR AS DIRECTED BY THE RESIDENT ENGINEER.
- BITUMINOUS CONCRETE PAVEMENT TOLERANCE = 1/4" (TOTAL PAVEMENT THICKNESS EXCLUDING LEVELING).
- THE EXISTING SHOULDER MATERIAL DEEMED UNSUITABLE BY THE RESIDENT ENGINEER, SHALL BE EXCAVATED TO A DEPTH OF 6" OR AS DIRECTED BY THE ENGINEER. EXCAVATION WILL BE PAID FOR AS ALL PURPOSE EXCAVATOR OR GRADER RENTAL. MATERIAL REMOVED SHALL BE REPLACED WITH SUBBASE OF CRUSHED GRAVEL (FINE GRADED). EXCAVATED MATERIAL SHALL BE SPREAD ON THE ADJACENT SLOPES OR REMOVED FROM PROJECT, AS DIRECTED BY THE ENGINEER.
- ALL DRIVES AND TURNOUTS SHALL RECEIVE A PAVED APRON AS DIRECTED BY THE ENGINEER. ANY AND ALL REQUIRED EXCAVATION IN DRIVE OR TURNOUT AREAS SHALL BE AS DIRECTED AND WILL BE PAID FOR UNDER ITEM 210.10 OR THE APPLICABLE RENTAL ITEM(S). IF REQUIRED, A NEW DRIVEWAY SUBBASE SHALL BE CONSTRUCTED AND WILL BE PAID FOR UNDER ITEM 301.28. A NEW BITUMINOUS SURFACE SHALL BE CONSTRUCTED AS DIRECTED AND WILL BE PAID FOR UNDER ITEM 406.25. ESTIMATED QUANTITIES OF THE ABOVE ITEMS HAVE BEEN INCLUDED TO PAY FOR THIS WORK.
- GRASS GROWING ADJACENT TO PAVEMENT OR THROUGH CRACKS IN THE PAVEMENT WHICH MAY HAMPER THE PLACEMENT OF NEW BITUMINOUS CONCRETE SHALL BE REMOVED BY THE CONTRACTOR AS DIRECTED BY THE ENGINEER. PAYMENT FOR THIS WORK WILL NOT BE PAID FOR DIRECTLY, BUT WILL BE CONSIDERED SUBSIDIARY TO ITEM 406.25 - BITUMINOUS CONCRETE PAVEMENT.
- UTILIZE MILLINGS FROM COLD PLANING. PAYABLE UNDER ITEM 402.12 AGGREGATE SHOULDERS (MOD.) AS DIRECTED BY THE ENGINEER.
- AN ESTIMATED QUANTITY OF EARTH BORROW HAS BEEN INCLUDED FOR THE PROVISION OF CONSTRUCTING GUARDRAIL FLARES WHICH SHALL BE CAPPED WITH AN ESTIMATED 3' DEPTH OF AGGREGATE SHOULDER MATERIAL UNLESS OTHERWISE DIRECTED BY THE RESIDENT ENGINEER. THE QUANTITIES INCLUDED REFLECT 26 CUBIC YARDS OF EARTH BORROW AND 5 TONS OF AGGREGATE SHOULDER MATERIAL FOR EACH GUARDRAIL TERMINAL.
- EXISTING PAVED SHOULDER WIDTHS VARY FROM DESIGNED 40' WIDTH AT SOME LOCATIONS. PAVEMENT SHALL EXTEND TO THE LIMIT OF THE SHOULDERS IN THESE AREAS. VARIATIONS IN WIDTHS ARE INCLUDED IN ESTIMATE OF ITEM 406.25 - BITUMINOUS CONCRETE PAVEMENT.

RURAL AREA - SEED MIXTURE				
% WT.	LBS./A.	NAME	PUR. %	GERM. %
37.5	22.5	CREeping RED FESCUE	98	85
37.5	22.5	TALL FESCUE	95	90
5.0	3.0	RED TOP	95	90
15.5	9.0	BIRDFOOT TREFOIL	98	85
5.0	3.0	ANNUAL RYEGRASS	95	85
100.0	60.0			

SEED MIXTURE SHALL NOT HAVE A WEED CONTENT EXCEEDING 0.40% BY WEIGHT AND SHALL BE FREE OF ALL NOXIOUS WEED SEED.

SEED TO BE APPLIED PER SEEDING FORMULA DIRECTED BY THE ENGINEER.

FERTILIZER FORMULA 10-20-10 TO BE USED WITH SEED, APPLIED AT THE RATE OF 500 LBS/ACRE (HYDRO SEEDERS MAY USE 19-19-19 FORMULA)

AGRICULTURAL LIMESTONE TO BE APPLIED AT THE RATE OF 2 TONS/ACRE OR AS DIRECTED BY THE ENGINEER.

HAY MULCH TO BE APPLIED ON EARTH SLOPES AT THE RATE OF 2 TONS/ACRE, OR AS DIRECTED BY THE ENGINEER.

TOPSOIL TO BE USED WITH SEED AS INDICATED ON THE PLANS, OR AS DIRECTED BY THE ENGINEER.

PROJECT TYPICAL SHEET	PROJECT: DORSET-MT TABOR-DANBY	PROJECT NO.: NH 2132 (1) S
	DESIGN FILE NAME: /pave/93b080a/pb080.dgn	PLOT DATE: 13-AUG-1999
	IPARM FILE NAME: pb080pt.l	SURVEY DATE: N/A
	SURVEYED BY: N/A	DRAWN BY: SJL
	SQUAD LEADER: JAV	SHEET: 2 OF 19

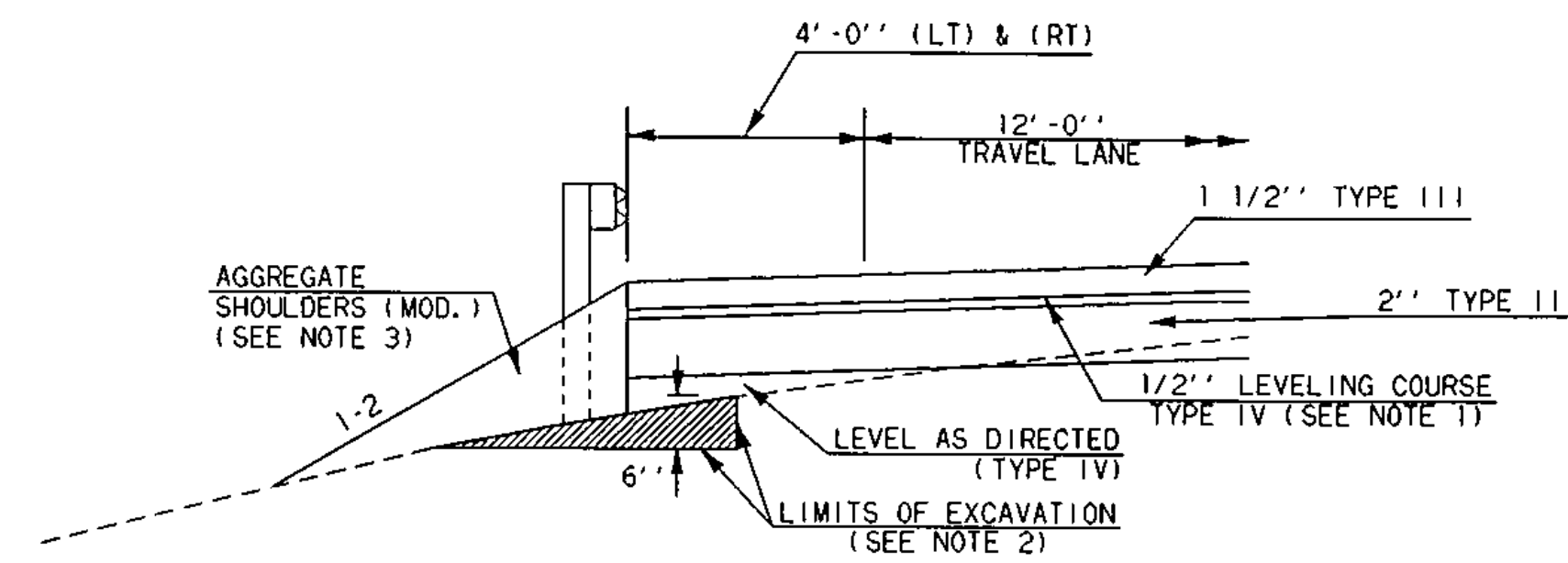

- WIDENING DETAIL -
(GUARD RAIL LOCATIONS)

U.S. ROUTE 7 (DORSET) STA. 156+00 LT & RT TO (DORSET) STA. 160+00 LT & RT
 (MT. TABOR) STA. 113+30 LT & RT TO (MT. TABOR) STA. 117+80 LT & RT
 (MT. TABOR) STA. 123+00 LT & RT TO (MT. TABOR) STA. 127+30 LT & RT

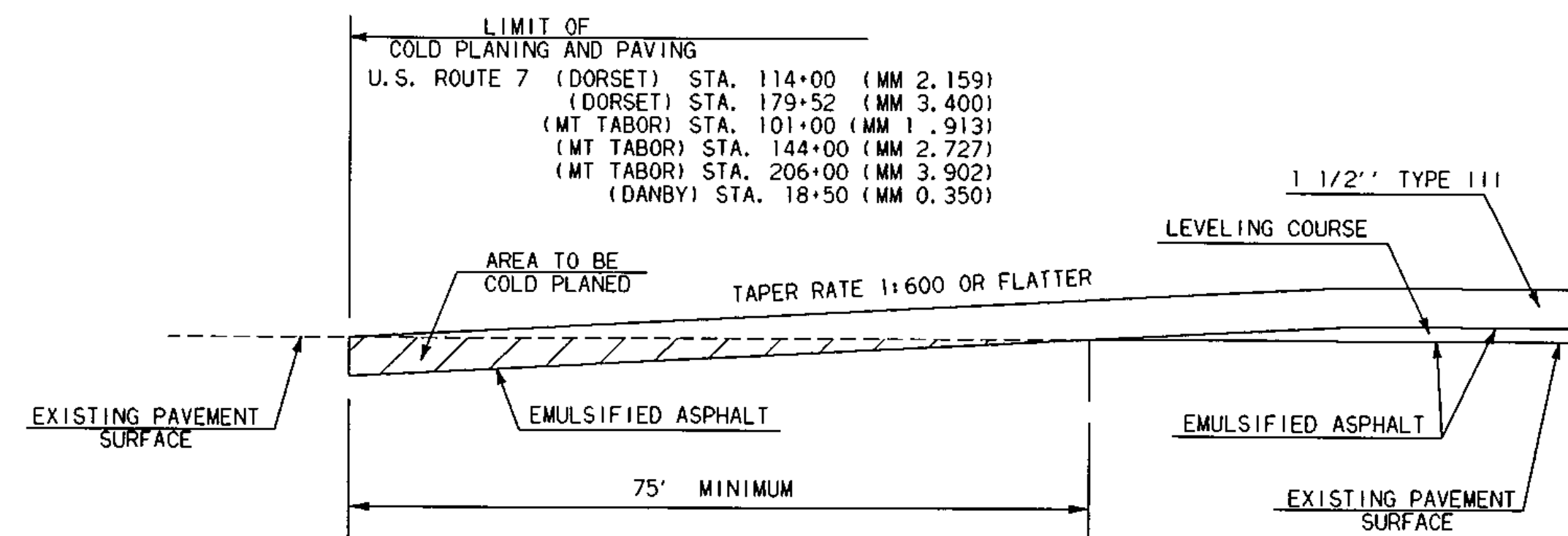

- APPROACH AREA DETAIL -

U.S. ROUTE 7 (DORSET) STA. 114+00 (MM 2.159)
 (DORSET) STA. 179+52 (MM 3.400)
 (MT TABOR) STA. 101+00 (MM 1.913)
 (MT TABOR) STA. 144+00 (MM 2.727)
 (MT TABOR) STA. 206+00 (MM 3.902)
 (DANBY) STA. 18+50 (MM 0.350)

**PROJECT
DETAIL
SHEET**

PROJECT:	DORSET-MT TABOR-DANBY	PROJECT NO.:	NH 2132 (I) S
DESIGN FILE NAME:	/pave/93b080a/pb080.dgn	PLOT DATE:	13-AUG-1999
IPARM FILE NAME:	pb080pd.1	SURVEY DATE:	N/A
SURVEYED BY:	N/A	DRAWN BY:	SJL
SQUAD LEADER:	JAV	SHEET:	3 OF 19

QUANTITY SHEET

STATE OF VERMONT
AGENCY OF TRANSPORTATION

SUMMARY OF ESTIMATED QUANTITIES											DETAILED SUMMARY OF QUANTITIES			DETAILED SUMMARY OF QUANTITIES		
	NON-GOV'T PARTICIPATING		GOV'T PARTICIPATING		QUANTITIES GRAND TOTAL	UNIT	ITEMS	ITEM NO.	ROUNDING	QUANTITIES	UNIT	ITEMS	QUANTITIES	UNIT	ITEMS	
	BRIDGE	ROADWAY	BRIDGE	ROADWAY												
					1	LS	TESTING EQUIPMENT - BITUMINOUS	631.17	--							
					1	LS	MOBILIZATION	635.10	--							
					30,480	LF	DURABLE 4" WHITE LINE	646.40	12.0							
					31,360	LF	DURABLE 4" YELLOW LINE	646.41	13.5							
					300	LF	DURABLE 8" WHITE LINE	646.42	14.1							
					780	LF	DURABLE 8" YELLOW LINE	646.43	11.4							
					30	LF	DURABLE 24" STOP BAR	646.46	6.0							
					8	EA	DURABLE LETTER OR SYMBOL	646.50	0.0							
					60,960	LF	TEMPORARY 4" WHITE LINE	646.60	0.0							
					62,720	LF	TEMPORARY 4" YELLOW LINE	646.61	0.0							
					60	LF	TEMPORARY 24" STOP BAR	646.66	0.0							
					16	EA	TEMPORARY LETTER OR SYMBOL	646.70	0.0							
					360	EA	LINE STRIPING TARGETS	646.73	0.3							
					300	SF	REMOVAL OF EXISTING PAVEMENT MARKINGS	646.82	4.2							
					40	lb	SEED	651.15	0.49							
					360	lb	FERTILIZER	651.18	10.8							
					2	t	AGRICULTURAL LIMESTONE	651.20	0.68							
					2	t	HAY MULCH	651.25	0.68							
					900	CY	TOPSOIL	651.35	12.9							
					135	ft ²	TRAFFIC SIGNS, TYPE A	675.20	3.32							
							***** BEGIN OPTION ITEMS *****									
					400	LF	FLANGED CHANNEL SIGN POST	675.301	10.0							
					400	LF	SQUARE TUBE STEEL POSTS AND ANCHORS	675.341	10.0							
							***** END OPTION ITEMS *****									
					11	EA	REMOVING SIGNS	675.50	0.0							
					11	EA	ERECTING SALVAGED SIGNS	675.60	0.0							

PROJECT: DORSET-MT TABOR-DANBY	PROJECT NO.: NH 2132 (1) 5
DESIGN FILE NAME: /pave/93b080a/pb080.dgn IPARM FILE NAME: pb080qs2.i SURVEYED BY: N/A SQUAD LEADER: JAV	PLOT DATE: 13-AUG-1999 SURVEY DATE: N/A DRAWN BY: SJL SHEET: 5 OF 19

ITEM DETAIL SUMMARY SHEET

STATION	STATION	POS.	COMMON EXCAVATION	STONE FILL TYPE I	SUBBASE OF CR. GRAVEL	BITUMINOUS CONC. GUTTERS & TRAFFIC ISLANDS	BITUMINOUS CONCRETE SIDEWALK	TREATED TIMBER CURB	PORTLAND CEMENT CONC. SIDEWALK 6 INCH	TRENCH EXCAVATION OF EARTH	REHAB. OF DI, CB, OR MH			GRATE TYPE	GUARD RAIL ITEMS											REMARKS																		
											604.412	604.415	604.418		621.20	621.20 (MOD.)	621.505 (ET2000)	621.505 (FLARED)	621.505 (TANGENT)	621.505 TYPE IV	621.60	621.75	621.76	621.77	621.79		621.80	621.81																
			ft ³	ft ³	+	+	+	ft	ft ²	ft ³	EA	EA	EA	EA	ft	ft	EA	EA	EA	EA	EA	ft	EA	EA	ft	ft	EA																	
157+43	158+68	LT																																										
157+45	158+45	RT																																										
176+63	180+88	RT																																										
114+75	116+00	LT																																										
114+90.5	116+40.5	RT												50															INCLUDES 2 SECTIONS OF NESTED RAIL															
124+41.5	125+91.5	LT												50															INCLUDES 2 SECTIONS OF NESTED RAIL															
124+41.5	125+91.5	RT												50															INCLUDES 2 SECTIONS OF NESTED RAIL															
209+03.5	211+41	LT																																										
208+42.5	215+67.5	RT																																										
13+48	15+48	LT																																										
13+96	18+46	RT												50															INCLUDES 2 SECTIONS OF NESTED RAIL															
16+00	20+50	LT																																										
WHERE NEEDED																																												
SUBTOTAL															200	25		22	1					2,325	19	19	25	962.5																
ROUNDING															-	-		-	-					25	-	-	-	12.5																
TOTAL															200	25		22	1					2,350	19	19	25	975																

ITEM DETAIL SHEET	PROJECT: DORSET-MT TABOR-DANBY	PROJECT NO.: NH 2132 (1) S
	DESIGN FILE NAME: /pave/93b080a/pb080.dgn	PLOT DATE: 13-AUG-1999
	IPARM FILE NAME: pb080id.1	SURVEY DATE: N/A
	SURVEYED BY: N/A	DRAWN BY: SJL
	SQUAD LEADER: JAV	SHEET: 6 OF 19

TEMPORARY AND DURABLE 4'' WHITE LINE
 STA. 114+00 TO STA. 129+00 SOLID LT. AND RT. (EDGE LINE)
 (WITH EDGE LINE BREAK FOR SIDE ROAD)
 STA. 124+00 TO STA. 129+00 DASHED RT. (PASSING LANE)

TEMPORARY AND DURABLE 4'' YELLOW LINE
 STA. 114+00 TO STA. 129+00 SOLID LT. AND RT.
 (WITH CENTERLINE BREAK FOR SIDE ROAD)
 STA. 120+07 LT. (COOK ROAD)

TEMPORARY AND DURABLE LETTER OR SYMBOL
 STA. 120+07 LT. 'STOP' (COOK ROAD)

TEMPORARY AND DURABLE 24'' STOP BAR
 STA. 120+07 LT. (COOK ROAD)

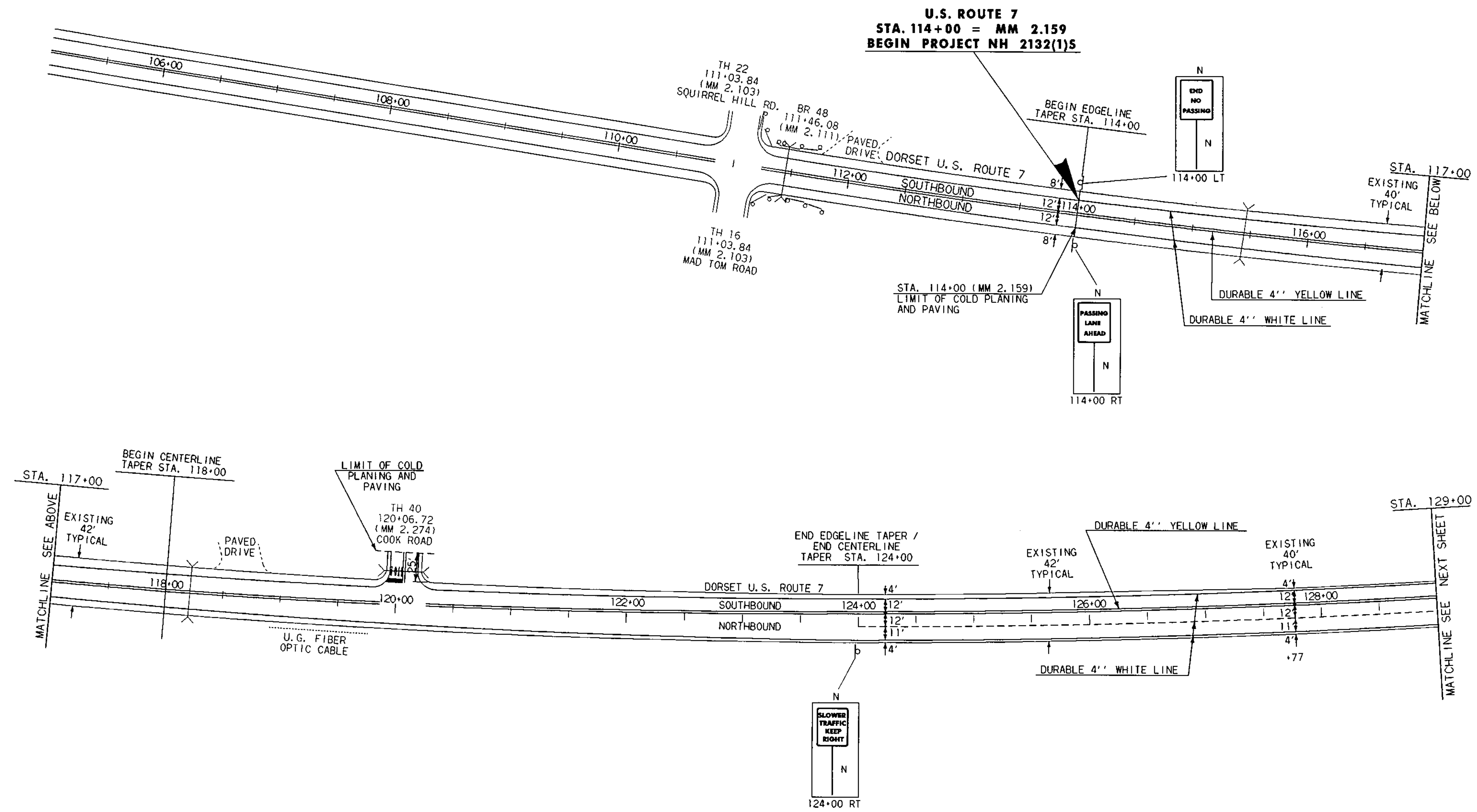

DATUM	
VERTICAL	N/A
HORIZONTAL	N/A

LEGEND
 N = NEW
 R = REMOVE
 R&S = REMOVE AND SALVAGE
 S = SALVAGE SIGN
 RET = RETAIN
 B - B = BACK TO BACK

PAVING PROJECT LAYOUT	PROJECT: DORSET-MT TABOR-DANBY	PROJECT NO.: NH 2132 (1) S
	DESIGN FILE NAME: /pave/93b080a/pb080.dgn	PLOT DATE: 13-AUG-1999
	IPARM FILE NAME: pb080i01.i	SURVEY DATE: N/A
	SURVEYED BY: N/A SQUAD LEADER: JAV	DRAWN BY: SJL SHEET: 7 OF 19

TEMPORARY AND DURABLE 4" WHITE LINE
 STA. 129+00 TO STA. 153+00 SOLID LT. AND RT. (EDGE LINE)
 STA. 129+00 TO STA. 136+26 DASHED RT. (PASSING LANE)

TEMPORARY AND DURABLE 4" YELLOW LINE
 STA. 129+00 TO STA. 153+00 SOLID LT. AND RT.
 (WITH CENTERLINE BREAK FOR SIDE ROAD)

DURABLE 8" YELLOW LINE
 STA. 142+59.3 TO STA. 150+92.7 SOLID (CHANNELIZING LINES)

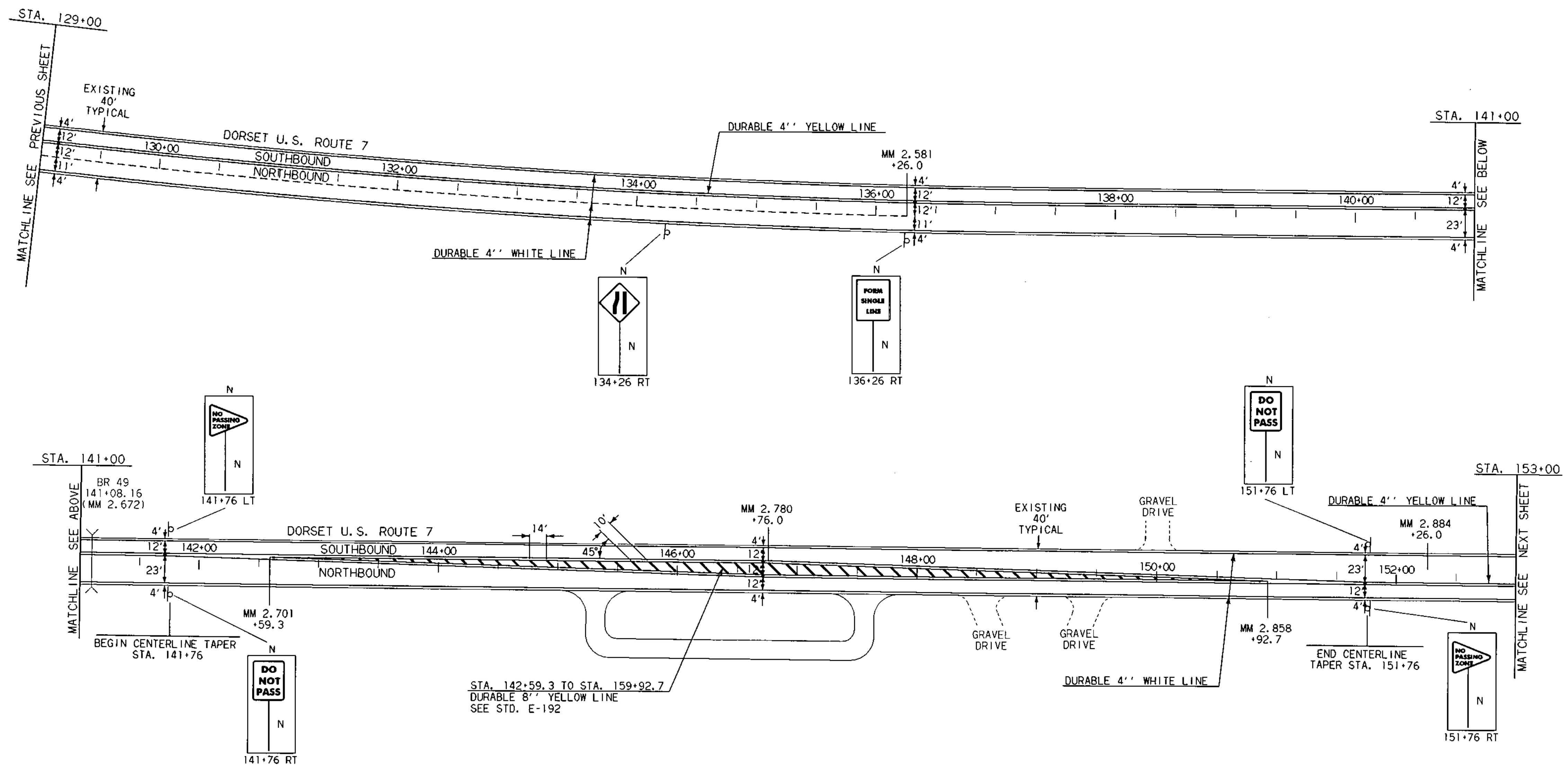

DATUM	
VERTICAL	N/A
HORIZONTAL	N/A

LEGEND
 N = NEW
 R = REMOVE
 R&S = REMOVE AND SALVAGE
 S = SALVAGE SIGN
 RET = RETAIN
 B - B = BACK TO BACK

PAVING PROJECT LAYOUT	PROJECT: DORSET-MT TABOR-DANBY	PROJECT NO.: NH 2132 (1) S
	DESIGN FILE NAME: /pave/93b080a/pb080.dgn	PLOT DATE: 13-AUG-1999
	IPARM FILE NAME: pb080i02.1	SURVEY DATE: N/A
	SURVEYED BY: N/A	DRAWN BY: S.J.L.
	SQUAD LEADER: JAV	SHEET: 8 OF 19

TEMPORARY AND DURABLE 4" WHITE LINE
 STA. 153+00 TO STA. 179+52 SOLID LT. AND RT. (EDGE LINE)
 STA. 157+26 TO STA. 169+52 DASHED LT. (PASSING LANE)

TEMPORARY AND DURABLE 4" YELLOW LINE
 STA. 153+00 TO STA. 179+52 SOLID LT. AND RT.
 STA. 179+52 TO STA. 189+02 SOLID LT., AND DASH RT.

DURABLE 8" WHITE LINE
 STA. 179+52 TO STA. 183+00 RT.

REMOVAL AND DISPOSAL OF GUARD RAIL
 STA. 157+43 TO STA. 157+80.5 LT.
 STA. 157+45 TO STA. 157+82.5 RT.
 STA. 158+07.5 TO STA. 158+45 RT.
 STA. 158+30.5 TO STA. 158+68 LT.
 STA. 176+63 TO STA. 177+00.5 RT.
 STA. 180+50.5 TO STA. 180+88 RT.

MANUFACTURED TERMINAL SECTION (FLARED)
 STA. 157+43 TO STA. 157+80.5 LT.
 STA. 157+45 TO STA. 157+82.5 RT.
 STA. 158+07.5 TO STA. 158+45 RT.
 STA. 158+30.5 TO STA. 158+68 LT.
 STA. 176+63 TO STA. 177+00.5 RT.
 STA. 180+50.5 TO STA. 180+88 RT.

REMOVE AND RESET GUARD RAIL
 STA. 157+80.5 TO STA. 158+30.5 LT.
 STA. 157+82.5 TO STA. 158+07.5 RT.
 STA. 158+68 LT. TO STA. 158+30.5 LT.
 STA. 177+00.5 TO STA. 180+50.5 RT.

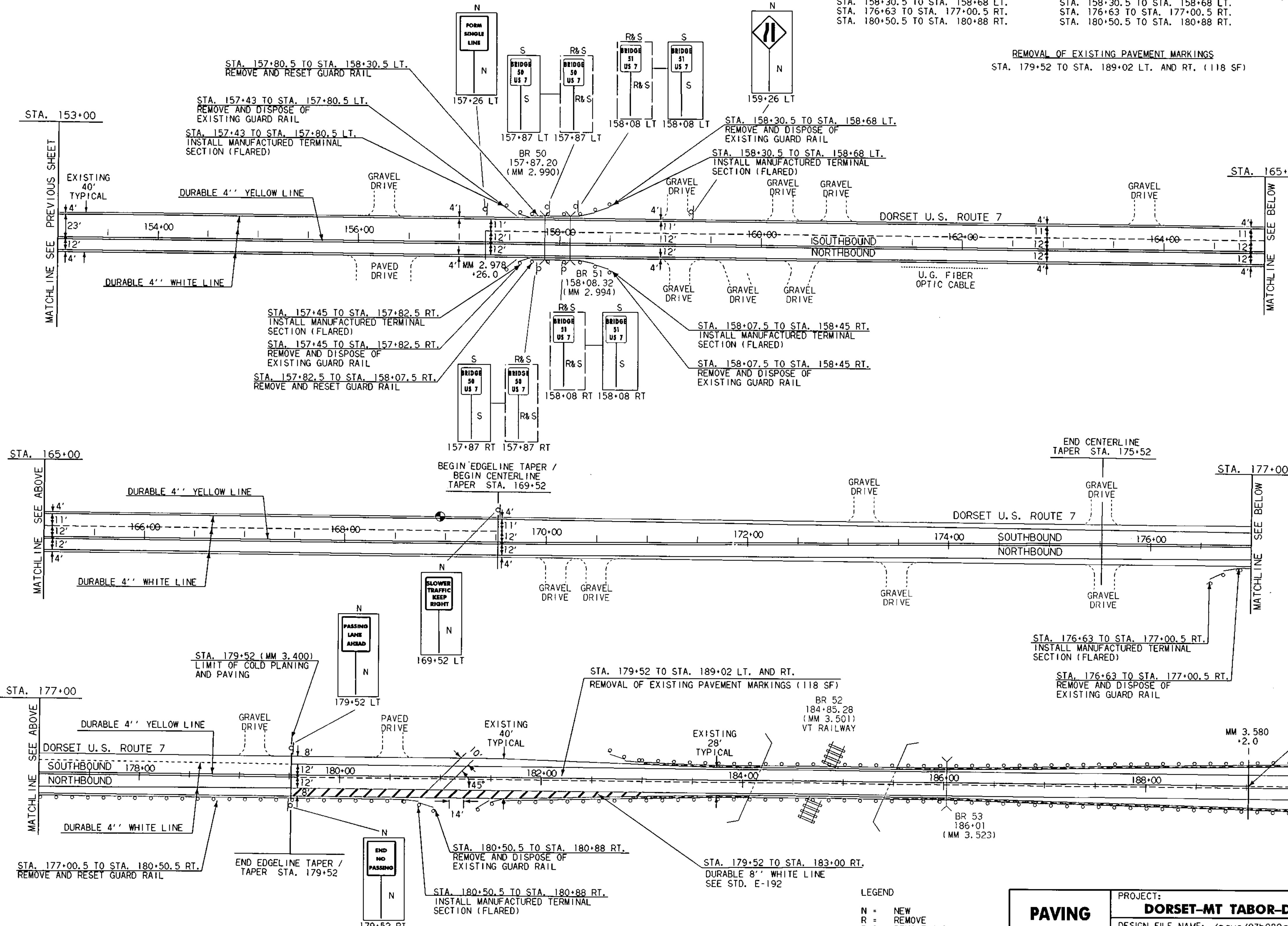

REMOVAL OF EXISTING PAVEMENT MARKINGS
 STA. 179+52 TO STA. 189+02 LT. AND RT. (118 SF)

REMOVING SIGNS
 4 -- AS SHOWN

ERECTING SALVAGED SIGNS
 4 -- AS SHOWN

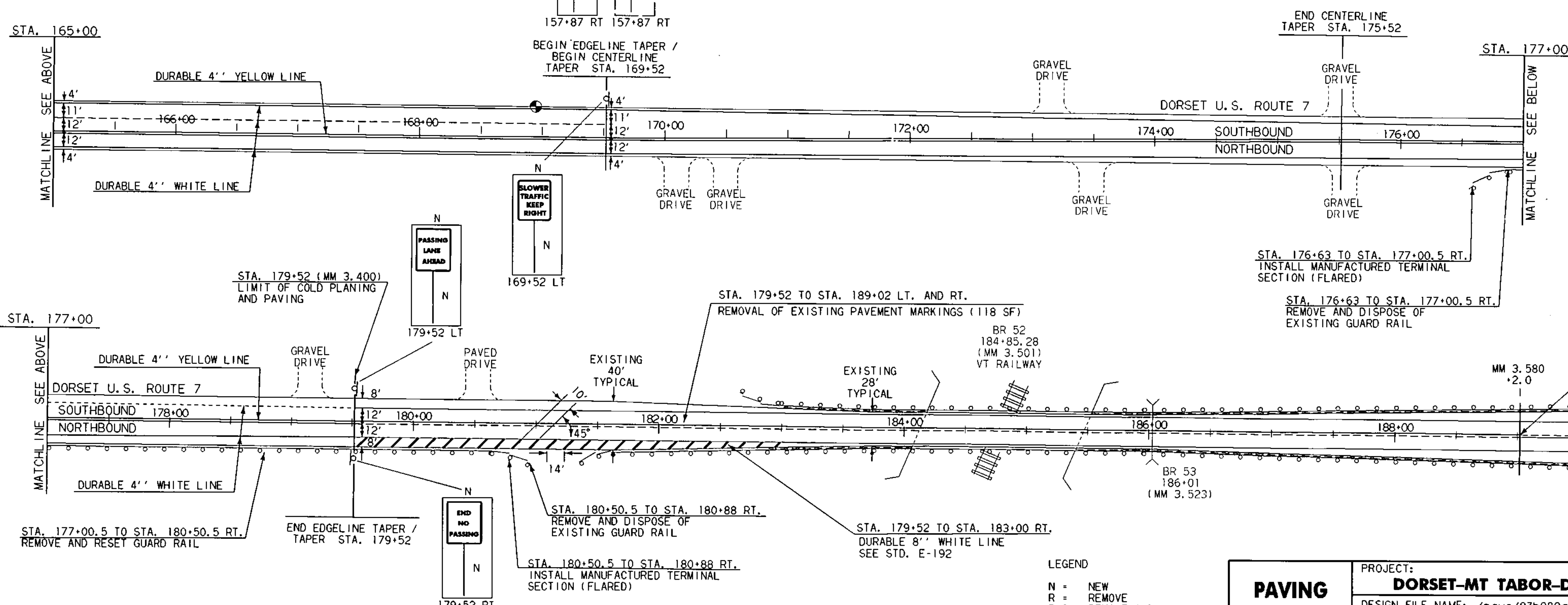

DATUM

VERTICAL	N/A
HORIZONTAL	N/A

LEGEND

N = NEW
 R = REMOVE
 R&S = REMOVE AND SALVAGE
 S = SALVAGE SIGN
 RET = RETAIN
 B - B = BACK TO BACK

PAVING PROJECT LAYOUT	PROJECT: DORSET-MT TABOR-DANBY	PROJECT NO. : NH 2132 (1) S
	DESIGN FILE NAME: /pave/93b080a/pb080.dgn	PLOT DATE: 13-AUG-1999
	IPARM FILE NAME: pb080i03.i	SURVEY DATE: N/A
	SURVEYED BY: N/A SQUAD LEADER: JAV	DRAWN BY: S.J.L. SHEET: 9 OF 19

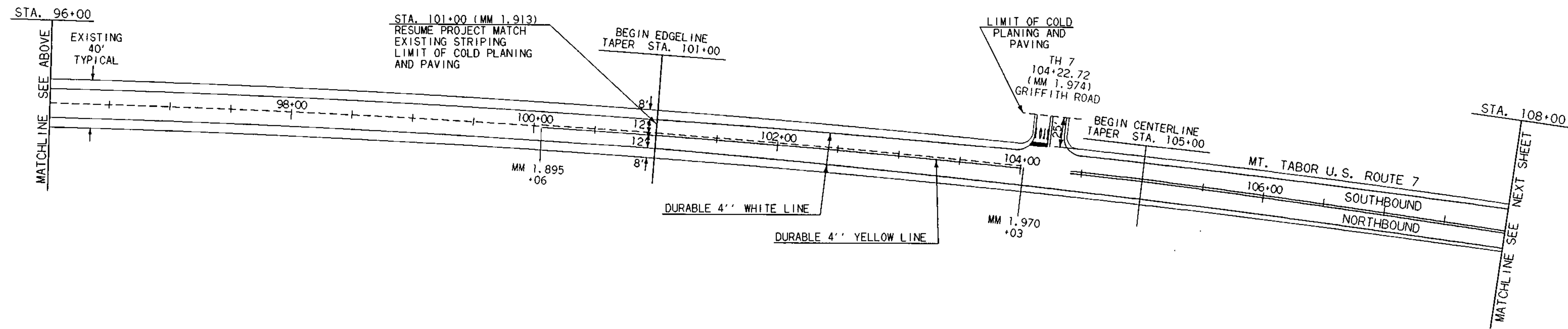
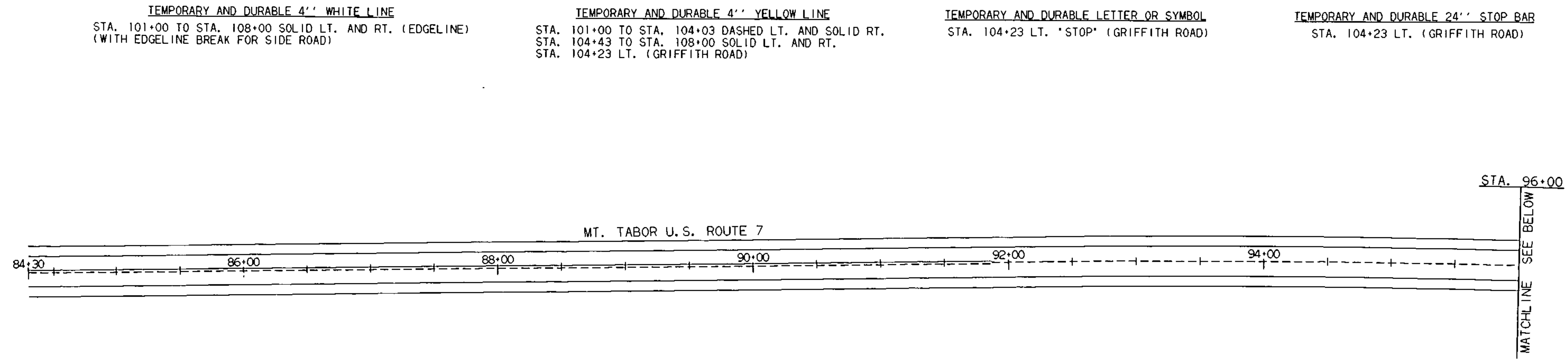

TEMPORARY AND DURABLE 4'' WHITE LINE
 STA. 101+00 TO STA. 108+00 SOLID LT. AND RT. (EDGELINE)
 (WITH EDGELINE BREAK FOR SIDE ROAD)

TEMPORARY AND DURABLE 4'' YELLOW LINE
 STA. 101+00 TO STA. 104+03 DASHED LT. AND SOLID RT.
 STA. 104+43 TO STA. 108+00 SOLID LT. AND RT.
 STA. 104+23 LT. (GRIFFITH ROAD)

TEMPORARY AND DURABLE LETTER OR SYMBOL
 STA. 104+23 LT. *STOP* (GRIFFITH ROAD)

TEMPORARY AND DURABLE 24'' STOP BAR
 STA. 104+23 LT. (GRIFFITH ROAD)

DATUM	
VERTICAL	N/A
HORIZONTAL	N/A

LEGEND
 N = NEW
 R = REMOVE
 R&S = REMOVE AND SALVAGE
 S = SALVAGE SIGN
 RET = RETAIN
 B - B = BACK TO BACK

**PAVING
 PROJECT
 LAYOUT**

PROJECT:	DORSET-MT TABOR-DANBY	PROJECT NO.:	NH 2132 (1) S
DESIGN FILE NAME:	/pave/93b080a/pb080.dgn	PLOT DATE:	13-AUG-1999
IPARM FILE NAME:	pb080i04.i	SURVEY DATE:	N/A
SURVEYED BY:	N/A	DRAWN BY:	SJL
SQUAD LEADER:	JAV	SHEET:	10 OF 19

TEMPORARY AND DURABLE 4" WHITE LINE
 STA. 108+00 TO STA. 132+00 SOLID LT. AND RT. (EDGE LINE)
 STA. 111+00 TO STA. 132+00 DASHED LT. (PASSING LANE)

TEMPORARY AND DURABLE 4" YELLOW LINE
 STA. 108+00 TO STA. 132+00 SOLID LT. AND RT.

STEEL BEAM GUARD RAIL
 STA. 115+53 TO STA. 115+78 RT.
 STA. 125+04 TO STA. 125+29 LT.
 STA. 125+04 TO STA. 125+29 RT.

REMOVAL AND DISPOSAL OF GUARD RAIL
 STA. 114+75 TO STA. 115+12.5 LT.
 STA. 115+53 TO STA. 115+78 RT.
 STA. 115+62.5 TO STA. 116+00 LT.
 STA. 114+90.5 TO STA. 115+28 RT.
 STA. 116+03 TO STA. 116+40.5 RT.
 STA. 124+41.5 TO STA. 124+79 LT.
 STA. 125+04 TO STA. 125+29 LT.
 STA. 125+04 TO STA. 125+29 RT.
 STA. 125+54 TO STA. 125+91.5 LT.
 STA. 124+41.5 TO STA. 124+79 RT.
 STA. 125+54 TO STA. 125+91.5 RT.

MANUFACTURED TERMINAL SECTION (FLARED)
 STA. 114+75 TO STA. 115+12.5 LT.
 STA. 115+62.5 TO STA. 116+00 LT.
 STA. 114+90.5 TO STA. 115+28 RT.
 STA. 116+03 TO STA. 116+40.5 RT.
 STA. 124+41.5 TO STA. 124+79 LT.
 STA. 125+54 TO STA. 125+91.5 LT.
 STA. 124+41.5 TO STA. 124+79 RT.
 STA. 125+54 TO STA. 125+91.5 RT.

REMOVE AND RESET GUARD RAIL
 STA. 115+12.5 TO STA. 115+62.5 LT.
 STA. 115+28 TO STA. 115+53 RT.
 STA. 115+78 TO STA. 116+03 RT.
 STA. 124+79 TO STA. 125+04 LT.
 STA. 124+79 TO STA. 125+04 RT.
 STA. 125+29 TO STA. 125+54 LT.
 STA. 125+29 TO STA. 125+54 RT.

REMOVING SIGNS
 6 -- AS SHOWN

ERECTING SALVAGED SIGNS
 6 -- AS SHOWN

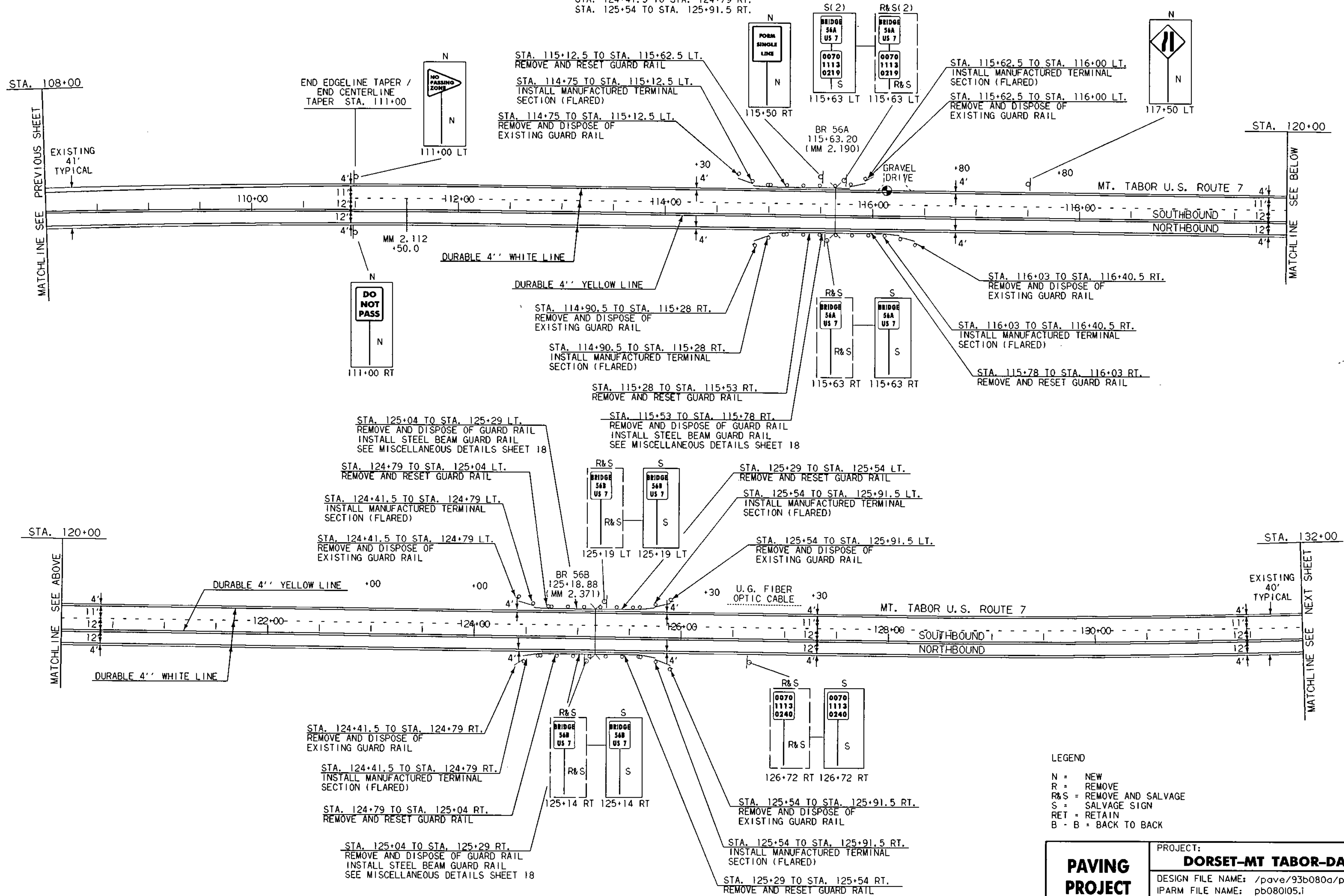

LEGEND
 N = NEW
 R = REMOVE
 R&S = REMOVE AND SALVAGE
 S = SALVAGE SIGN
 RET = RETAIN
 B = BACK TO BACK

DATUM	
VERTICAL	N/A
HORIZONTAL	N/A

PAVING PROJECT LAYOUT	PROJECT: DORSET-MT TABOR-DANBY	PROJECT NO.: NH 2132 (1) S
	DESIGN FILE NAME: /pave/93b080a/pb080.dgn	PLOT DATE: 13-AUG-1999
	IPARM FILE NAME: pb080i05.1	SURVEY DATE: N/A
	SURVEYED BY: N/A	DRAWN BY: SJL
	SQUAD LEADER: JAV	SHEET: 11 OF 19

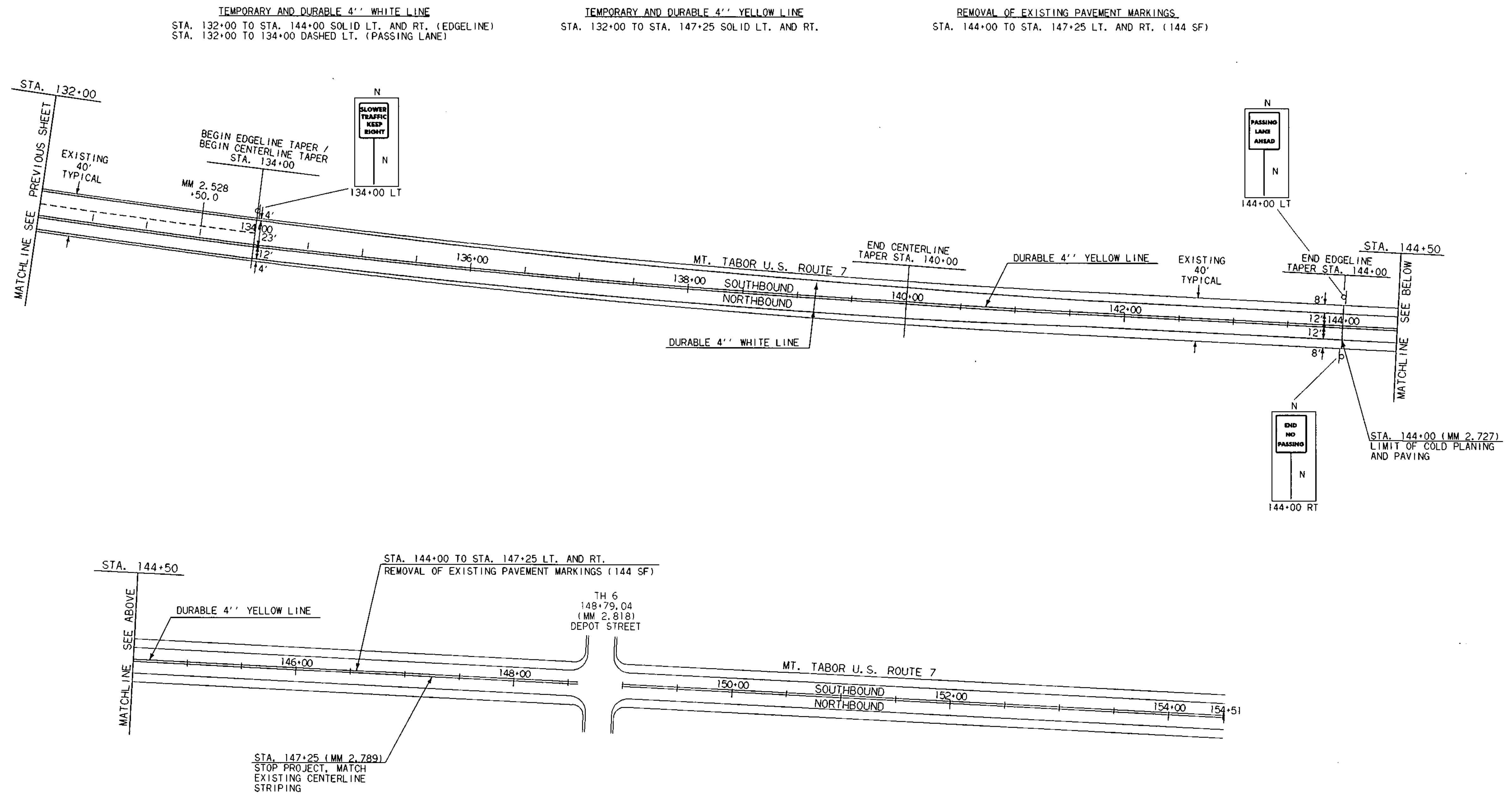

DATUM	
VERTICAL	N/A
HORIZONTAL	N/A

LEGEND
 N = NEW
 R = REMOVE
 R&S = REMOVE AND SALVAGE
 S = SALVAGE SIGN
 RET = RETAIN
 B - B = BACK TO BACK

PAVING PROJECT LAYOUT	PROJECT: DORSET-MT TABOR-DANBY	PROJECT NO.: NH 2132 (1) S
	DESIGN FILE NAME: /pave/93b080a/pb080.dgn	PLOT DATE: 13-AUG-1999
	IPARM FILE NAME: pb080i06.i	SURVEY DATE: N/A
	SURVEYED BY: N/A	DRAWN BY: SJL
	SQUAD LEADER: JAV	SHEET: 12 OF 19

TEMPORARY AND DURABLE 4" WHITE LINE
 STA. 206+00 TO STA. 217+00 SOLID LT. AND RT. (EDGE LINE)
 STA. 216+00 TO STA. 217+00 DASHED RT. (PASSING LANE)

TEMPORARY AND DURABLE 4" YELLOW LINE
 STA. 206+00 TO STA. 217+00 SOLID LT. AND RT.

REMOVAL AND DISPOSAL OF GUARD RAIL
 STA. 208+42.5 TO STA. 208+80 RT.
 STA. 209+03.5 TO STA. 209+41 LT.
 STA. 211+03.5 TO STA. 211+41 LT.
 STA. 215+30 TO STA. 215+67.5 RT.

MANUFACTURED TERMINAL SECTION (FLARED)
 STA. 208+42.5 TO STA. 208+80 RT.
 STA. 209+03.5 TO STA. 209+41 LT.
 STA. 215+30 TO STA. 215+67.5 RT.

REMOVE AND RESET GUARD RAIL
 STA. 209+41 TO STA. 211+03.5 LT. (W/ 8' POST SPACING)
 STA. 208+80 TO STA. 215+30 RT. (W/ 8' POST SPACING)

MANUFACTURED TERMINAL SECTION (TANGENT)
 STA. 211+03.5 TO STA. 211+41 LT.

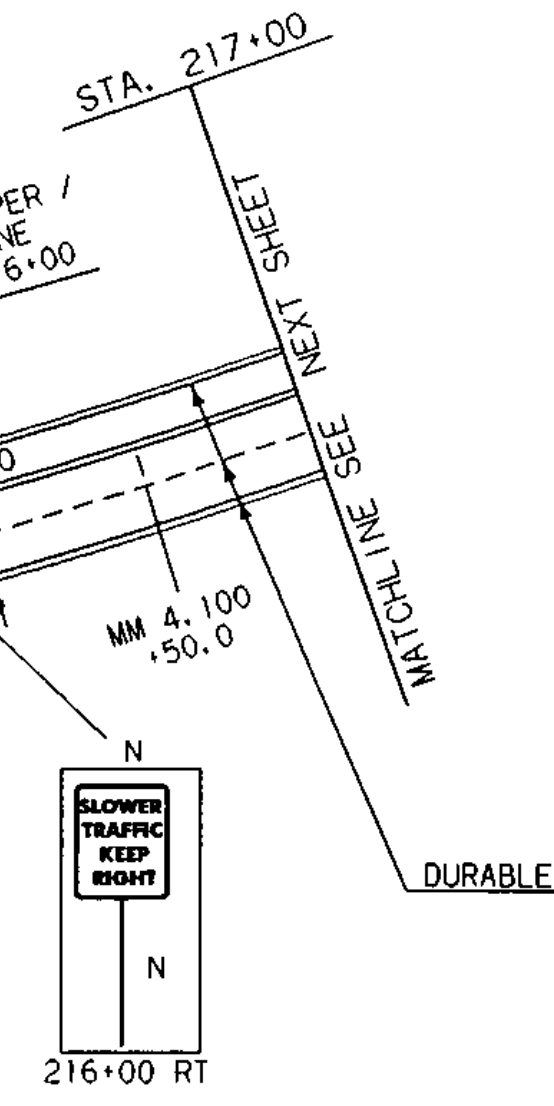
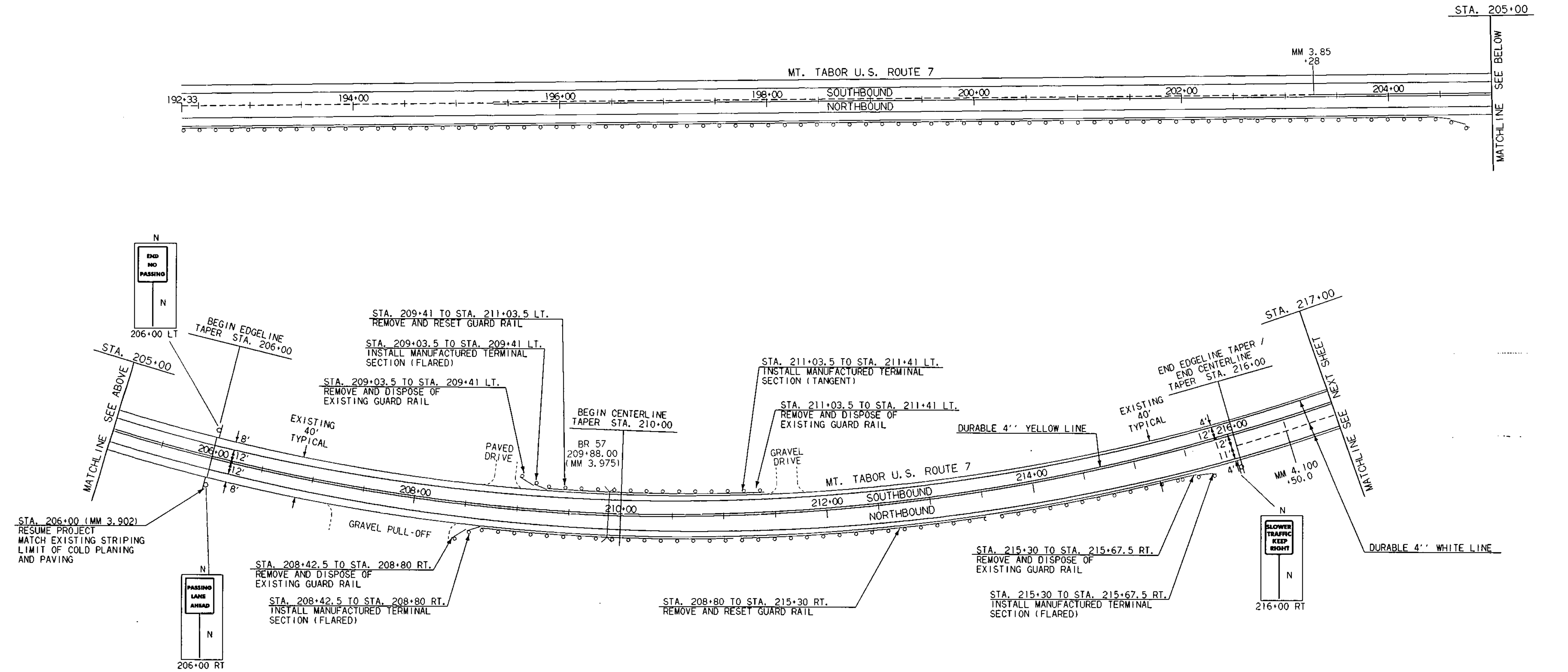

DATUM	
VERTICAL	N/A
HORIZONTAL	N/A

- LEGEND
- N = NEW
 - R = REMOVE
 - R&S = REMOVE AND SALVAGE
 - S = SALVAGE SIGN
 - RET = RETAIN
 - B - B = BACK TO BACK

PAVING PROJECT LAYOUT	PROJECT:	DORSET-MT TABOR-DANBY	PROJECT NO.:	NH 2132 (1) S
	DESIGN FILE NAME:	/pave/93b080a/pb080.dgn	PLOT DATE:	13-AUG-1999
	IPARM FILE NAME:	pb080i07.i	SURVEY DATE:	N/A
	SURVEYED BY:	N/A	DRAWN BY:	SJL
	SQUAD LEADER:	JAV	SHEET:	13 OF 19

TEMPORARY AND DURABLE 4" WHITE LINE
 STA. 217+00 TO STA. 220+86.24 SOLID LT. AND RT. (EDGE LINE)
 STA. 0+00 TO STA. 20+50 SOLID LT. AND RT. (EDGE LINE)
 STA. 217+00 TO STA. 220+86.24 DASHED RT. (PASSING LANE)
 STA. 0+00 TO STA. 10+50 DASHED RT. (PASSING LANE)

TEMPORARY AND DURABLE 4" YELLOW LINE
 STA. 217+00 TO STA. 220+86.24 SOLID LT. AND RT.
 STA. 0+00 TO STA. 20+50 SOLID LT. AND RT.

REMOVAL AND DISPOSAL OF GUARD RAIL
 STA. 13+48 TO STA. 13+85.5 LT.
 STA. 13+96 TO STA. 14+33.5 RT.
 STA. 15+10.5 TO STA. 15+48 LT.
 STA. 16+00 TO STA. 16+37.5 LT.
 STA. 17+33.5 TO STA. 17+58.5 RT.
 STA. 18+08.5 TO STA. 18+46 RT.

STEEL BEAM GUARD RAIL
 STA. 17+33.5 TO STA. 17+58.5 RT.

MANUFACTURED TERMINAL SECTION (FLARED)
 STA. 13+48 TO STA. 13+85.5 LT.
 STA. 13+96 TO STA. 14+33.5 RT.
 STA. 15+10.5 TO STA. 15+48 LT.
 STA. 16+00 TO STA. 16+37.5 LT.
 STA. 18+08.5 TO STA. 18+46 RT.

REMOVE AND RESET GUARD RAIL
 STA. 13+85.5 TO STA. 15+10.5 LT. (W/ 8' POST SPACING)
 STA. 14+33.5 TO STA. 17+33.5 RT.
 STA. 16+37.5 TO STA. 20+50 LT. (W/ 8' POST SPACING)
 STA. 17+58.5 TO STA. 18+08.5 RT.

REMOVING SIGNS
 1 -- AS SHOWN

ERECTING SALVAGED SIGNS
 1 -- AS SHOWN

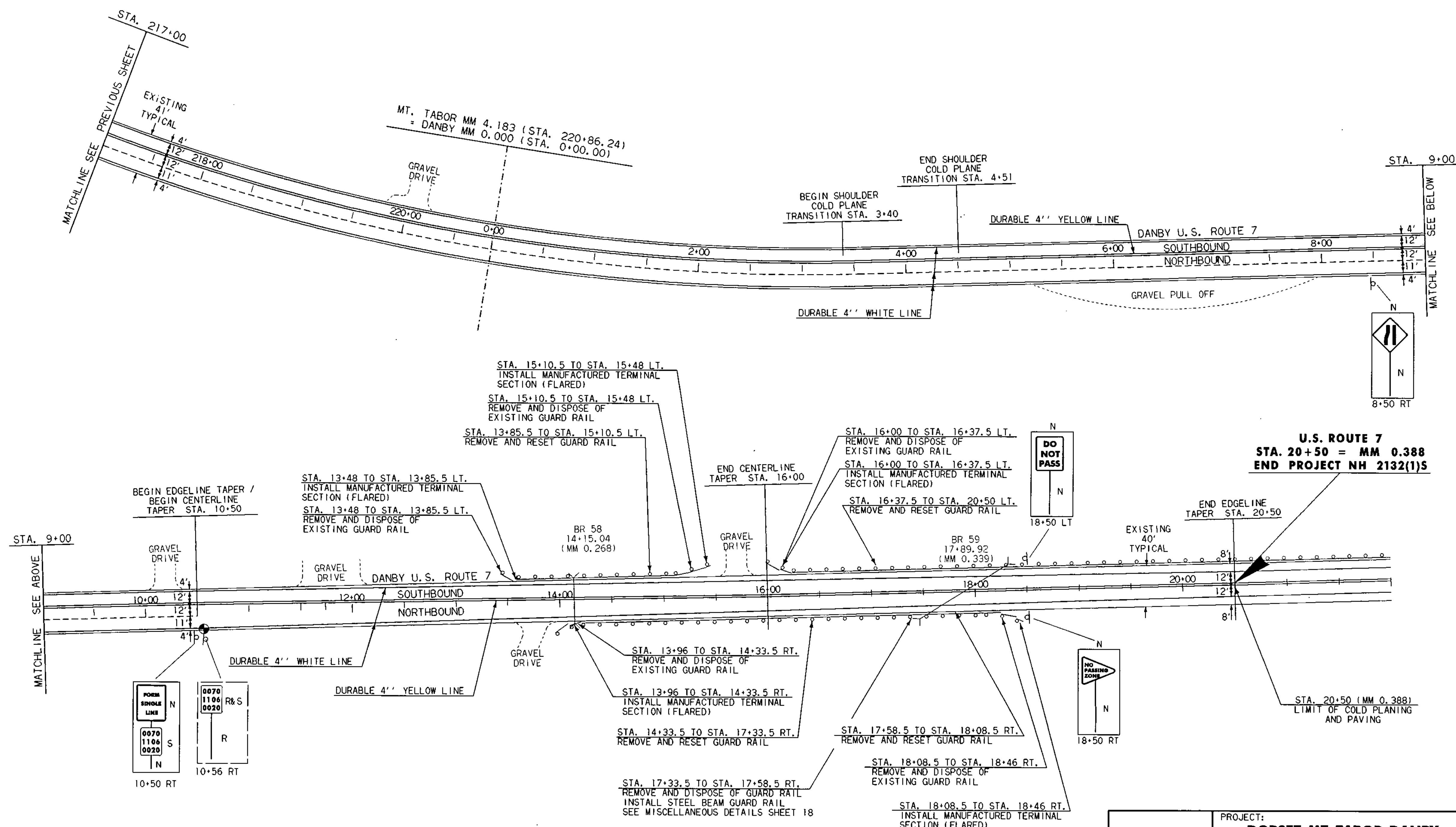

DATUM	
VERTICAL	N/A
HORIZONTAL	N/A

PAVING PROJECT LAYOUT	PROJECT: DORSET-MT TABOR-DANBY	PROJECT NO.: NH 2132 (1) S
	DESIGN FILE NAME: /pave/93b080/pb080.dgn	PLOT DATE: 13-AUG-1999
	IPARM FILE NAME: pb080i08.i	SURVEY DATE: N/A
	SURVEYED BY: N/A	DRAWN BY: SJL
	SQUAD LEADER: JAV	SHEET: 14 OF 19

LEGEND
 N = NEW
 R = REMOVE
 R&S = REMOVE AND SALVAGE
 S = SALVAGE SIGN
 RET = RETAIN
 B - B = BACK TO BACK

STATE OF VERMONT
AGENCY OF TRANSPORTATION

TRAFFIC SIGN SUMMARY SHEET

MILEMARKER, STATION, OR SIGN NUMBER	SIGN LEGEND	SIGN DIMENSIONS		NEW & SALVAGED SIGNS				EXIST. POST	NO. OF POSTS	NEW SIGN POSTS																REMARKS	SIGN DETAIL			
		EA	WIDTH (in)	HEIGHT (in)	"A"	"B"	SALV SIGN			SALV TIS	FLANGED CHANNEL			SQUARE STEEL (in)			TUBULAR ALUMINUM (in)			TUBULAR STEEL (in)				W-SHAPE STEEL			DETAIL ON SHEET NUMBER	STD. SHEET NUMBER		
											1.2	2.0	3.0	1.75	2.0	2.5	3.0	4.0	4.0 MOD	3.0	3.5	4.0	5.0	24"	30"				WEIGHT	POST SIZE
OPTION ITEMS																														
TOWN OF DORSET 159+26 LT		1	30	30	6.25				1			X			X													W4-1	E-151	
169+52 LT		1	24	30	5.0				1			X			X													R4-3	E-141M	
179+52 LT		1	24	30	5.0				1			X			X													SEE MISCELLANEOUS DETAILS	18	
179+52 RT		1	24	30	5.0				1			X			X													SEE MISCELLANEOUS DETAILS	18	
TOWN OF MT TABOR 111+00 LT		1	40	30	4.17				1			X			X													R4-1	E-141	
111+00 RT		1	24	30	5.0				1			X			X													W14-3	E-152	
115+50 LT		1	24	30	5.0				1			X			X													SEE MISCELLANEOUS DETAILS	18	
115+63 RT		1																												
115+63 LT		1																												
117+50 LT		1	30	30	6.25				1			X			X													W4-1	E-151	
125+14 RT		1																												
125+19 RT		1																												
FINAL POST LENGTHS ARE TO BE DETERMINED IN THE FIELD. POST SIZES ARE COMPUTED BASED ON INFORMATION FURNISHED ON THE STANDARD SHEETS AND THE TRAFFIC & SAFETY DIVISION'S "SIGN POST DESIGN GUIDELINE."																														
TOTALS		SF	SF	EA.	SF					FT	FT			EA.	LB	EA.	EA.	LB												
		41.67		5						120	120																			

PROJECT: DORSET-MT TABOR-DANBY	PROJECT NO.: NH 2132 (1) S
DESIGN FILE NAME: /pave/93b080a/pb080.dgn	PLOT DATE: 13-AUG-1999
IPARM FILE NAME: pb080ss2.1	SURVEY DATE: N/A
SURVEYED BY: N/A	DRAWN BY: SJL
SQUAD LEADER: JAV	SHEET: 16 OF 19

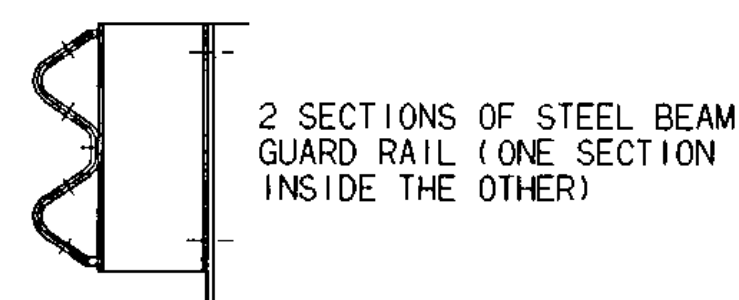

DETAIL A

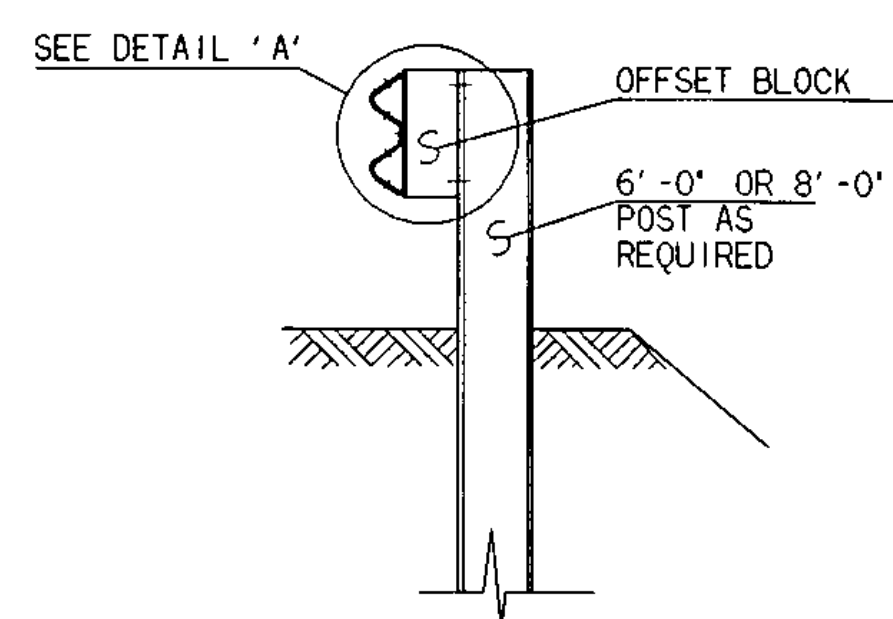

SECTION A-A

NOTES

1. SEE STANDARD G-1 & G-1D FOR STEEL BEAM GUARD RAIL DETAILS.
2. THIS WORK SHALL BE PAID UNDER ITEM 621.20, STEEL BEAM GUARD RAIL, OR 621.21 HEAVY DUTY STEEL BEAM GUARD RAIL AT A PAY FACTOR OF 1.0.
3. THIS DETAIL TO BE USED AS INDICATED ON THE ITEM DETAIL AND DRAINAGE SHEET OR AS DIRECTED BY THE ENGINEER.

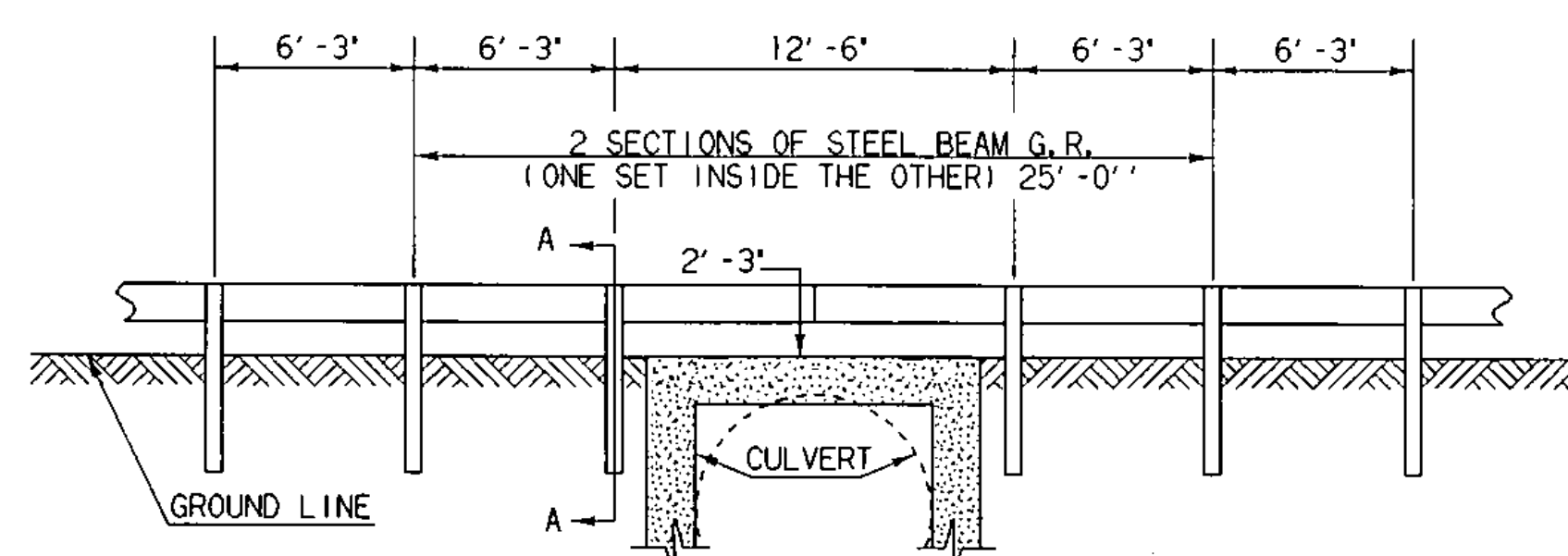

DETAIL OF STEEL BEAM GUARD RAIL AT SMALL CULVERTS

BRIDGE NUMBERS 56A, 56B, AND 59

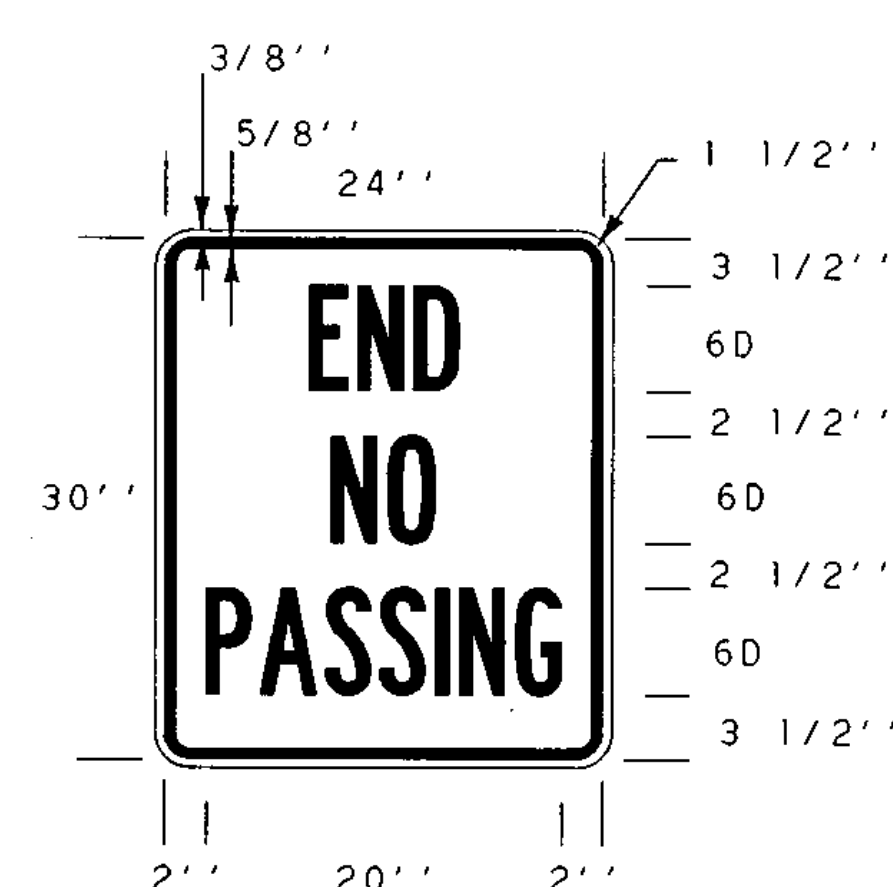
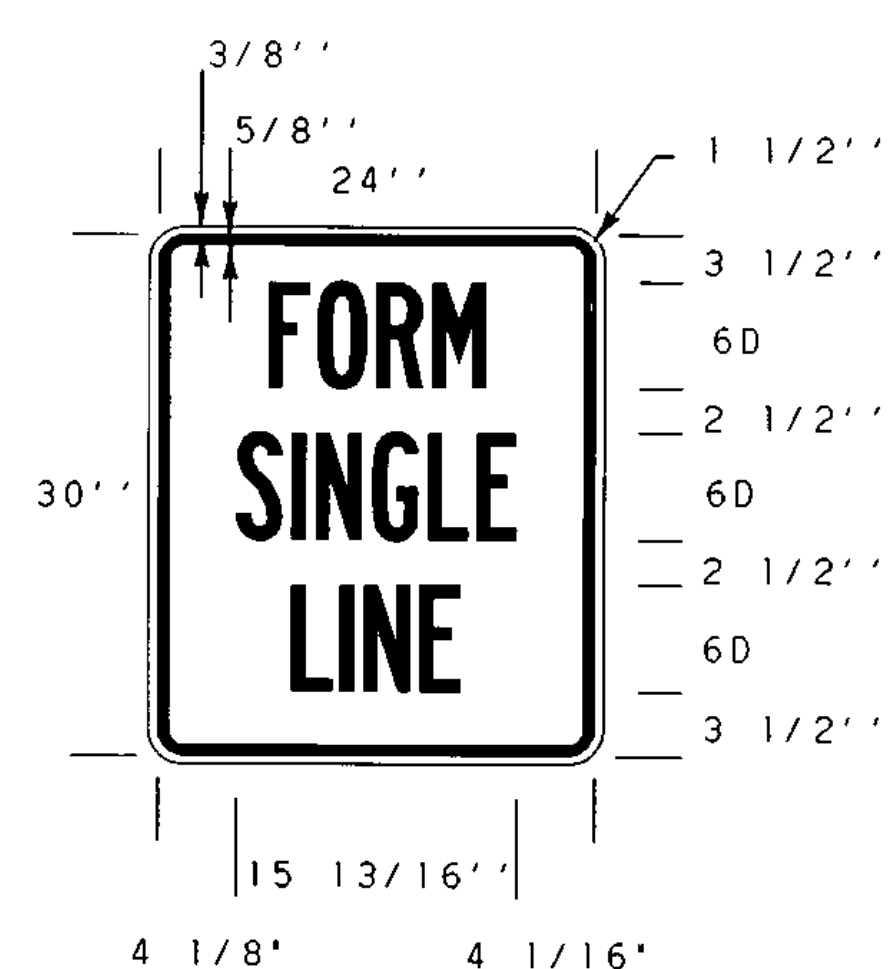
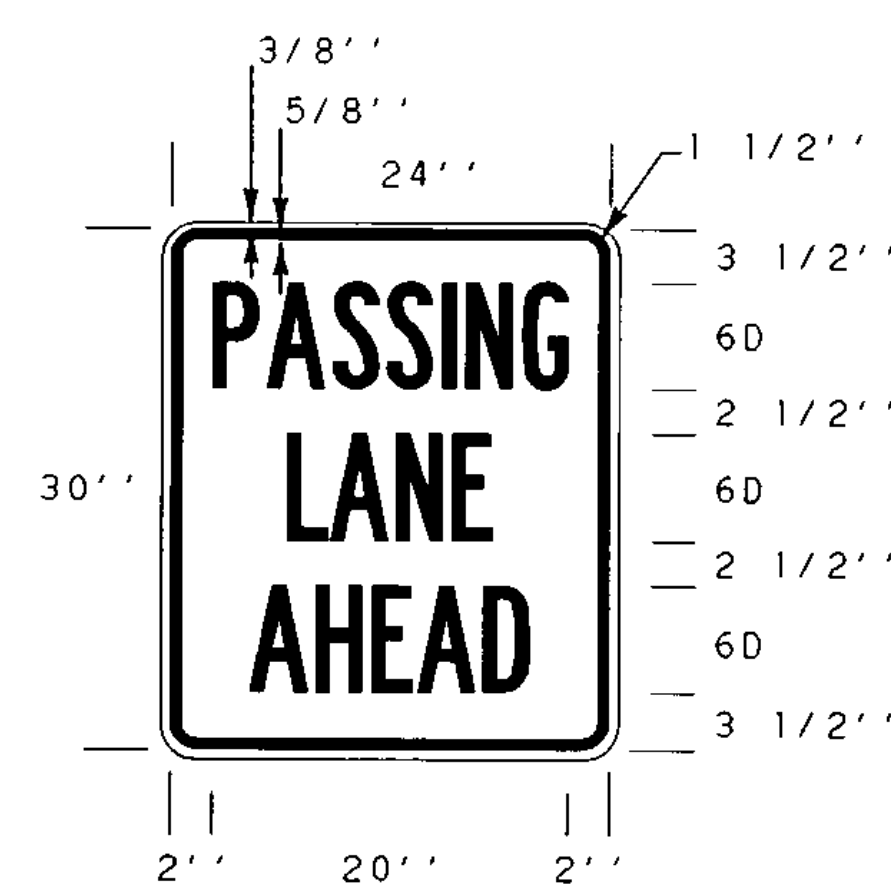

SEE STANDARD E- 140 FOR MATERIALS AND COLORS

MISCELLANEOUS DETAILS	PROJECT: DORSET-MT TABOR-DANBY	PROJECT NO.: NH 2132 (1) S
	DESIGN FILE NAME: /pave/93b080a/pb080.dgn	PLOT DATE: 13-AUG-1999
	IPARM FILE NAME: pb080md.1	SURVEY DATE: N/A
	SURVEYED BY: N/A	DRAWN BY: S.JL
	SQUAD LEADER: JAV	SHEET: 18 OF 19

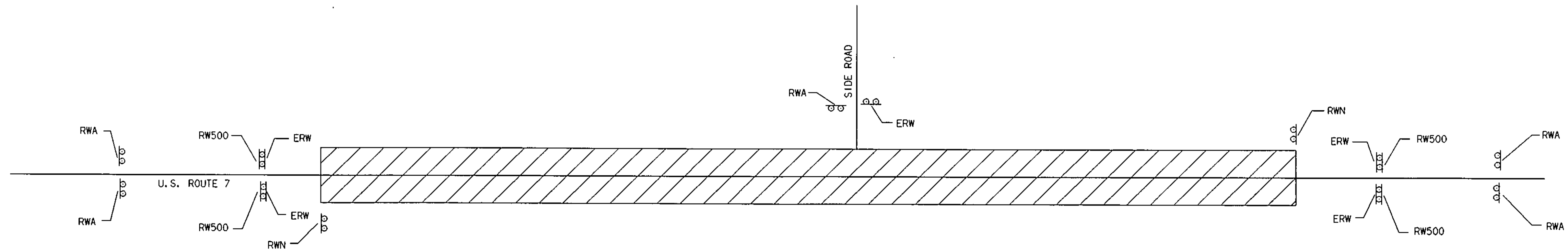

CONSTRUCTION APPROACH SIGNING
SEE STD. E-100 FOR SIGN PLACEMENT

LOCATION	RWA	ERW	RW500	RWN	OTHER
SQUIRREL HILL ROAD	1	1			
MAD TOM ROAD	1	1			
COOK ROAD	1	1			
GRIFFITH ROAD	1	1			
DEPOT STREET	2	2			
RAYMOND ROAD	1	1			
BEGINNING OF PROJECT	2	2	2	1	
END OF PROJECT	2	2	2	1	
TOTAL	11	11	4	2	

LEGEND
 RWA = ROAD WORK AHEAD
 RW500 = ROAD WORK 500 FT
 ERW = END ROAD WORK
 RWN = ROAD WORK NEXT 10 MILES

CONSTRUCTION APPROACH SIGNING	PROJECT: DORSET-MT TABOR-DANBY	PROJECT NO.: NH 2132 (1) S
	DESIGN FILE NAME: /pave/93b080a/pb080.dgn	PLOT DATE: 13-AUG-1999
	IPARM FILE NAME: pb080cas.1	SURVEY DATE: N/A
	SURVEYED BY: N/A	DRAWN BY: SJL
	SQUAD LEADER: JAV	SHEET: 19 OF 19