

TEMPORARY AND DURABLE 4 in YELLOW LINE

TOWN OF WATERVILLE
 STA 205+00 TO 221+91 SOLID LT&RT
 STA 220+75 DOUBLE SOLID LT
 (WITH CENTERLINE BREAKS FOR TOWN HIGHWAYS)

TOWN OF BELVIDERE
 STA 0+00 TO 12+00 SOLID LT&RT
 STA 9+00 LT DOUBLE SOLID LT
 (WITH CENTERLINE BREAKS FOR TOWN HIGHWAYS)

TEMPORARY AND DURABLE 4 in WHITE LINE

TOWN OF WATERVILLE
 STA 205+000 TO 221+91 SOLID LT&RT
 (WITH EDGELINE BREAKS FOR TOWN HIGHWAYS)

TOWN OF BELVIDERE
 STA 0+00 TO 12+00 SOLID LT&RT
 (WITH EDGELINE BREAKS FOR TOWN HIGHWAYS)

TEMPORARY AND DURABLE LETTER OR SYMBOL

TOWN OF WATERVILLE
 STA 220+75 LT "STOP"

TOWN OF BELVIDERE
 STA 9+00 LT "STOP"

TEMPORARY AND DURABLE 24 in STOP BAR

TOWN OF WATERVILLE
 STA 220+75 LT SMITHVILLE ROAD

TOWN OF BELVIDERE
 STA 9+00 LT BACK ROAD

REMOVING SIGNS

TOWN OF WATERVILLE
 -3-4

TOWN OF BELVIDERE
 1

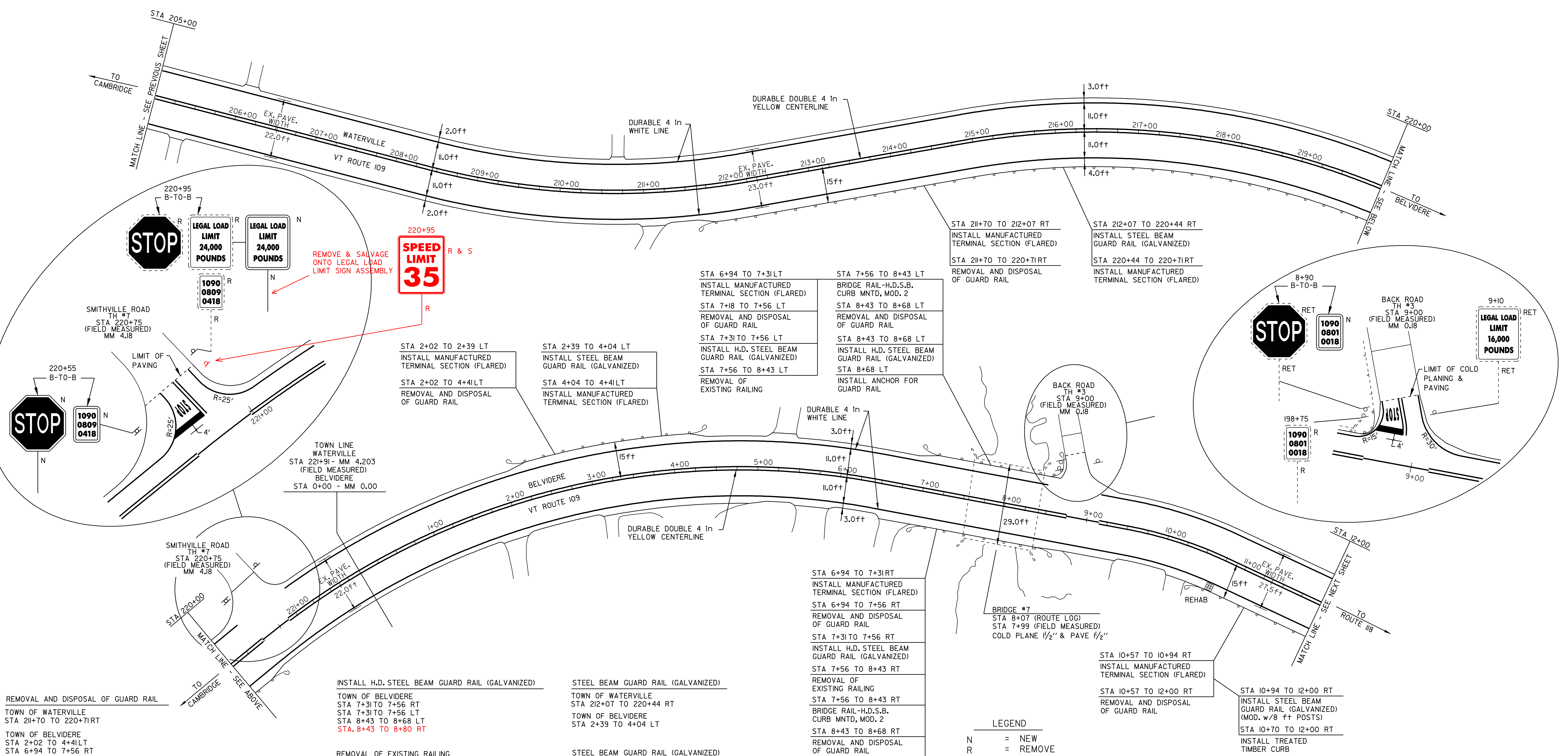

REMOVAL AND DISPOSAL OF GUARD RAIL

TOWN OF WATERVILLE
 STA 211+70 TO 220+71RT

TOWN OF BELVIDERE
 STA 2+02 TO 4+41LT
 STA 6+94 TO 7+56 RT
 STA 7+18 TO 7+56 LT
 STA 8+43 TO 8+68 RT
 STA 8+43 TO 8+68 LT
 STA 10+57 TO 10+94 RT

MANUFACTURED TERMINAL SECTION (FLARED)

TOWN OF WATERVILLE
 STA 211+70 TO 212+07 RT
 STA 220+44 TO 220+71RT

TOWN OF BELVIDERE
 STA 2+02 TO 2+39 LT
 STA 4+04 TO 4+41LT
 STA 6+94 TO 7+31RT
 STA 6+94 TO 7+31LT
 STA 8+43 TO 8+80 RT
 STA 10+57 TO 12+00 RT
 10+94

INSTALL H.D. STEEL BEAM GUARD RAIL (GALVANIZED)

TOWN OF BELVIDERE
 STA 7+31 TO 7+56 RT
 STA 7+31 TO 7+56 LT
 STA 8+43 TO 8+68 LT
 STA 8+43 TO 8+80 RT

REMOVAL OF EXISTING RAILING

TOWN OF BELVIDERE
 STA 7+56 TO 8+43 RT
 STA 7+56 TO 8+43 LT

ANCHOR FOR GUARD RAIL

TOWN OF BELVIDERE
 STA 8+68 LT
 STA 8+80 RT

TOWN OF BELVIDERE
 STA 7+56 TO 8+43 RT
 STA 7+56 TO 8+43 LT

STEEL BEAM GUARD RAIL (GALVANIZED)

TOWN OF WATERVILLE
 STA 212+07 TO 220+44 RT

TOWN OF BELVIDERE
 STA 2+39 TO 4+04 LT

STEEL BEAM GUARD RAIL (GALVANIZED) (MOD. w/8 ft POSTS)

TOWN OF BELVIDERE
 STA 10+94 TO 12+00 RT

TREATED TIMBER CURB

TOWN OF BELVIDERE
 STA 10+70 TO 12+00 RT

DITCHING LOCATIONS (REFER TO SHEET 9 FOR DETAILS)

TOWN OF WATERVILLE
 STA 210+40 TO 216+50 LT 210+14 ~ 210+69 LT
 STA 210+40 TO 216+50 LT 211+04 ~ 216+18 LT

TOWN OF BELVIDERE
 STA 8+93 ~ 10+02 LT BELVIDERE

STA 6+94 TO 7+31RT
 INSTALL MANUFACTURED TERMINAL SECTION (FLARED)

STA 6+94 TO 7+56 RT
 REMOVAL AND DISPOSAL OF GUARD RAIL

STA 7+31 TO 7+56 RT
 INSTALL H.D. STEEL BEAM GUARD RAIL (GALVANIZED)

STA 7+56 TO 8+43 RT
 REMOVAL OF EXISTING RAILING

STA 8+43 TO 8+68 RT
 REMOVAL AND DISPOSAL OF GUARD RAIL

STA 8+43 TO 8+80 RT
 INSTALL MANUFACTURED TERMINAL SECTION (FLARED)

STA 8+43 TO 8+80 RT
 INSTALL H.D. STEEL BEAM GUARD RAIL (GALVANIZED)

STA 8+43 TO 8+80 RT
 INSTALL MANUFACTURED TERMINAL SECTION (FLARED)

STA 8+43 TO 8+80 RT
 INSTALL H.D. STEEL BEAM GUARD RAIL (GALVANIZED)

STA 8+80 RT
 INSTALL ANCHOR FOR GUARD RAIL

- LEGEND**
- N = NEW
 - R = REMOVE
 - R&S = REMOVE & SALVAGE
 - S = SALVAGE
 - RET = RETAIN
 - B-T-O-B = BACK TO BACK
 - ⊕ ⊞ ⊠ = CATCH BASIN/DI
 - ⊙ ⊠ = EXISTING THROAT DI
 - I = MARKER POST
 - ⊗ ⊘ = UTILITY POLE
 - ⊗ ⊘ ⊗ ⊘ = UTIL. POLE W/UNDERGROUND UTIL.
 - ⊗ ⊘ ⊗ ⊘ ⊗ ⊘ = DRIVE

PAVING PROJECT LAYOUT SHEET #15

DESIGNED BY BCE/PJM DATE 8-05

DRAWN BY C.E.A., INC. DATE 8-05

DESIGN FILE NO. p99cl90.dgn

PRF FILE p99cl90i15.1 DATE 12-DEC-2008

PROJ. NAME **CAMBRIDGE - BELVIDERE**

PROJ. NO. **STP 2219(1)S**

SHEET **24** OF **37** SHEETS