

TEMPORARY AND DURABLE 4 in YELLOW LINE
 STA 145+00 TO 175+00
 SOLID LT&RT

TEMPORARY AND DURABLE LETTER OR SYMBOL
 STA 174+40 RT
 "SCHOOL"

TEMPORARY AND DURABLE 4 in WHITE LINE
 STA 145+00 TO 175+00
 SOLID LT&RT

REMOVAL AND DISPOSAL OF GUARD RAIL
 STA 149+26 TO 151+75 RT
 STA 149+71 TO 151+95 LT
 STA 159+11 TO 165+22 RT
 STA 172+41 TO 175+00 RT

MANUFACTURED TERMINAL SECTION (FLARED)
 STA 149+26 TO 149+63 RT
 STA 149+71 TO 150+08 LT
 STA 151+38 TO 151+75 RT
 STA 151+58 TO 151+95 LT
 STA 159+11 TO 159+48 RT
 STA 164+85 TO 165+22 RT
 STA 172+41 TO 172+78 RT

STEEL BEAM GUARD RAIL (GALVANIZED) (MOD. w/8 ft POSTS)
 STA 149+63 TO 150+50 RT
 STA 150+08 TO 150+83 LT 151+58
 STA 159+48 TO 162+60 RT
 STA 174+78 TO 175+00 RT
 172+78

STEEL BEAM GUARD RAIL (GALVANIZED)
 STA 150+50 TO 151+38 RT
~~STA 150+83 TO 151+58 LT~~
 STA 162+60 TO 164+85 RT
~~STA 172+78 TO 174+78 RT~~

REHABILITATION OF C.B.'S, D.J.'S, OR M.H.'S
 STA 164+92 LT
 STA 173+43 LT

DITCHING LOCATIONS

152+29 ~ 155+21 LT
 159+32 ~ 160+71 LT
 165+54 ~ 167+66 LT
 168+00 ~ 168+56 LT
 174+64 ~ 175+03 LT

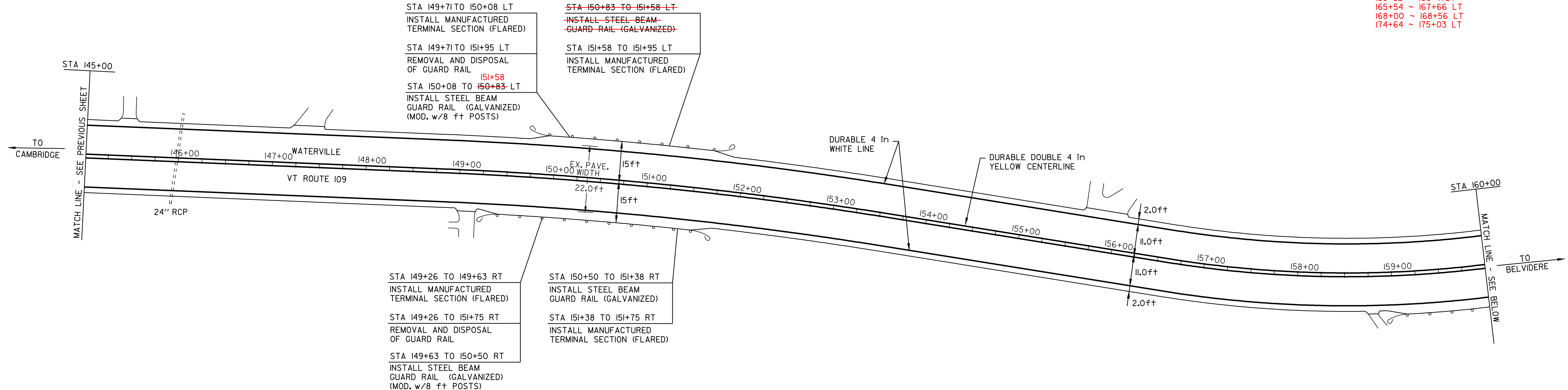

BITUMINOUS CONCRETE GUTTER
 STA 172+00 TO 173+43 LT

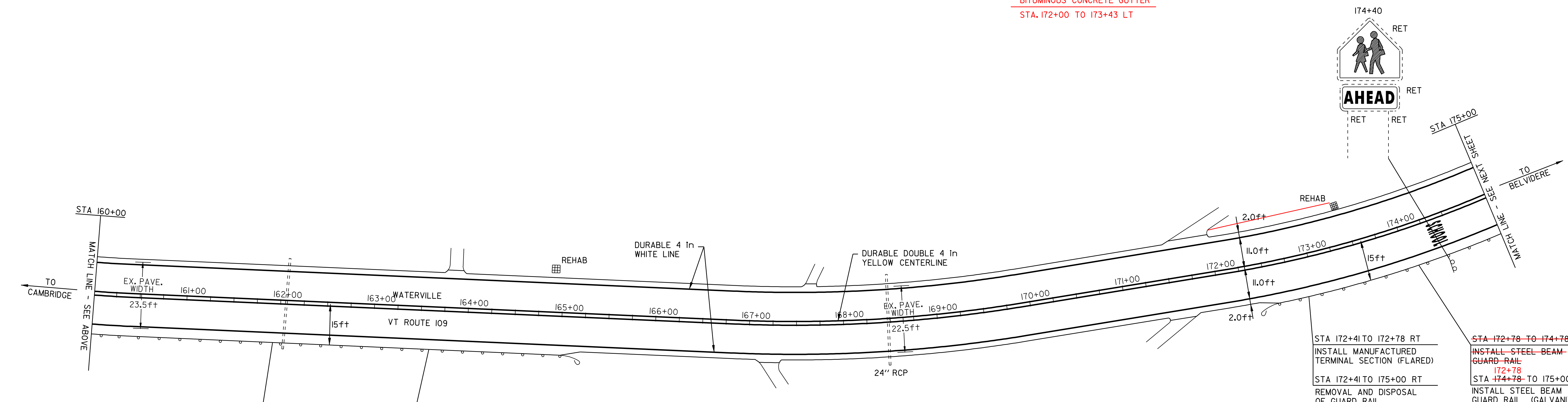

- LEGEND**
- N = NEW
 - R = REMOVE
 - R&S = REMOVE & SALVAGE
 - S = SALVAGE
 - RET = RETAIN
 - B-TO-B = BACK TO BACK
 - ⊕ ⊞ ⊠ = CATCH BASIN/DI
 - ⊙ ⊞ = EXISTING THROAT DI
 - I = MARKER POST
 - ⊗ = UTILITY POLE
 - ⊗/I = UTIL. POLE W/UNDERGROUND UTIL.
 - ⌌ = DRIVE

PAVING PROJECT LAYOUT SHEET #13

DESIGNED BY	BCE/PJM	DATE	8-05
DRAWN BY	C.E.A., INC.	DATE	8-05
DESIGN FILE NO.	p99ci90.dgn		
PRF FILE	p99ci90i3.i	DATE PLOTTED	12-DEC-2008 09
PROJ. NAME	CAMBRIDGE - BELVIDERE		
PROJ. NO.	STP 2219(1)S		
SHEET	22	OF	37 SHEETS