

TEMPORARY AND DURABLE 4 in YELLOW LINE
 STA 21+00 TO 36+00
 SOLID LT&RT
 DOUBLE SOLID LT
 (WITH CENTERLINE BREAKS FOR TOWN HIGHWAYS)

TEMPORARY AND DURABLE 4 in WHITE LINE
 STA 21+00 TO 36+00
 SOLID LT&RT
 (WITH EDGE LINE BREAKS FOR TOWN HIGHWAYS)

TEMPORARY AND DURABLE LETTER OR SYMBOL
 STA 28+13 LT
 "STOP"

TEMPORARY AND DURABLE 24 in STOP BAR
 STA 28+13 LT
 CHURCH STREET

REMOVING SIGNS
 7
 8

REMOVAL AND DISPOSAL OF GUARD RAIL
 STA 34+40 TO 36+00 LT

ANCHOR FOR GUARD RAIL
 STA 34+40 LT

STEEL BEAM GUARD RAIL (GALVANIZED)
 STA 34+40 TO 36+00 LT

DITCHING LOCATIONS
 31+82 ~ 32+41 RT
 34+40 ~ 34+63 RT

REHABILITATION OF C.B.'S, D.I.'S, OR M.H.'S
 STA 31+90 LT&RT
 STA 32+60 LT
 STA 34+46 RT

BITUMINOUS CONCRETE GUTTER
 STA 21+00 TO 21+90 RT 21+75 RT
 STA 25+90 TO 31+60 RT 25+75 ~ 28+00 RT
 STA 31+90 TO 34+00 LT
 STA 32+00 TO 33+20 RT
 STA 34+46 RT

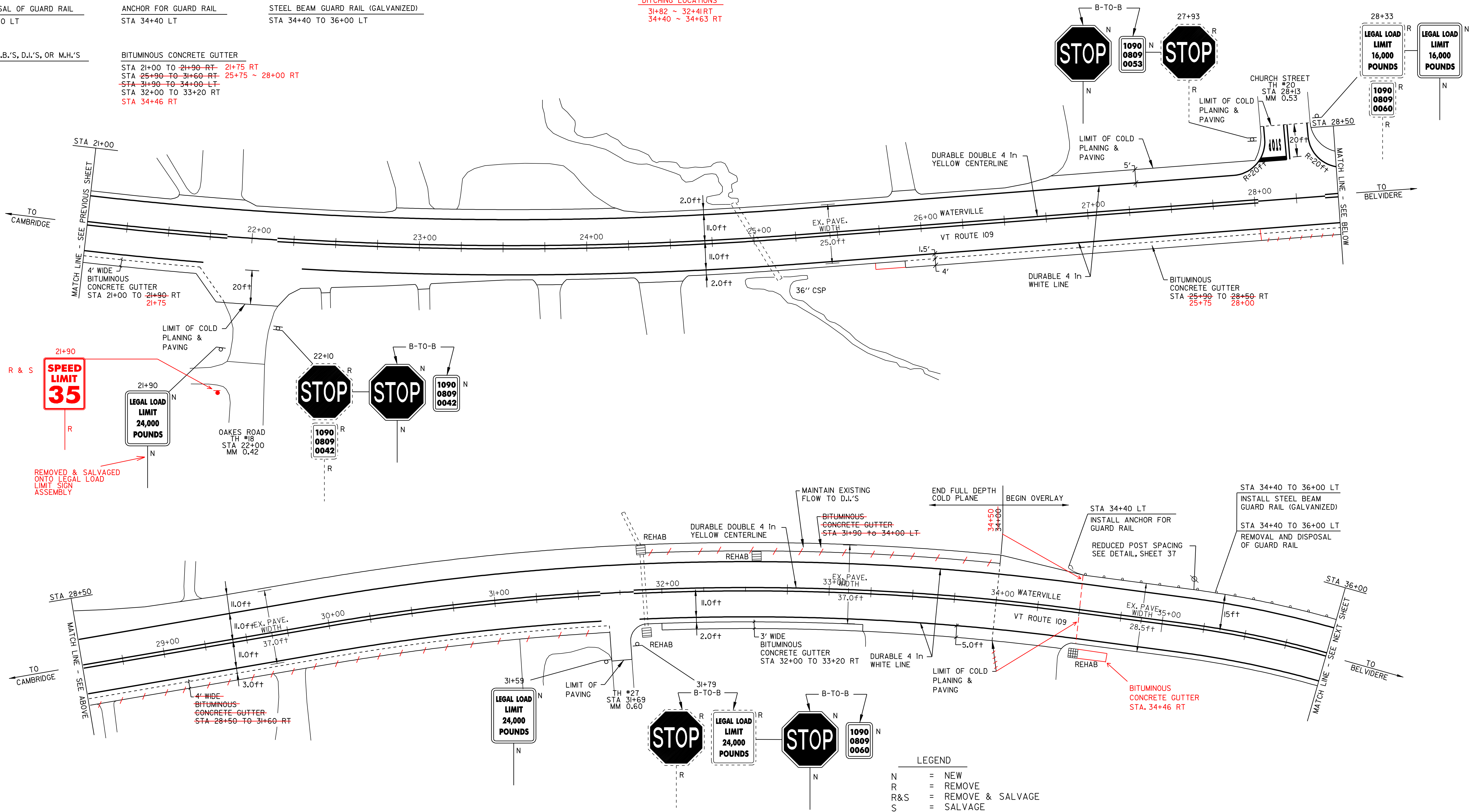

- LEGEND
- N = NEW
 - R = REMOVE
 - R&S = REMOVE & SALVAGE
 - S = SALVAGE
 - RET = RETAIN
 - B-TO-B = BACK TO BACK
 - ⊕ ⊞ ⊠ = CATCH BASIN/DI
 - ⊙ ⊠ = EXISTING THROAT DI
 - I = MARKER POST
 - ⊗ = UTILITY POLE
 - ⊗/I = UTIL. POLE W/UNDERGROUND UTIL.
 - ⌋ = DRIVE

PAVING PROJECT LAYOUT SHEET #8

DESIGNED BY	BCE/PJM	DATE	8-05
DRAWN BY	C.E.A., INC.	DATE	8-05
DESIGN FILE NO.	p99ci90.dgn		
PRF FILE	p99ci90i08.i	DATE PLOTTED	12-DEC-2008 09
PROJ. NAME	CAMBRIDGE - BELVIDERE		
PROJ. NO.	STP 2219(1)S		
SHEET	17	OF	37 SHEETS