

TEMPORARY AND DURABLE 4 in YELLOW LINE  
 STA 135+00 TO 165+00 SOLID LT&RT  
 (WITH CENTERLINE BREAKS FOR TOWN HIGHWAYS)

TEMPORARY AND DURABLE 4 in WHITE LINE  
 STA 135+00 TO 165+00 SOLID LT&RT  
 (WITH EDGELINE BREAKS FOR TOWN HIGHWAYS)

REMOVING SIGNS  
 3

REMOVAL AND DISPOSAL OF GUARD RAIL

STA 142+78 TO 143+40 RT  
 STA 142+78 TO 143+40 LT  
 STA 143+65 TO 144+27 RT  
 STA 143+65 TO 144+27 LT

MANUFACTURED TERMINAL SECTION (FLARED)

STA 142+78 TO 143+15 RT  
 STA 142+78 TO 143+15 LT  
 STA 143+90 TO 144+27 RT  
 STA 143+90 TO 144+27 LT

H.D. STEEL BEAM GUARD RAIL (GALVANIZED)

STA 143+15 TO 143+40 RT  
 STA 143+15 TO 143+40 LT  
 STA 143+65 TO 143+90 RT  
 STA 143+65 TO 143+90 LT

DITCHING LOCATIONS (REFER TO SHEET 9 FOR DETAILS)

~~STA 135+00 TO 139+15 LT~~  
~~STA 140+25 TO 143+00 LT~~ 138+91 ~ 142+40  
~~STA 146+50 TO 155+50 LT~~ 146+73 ~ 158+00  
~~STA 158+00 TO 163+25 LT~~ 158+44 ~ 163+24

REMOVAL OF EXISTING RAILING

STA 143+40 TO 143+65 RT  
 STA 143+40 TO 143+65 LT

BRIDGE RAIL-H.D.S.B. CURB MOUNTED, MOD. 1

STA 143+40 TO 143+65 RT  
 STA 143+40 TO 143+65 LT

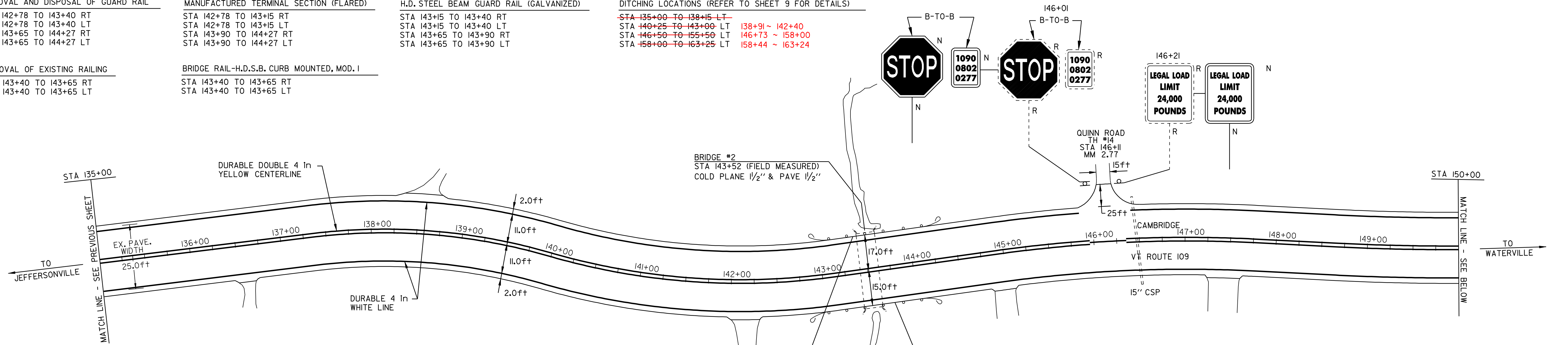

STA 142+78 TO 143+15 LT INSTALL MANUFACTURED TERMINAL SECTION (FLARED) STA 142+78 TO 143+40 LT REMOVAL AND DISPOSAL OF GUARD RAIL STA 143+15 TO 143+40 LT INSTALL H.D.S.B. GUARD RAIL STA 143+40 TO 143+65 LT REMOVAL OF EXISTING RAILING	STA 143+40 TO 143+65 LT BRIDGE RAIL-H.D.S.B. CURB MNTD, MOD. 1 STA 143+65 TO 143+90 LT INSTALL H.D.S.B. GUARD RAIL STA 143+65 TO 144+27 LT REMOVAL AND DISPOSAL OF GUARD RAIL STA 143+90 TO 144+27 LT INSTALL MANUFACTURED TERMINAL SECTION (FLARED)	STA 142+78 TO 143+15 RT INSTALL MANUFACTURED TERMINAL SECTION (FLARED) STA 142+78 TO 143+40 RT REMOVAL AND DISPOSAL OF GUARD RAIL STA 143+15 TO 143+40 RT INSTALL H.D.S.B. GUARD RAIL STA 143+40 TO 143+65 RT REMOVAL OF EXISTING RAILING	STA 143+40 TO 143+65 RT BRIDGE RAIL-H.D.S.B. CURB MNTD, MOD. 1 STA 143+65 TO 143+90 RT INSTALL H.D.S.B. GUARD RAIL STA 143+65 TO 144+27 RT REMOVAL AND DISPOSAL OF GUARD RAIL STA 143+90 TO 144+27 RT INSTALL MANUFACTURED TERMINAL SECTION (FLARED)
--	---	--	---

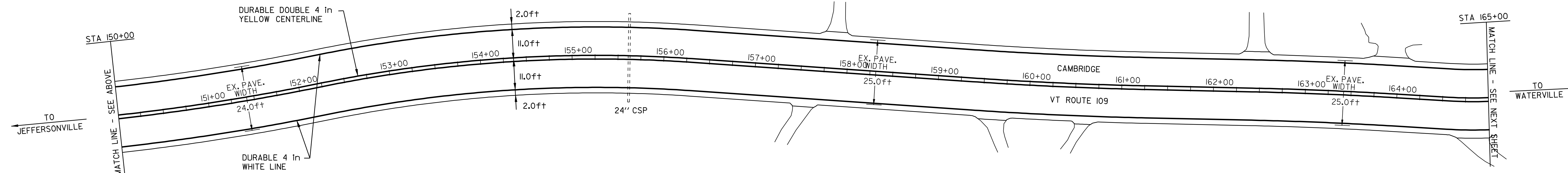

LEGEND

N	=	NEW
R	=	REMOVE
R&S	=	REMOVE & SALVAGE
S	=	SALVAGE
RET	=	RETAIN
B-TO-B	=	BACK TO BACK
⊕	⊗	CATCH BASIN/DI
⊙	⊠	EXISTING THROAT DI
I		MARKER POST
⊗		UTILITY POLE
⊗		UTIL. POLE W/UNDERGROUND UTIL.
⊎		DRIVE

## PAVING PROJECT LAYOUT SHEET #5

DESIGNED BY	BCE/PJM	DATE	8-05
DRAWN BY	C.E.A., INC.	DATE	8-05
DESIGN FILE NO.	p99cl90.dgn		
PRF FILE	p99cl90i05.1	DATE PLOTTED	12-DEC-2008 03
PROJ. NAME	CAMBRIDGE - BELVIDERE		
PROJ. NO.	STP 2219(1)S		
SHEET	14	OF	37 SHEETS