

CONSTRUCTION APPROACH SIGNING

NOT TO SCALE

SEE STD E-100, E-100A AND E-103 FOR SIGN PLACEMENT

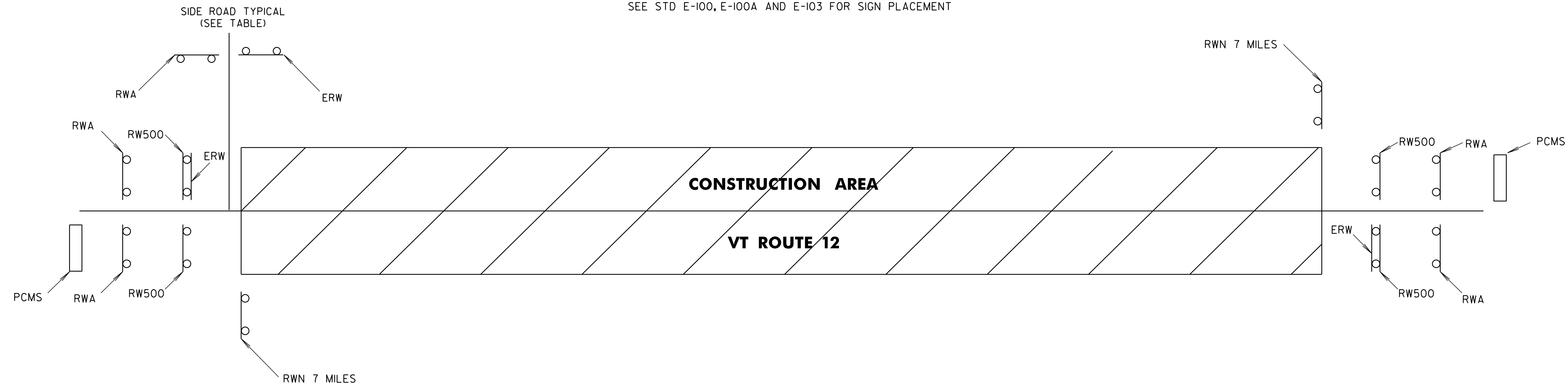

NOTES:

- THE CONTRACTOR SHALL SUBMIT A TRAFFIC CONTROL PLAN TO THE RESIDENT ENGINEER FOR THEIR APPROVAL PRIOR TO THE START OF CONSTRUCTION. THE COST OF PREPARING THIS PLAN (AND MAKING CHANGES IF NECESSARY) SHALL NOT BE PAID SEPARATELY BUT SHALL BE INCIDENTAL TO ITEM 641.10, "TRAFFIC CONTROL".
- THE CONTRACTOR SHALL INCLUDE A CONSTRUCTION SIGN APPROACH PACKAGE FOR EXPECTED LANE CLOSURES AND WORK ZONE SPEED REDUCTIONS IN COMPLIANCE WITH THE TRAFFIC CONTROL NOTES AND PART 6 OF THE MUTCD. PAYMENT FOR PROVIDING THIS PACKAGE SHALL BE INCIDENTAL TO ITEM 641.10, "TRAFFIC CONTROL".
- THE BID PRICE FOR "TRAFFIC CONTROL", ITEM 641.10, SHALL INCLUDE ALL OF THE FOLLOWING, AS NEEDED: APPROACH AND ON-PROJECT CONSTRUCTION SIGNING, PORTABLE ARROW BOARDS, BARRIERS, BARRELS, CONES, BARRICADES, TEMPORARY REGULATORY AND WARNING SIGNS, AND POSTS AS DETAILED IN VTRANS STANDARDS. ALL ADJUSTING, RELOCATING, AND REMOVING OF THESE DEVICES AS DIRECTED BY THE RESIDENT ENGINEER SHALL ALSO BE INCLUDED. THE FOLLOWING ITEMS WILL BE PAID FOR SEPARATELY:
 646.602 AND 646.612 - TEMPORARY PAVEMENT MARKINGS
 630.10 UNIFORMED TRAFFIC OFFICER, 630.15 - FLAGGERS
- PORTABLE CHANGEABLE MESSAGE SIGNS (PCMS) WILL BE PROVIDED FOR USE ALONG THIS PROJECT. THE PLACEMENT OF THESE UNITS AS WELL AS THE MESSAGE WILL BE APPROVED BY THE RESIDENT ENGINEER. THESE SIGNS WILL BE PAID FOR UNDER ITEM 641.15, "PORTABLE CHANGEABLE MESSAGE SIGN".

 PCMS SHOULD NOT REPLACE ANY OF THE SIGNING DETAILED IN THE MUTCD AND SHOULD NOT BE USED IF STANDARD TRAFFIC CONTROL DEVICES ADEQUATELY PROVIDE THE INFORMATION THE MOTORISTS NEED TO TRAVEL SAFELY.

 THE PCMS SHALL CONSIST OF EITHER ONE OR TWO PHASES. TYPICALLY, A PHASE SHALL CONSIST OF UP TO THREE LINES OF EIGHT CHARACTERS PER LINE. THE PCMS SHOULD BE USED AS A SUPPLEMENT AND NOT AS A SUBSTITUTE FOR CONVENTIONAL SIGNS AND PAVEMENT MARKINGS.

 THE PCMS SHOULD COMMUNICATE WHAT INFORMATION MOTORISTS NEED TO KNOW. UNNECESSARY INFORMATION SHOULD BE AVOIDED. MESSAGES SHOULD BE UPDATED PERIODICALLY TO DESCRIBE THE WORK ACTIVITY OCCURRING SO THAT THE PCMS CONTINUES TO COMMAND THE ATTENTION OF MOTORISTS.
- THE MUTCD 2003 SHALL BE THE STANDARD FOR ALL TRAFFIC CONTROL DEVICES. EXISTING SIGNS, SIGNALS AND MARKINGS SHALL BE VALID UNTIL SUCH TIME AS THEY ARE REPLACED OR RECONSTRUCTED. WHEN NEW TRAFFIC CONTROL DEVICES ARE ERECTED OR PLACED OR EXISTING TRAFFIC CONTROL DEVICES ARE REPLACED OR REPAIRED THE EQUIPMENT, DESIGN, METHOD OF INSTALLATION, PLACEMENT OR REPAIR SHALL CONFORM WITH SUCH STANDARDS.
- NO CONSTRUCTION SIGNS SHALL BE INSTALLED AS TO INTERFERE OR OBSTRUCT THE VIEW OF EXISTING TRAFFIC CONTROL DEVICES, STOPPING SIGHT DISTANCE, AND CORNER SIGHT DISTANCE FROM DRIVES AND TOWN HIGHWAYS.

	ROAD WORK AHEAD	END ROAD WORK	ROAD WORK 500 FT	ROAD WORK NEXT 7.5 MILES	PCMS
WORCESTER					
BEGIN PROJECT (VT 12)	2	1	2	1	1
HANCOCK BROOK RD	1	1			
ELMORE					
END PROJECT (VT 12)	2	1	2	1	1
TOTALS	5	3	4	2	2

LEGEND

- RWA = ROAD WORK AHEAD
- RW500 = ROAD WORK 500 FT
- ERW = END ROAD WORK
- RWN = ROAD WORK NEXT 7.5 MILES
- PCMS = PORTABLE CHANGEABLE MESSAGE SIGN

CONSTRUCTION APPROACH SIGNING SHEET

PROJECT NAME: WORCESTER-ELMORE	PLOT DATE: 23-SEP-2011 15:25
PROJECT NUMBER: STP 2209(1)S	DRAWN BY: SJL
FILE NAME: 99c170.dgn	CHECKED BY: EPD
PROJECT LEADER: CDL	SHEET 36 OF 36
DESIGNED BY: SJL	
PLOT FILE: 99c170_37.i	