

~~646.412 DURABLE 4 INCH YELLOW LINE, THERMOPLASTIC~~  
~~STA. 79+50 - STA. 79+83 (SOLID RT)~~  
~~STA. 79+50 - STA. 87+12 (SOLID LT)~~  
~~STA. 79+83 - STA. 86+51 (DASHED RT)~~  
~~STA. 86+51 - STA. 95+50 (SOLID RT)~~  
~~STA. 87+12 - STA. 94+25 (DASHED LT)~~  
~~STA. 94+25 - STA. 95+50 (SOLID LT)~~

646.612 TEMPORARY 4 INCH YELLOW LINE, PAINT  
 STA. 79+50 - STA. 79+83 (SOLID RT)  
 STA. 79+50 - STA. 87+12 (SOLID LT)  
 68 STA. 79+83 - STA. 86+51 (DASHED RT)  
 60 STA. 86+51 - STA. 95+50 (SOLID RT)  
 08 STA. 87+12 - STA. 94+25 (DASHED LT)  
 16 STA. 94+25 - STA. 95+50 (SOLID LT)

~~646.402 DURABLE 4 INCH WHITE LINE, THERMOPLASTIC~~  
~~STA. 79+50 - STA. 95+50 (SOLID LT & RT)~~

646.602 TEMPORARY 4 INCH WHITE LINE, PAINT  
 STA. 79+50 - STA. 95+50 (SOLID LT & RT)

601.0010 15" CSP .064 (2-2/3 X 1/2)  
 STA. 94+87 - STA. 95+17 LT

621.20 STEEL BEAM GUARDRAIL, GALVANIZED  
 STA. 79+50.00 - STA. 80+98.00 LT 82+10.00  
 STA. 81+60.50 - STA. 83+98.00 LT  
 95.00 STA. 93+87.50 - STA. 94+25.00 LT 07.50  
 93+94.00 STA. 94+00.00 - STA. 94+25.00 RT 06.50  
 81.00 STA. 94+62.50 - STA. 94+87.50 RT 92.00  
 STA. 94+82.50 - STA. 94+95.00 LT

621.205 STEEL BEAM GUARDRAIL, GALVANIZED W/8 FEET POSTS  
 STA. 80+98.00 - STA. 81+60.50 LT  
 82+10.00 - STA. 84+00.00

621.206 STEEL BEAM GUARDRAIL, GALVANIZED/NESTED  
 STA. 94+25.00 - STA. 94+62.50 LT  
 STA. 94+25.00 - STA. 94+62.50 RT

621.50 MANUFACTURED TERMINAL SECTION, FLARED  
 STA. 83+98.00 - STA. 84+35.50 LT 84+38.00  
 57.50 STA. 93+50.00 - STA. 93+87.50 LT 95.00  
 56.50 STA. 93+62.50 - STA. 94+00.00 RT 93+94.00  
 95.00 STA. 94+62.50 - STA. 95+00.00 LT 32.50  
 92.00 STA. 94+87.50 - STA. 95+25.00 RT 29.50

621.80 REMOVAL AND DISPOSAL OF GUARDRAIL  
 STA. 79+50.00 - STA. 83+12.50 LT  
 63 STA. 93+50.00 - STA. 95+00.00 LT 94+32.50  
 STA. 93+78.50 - STA. 95+17.50 RT 94+31.50  
 STA. 94+56.50 - STA. 95+17.00 RT  
 STA. 94+57.50 - STA. 95+00.00 LT

BRIDGE RAILING REPAIR, TYPE II  
 STA. 94+32.50 - STA. 94+57.50 LT  
 STA. 94+31.50 - STA. 94+56.50 RT

REMOVAL OF EXISTING RAILING  
 STA. 94+32.50 - STA. 94+57.50 LT  
 STA. 94+31.50 - STA. 94+56.50 RT

621.21 HD STEEL BEAM GUARDRAIL, GALV.  
 STA. 94+07.50 - STA. 94+32.50 LT  
 STA. 94+57.50 - STA. 94+82.50 LT  
 STA. 94+06.50 - STA. 94+31.50 RT  
 STA. 94+56.50 - STA. 94+81.00 RT

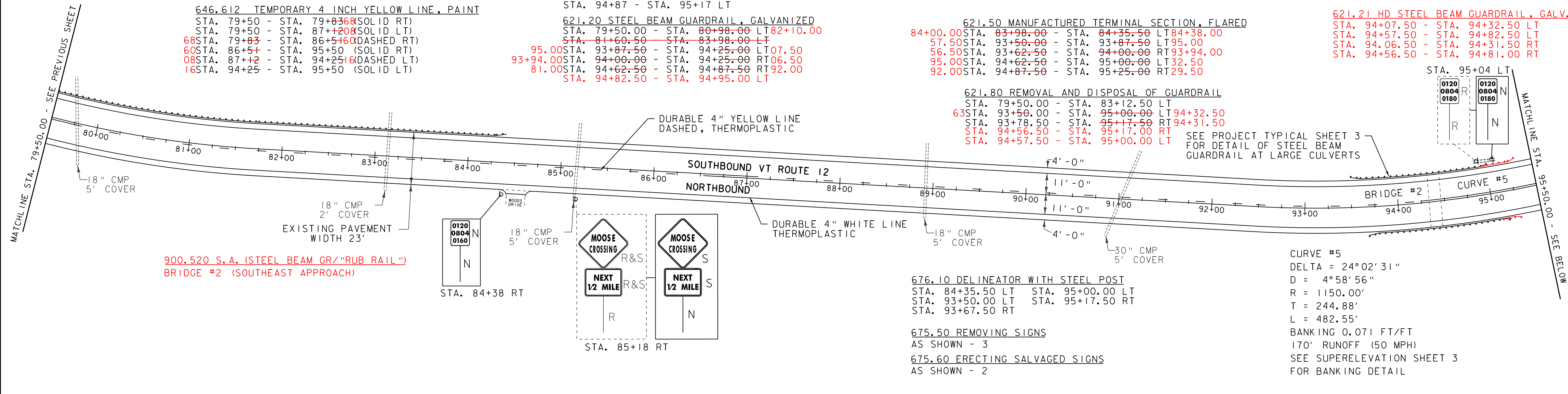

900.520 S.A. (STEEL BEAM GR/"RUB RAIL")  
 BRIDGE #2 (SOUTHEAST APPROACH)

CURVE #5  
 DELTA = 24°02'31"  
 D = 4°58'56"  
 R = 1150.00'  
 T = 244.88'  
 L = 482.55'  
 BANKING 0.071 FT/FT  
 170' RUNOFF (50 MPH)  
 SEE SUPERELEVATION SHEET 3  
 FOR BANKING DETAIL

676.10 DELINEATOR WITH STEEL POST  
 STA. 84+35.50 LT STA. 95+00.00 LT  
 STA. 93+50.00 LT STA. 95+17.50 RT  
 STA. 93+67.50 RT

675.50 REMOVING SIGNS  
 AS SHOWN - 3

675.60 ERECTING SALVAGED SIGNS  
 AS SHOWN - 2

646.602 TEMPORARY 4 INCH WHITE LINE, PAINT  
 STA. 95+50 - STA. 111+50 (SOLID LT & RT)

~~646.412 DURABLE 4 INCH YELLOW LINE, THERMOPLASTIC~~  
~~STA. 95+50 - STA. 111+50 (SOLID LT & RT)~~

646.612 TEMPORARY 4 INCH YELLOW LINE, PAINT  
 STA. 95+50 - STA. 111+50 (SOLID LT & RT)

CURVE #6  
 DELTA = 14°59'33"  
 D = 2°51'53"  
 R = 2000.00'  
 T = 263.17'  
 L = 523.34'  
 BANKING 0.051 FT/FT  
 150' RUNOFF (50 MPH)  
 SEE SUPERELEVATION SHEET 3  
 FOR BANKING DETAIL

~~646.402 DURABLE 4 INCH WHITE LINE, THERMOPLASTIC~~  
~~STA. 95+50 - STA. 111+50 (SOLID LT & RT)~~

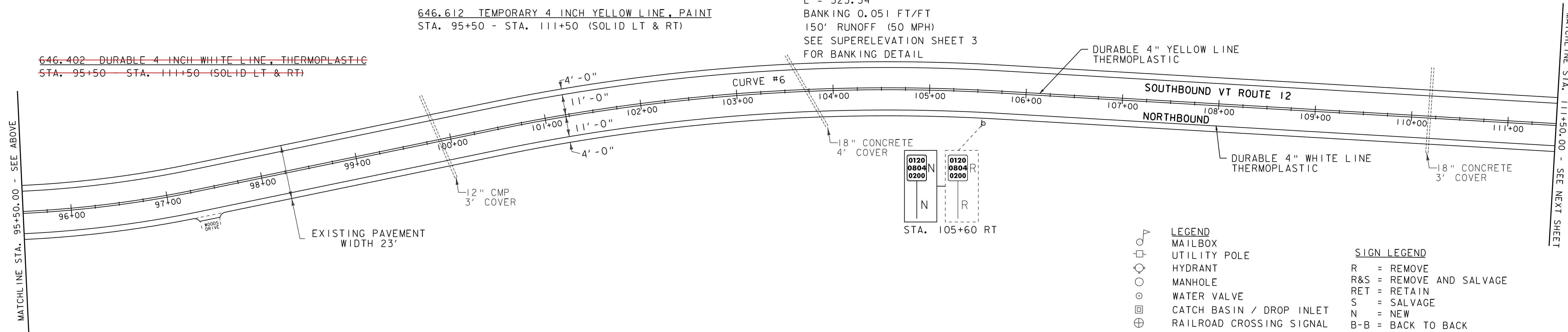

675.50 REMOVING SIGNS  
 AS SHOWN - 1

**PROJECT LAYOUT SHEET 10**

PROJECT NAME: WORCESTER-ELMORE  
 PROJECT NUMBER: STP 2209(I)S

FILE NAME: 99c170.dgn  
 PROJECT LEADER: CDL  
 DESIGNED BY: SJL  
 PLOT FILE: 99c170.25.1

PLOT DATE: 23-SEP-2011 5:25  
 DRAWN BY: SJL  
 CHECKED BY: EPD  
 SHEET 25 OF 36

NOT TO SCALE