

CURVE #1
 DELTA = 34°51'48"
 D = 3°00'56"
 R = 1900.00'
 T = 596.58'
 L = 1156.11'
 BANKING 0.053 FT/FT
 150' RUNOFF (50 MPH)
 SEE SUPERELEVATION SHEET 2
 FOR BANKING DETAIL

~~621.205 STEEL BEAM GUARDRAIL, GALV. W/8' POSTS~~
~~STA. 27+51.50 - STA. 28+00.00 RT~~
~~STA. 27+33.50 - STA. 27+96.00 LT~~

~~646.402 DURABLE 4 INCH WHITE LINE, THERMOPLASTIC~~
~~STA. 17+25 - STA. 32+75 (SOLID LT & RT)~~

~~646.412 DURABLE 4 INCH YELLOW LINE, THERMOPLASTIC~~
~~STA. 17+25 - STA. 32+75 (SOLID LT & RT)~~

~~621.60 ANCHOR FOR STEEL BEAM RAIL~~
~~STA. 26+36.50 LT~~

~~900.520 S.A. (STEEL BEAM GUARDRAIL/"RUB RAIL")~~
~~BRIDGE #1 (SOUTHEAST APPROACH)~~
~~BRIDGE #1 (NORTHEAST APPROACH)~~
~~BRIDGE #1 (NORTHWEST APPROACH)~~

~~646.602 TEMPORARY 4 INCH WHITE LINE, PAINT~~
~~STA. 17+25 - STA. 32+75 (SOLID LT & RT)~~

~~646.612 TEMPORARY 4 INCH YELLOW LINE, PAINT~~
~~STA. 17+25 - STA. 32+75 (SOLID LT & RT)~~

~~621.20 STEEL BEAM GUARDRAIL, GALVANIZED~~
~~64.00 STA. 24+79.50 - STA. 26+10.75 RT 26.50~~
~~22.00 STA. 26+23.75 - STA. 26+36.25 LT 33.50~~
~~26.50 STA. 27+10.75 - STA. 27+29.50 RT 51.50~~
~~STA. 27+36.25 - STA. 27+67.50 LT~~

~~621.50 MANUFACTURED TERMINAL SECTION, FLARED~~
~~27.00 STA. 24+42.00 - STA. 24+79.50 RT 64.00~~
~~28+00.00 STA. 27+29.50 - STA. 27+67.00 RT 28+37.50~~
~~96.00 STA. 27+67.50 - STA. 28+05.00 LT 33.50~~

~~621.80 REMOVAL AND DISPOSAL OF GUARDRAIL~~
~~22.00 STA. 26+23.75 - STA. 26+67.50 LT 65.00~~
~~02.50 STA. 27+05.00 - STA. 27+67.50 LT~~
~~42.00 STA. 24+79.50 - STA. 26+42.00 RT 57~~
~~STA. 26+79.50 - STA. 27+29.50 RT~~
~~94 67.00~~

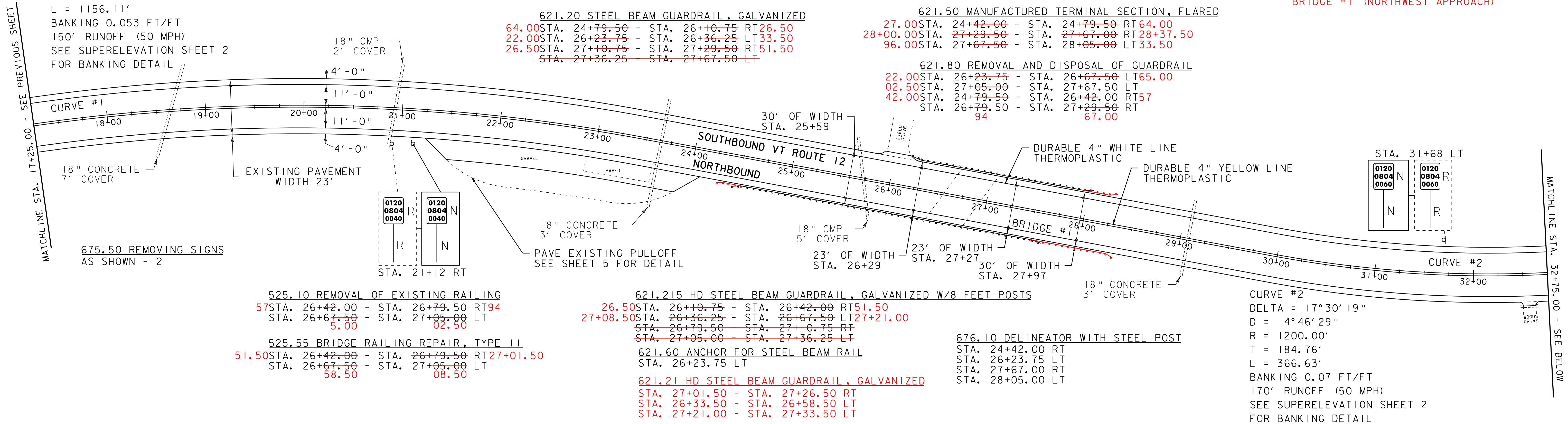

~~525.10 REMOVAL OF EXISTING RAILING~~
~~57 STA. 26+42.00 - STA. 26+79.50 RT 94~~
~~STA. 26+67.50 - STA. 27+05.00 LT~~
~~5.00 02.50~~

~~525.55 BRIDGE RAILING REPAIR, TYPE II~~
~~51.50 STA. 26+42.00 - STA. 26+79.50 RT 27+01.50~~
~~STA. 26+67.50 - STA. 27+05.00 LT~~
~~58.50 08.50~~

~~621.215 HD STEEL BEAM GUARDRAIL, GALVANIZED W/8 FEET POSTS~~
~~26.50 STA. 26+10.75 - STA. 26+42.00 RT 51.50~~
~~27+08.50 STA. 26+36.25 - STA. 26+67.50 LT 27+21.00~~
~~STA. 26+79.50 - STA. 27+10.75 RT~~
~~STA. 27+05.00 - STA. 27+36.25 LT~~

~~621.60 ANCHOR FOR STEEL BEAM RAIL~~
~~STA. 26+23.75 LT~~

~~621.21 HD STEEL BEAM GUARDRAIL, GALVANIZED~~
~~STA. 27+01.50 - STA. 27+26.50 RT~~
~~STA. 26+33.50 - STA. 26+58.50 LT~~
~~STA. 27+21.00 - STA. 27+33.50 LT~~

~~676.10 DELINEATOR WITH STEEL POST~~
~~STA. 24+42.00 RT~~
~~STA. 26+23.75 LT~~
~~STA. 27+67.00 RT~~
~~STA. 28+05.00 LT~~

CURVE #2
 DELTA = 17°30'19"
 D = 4°46'29"
 R = 1200.00'
 T = 184.76'
 L = 366.63'
 BANKING 0.07 FT/FT
 170' RUNOFF (50 MPH)
 SEE SUPERELEVATION SHEET 2
 FOR BANKING DETAIL

~~646.402 DURABLE 4 INCH WHITE LINE, THERMOPLASTIC~~
~~STA. 32+75 - STA. 48+25 (SOLID LT & RT)~~

~~646.602 TEMPORARY 4 INCH WHITE LINE, PAINT~~
~~STA. 32+75 - STA. 48+25 (SOLID LT & RT)~~

CURVE #3
 DELTA = 53°01'52"
 D = 3°28'21"
 R = 1650.00'
 T = 823.22'
 L = 1527.19'
 BANKING 0.058 FT/FT
 150' RUNOFF (50 MPH)
 SEE SUPERELEVATION SHEET 2
 FOR BANKING DETAIL

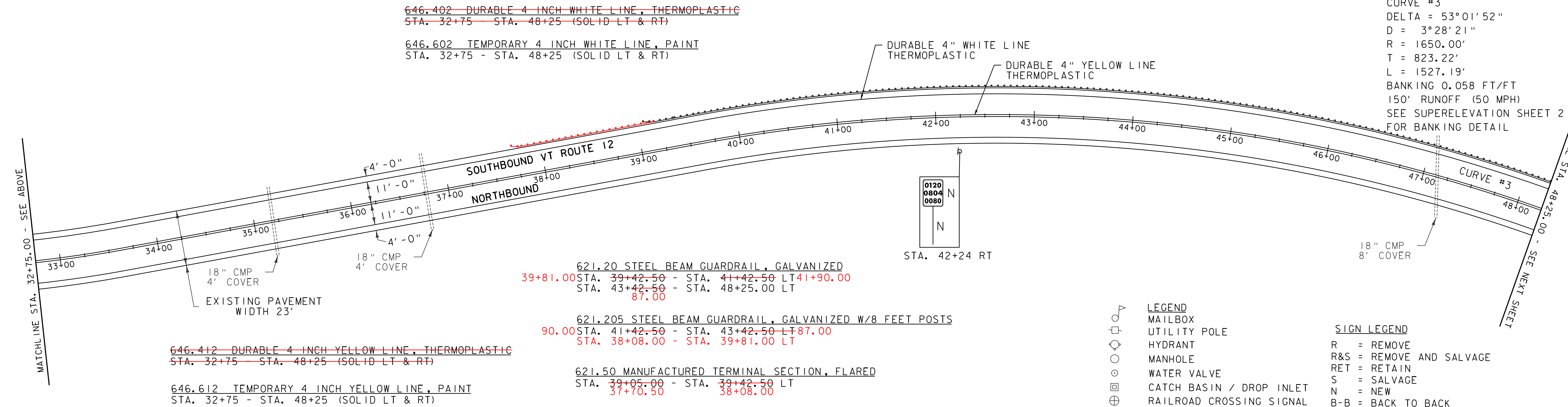

~~646.412 DURABLE 4 INCH YELLOW LINE, THERMOPLASTIC~~
~~STA. 32+75 - STA. 48+25 (SOLID LT & RT)~~

~~646.612 TEMPORARY 4 INCH YELLOW LINE, PAINT~~
~~STA. 32+75 - STA. 48+25 (SOLID LT & RT)~~

~~621.20 STEEL BEAM GUARDRAIL, GALVANIZED~~
~~39+81.00 STA. 39+42.50 - STA. 41+42.50 LT 41+90.00~~
~~STA. 43+42.50 - STA. 48+25.00 LT~~
~~87.00~~

~~621.205 STEEL BEAM GUARDRAIL, GALVANIZED W/8 FEET POSTS~~
~~90.00 STA. 41+42.50 - STA. 43+42.50 LT 87.00~~
~~STA. 38+08.00 - STA. 39+81.00 LT~~

~~621.50 MANUFACTURED TERMINAL SECTION, FLARED~~
~~STA. 39+05.00 - STA. 39+42.50 LT~~
~~37+70.50 38+08.00~~

~~621.80 REMOVAL AND DISPOSAL OF GUARDRAIL~~
~~STA. 39+30.00 - STA. 48+25.00 LT~~

~~676.10 DELINEATOR WITH STEEL POST~~
~~STA. 39+05.00 LT~~

- | | | |
|---|--------------------------|--|
| ○ | LEGEND | |
| □ | MAILBOX | |
| ○ | UTILITY POLE | |
| ○ | HYDRANT | |
| ○ | MANHOLE | |
| ○ | WATER VALVE | |
| □ | CATCH BASIN / DROP INLET | |
| ⊕ | RAILROAD CROSSING SIGNAL | |
| | SIGN LEGEND | |
| | R = REMOVE | |
| | R&S = REMOVE AND SALVAGE | |
| | RET = RETAIN | |
| | S = SALVAGE | |
| | N = NEW | |
| | B-B = BACK TO BACK | |

**PROJECT
 LAYOUT
 SHEET 8**

PROJECT NAME: WORCESTER-ELMORE
 PROJECT NUMBER: STP 2209(I)S

FILE NAME: 99cl70.dgn
 PROJECT LEADER: CDL
 DESIGNED BY: SJL
 PLOT FILE: 99cl70_23.1

PLOT DATE: 23-SEP-2011 5:24
 DRAWN BY: SJL
 CHECKED BY: EPD
 SHEET 23 OF 36

NOT TO SCALE