

~~646.402 DURABLE 4 INCH WHITE LINE, THERMOPLASTIC~~  
~~STA. 242+25 - STA. 258+25 (SOLID LT & RT)~~

~~646.602 TEMPORARY 4 INCH WHITE LINE, PAINT~~  
~~STA. 242+25 - STA. 258+25 (SOLID LT & RT)~~

675.50 REMOVING SIGNS  
AS SHOWN - 1  
675.60 ERECTING SALVAGED SIGNS  
AS SHOWN - 1

CURVE #4  
DELTA = 62°12'35"  
D = 8°11'06"  
R = 700.00'  
T = 422.35'  
L = 760.03'  
BANKING 0.08 FT/FT  
190' RUNOFF (50 MPH)  
SEE SUPERELEVATION SHEET 1  
FOR BANKING DETAIL

~~646.412 DURABLE 4 INCH YELLOW LINE, THERMOPLASTIC~~  
~~STA. 242+25 - STA. 258+25 (SOLID LT & RT)~~

646.612 TEMPORARY 4 INCH YELLOW LINE, PAINT  
STA. 242+25 - STA. 258+25 (SOLID LT & RT)

~~621.20 STEEL BEAM GUARDRAIL, GALVANIZED~~  
~~82.00 STA. 246+72.00 - STA. 250+09.50 LT~~  
~~15.5 STA. 258+08.00 - STA. 258+25.00 LT~~

~~621.50 MANUFACTURED TERMINAL SECTION, FLARED~~  
~~STA. 246+34.50 - STA. 246+72.00 LT~~  
~~32.00 STA. 250+09.50 - STA. 250+47.00 LT~~ 69.5

~~621.51 MANUFACTURED TERMINAL SECTION, TANGENT~~  
~~65.5 STA. 257+70.50 - STA. 258+08.00 LT~~ 15.5  
~~STA. 246+07.00 - STA. 246+57.00 LT~~  
~~621.80 REMOVAL AND DISPOSAL OF GUARDRAIL~~  
~~STA. 246+34.50 - STA. 250+47.00 LT~~  
~~STA. 257+70.50 - STA. 258+25.00 RT~~ 258+25  
66.00

676.10 DELINEATOR WITH STEEL POST  
STA. 246+34.50 LT  
STA. 250+47.00 LT  
STA. 257+70.50 LT

STA. 254+07 LT

STA. 253+44 LT

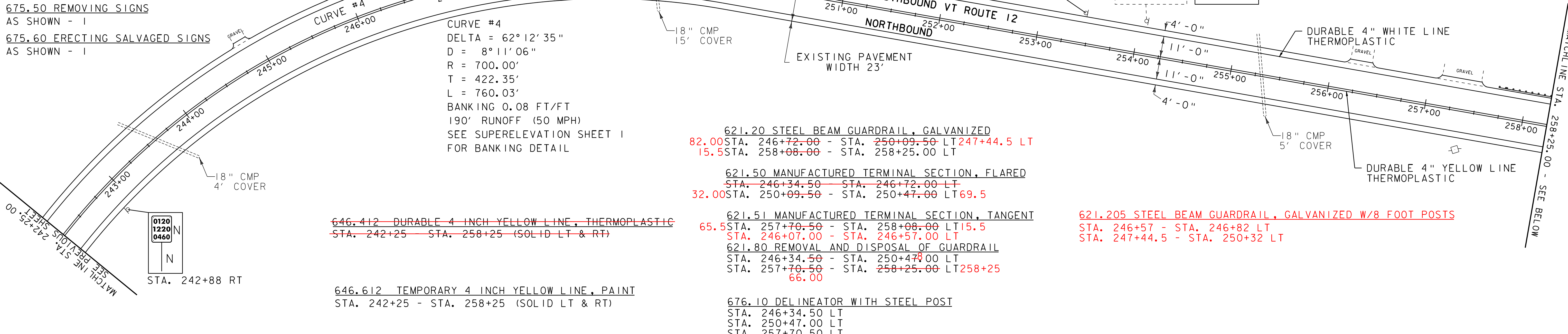
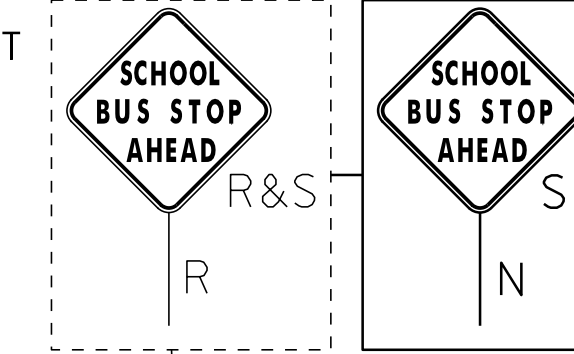

~~601.0010 15" CSP .064 (2-2/3 X 1/2)~~  
~~STA. 266+28 - STA. 266+58 RT~~

~~646.402 DURABLE 4 INCH WHITE LINE, THERMOPLASTIC~~  
~~STA. 258+25 - STA. 274+25 (SOLID LT & RT)~~

646.602 TEMPORARY 4 INCH WHITE LINE, PAINT  
STA. 258+25 - STA. 274+25 (SOLID LT & RT)

~~646.412 DURABLE 4 INCH YELLOW LINE, THERMOPLASTIC~~  
~~STA. 258+25 - STA. 274+25 (SOLID LT & RT)~~

CURVE #5  
DELTA = 8°34'48"  
D = 2°51'53"  
R = 2000.00'  
T = 150.03'  
L = 299.50'  
BANKING 0.051 FT/FT  
150' RUNOFF (50 MPH)  
SEE SUPERELEVATION SHEET 1  
FOR BANKING DETAIL

STA. 263+32 LT

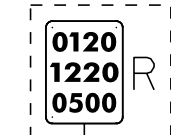

646.612 TEMPORARY 4 INCH YELLOW LINE, PAINT  
STA. 258+25 - STA. 274+25 (SOLID LT & RT)  
621.20 STEEL BEAM GUARDRAIL, GALVANIZED  
STA. 258+25.00 - STA. 259+33.00 LT 03.00  
STA. 266+62.50 - STA. 267+87.50 RT

621.50 MANUFACTURED TERMINAL SECTION, FLARED  
261+03 STA. 259+33.00 - STA. 259+70.50 LT 261+40.5  
264+70 STA. 265+18.00 - STA. 265+55.50 LT 07.50  
265+92 STA. 266+25.00 - STA. 266+62.50 RT 29.5  
92.00 STA. 267+87.50 - STA. 268+25.00 RT 29.5  
70.00 STA. 268+18.00 - STA. 268+55.50 LT 269+07.5

621.80 REMOVAL AND DISPOSAL OF GUARDRAIL  
STA. 258+25.00 - STA. 259+40.00 LT 37.2  
STA. 265+80.00 - STA. 267+05.00 LT  
64.00 11.00

621.205 STEEL BEAM GUARDRAIL, GALVANIZED W/8 FEET POSTS  
07.50 STA. 265+55.50 - STA. 268+18.00 LT 70.00  
STA. 259+03.00 - STA. 261+03.00 LT  
STA. 266+29.50 - STA. 267+92.00 RT

676.10 DELINEATOR WITH STEEL POST  
STA. 259+70.50 LT  
STA. 265+18.00 LT  
STA. 268+55.50 LT

675.50 REMOVING SIGNS  
AS SHOWN - 2

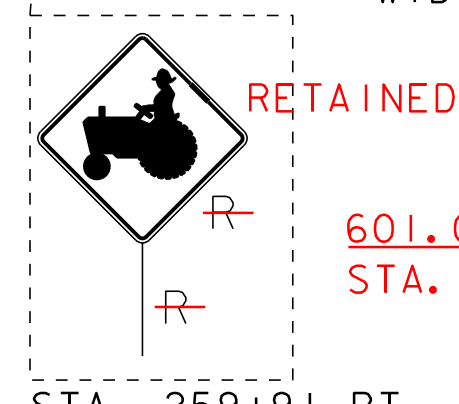
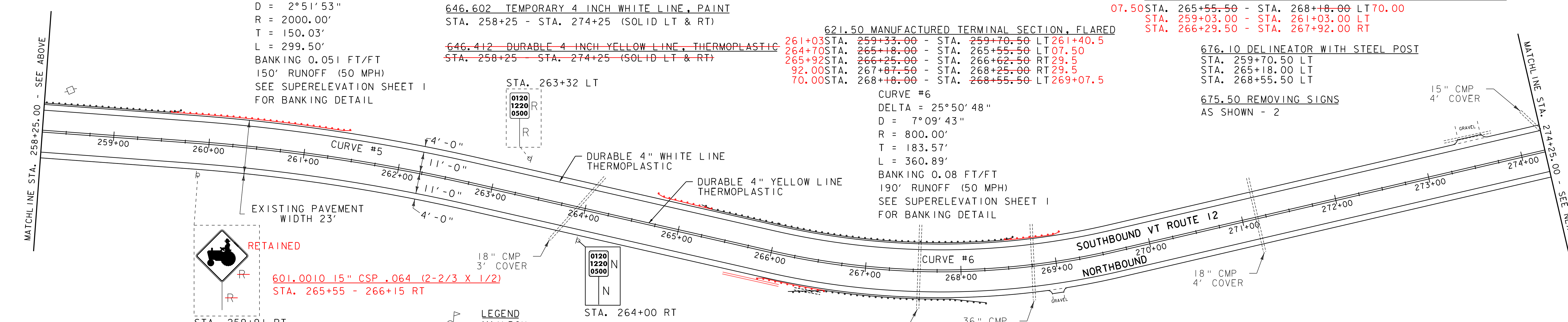

601.0010 15" CSP .064 (2-2/3 X 1/2)  
STA. 265+55 - 266+15 RT

- LEGEND
- MAILBOX
  - UTILITY POLE
  - HYDRANT
  - MANHOLE
  - WATER VALVE
  - CATCH BASIN / DROP INLET
  - RAILROAD CROSSING SIGNAL

- SIGN LEGEND
- R = REMOVE
  - R&S = REMOVE AND SALVAGE
  - RET = RETAIN
  - S = SALVAGE
  - N = NEW
  - B-B = BACK TO BACK

24" CONCRETE 10' COVER  
36" CMP 4' COVER

NOT TO SCALE

PROJECT LAYOUT SHEET 2

PROJECT NAME: WORCESTER-ELMORE  
PROJECT NUMBER: STP 2209(I)S

FILE NAME: 99cl70.dgn  
PROJECT LEADER: CDL  
DESIGNED BY: SJL  
PLOT FILE: 99cl70\_17.1

PLOT DATE: 23-SEP-2011 5:24  
DRAWN BY: SJL  
CHECKED BY: EPD  
SHEET 17 OF 36