

HIGHWAY NAME	RWA	ERW	RW500	RWN	OTHER
BEGIN PROJECT	2	2	2	1	1 VARIABLE MESSAGE BOARD
HAVEN HILL ROAD (T-8)	1	1			
NORTH END DRIVE (T-7)	1	1			
CLARENDON ROAD	1	1			
VT. ROUTE 7B	2	1	2		
BUMP ROAD (T-26)	2	2			
VT. ROUTE 7B	2	1	2		
MIDDLE ROAD	1	1			
VT. ROUTE 103	2	1	2		1 VARIABLE MESSAGE BOARD
CROSSROAD ROAD (T-19)	1	1			
VT. ROUTE 7B	4	2	4		
NORTH SHREWSBURY ROAD	2	2			
VT. ROUTE 7B	2	1	2		
WIND CREST ROAD (T-35)	1	1			
MIDDLE ROAD	1	1			
U.S. ROUTE 4	2	1	2		1 VARIABLE MESSAGE BOARD
SEWARD ROAD (T-36)	1	1			
RANDBURY ROAD (T-67)	1	1			
END PROJECT	2	2	2	1	1 VARIABLE MESSAGE BOARD
TOTAL	31	24	18	2	4

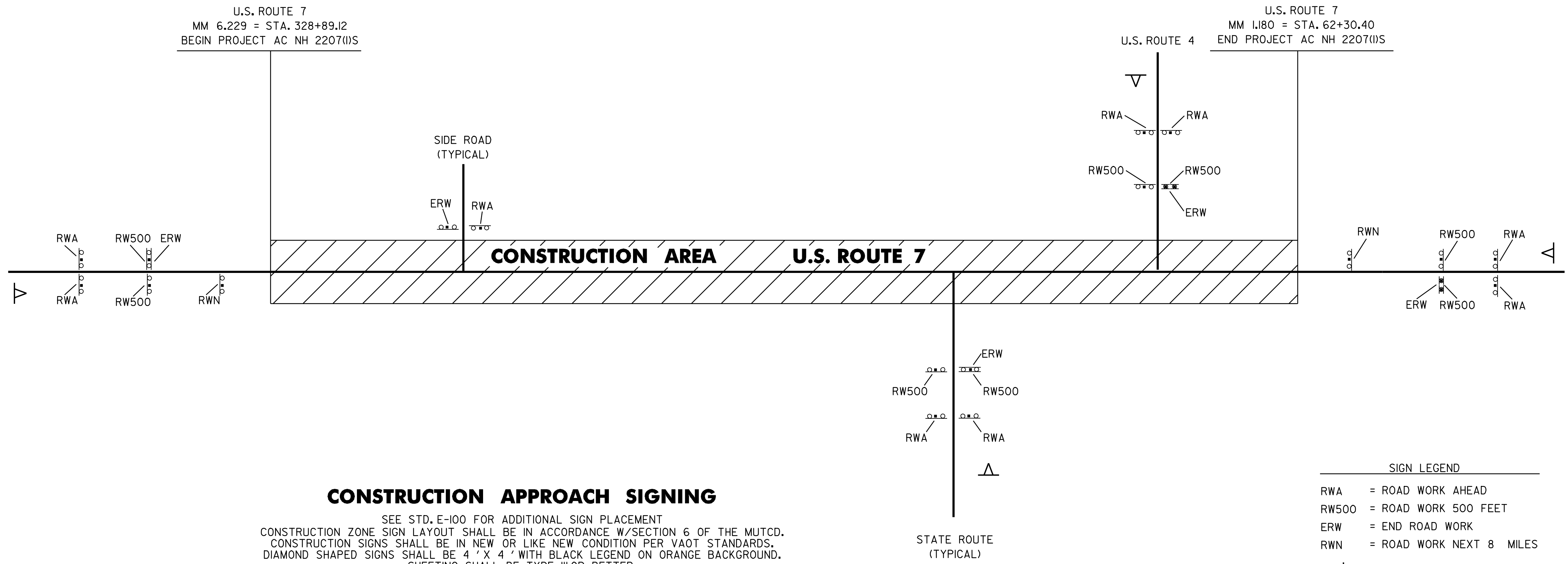

THINNING AND TRIMMING DETAIL

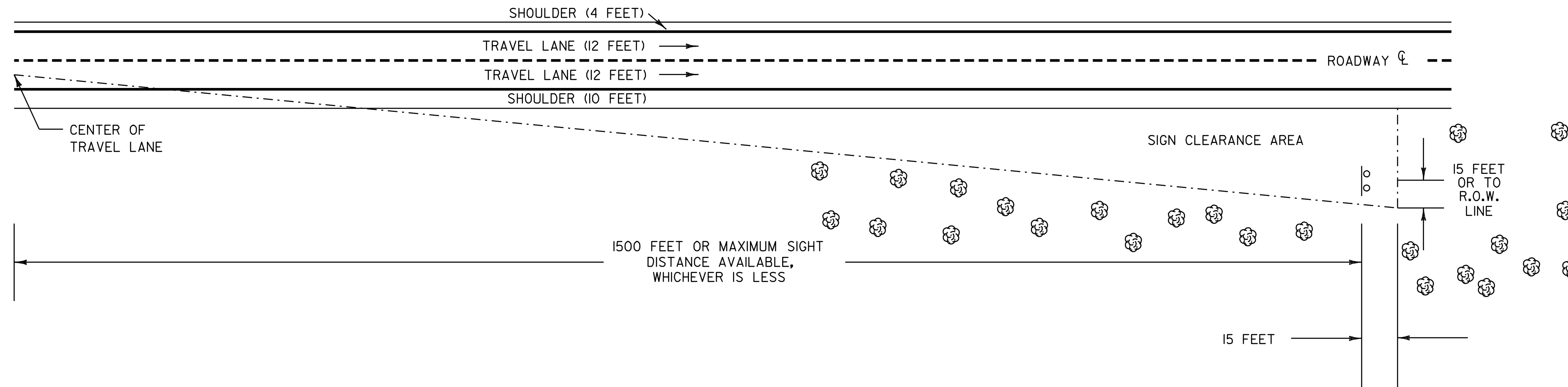

THE CONTRACTOR SHALL REMOVE ALL WOODY STEMMED GROWTH INCLUDING BRUSH, SAPLINGS AND TREE LIMBS GROWING WITHIN OR PROJECTING INTO THE CLEARANCE AREA DOWN TO GROUND LEVEL OR AT LEAST 10 FEET BELOW THE BOTTOM OF THE SIGN, WHICHEVER IS LESS. PAYMENT WILL BE FOR THINNING AND TRIMMING OF SIGNS, ITEM 201.31, AND PAID FOR PER EACH SIGN. NO CHEMICALS (POISONS OR DEFOLIANTS) WILL BE ALLOWED.

SIGN LOCATIONS:
 CLARENDON:
 STA. 149+50.0, RT

**MISCELLANEOUS
 DETAIL
 SHEET #2**

PROJECT NAME: WALLINGFORD - RUTLAND TOWN
 PROJECT NUMBER: AC NH 2207(1)S

FILE NAME: p99bl66.dgn
 PROJECT LEADER: D.E.G.
 DESIGNED BY: D.W.E.

PLOT DATE: 12-MAR-2007 11:35
 DRAWN BY: C.A.K.
 CHECKED BY: D.E.G.
 SHEET 95 OF 95