

646.414 DURABLE 6" WHITE LINE (MOD.) (RETROREFLECTIVITY/INLAID)

(ALL LINES WILL INCLUDE EDGE LINE BREAKS AND RADIUS FOR TOWN HIGHWAYS)

WALLINGFORD:
STA. 371+00.00 - STA. 375+61.92 DASHED LINE C/L
STA. 371+00.00 - STA. 375+61.92 EDGE LINE RT

CLARENDON:
STA. 0+00.00 - STA. 11+00.00 DASHED LINE C/L
STA. 0+00.00 - STA. 11+00.00 EDGE LINE RT

646.415 DURABLE 6" YELLOW LINE (MOD.) (RETROREFLECTIVITY/INLAID)

(ALL LINES WILL INCLUDE C/L BREAKS FOR TOWN HIGHWAYS) S=SOLID, D=DASHED

WALLINGFORD:
STA. 371+00.00 - STA. 375+61.92 EDGE LINE LT

CLARENDON:
STA. 0+00.00 - STA. 11+00.00 EDGE LINE LT

646.614 TEMPORARY 6" WHITE LINE (PAINT)

(ALL LINES WILL INCLUDE EDGE LINE BREAKS AND RADIUS FOR TOWN HIGHWAYS)

WALLINGFORD:
STA. 371+00.00 - STA. 375+61.92 DASHED LINE C/L
STA. 371+00.00 - STA. 375+61.92 EDGE LINE RT

CLARENDON:
STA. 0+00.00 - STA. 11+00.00 DASHED LINE C/L
STA. 0+00.00 - STA. 11+00.00 EDGE LINE RT

646.615 TEMPORARY 6" YELLOW LINE (PAINT)

(ALL LINES WILL INCLUDE C/L BREAKS FOR TOWN HIGHWAYS) S=SOLID, D=DASHED

WALLINGFORD:
STA. 371+00.00 - STA. 375+61.92 EDGE LINE LT

CLARENDON:
STA. 0+00.00 - STA. 11+00.00 EDGE LINE LT

675.50 REMOVING SIGNS

AS SHOWN - 2

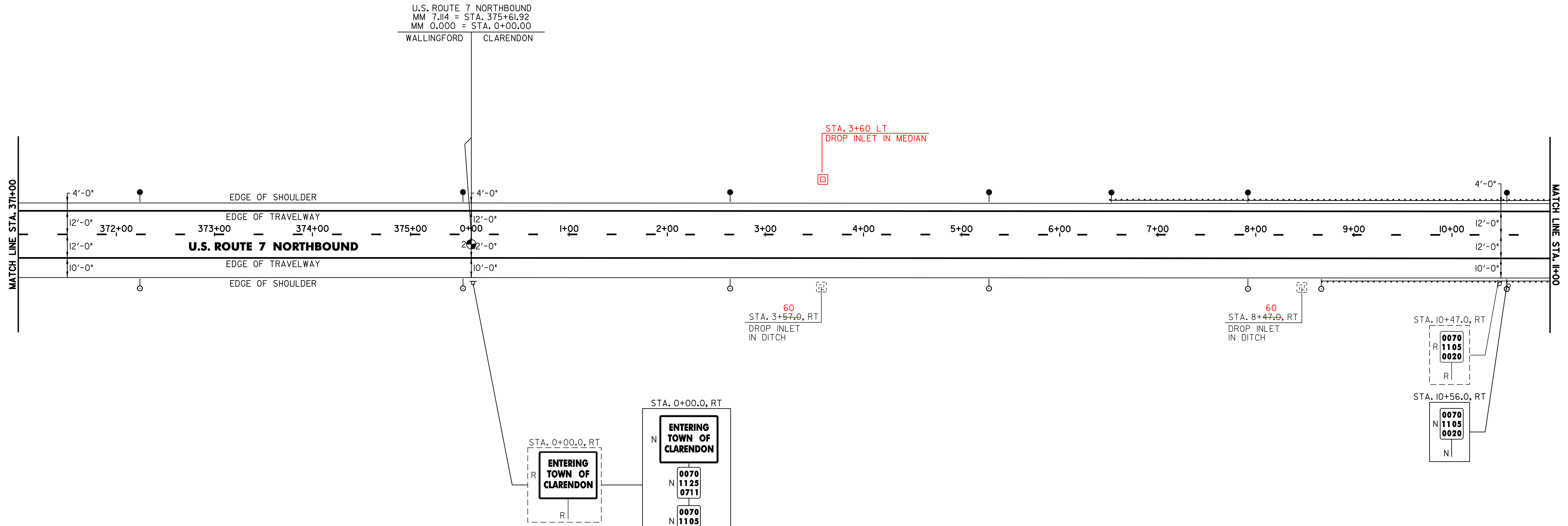

SEE SHEET 13 OF 96 FOR STATIONING PROBLEM.
TP 10-28-05

PAVEMENT CORES =

#	TOTAL DEPTH (INCH)	PCC	COMMENTS
2	1.625	NO	

213.10 MILLED RUMBLE STRIPS

WALLINGFORD:
STA. 371+00.0 - STA. 375+61.92 LT (461.92 FT)
STA. 371+00.0 - STA. 375+61.92 RT (461.92 FT)

CLARENDON:
STA. 0+00.0 - STA. 6+63.0 LT (663 FT)
STA. 0+00.0 - STA. 11+00.0 RT (1100 FT)

604.412 REHABING DI, CB OR MH, CLASS I

CLARENDON:
STA. 3+57.0 RT
STA. 8+47.0 RT
STA. 3+60 LT

621.20 STEEL BEAM GUARDRAIL (GALVANIZED)

CLARENDON:
STA. 6+90.3 - STA. 11+00.0 LT (409.7 FT)
STA. 9+04.3 - STA. 11+00.0 RT (195.7 FT)

621.505 MANUFACTURED TERMINAL SECTION (FLARED)

CLARENDON:
STA. 6+52.8 - STA. 6+90.3 LT
STA. 8+66.8 - STA. 9+04.3 RT
8+62 - STA. 9+00

621.80 REMOVAL AND DISPOSAL OF GUARDRAIL

CLARENDON:
STA. 6+54.0 - STA. 11+00.0 LT (446 FT)
STA. 10+47.0 - STA. 11+00.0 RT (53 FT)

676.10 DELINEATORS WITH STEEL POSTS

WALLINGFORD:
STA. 372+24.0 RT STA. 372+24.0 LT

CLARENDON:
STA. 0+00.0 RT STA. 0+00.0 LT
STA. 2+64.0 RT STA. 2+64.0 LT
STA. 5+28.0 RT STA. 5+28.0 LT
STA. 7+92.0 RT STA. 6+52.8 LT
STA. 8+66.8 RT STA. 7+92.0 LT
STA. 10+56.0 RT STA. 10+56.0 LT

SIGN LEGEND

R= REMOVE
S= SALVAGE
N= NEW
RET= RETAIN
B-B= BACK TO BACK
EXISTING= -----
NEW= -----

PROJECT LAYOUT SHEET #4

PROJECT NAME: WALLINGFORD - RUTLAND TOWN
PROJECT NUMBER: AC NH 2207(1)S

FILE NAME: p99bl66.dgn PLOT DATE: 12-MAR-2007 11:28
PROJECT LEADER: D.E.G. DRAWN BY: C.A.K.
DESIGNED BY: D.W.E. CHECKED BY: D.E.G.
SHEET 16 OF 95