

646.40 DURABLE 4" WHITE LINE (MOD.) (RETROREFLECTIVITY/INLAID)
 (ALL LINES WILL INCLUDE EDGE LINE BREAKS AND RADIUS FOR TOWN HIGHWAYS)
 WALLINGFORD:
 STA. 339+00.00 - STA. 344+16.00 LT & RT

646.41 DURABLE 4" YELLOW LINE (MOD.) (RETROREFLECTIVITY/INLAID)
 (ALL LINES WILL INCLUDE C/L BREAKS FOR TOWN HIGHWAYS) S=SOLID, D=DASHED
 WALLINGFORD:
 STA. 339+00.00 - STA. 341+35.00 S - S
 STA. 341+35.00 - STA. 344+16.00 DOUBLE SOLID LT & RT

646.43 DURABLE 8" YELLOW LINE (MOD.) (RETROREFLECTIVITY/INLAID)
 WALLINGFORD:
 STA. 341+35.00 - STA. 344+16.00 HATCHED MEDIAN LT & RT (169.7 FT)

646.60 TEMPORARY 4" WHITE LINE (PAINT)
 (ALL LINES WILL INCLUDE EDGE LINE BREAKS AND RADIUS FOR TOWN HIGHWAYS)
 WALLINGFORD:
 STA. 339+00.00 - STA. 344+16.00 LT & RT

646.61 TEMPORARY 4" YELLOW LINE (PAINT)
 (ALL LINES WILL INCLUDE C/L BREAKS FOR TOWN HIGHWAYS) S=SOLID, D=DASHED
 WALLINGFORD:
 STA. 339+00.00 - STA. 341+35.00 S - S
 STA. 341+35.00 - STA. 344+16.00 DOUBLE SOLID LT & RT

646.414 DURABLE 6" WHITE LINE (MOD.) (RETROREFLECTIVITY/INLAID)
 (ALL LINES WILL INCLUDE EDGE LINE BREAKS AND RADIUS FOR TOWN HIGHWAYS)
 WALLINGFORD:
 STA. 344+16.00 - STA. 355+00.00 EDGE LINE RT
 STA. 350+97.00 - STA. 355+00.00 DASHED LINE C/L

646.415 DURABLE 6" YELLOW LINE (MOD.) (RETROREFLECTIVITY/INLAID)
 (ALL LINES WILL INCLUDE C/L BREAKS FOR TOWN HIGHWAYS) S=SOLID, D=DASHED
 WALLINGFORD:
 STA. 344+16.00 - STA. 355+00.00 EDGE LINE LT

646.614 TEMPORARY 6" WHITE LINE (PAINT)
 (ALL LINES WILL INCLUDE EDGE LINE BREAKS AND RADIUS FOR TOWN HIGHWAYS)
 WALLINGFORD:
 STA. 344+16.00 - STA. 355+00.00 EDGE LINE RT
 STA. 350+97.00 - STA. 355+00.00 DASHED LINE C/L

646.615 TEMPORARY 6" YELLOW LINE (PAINT)
 (ALL LINES WILL INCLUDE C/L BREAKS FOR TOWN HIGHWAYS) S=SOLID, D=DASHED
 WALLINGFORD:
 STA. 344+16.00 - STA. 355+00.00 EDGE LINE LT

675.50 REMOVING SIGNS
 AS SHOWN - 17

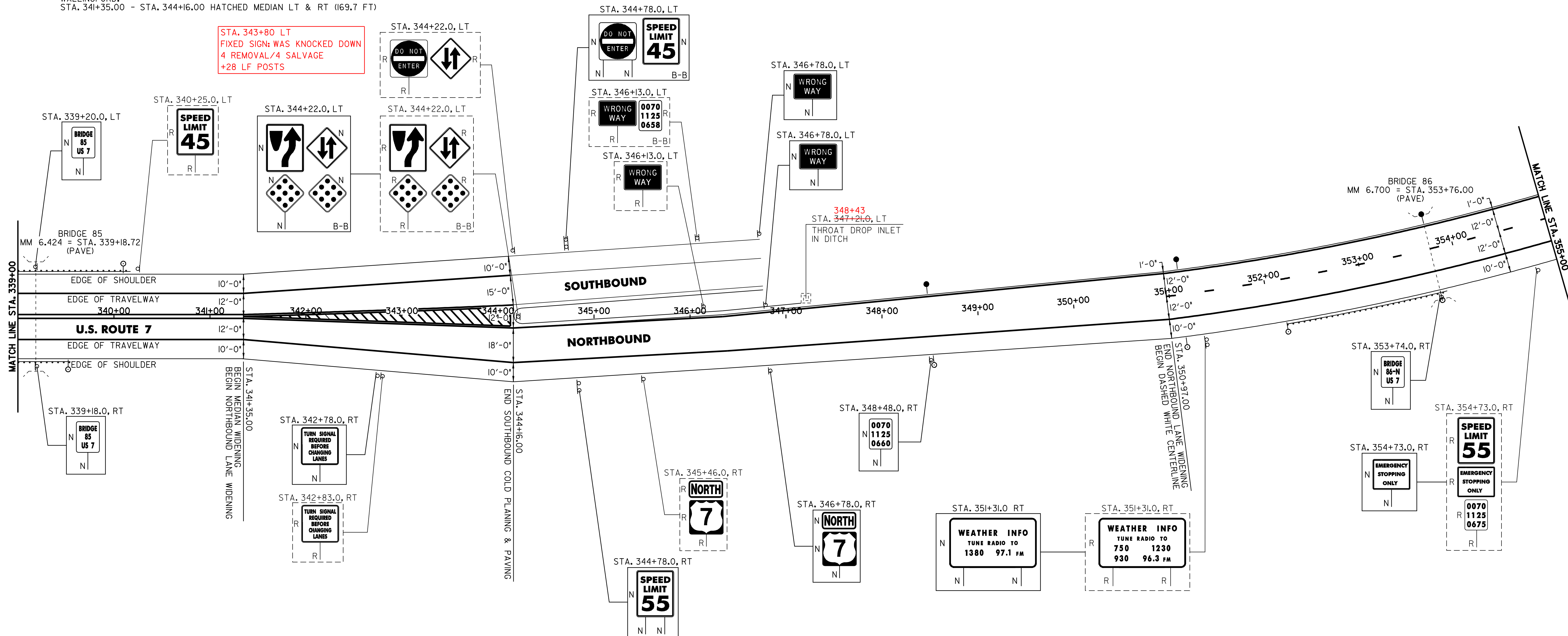

STA. 343+80 LT
 FIXED SIGN WAS KNOCKED DOWN
 4 REMOVAL/4 SALVAGE
 +28 LF POSTS

213.10 MILLED RUMBLE STRIPS
 WALLINGFORD:
 STA. 344+16 TO STA. 355+00 RT (1084 FT)

604.412 REHABING DI, CB OR MH, CLASS I
 WALLINGFORD:
 STA. 347+21.0 LT
 348+43

621.20 STEEL BEAM GUARDRAIL (GALVANIZED)
 WALLINGFORD:
 STA. 339+00.0 - STA. 339+14.8 RT (14.8 FT)
 STA. 339+00.0 - STA. 339+72.3 LT (72.3 FT)
 STA. 352+53.8 - STA. 353+66.3 RT (112.5 FT)
 353+62 - STA. 364+76

621.505 MANUFACTURED TERMINAL SECTION (FLARED)
 WALLINGFORD:
 STA. 339+14.8 - STA. 339+52.3 RT
 STA. 339+72.3 - STA. 340+09.8 LT
 STA. 352+53.8 - STA. 352+63.8 RT
 STA. 340+48 - STA. 340+86 RT
 STA. 341+15 - STA. 341+53 LT
 STA. 353+24 - STA. 353+62 RT

621.52 TRAILING END TERMINAL
 WALLINGFORD:
 STA. 353+66.3 - STA. 353+80.5
 354+76 - STA. 354+90 RT

621.80 REMOVAL AND DISPOSAL OF GUARDRAIL
 WALLINGFORD:
 STA. 339+00.0 - STA. 339+47.0 RT (47 FT)
 STA. 339+00.0 - STA. 340+08.0 LT (108 FT)
 STA. 352+20.0 - STA. 353+75.0 RT (155 FT)

676.10 DELINEATORS WITH STEEL POSTS
 TYPE I WHITE
 WALLINGFORD:
 STA. 339+52.3 RT
 STA. 340+09.8 RT
 STA. 348+48.0 RT
 STA. 351+12.0 RT
 STA. 352+16.3 RT
 STA. 353+76.0 RT

TYPE I AMBER
 WALLINGFORD:
 STA. 348+48.0 LT
 STA. 351+12.0 LT
 STA. 353+76.0 LT

201.31 THINNING AND TRIMMING
 STA. 351+31.0 RT

SIGN LEGEND
 R= REMOVE
 S= SALVAGE
 N= NEW
 RET= RETAIN
 B-B= BACK TO BACK
 EXISTING= -----
 NEW= _____

PROJECT LAYOUT SHEET #2

PROJECT NAME: WALLINGFORD - RUTLAND TOWN
 PROJECT NUMBER: AC NH 2207(1)S
 FILE NAME: p99bl66.dgn
 PROJECT LEADER: D.E.G.
 DESIGNED BY: D.W.E.
 PLOT DATE: 12-MAR-2007 11:28
 DRAWN BY: C.A.K.
 CHECKED BY: D.E.G.
 SHEET 14 OF 95

SEE SHEET 13 OF 96 FOR STATIONING PROBLEM.
 TP 10-28-05