

DESIGNED BY J. RIZZO
 CHECKED BY J. SHUKULET
 DRAFTED BY K. COLE
 IN CHARGE OF J. STEVENS

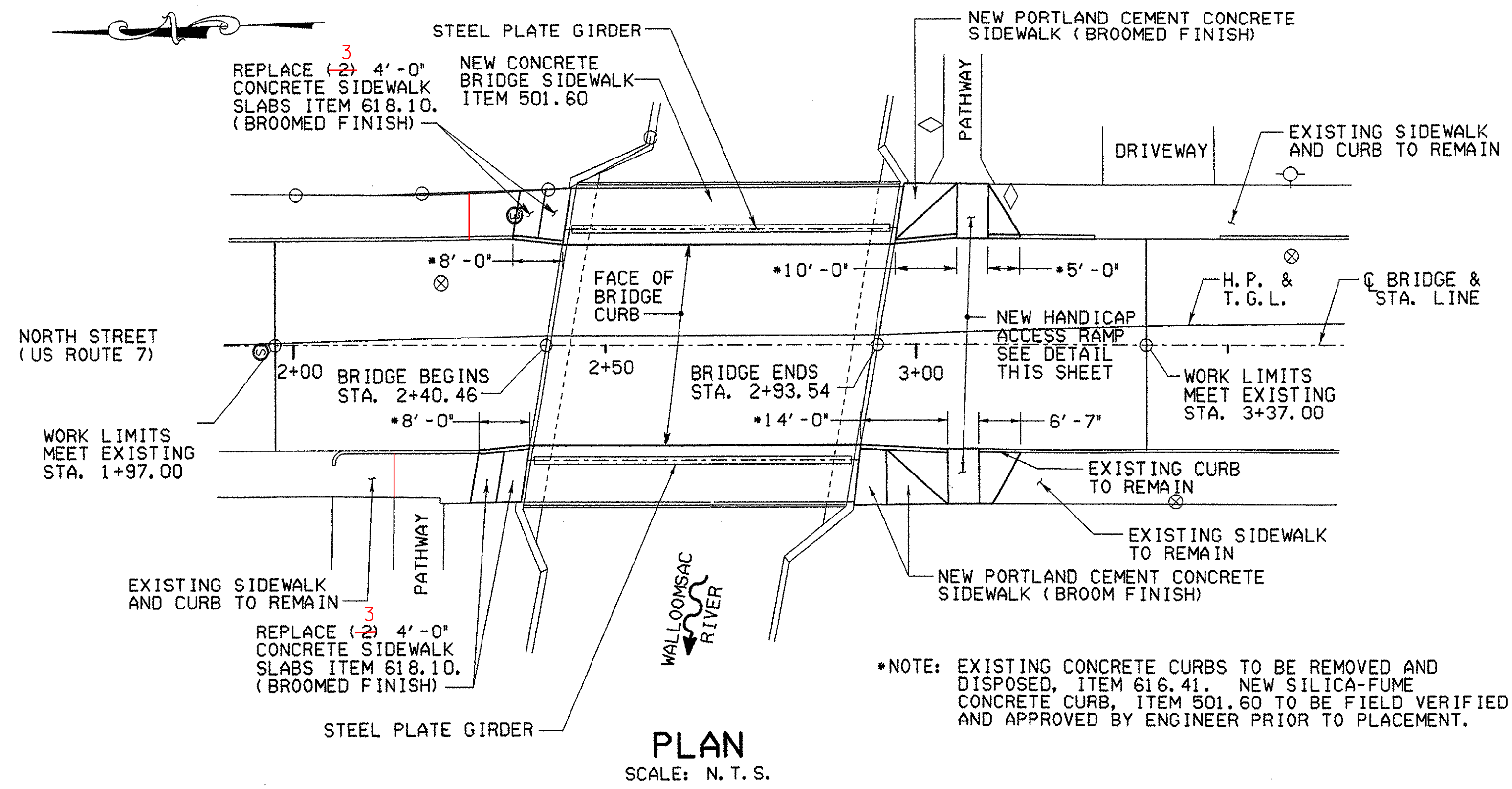

PLAN
SCALE: N. T. S.

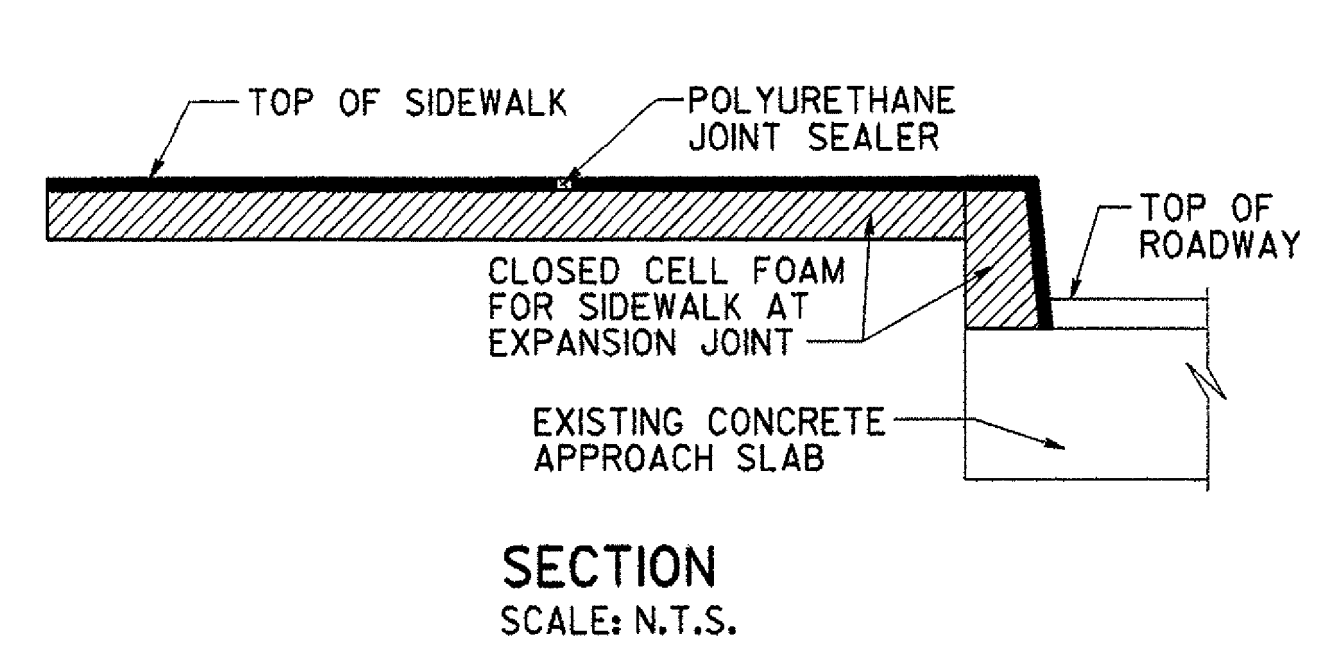

SECTION
SCALE: N.T.S.

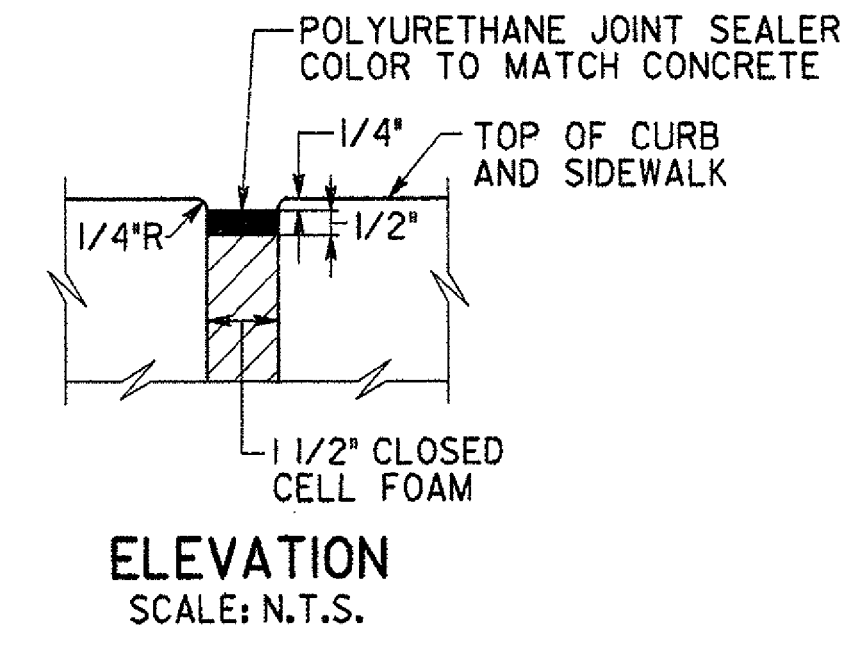

ELEVATION
SCALE: N.T.S.

SIDEWALK EXPANSION JOINT DETAILS

NOTES:

1. APPROACH SIDEWALKS WILL BE OF PORTLAND CEMENT CONCRETE, ITEM 618.10. ALL APPROACH CURBS WILL BE SILICA-FUME CONCRETE ITEM 501.60 WITH THE REINFORCEMENT FROM THE EXISTING CURBS BEING RETAINED.
2. THE APPROACH SIDEWALKS AND CURBS SHALL BE REPLACED ENTIRELY BETWEEN THE BRICK PATHWAY ENTRANCES AND THE BRIDGE SIDEWALKS. THE SIDEWALK SLABS SHALL MATCH THE EXISTING GEOMETRIC CONFINES.
3. APPROXIMATELY 8'-0", (2) 4'-0" SIDEWALK PANELS, SHALL BE REPLACED WITH CURBS ADJACENT TO THE NORTH END OF THE BRIDGE AT THE EAST AND WEST SIDEWALKS.
4. THE CONTRACTOR SHALL FIELD VERIFY ALL DIMENSIONS PRIOR TO REMOVAL OF EXISTING SIDEWALK SLABS. LIMITS OF APPROACH SIDEWALK SLAB REMOVAL SHALL BE APPROVED BY THE ENGINEER.
5. THE COSTS FOR ALL CLOSED CELL FOAM EXPANSION JOINT MATERIAL AND ASSOCIATED POLYURETHANE JOINT SEALER SHALL BE INCLUDED UNDER THE UNIT PRICE BID FOR ITEM 516.10, BRIDGE EXPANSION JOINT.
6. THE APPROACH SIDEWALKS SHALL INCREASE IN THICKNESS TO A MIN. OF 5/4" AT THE BACKWALLS OF THE ABUTMENTS SO AS TO MATCH THE BRIDGE SIDEWALKS AND BEAR ON THE BACKWALLS.
7. SIDEWALKS SHALL RECEIVE A BROOM FINISHED SURFACE IN ACCORDANCE WITH S.S.618.03(d).
8. ATTENTION IS BROUGHT TO THE CONTRACTOR THAT THERE SHALL BE NEW OBJECT MARKER SIGNS INSTALLED AT 2 CORNERS OF THE BRIDGE. SEE SIGNING AND PAVEMENT MARKING DWG. SP-1.
9. THE REINFORCING OF EXISTING APPROACH SLAB CURBS SCHEDULED TO BE REPLACED SHALL BE REMOVED AND DISPOSED OF TO A DEPTH OF 2" (MIN.) BELOW THE TOP SURFACE OF THE APPROACH SLABS AND FILLED WITH AN APPROVED NON-SHRINK GROUT. COSTS TO PERFORM THIS WORK SHALL BE SUBSIDIARY TO ITEM 616.41, LIMITS OF CURB AND REINFORCEMENT REMOVAL SHALL BE APPROVED PRIOR TO COMMENCEMENT OF WORK.
10. MINOR AMOUNTS OF GRAVEL SUBBASE AND REGRADING OF EXISTING SIDEWALK SUBBASE WILL BE REQUIRED PRIOR TO PLACEMENT OF THE NEW APPROACH SIDEWALKS. COSTS FOR MATERIAL, LABOR AND TOOLS NECESSARY TO COMPLETE THIS WORK SHALL BE SUBSIDIARY TO ITEM 618.10.
11. FOR BAR LIST, REINFORCEMENT NOTES AND BAR BENDING DETAILS SEE DRAWING SW-1.
12. FOR PROPOSED STRIPING AND CROSSWALK MARKINGS SEE DWG. SP-1.
13. FOR DETAIL 'A' SEE DWG. SW-2.
14. FOR LEGEND SEE DWG. PE-1.

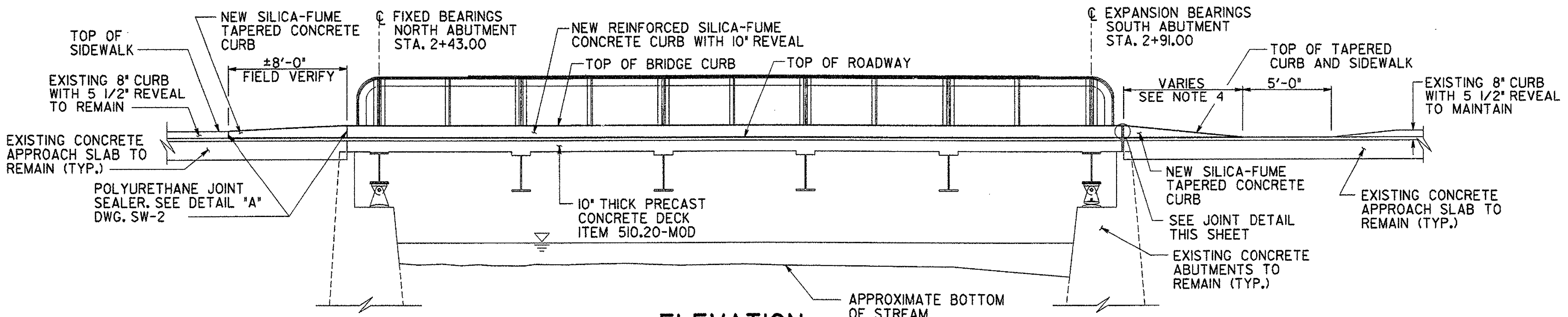

ELEVATION
SCALE: 1" = 5'

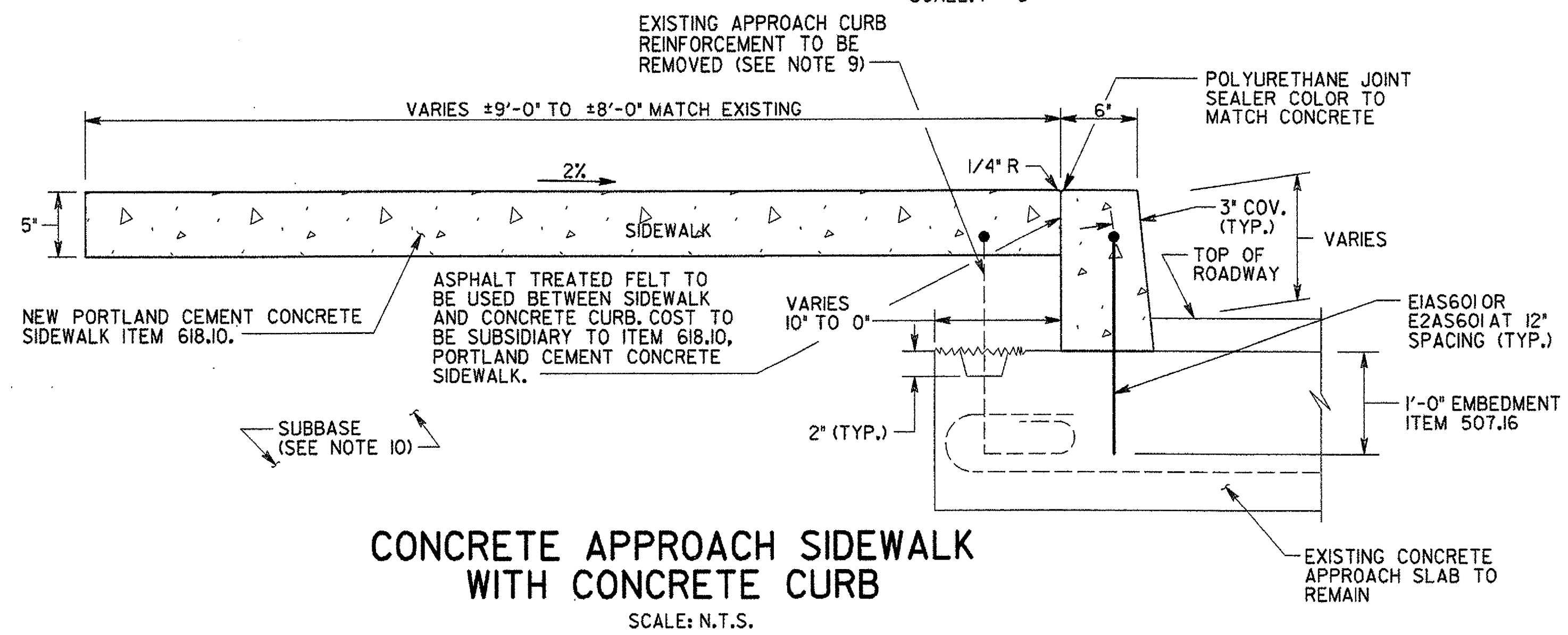

CONCRETE APPROACH SIDEWALK WITH CONCRETE CURB
SCALE: N.T.S.

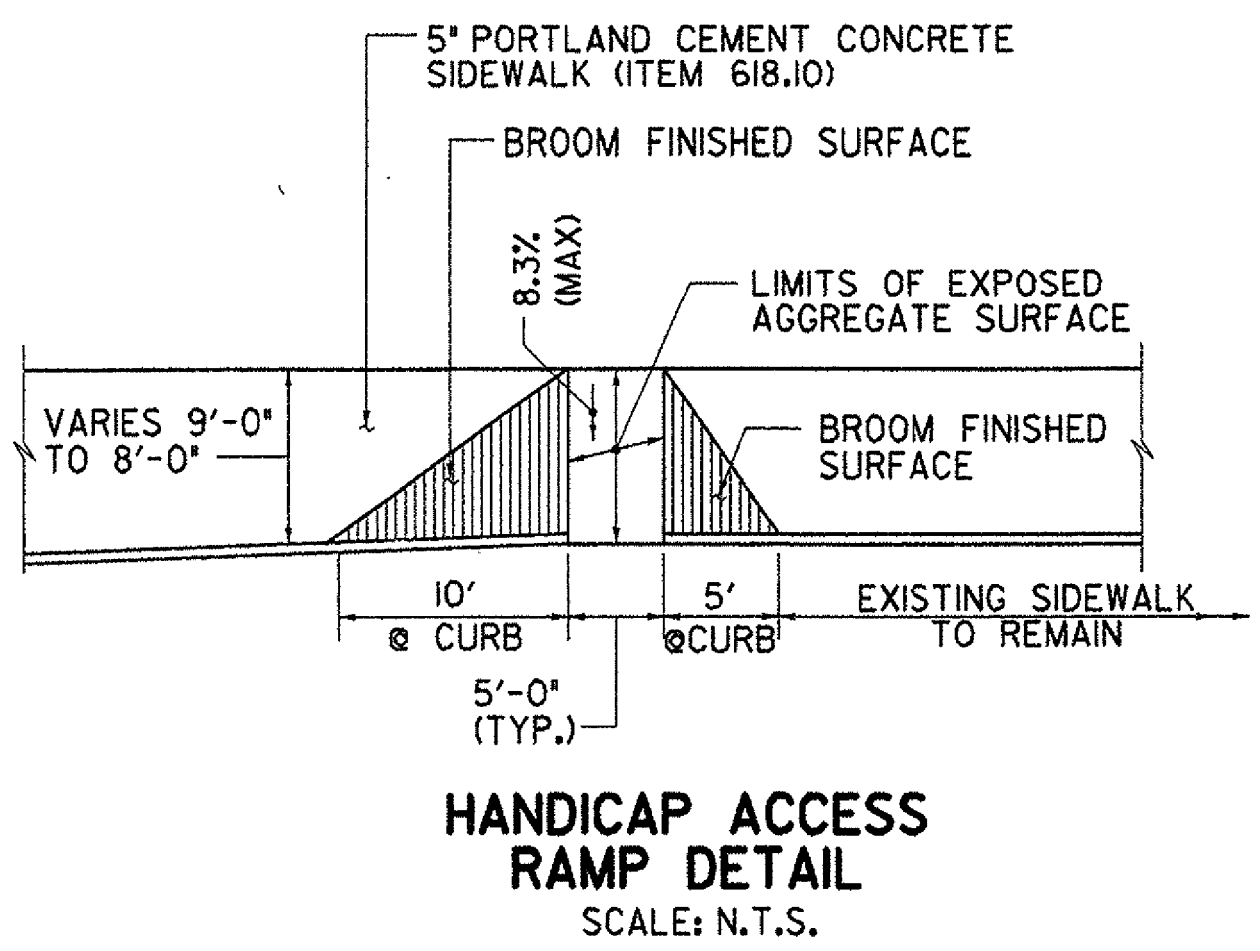

HANDICAP ACCESS RAMP DETAIL
SCALE: N.T.S.

PROJECT NO. THI-9914		BHF 1000 (17)S	
Greenman-Pedersen CONSULTING ENGINEERS GPI 55 Monument Ave. Bennington, VT. 05201		BENNINGTON BRIDGE #10 (U.S. ROUTE 7) OVER THE WALLOOMSAC RIVER	
		SIDEWALK DETAILS 3	
DRAWING NO. SW-3	SCALE: AS SHOWN	DATE: DEC ., 1999	SHEET NO. 14 OF 20