

646.40 DURABLE 100 mm WHITE LINE
 BARRE CITY:
 STA. 3+540.0 - STA. 3+546.0 LT, EDGE LINE
 STA. 3+540.0 - STA. 3+546.0 LT, HATCHED SHOULDER (3.0 m)
 STA. 3+540.0 - STA. 3+542.0 RT, EDGE LINE

646.41 DURABLE 100 mm YELLOW LINE
 (ALL LINES WILL INCLUDE C/L BREAKS FOR TOWN HIGHWAYS) S=SOLID, D=DASHED
 BARRE CITY:
 STA. 3+589.0 - STA. 3+680.0 LT & RT, RAISED ISLAND
 STA. 3+540.0 - STA. 3+552.0 DOUBLE SOLID LT & RT, HATCHED MEDIAN
 STA. 3+552.0 - STA. 3+560.0 DOUBLE SOLID LT, CHURCH STREET
 STA. 3+553.432 - STA. 3+560.0 LT & RT, RAISED ISLAND
 STA. 3+560.0 - STA. 3+570.0 DOUBLE SOLID RT, SPAULDING STREET
 STA. 3+572.744 - STA. 3+589.0 DOUBLE SOLID LT & RT, MEDIAN TAPER
 STA. 3+577.0 - STA. 3+589.0 DOUBLE SOLID LT, ACADEMY STREET

646.43 DURABLE 200 mm YELLOW LINE
 BARRE CITY:
 STA. 3+552.0 - STA. 3+560.0, HATCHED MEDIAN (21.0 m)
 STA. 3+577.0 - STA. 3+589.0, HATCHED MEDIAN (23.0 m)

646.70 TEMPORARY LETTER OR SYMBOL
 BARRE CITY:
 STA. 3+545.0 RT, CHURCH STREET "Y,I,E,L,D" (10 EA)
 STA. 3+553.432 LT, CHURCH STREET "S,T,O,P" (8 EA)
 STA. 3+572.744 RT, SPAULDING STREET "S,T,O,P" (8 EA)
 STA. 3+593.665 LT, ACADEMY STREET "S,T,O,P" (8 EA)

646.42 DURABLE 200 mm WHITE LINE
 BARRE CITY:
 STA. 3+542.0 - STA. 3+560.0 RT, EDGELINE
 STA. 3+542.0 - STA. 3+560.0 RT, GORELINE
 STA. 3+542.0 - STA. 3+560.0 RT, GORE HATCHING (35.0)

646.41 DURABLE 100 mm YELLOW LINE
 (ALL LINES WILL INCLUDE C/L BREAKS FOR TOWN HIGHWAYS) S=SOLID, D=DASHED
 BARRE CITY:
 STA. 3+589.0 - STA. 3+680.0 LT & RT, RAISED ISLAND
 STA. 3+540.0 - STA. 3+552.0 DOUBLE SOLID LT & RT, HATCHED MEDIAN
 STA. 3+552.0 - STA. 3+560.0 DOUBLE SOLID LT, CHURCH STREET
 STA. 3+553.432 - STA. 3+560.0 LT & RT, RAISED ISLAND
 STA. 3+560.0 - STA. 3+570.0 DOUBLE SOLID RT, SPAULDING STREET
 STA. 3+572.744 - STA. 3+589.0 DOUBLE SOLID LT & RT, MEDIAN TAPER
 STA. 3+577.0 - STA. 3+589.0 DOUBLE SOLID LT, ACADEMY STREET

646.66 TEMPORARY 600 mm STOP BAR
 BARRE CITY:
 STA. 3+553.432 LT, CHURCH STREET
 STA. 3+572.744 RT, SPAULDING STREET
 STA. 3+593.665 LT, ACADEMY STREET

646.51 DURABLE CROSSWALK MARKINGS WITH DIAGONAL LINES (MOD.)
 BARRE CITY:
 STA. 3+553.432 LT, CHURCH STREET
 STA. 3+572.744 RT, SPAULDING STREET
 STA. 3+584.0
 STA. 3+593.665 LT, ACADEMY STREET

646.62 TEMPORARY 200 mm WHITE LINE
 BARRE CITY:
 STA. 3+542.0 - STA. 3+560.0 RT, EDGELINE
 STA. 3+542.0 - STA. 3+560.0 RT, GORELINE

646.41 DURABLE 100 mm YELLOW LINE
 (ALL LINES WILL INCLUDE C/L BREAKS FOR TOWN HIGHWAYS) S=SOLID, D=DASHED
 BARRE CITY:
 STA. 3+589.0 - STA. 3+680.0 LT & RT, RAISED ISLAND
 STA. 3+540.0 - STA. 3+552.0 DOUBLE SOLID LT & RT, HATCHED MEDIAN
 STA. 3+552.0 - STA. 3+560.0 DOUBLE SOLID LT, CHURCH STREET
 STA. 3+553.432 - STA. 3+560.0 LT & RT, RAISED ISLAND
 STA. 3+560.0 - STA. 3+570.0 DOUBLE SOLID RT, SPAULDING STREET
 STA. 3+572.744 - STA. 3+589.0 DOUBLE SOLID LT & RT, MEDIAN TAPER
 STA. 3+577.0 - STA. 3+589.0 DOUBLE SOLID LT, ACADEMY STREET

646.50 DURABLE LETTER OR SYMBOL
 BARRE CITY:
 STA. 3+545.0 RT, CHURCH STREET "Y,I,E,L,D" (5 EA)
 STA. 3+553.432 LT, CHURCH STREET "S,T,O,P" (4 EA)
 STA. 3+572.744 RT, SPAULDING STREET "S,T,O,P" (4 EA)
 STA. 3+593.665 LT, ACADEMY STREET "S,T,O,P" (4 EA)

646.71 TEMPORARY CROSSWALK MARKINGS WITH DIAGONAL LINES (MOD.)
 BARRE CITY:
 STA. 3+553.432 LT, CHURCH STREET
 STA. 3+572.744 RT, SPAULDING STREET
 STA. 3+584.0
 STA. 3+593.665 LT, ACADEMY STREET

646.81 PAINTED CURB
 BARRE CITY:
 STA. 3+540.0 - STA. 3+552.0 LT & RT, RAISED ISLAND
 STA. 3+540.0 - STA. 3+542.0 RT, RAISED ISLAND
 STA. 3+540.0 - STA. 3+546.0 LT
 STA. 3+542.0 - STA. 3+566.0 RT
 STA. 3+560.0 - STA. 3+569.0 LT & RT, RAISED ISLAND
 STA. 3+561.0 - STA. 3+582.8 LT
 STA. 3+579.0 - STA. 3+582.8 RT
 STA. 3+585.2 - STA. 3+680.0 RT
 STA. 3+604.0 - STA. 3+634.0 LT

ARCHIVED
ON CADD

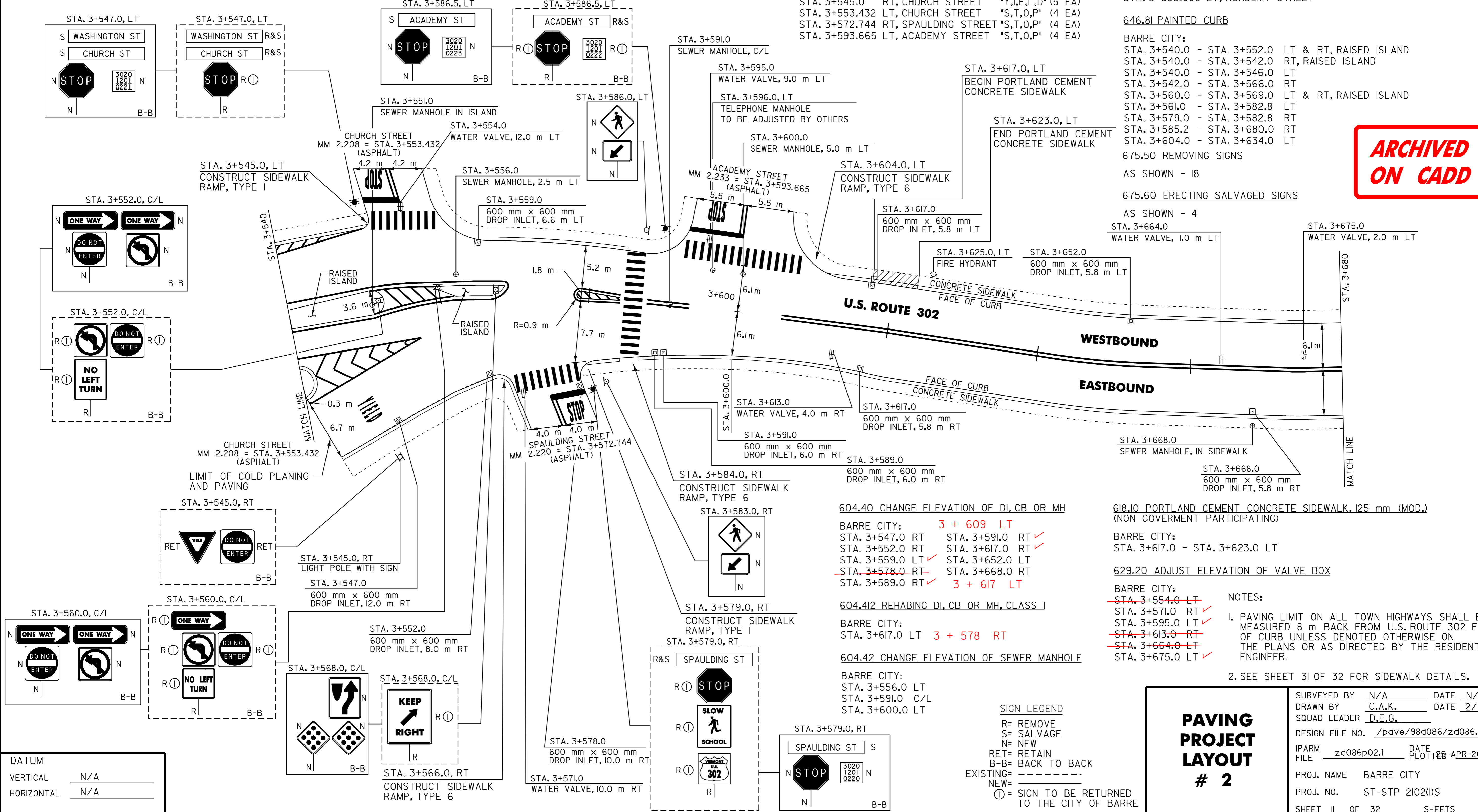

675.50 REMOVING SIGNS
 AS SHOWN - 18

675.60 ERECTING SALVAGED SIGNS
 AS SHOWN - 4

604.40 CHANGE ELEVATION OF DI, CB OR MH
 BARRE CITY:
 STA. 3+547.0 RT ✓
 STA. 3+552.0 RT ✓
 STA. 3+559.0 LT ✓
 STA. 3+578.0 RT ✓
 STA. 3+589.0 RT ✓
 STA. 3+591.0 RT ✓
 STA. 3+617.0 RT ✓
 STA. 3+623.0 LT ✓
 STA. 3+652.0 LT ✓
 STA. 3+668.0 RT ✓
 STA. 3+617.0 RT ✓

618.10 PORTLAND CEMENT CONCRETE SIDEWALK, 125 mm (MOD.)
 (NON GOVERNMENT PARTICIPATING)
 BARRE CITY:
 STA. 3+617.0 - STA. 3+623.0 LT

629.20 ADJUST ELEVATION OF VALVE BOX
 BARRE CITY:
 STA. 3+554.0 LT ✓
 STA. 3+571.0 RT ✓
 STA. 3+595.0 LT ✓
 STA. 3+613.0 RT ✓
 STA. 3+664.0 LT ✓
 STA. 3+675.0 LT ✓

NOTES:
 1. PAVING LIMIT ON ALL TOWN HIGHWAYS SHALL BE MEASURED 8 m BACK FROM U.S. ROUTE 302 FACE OF CURB UNLESS DENOTED OTHERWISE ON THE PLANS OR AS DIRECTED BY THE RESIDENT ENGINEER.
 2. SEE SHEET 31 OF 32 FOR SIDEWALK DETAILS.

604.412 REHABING DI, CB OR MH, CLASS I
 BARRE CITY:
 STA. 3+617.0 LT ✓
 STA. 3+591.0 C/L ✓
 STA. 3+600.0 LT ✓

604.42 CHANGE ELEVATION OF SEWER MANHOLE
 BARRE CITY:
 STA. 3+556.0 LT ✓
 STA. 3+591.0 C/L ✓
 STA. 3+600.0 LT ✓

SIGN LEGEND
 R= REMOVE
 S= SALVAGE
 N= NEW
 RET= RETAIN
 B-B= BACK TO BACK
 EXISTING= -----
 NEW= _____
 ⊕ = SIGN TO BE RETURNED TO THE CITY OF BARRE

PAVING PROJECT LAYOUT # 2

SURVEYED BY N/A DATE N/A
 DRAWN BY C.A.K. DATE 2/02
 SQUAD LEADER D.E.G.
 DESIGN FILE NO. /pave/98d086/zd086.dgn
 IPARM FILE zd086p02.i DATE 25-APR-2006 14
 PROJ. NAME BARRE CITY
 PROJ. NO. ST-STP 2102(IIS)
 SHEET II OF 32 SHEETS

DATUM
 VERTICAL N/A
 HORIZONTAL N/A