

REINFORCING STEEL			
Bar Size	No. Rods	Length	Detail
P1 1/2" φ	34	4'-9"	
P2 1/2" φ	8	17'-6"	Straight
P3 3/4" φ	92	18'-0"	Straight
P4 1/2" φ	48	17'-4"	Straight
P5 1" φ	46	7'-6"	
P6 1" φ	28	11'-6"	
P7 1" φ	12	24'-7"	
P8 1/2" φ	36	Ave. 16'-6"	Straight, bent in field

For General Notes See Details Abut. #1

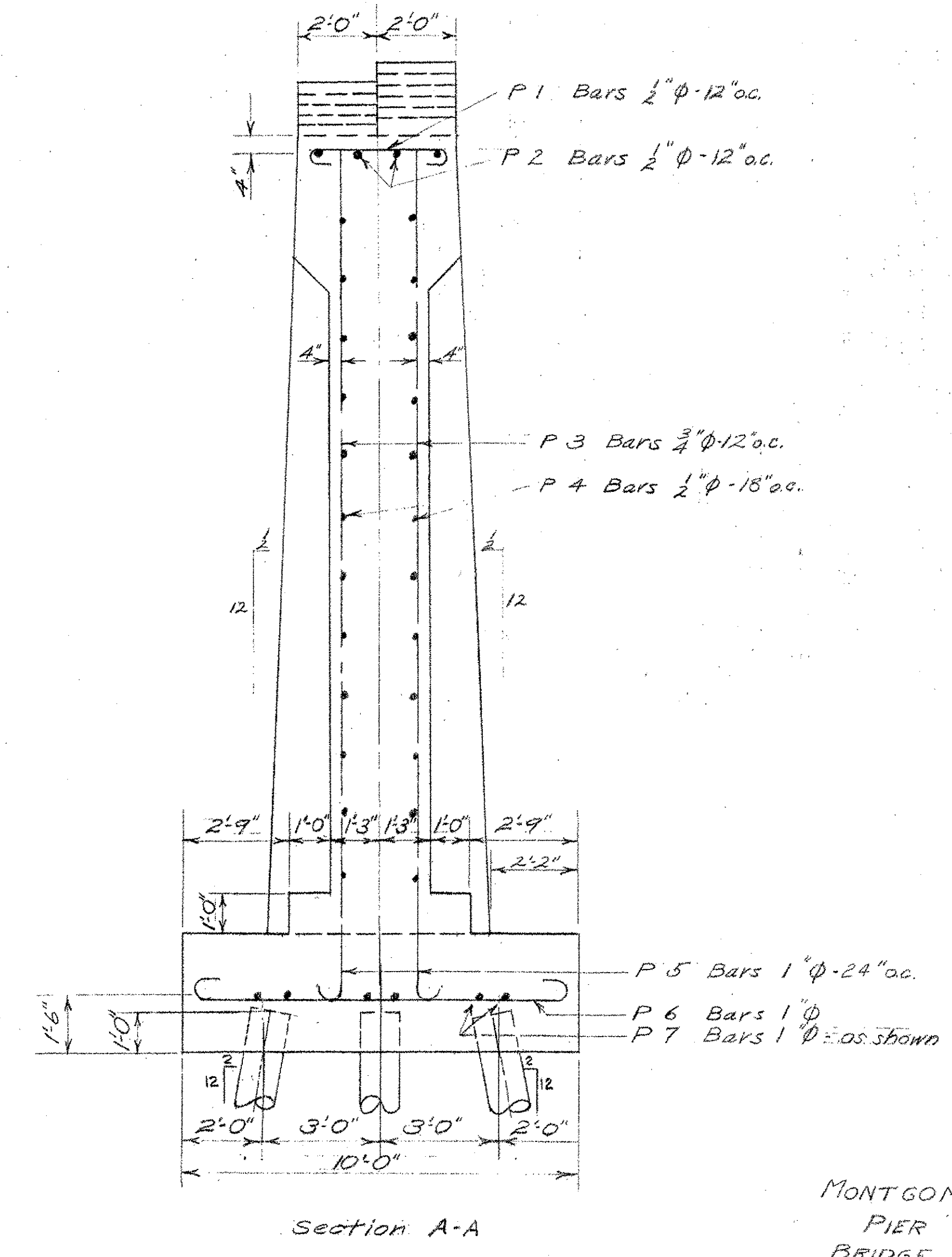
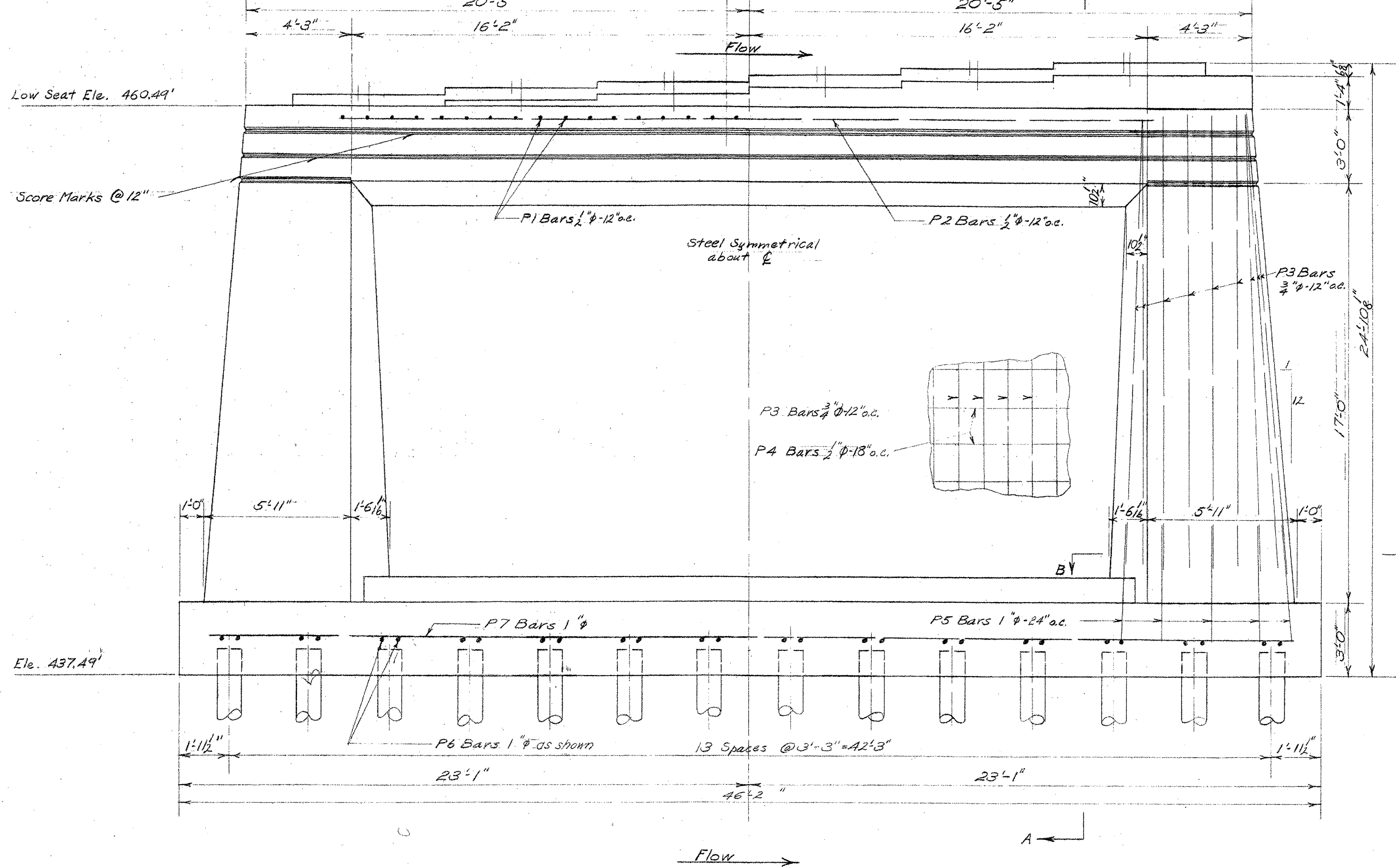

MONTGOMERY  
PIER No. 1  
BRIDGE No. 19  
Scale 3/8" = 1'-0"

Note: All Piling to be Untreated Timber Piling, Item 502-A, Driven to 20 Ton Bearing Capacity  
42 Piles Estimated to be 35' long, Minimum Diameter 3' from Butt to be 13" Under Bark.  
Piles shall be shod with Steel Shoes as shown on Std. Draw. SB-20 Det. 'N'. Cost of Steel Shoes shall be included in bid price for Untreated Timber Piling.  
Cut-off Allowance for Untreated Timber Piling, Item 502-A1 = 3 x 42 = 126 Lin. Ft.

REFERENCE SHEET ONLY

REINFORCING STEEL REVISION	
Estimated Quantities	
Structure Excav. (Mod)	160 CY
Concrete Class. C (Mod)	160 CY
Reinf. Steel	6202 lbs
Untreated Timber Piling	1470 Lin. Ft.
Cut-offs Untreated Timber Piling	126 Lin. Ft.

MONTGOMERY  
BHP 0283(S)  
VT RTE. 118 OVER THE TROUT RIVER  
SHEET 42 OF 45  
FOR INFORMATION PURPOSES ONLY