

TEMPORARY AND DURABLE 4in YELLOW LINE  
STA 69+25 TO 82+47  
SOLID LT&RT

TEMPORARY AND DURABLE 4in WHITE LINE  
STA 69+25 TO 82+47  
SOLID LT&RT

TEMPORARY AND DURABLE LETTER OR SYMBOL  
STA 72+94 RT  
STA 82+15 RT  
"STOP AHEAD"  
"STOP"

TEMPORARY AND DURABLE 24in STOP BAR  
STA 82+15 RT  
VT ROUTE 105

DITCHING LOCATIONS (REFER TO SHEET 10 FOR DETAILS)  
STA 69+25 TO ~~72+00~~ LT  
~~69+93~~

CHANGE ELEVATION OF C.B.'S, D.I.'S, OR M.H.'S  
STA 81+46 LT&RT

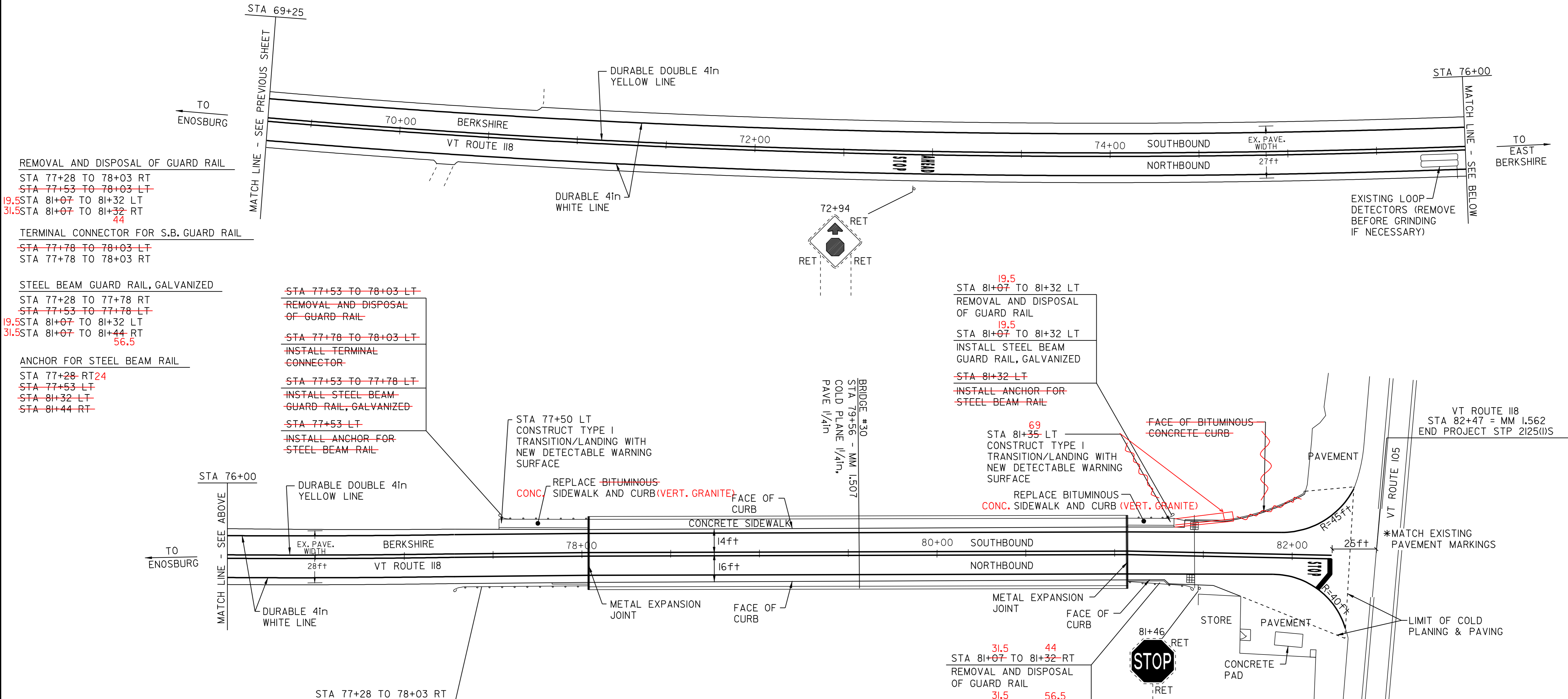

REMOVAL AND DISPOSAL OF GUARD RAIL  
~~19.5~~ STA 77+28 TO 78+03 RT  
~~19.5~~ STA 77+53 TO 78+03 LT  
~~31.5~~ STA 81+07 TO 81+32 LT  
~~31.5~~ STA 81+07 TO 81+32 RT  
 44

TERMINAL CONNECTOR FOR S.B. GUARD RAIL  
~~STA 77+78 TO 78+03 LT~~  
 STA 77+78 TO 78+03 RT

STEEL BEAM GUARD RAIL, GALVANIZED  
 STA 77+28 TO 77+78 RT  
~~STA 77+53 TO 77+78 LT~~  
~~19.5~~ STA 81+07 TO 81+32 LT  
~~31.5~~ STA 81+07 TO 81+44 RT  
 56.5

ANCHOR FOR STEEL BEAM RAIL  
 STA 77+28 RT 24  
~~STA 77+53 LT~~  
~~STA 81+32 LT~~  
~~STA 81+44 RT~~

~~STA 77+53 TO 78+03 LT~~  
 REMOVAL AND DISPOSAL OF GUARD RAIL

~~STA 77+78 TO 78+03 LT~~  
 INSTALL TERMINAL CONNECTOR

~~STA 77+53 TO 77+78 LT~~  
 INSTALL STEEL BEAM GUARD RAIL, GALVANIZED

~~STA 77+53 LT~~  
 INSTALL ANCHOR FOR STEEL BEAM RAIL

~~19.5~~ STA 81+07 TO 81+32 LT  
 REMOVAL AND DISPOSAL OF GUARD RAIL

~~19.5~~ STA 81+07 TO 81+32 LT  
 INSTALL STEEL BEAM GUARD RAIL, GALVANIZED

~~STA 81+32 LT~~  
 INSTALL ANCHOR FOR STEEL BEAM RAIL

69  
 STA 81+35 LT  
 CONSTRUCT TYPE I TRANSITION/LANDING WITH NEW DETECTABLE WARNING SURFACE

REPLACE BITUMINOUS CONC. SIDEWALK AND CURB (VERT. GRANITE)

~~31.5~~ ~~44~~  
 STA 81+07 TO 81+32 RT  
 REMOVAL AND DISPOSAL OF GUARD RAIL

~~31.5~~ ~~56.5~~  
 STA 81+07 TO 81+44 RT  
 INSTALL STEEL BEAM GUARD RAIL, GALVANIZED

~~STA 81+44 RT~~  
 INSTALL ANCHOR FOR STEEL BEAM RAIL

STA 77+28 TO 78+03 RT  
 REMOVAL AND DISPOSAL OF GUARD RAIL

STA 77+78 TO 78+03 RT  
 INSTALL TERMINAL CONNECTOR

STA 77+28 TO 77+78 RT  
 INSTALL STEEL BEAM GUARD RAIL, GALVANIZED  
 24

STA 77+28 RT  
 INSTALL ANCHOR FOR STEEL BEAM RAIL

- LEGEND
- N = NEW
  - R = REMOVE
  - R&S = REMOVE & SALVAGE
  - S = SALVAGE
  - RET = RETAIN
  - B-TO-B = BACK TO BACK
  - ⊕ □ CATCH BASIN/DI
  - ⊙ □ EXISTING THROAT DI
  - I MARKER POST
  - ⊗ UTILITY POLE
  - ⊗/⊗ UTIL. POLE W/UNDERGROUND UTIL.
  - ⊗ DRIVE

REHAB DROP INLETS, CATCH BASINS, CLASS I  
 STA 81+44 RT & LT

## PAVING PROJECT LAYOUT SHEET #14

DESIGNED BY	BCE/PJM	DATE	6-06
DRAWN BY	C.E.A., INC.	DATE	6-06
DESIGN FILE NO.	p98cl82.dgn		
PRF FILE	p98cl82i14.1	DATE PLOTTED	10-FEB-2010 14:
PROJ. NAME	MONTGOMERY - BERKSHIRE		
PROJ. NO.	STP 2125(1)S		
SHEET	24	OF	41 SHEETS